

OPERATORS AND PARTS MANUAL TP44, TRACK PAVER



MANUFACTURER OF OUTDOOR POWER EQUIPMENT

Products for Turf & Lawn care, Rental, Construction, Tree care, Wood Processing, Nursery & Farm Industries

Other Salsco Equipment

3-1/2" - 18", Gas, Diesel, and P.T.O, Wood/Brush Chippers

Chipper Shredder Vacuum - Tailgate & Truckloader Vacuums up to 65 HP

Shaving Mills - Gas and Electric Greens Rollers

***Quality of Workmanship, Innovative
Design, Built to Last!***

105 School House Road
Cheshire, CT 06410 U.S.A.
800-872-5726, 203-271-1682, 203-271-2596 (Fax)
sales@salsco.com, www.salsco.com

TABLE OF CONTENTS

MODEL TP-44 0005026 DESCRIPTION

COVER & TABLE OF CONTENTS.....	Pages 1 – 2
STATEMENT OF FACT	Page 3
MACHINE REGISTRATION	Page 4
TORQUE CHART.....	Page 5
PARTS DIAGRAM.....	Pages 6-24
TRACK PAVER OPERATION.....	Page 25
WARRANTY POLICY & PROCEDURE	Page 26
COPY OF WARRANTY CLAIM FORM.....	Page 27
COPY OF DEALER DELIVERY REPORT & WARRANTY CARD.....	Page 28
SERVICE SCHEDULE LOG	Page 29

SALSCO, INC.

105 School House Road
Cheshire, CT 06410 USA
800-872-5726, 203-271-1682
203-271-2596 (Fax)
www.salsco.com, sales@salsco.com

STATEMENT OF FACT

You have just purchased the highest quality, most dependable, Track Paver on the market today. This unit has the ability to meet exact standards and perform for years with minimum downtime. HOWEVER, it cannot read nor will it understand this manual no matter how long you leave it on top of the machine.

It is your responsibility to read and understand this manual; it is also your responsibility to be certain this information is passed along to anyone who is expected to operate this equipment. Should you choose not to read, understand and pass along the information provided you, please expect equipment failure and possible injuries to persons around this equipment.

For the safety of the operator, it is **imperative** that this manual is carefully read and understood.

Once you have read this manual, it is your responsibility to be sure that all new operators read and understand this manual, especially all cautions stated.

As a manufacturer of equipment, we have a responsibility to design a safe piece of equipment. NOTE: The important safeguards and instructions in this manual are not meant to cover all possible conditions and situations that may occur. It must be understood that common sense, caution, and care are factors, which cannot be built into any product. These factors must be supplied by the person(s) caring for and operating this equipment.

ONLY YOU CAN PREVENT ACCIDENTS!!

MACHINE REGISTRATION

MANUFACTURED BY:

SALSCO, INC.

105 School House Rd., Cheshire, CT 06410

800-872-5726, 203-271-1682, 203-271-2596 (Fax)

sales@salsco.com www.salsco.com

THIS MANUAL COVERS MODEL (s): 0005026– TRACK PAVER TP-44

This company reserves the right to discontinue, add improvements to, or change the design of any model or product at any time without obligation to improve existing machines, either by changing the design or adding new parts.

It has been and will continue to be the policy of SALSCO to update existing machines at its own discretion. Whenever possible, new designs will be made in such a way that they can be "Retro Fit" if so desired.

Record in the space provided below the model and serial number of this unit. Please retain these numbers for future reference.

No parts orders will be accepted **WITHOUT MODEL NUMBERS OR PART NUMBERS**. All part numbers are listed in this manual.

Serial Number

Model Number

NOTE: Be sure to complete your warranty card. This will insure immediate processing of any warranty claims.

READ AND UNDERSTAND THIS MANUAL BEFORE STARTING THE MACHINE

3/2011

Below is a quick reference chart for various “Flat Head Cap Screws” and the torque recommendations.

VALUES ARE STATED IN FOOT POUNDS

BOLT SIZE	Thds Per Inch	SAE Grade 5	SAE Grade 8
1/4	20	10	14
	28	---	---
5/16	18	19	29
	24	---	---
3/8	16	33	47
	24	---	---
7/16	14	54	78
	20	---	---
1/2	13	78	119
	20	---	---
9/16	12	114	169
	18	---	---
5/8	11	154	230
	11	---	---
3/4	10	257	380
	10	---	---
7/8	9	382	600
	9	---	---
1	8	587	700
	8	---	---

Drive Belt Tension Measurement by Deflection

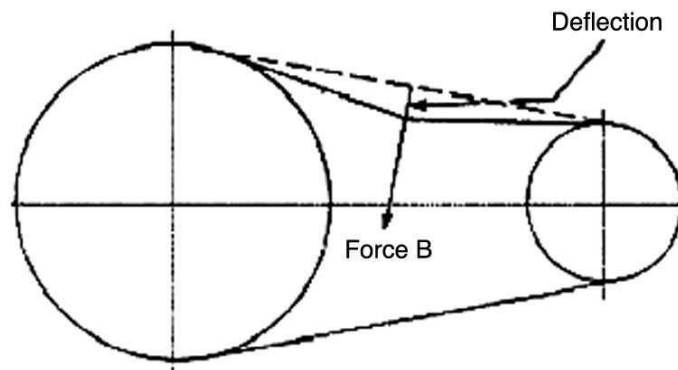

Deflection should be 3/8" when 8-12 lbs. push is applied at "B"

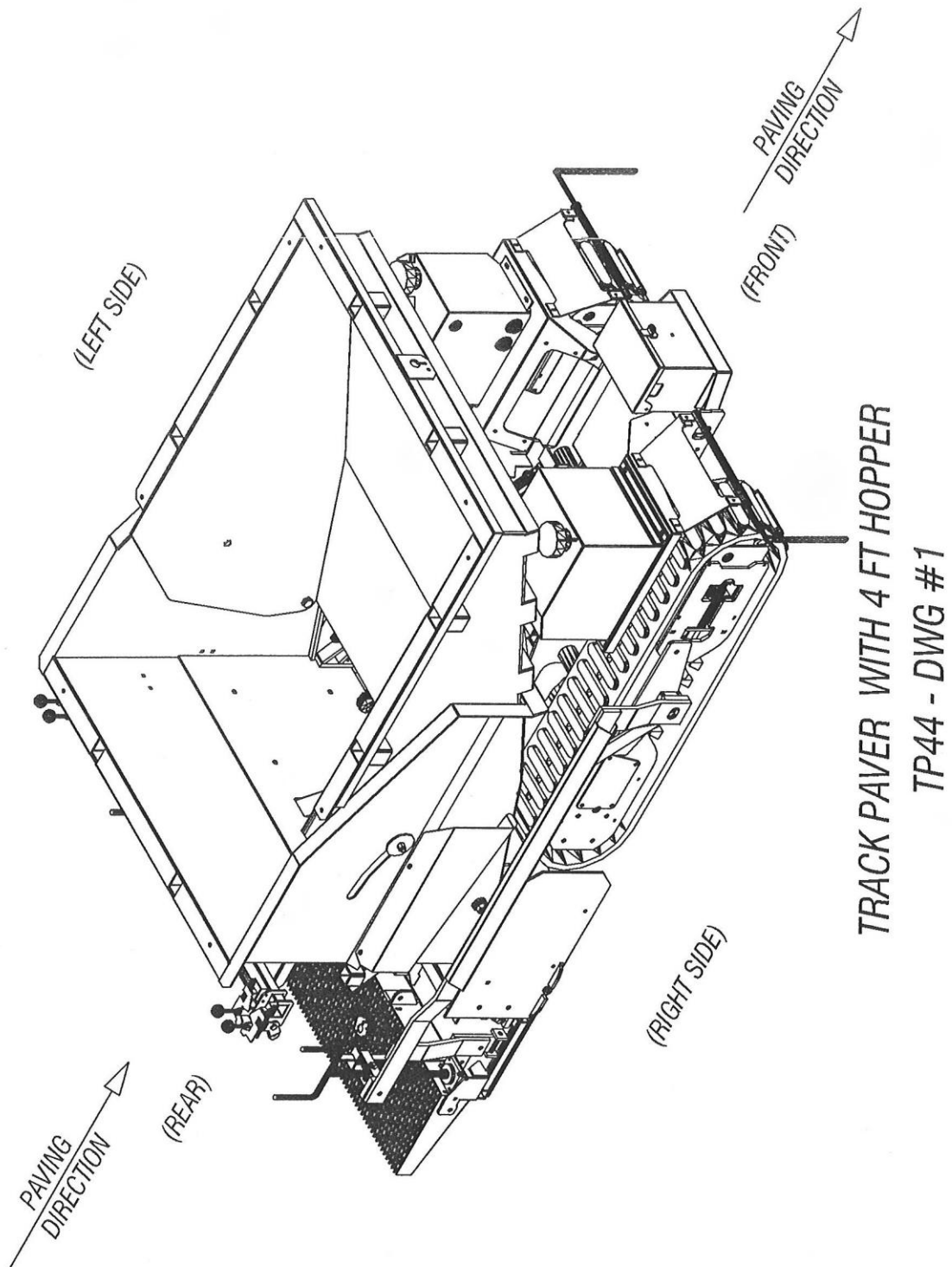

14	DRIVE CHAIN, #80 x 33 PITCHES	0309079	2
15	MASTER LINK, #80 CHAIN	0309038	2
16	SPROCKET, TRACK DRIVE	0251171	2
17	SHAFT, DRIVE SPROCKET	0448326	2
18	GUIDE, TRACK DRIVE, UPPER	0422162	2

ISSUED: 08-05-2013

ITEM	DESCRIPTION	PART NO	QTY
1	FRAME, TRACK DRIVE - RIGHT	0219383	1
2	FRAME, TRACK DRIVE - LEFT	0219384	1
3	ADJUSTER, IDLER TENSION	0201029	2
4	WHEEL, TRACK IDLER - MAIN	0254104	2
5	BEARING, PILLOW BLOCK	0303057	4
6	SHAFT, IDLER TRACK WHEEL	0448327	2
7	NUT HEX JAM - (3/4-10)	0338056	16
8	FLAT WASHER - (3/4 S.A.E.)	0353149	4
9	SPRING, COMPR. - (13 COIL)	0350044	4

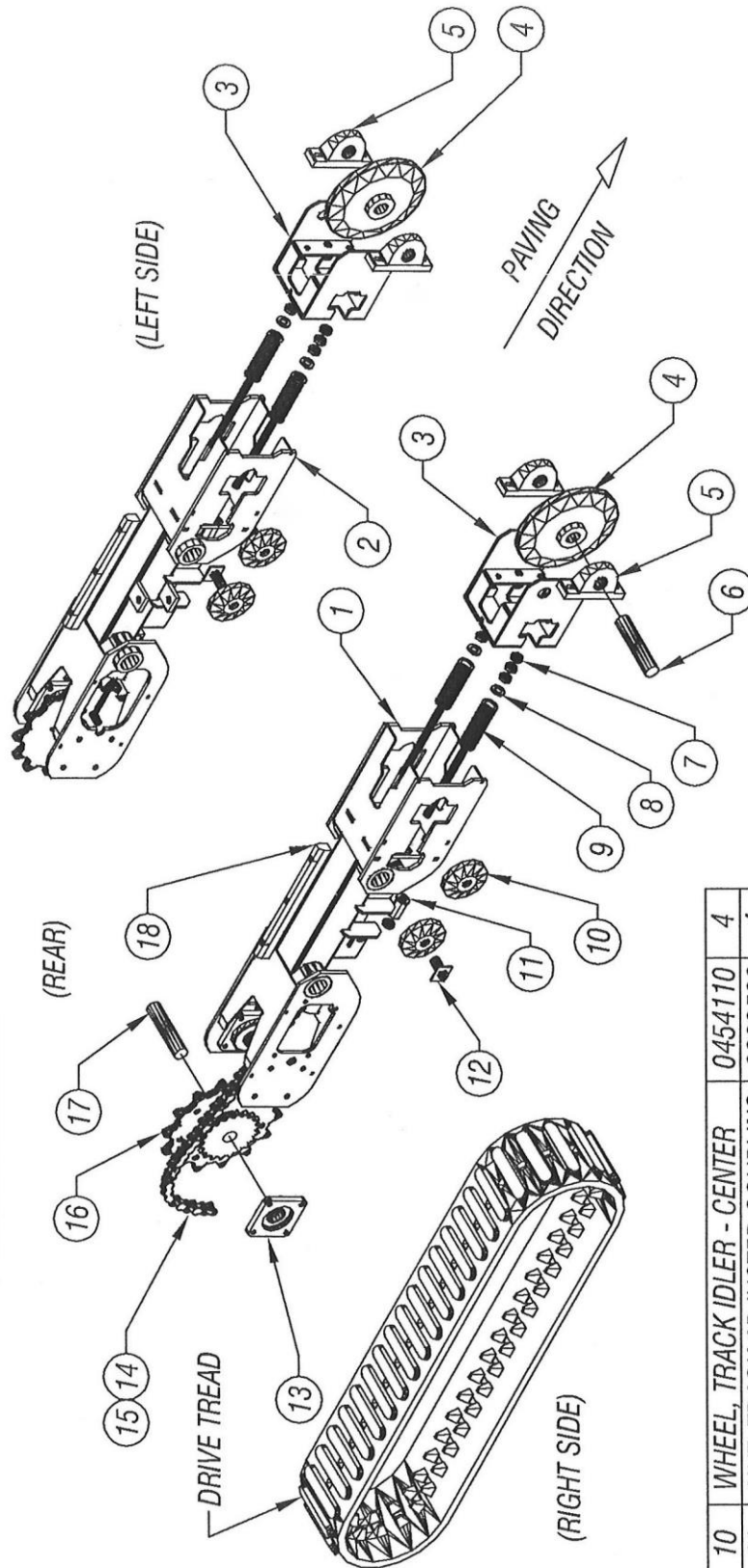

TP44 - DWG #2

10	WHEEL, TRACK IDLER - CENTER	0454110	4
11	NUT, TRACK ADJUSTER COUPLING	0238506	4
12	TUBE, IDLER MOUNTING	0267429	4
13	BEARING, 4-BOLT FLANGED	0303002	4

ISSUED: 08-05-2013

ITEM	DESCRIPTION	PART NO	QTY
1	DRIVE TREAD, RUBBER TRACK	0354102	2
2	COVER, CHAIN ACCESS - LEFT	0271302	1
3	COVER, CHAIN ACCESS - RIGHT	0271303	1
4	ADJUSTER, TRACK DRIVE MOTOR	0201034	2
5	HYDRAULIC DRIVE MOTOR	0330169	2
6	SPROCKET HYD DRIVE MOTOR	0251177	2
7	MOUNT, HYD DRIVE MOTOR - LEFT	0276893	1
8	MOUNT, HYD DRIVE MOTOR-RIGHT	0276894	1

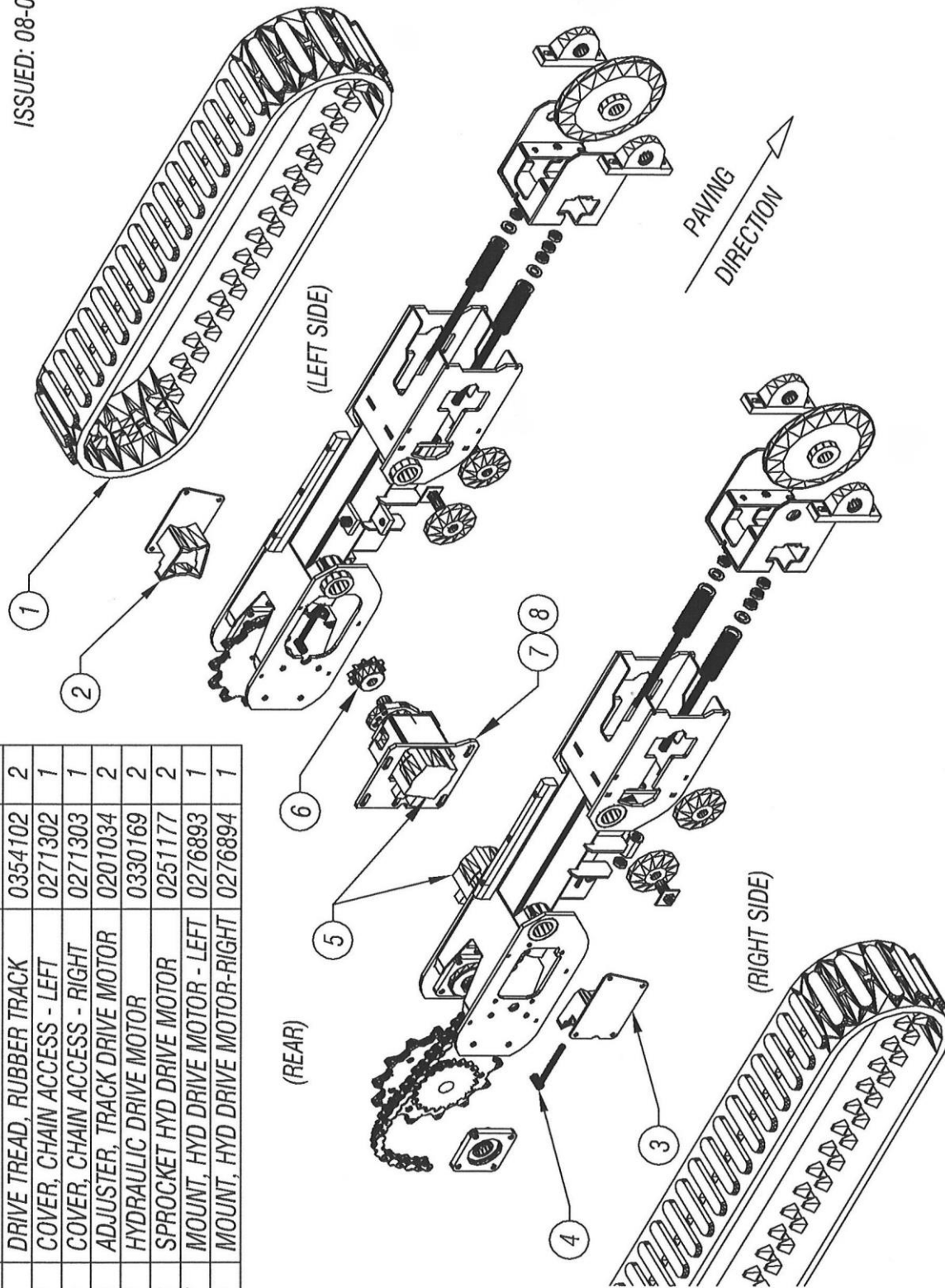

TP44 - DWG #3

ITEM	DESCRIPTION	PART NO	QTY
1	FRAME, BASE	0219525	1
2	STAND, PLATFORM	0273040	1
3	GUIDE, ASPHALT FLOW - RIGHT	0222232	1
4	GUIDE, ASPHALT FLOW - LEFT	0222231	1
5	GUIDE, ASPH.FLOW EXTENSION - LEFT	0222229	1
6	GUIDE, ASPH.FLOW EXTENSION-RIGHT	0222230	1
7	PLATE, ASPHALT GUIDE - RIGHT	0290196	1
8	PLATE, ASPHALT GUIDE - LEFT	0290195	1
9	BLOCK, SCREED EXTENSION MOUNT	0485049	4
10	SHAFT, FLOW GUIDE EXTENSION	0448388	4

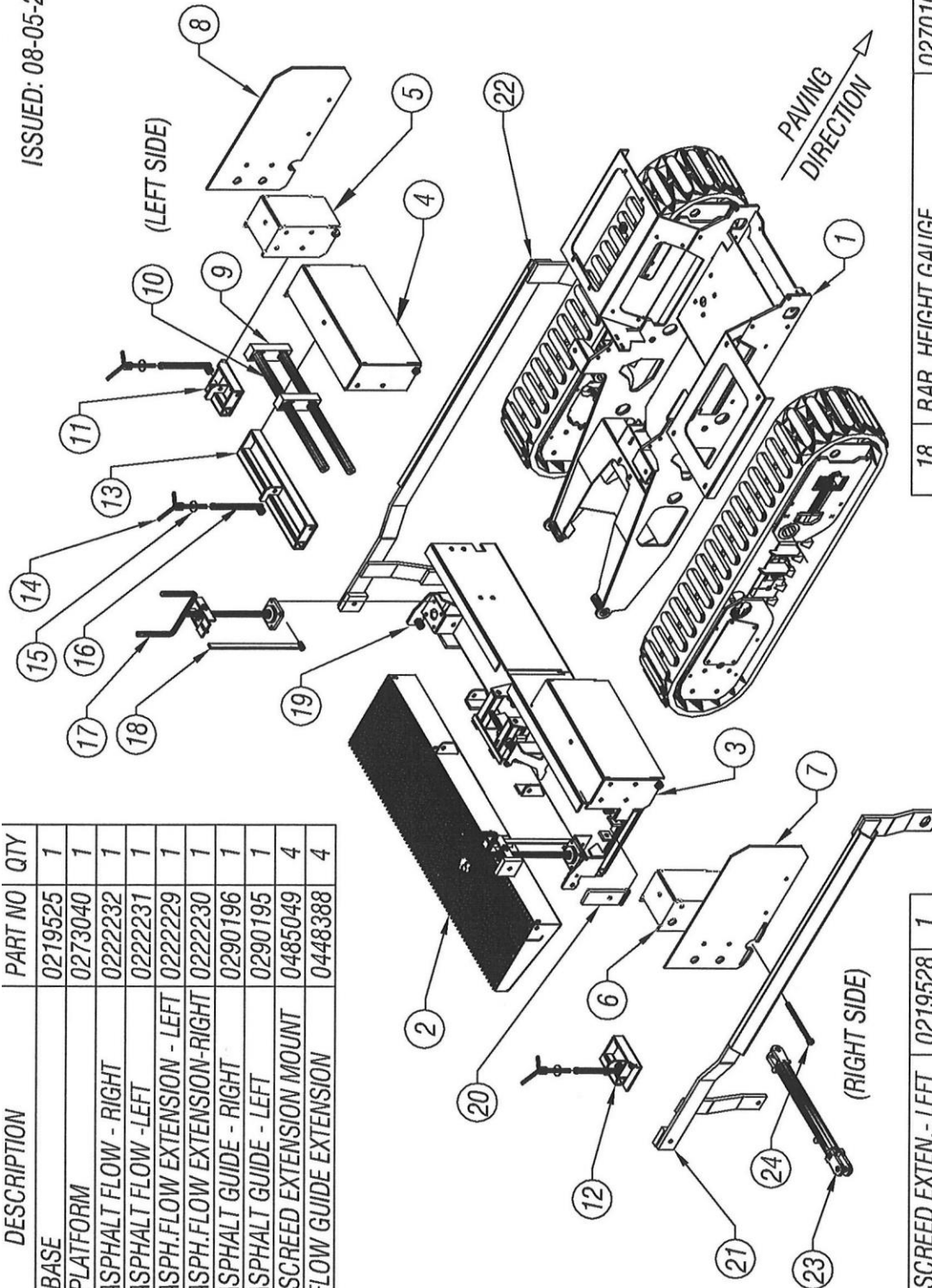

11	FRAME, 6" SCREED EXTEN. - LEFT	0219528	1
12	FRAME, 6" SCREED EXTEN. - RIGHT	0219529	1
13	FRAME, TRACK PAVER SCREED	0219530	2
14	ADJUSTER, SCREED EXTENSION	0201069	4
15	WASHER, FENDER - 1/2 ID	0353204	4
16	ROD, EXTEN. SCREED ADJUS.	0245189	4
17	JACK, SCREED HEIGHT ASSY	0169054	2

18	BAR, HEIGHT GAUGE	0270166	2
19	FRAME, SCREED	0219531	1
20	LINK, SCREED HEIGHT ADJUSTMT	0234061	2
21	ARM, SCREED EXT. LIFT - RIGHT	0265160	1
22	ARM, SCREED EXT. LIFT - LEFT	0265159	1
23	HYD CYLINDER (SCREED EXTENT)	0330254	2
24	BOLT, SCREED EXTENSION PIVOT	0246911	2

TP44 - DWG #4

ISSUED: 08-05-2013

ITEM	DESCRIPTION	PART NO	QTY
1	TANK, HYDRAULIC	0252117	1
2	CAP, GAS / OIL FILL LOCKING	0271024	2
3	TANK, FUEL - 8.9 GALLONS	0252116	1

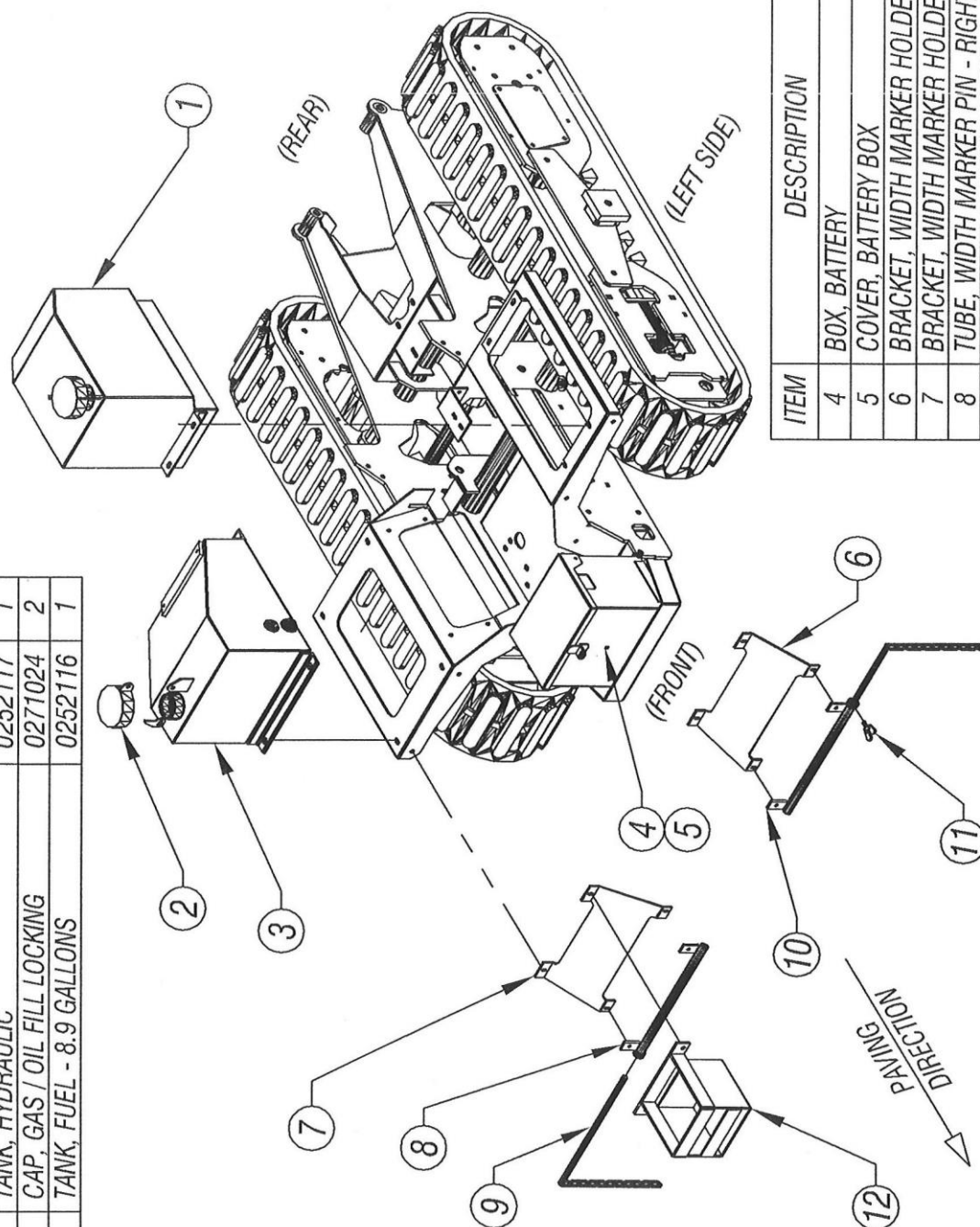

ITEM	DESCRIPTION	PART NO	QTY
4	BOX, BATTERY	0280001	1
5	COVER, BATTERY BOX	0271020	1
6	BRACKET, WIDTH MARKER HOLDER-LEFT	0488032	1
7	BRACKET, WIDTH MARKER HOLDER-RT	0488031	1
8	TUBE, WIDTH MARKER PIN - RIGHT	0267384	1
9	PIN, WIDTH MARKER	0240136	2
10	TUBE, WIDTH MARKER PIN - LEFT	0267383	1
11	WING SCREW	0246962	2
12	BOX, 6" SCREED EXTENSION STORAGE	0280070	2

TP44 - DWG #5

ITEM	DESCRIPTION	PART NO	QTY	ITEM	DESCRIPTION	PART NO	QTY
1	HYD MOTOR, AUGER TURN	0330209	2	9	SPACER, SPLITTER	0448040	2
2	WASHER, FENDER - 3/8 ID	0353203	2	10	BEARING	0303086	2
3	SOC HD CAP SCREW, - 3/8-24 x 1" LG	0346244	2	11	SPACER, AUGER SHAFT DRIVE	0249277	2
4	ROLLER CHAIN, AUGER TURN	0409092	2	12	AUGER, RIGHT	0336137	1
5	MASTER LINK (CONNECTING LINK)	0309049	4	13	BUSHING, BRONZE - OILIGHT	0307031	2
6	SPROCKET, HYD MOTOR, AUGER TURN	0251207	2	14	MOUNT, AUGER SHAFT	0276759	2
7	COVER, AUGER BOX, ACCESS	0471419	1	15	BOLT, HEX HEAD	0346522	4
8	SPACER, AUGER DRIVE MOTOR	0449278	1	16	NUT, CASTLE	0338204	4

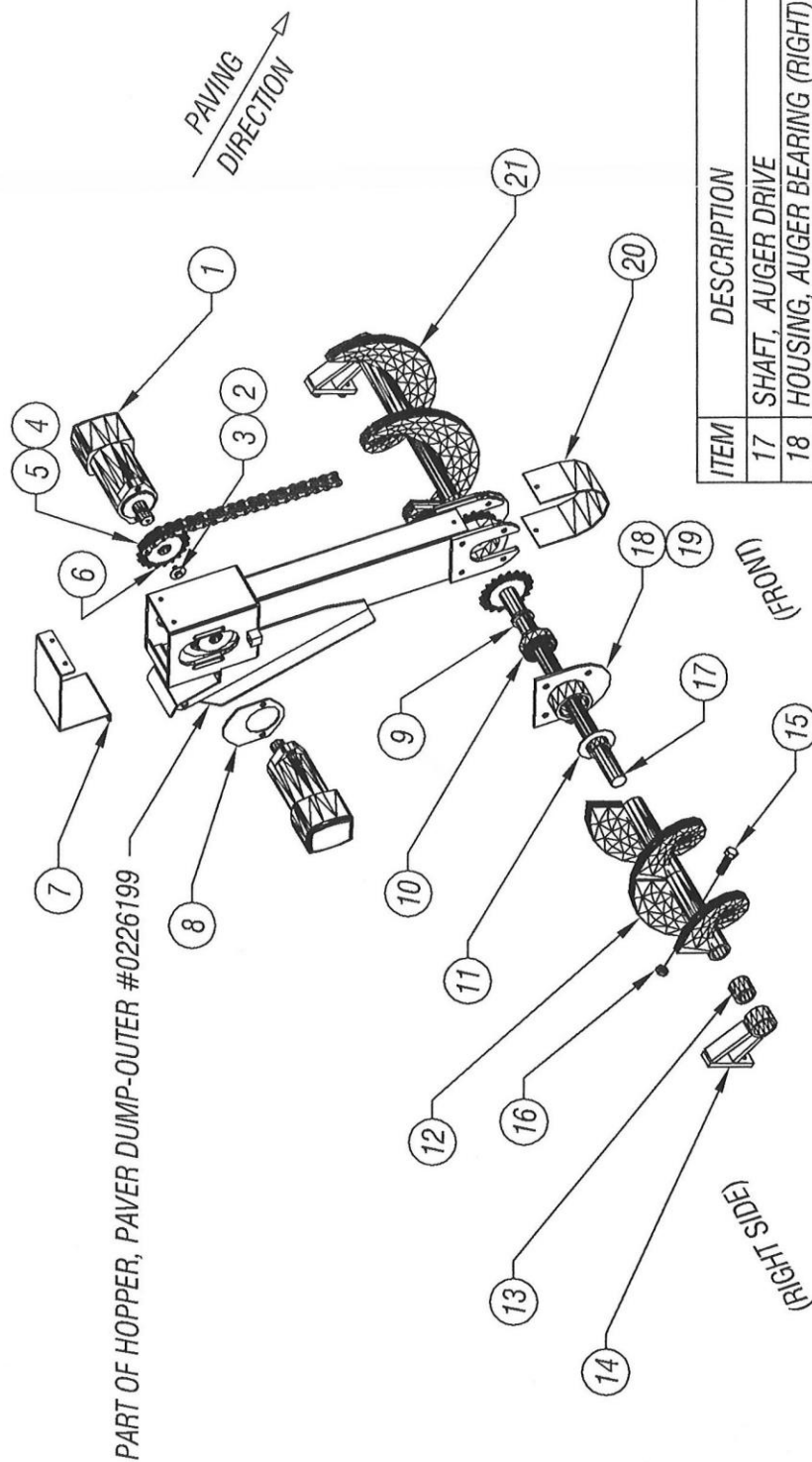

ITEM	DESCRIPTION	PART NO	QTY
17	SHAFT, AUGER DRIVE	0248384	2
18	HOUSING, AUGER BEARING (RIGHT)	0228284	1
19	HOUSING, AUGER BEARING (LEFT)	0228286	1
20	GUARD, AUGER CHAIN DRIVE	0421600	2
21	AUGER LEFT	0336138	1

TP44 - DWG #6

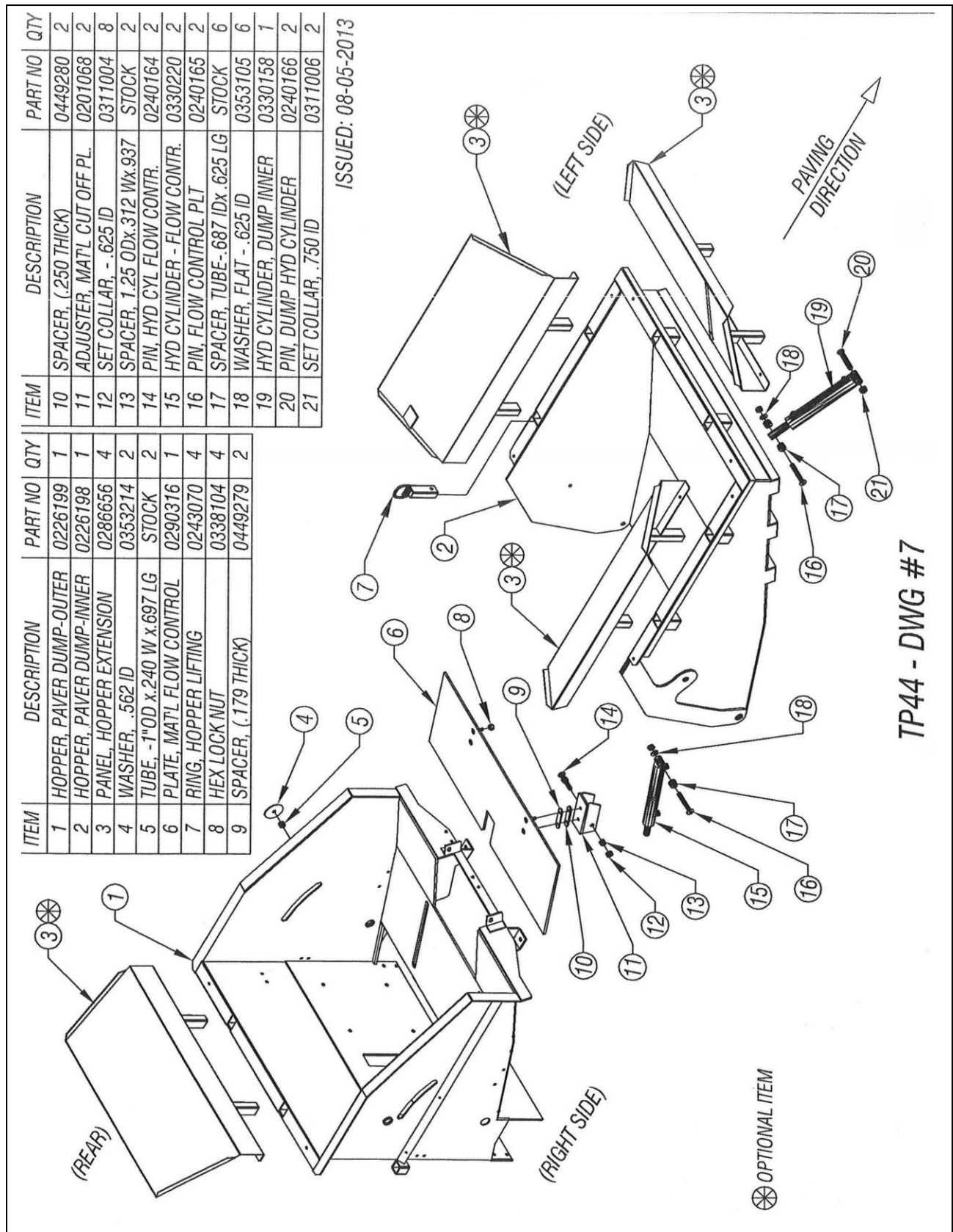

ITEM	DESCRIPTION	PART NO	QTY	ITEM	DESCRIPTION	PART NO	QTY
1	FRAME, SCREED	0219531	1	8	CHAIN, 3/8 x (8 LINKS)	STOCK	1
2	GUARD, REAR CONTR. CABLE-LEFT	0421599	1	9	ADJUSTER, PAVESCREW WIDTH	0201036	1
3	GUARD, REAR CONTR. CABLE-RIGHT	0421598	1	10	TUBE, SCREED WIDTH ADJUSTER	0267375	1
4	HYD CYLINDER, SCREED-UP/DOWN	0330157	1	11	HEX NUT, 3/4-10	0338016	2
5	ARM, SCREED LIFT HYD CYLINDER	0265120	1	12	WASHER, 3/4 FLAT	0353139	3
6	CHAIN, - 3/8 x (4 LINKS)	STOCK	2	13	STAND, PLATFORM	0273040	1
7	BRACKET, SCREED LIFT	0488048	2				

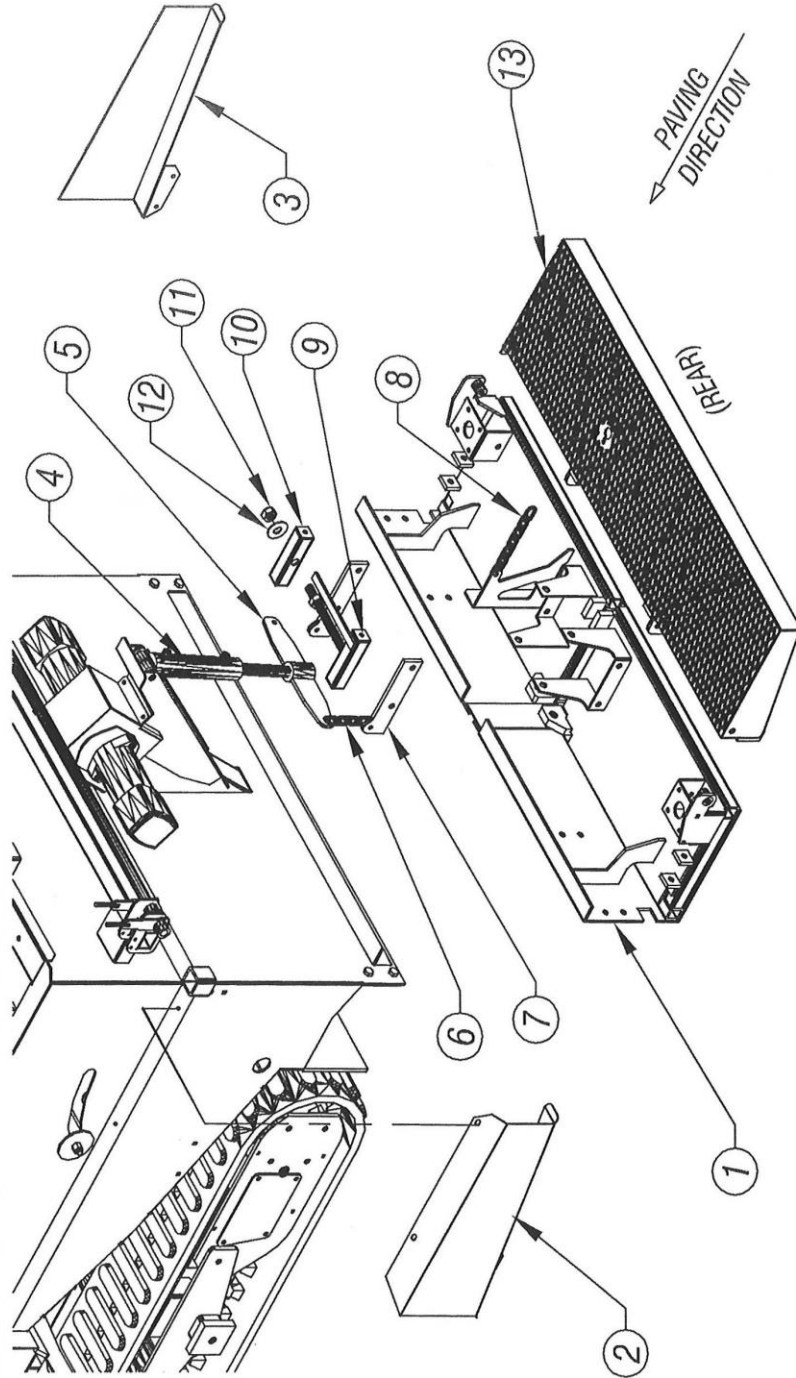

TP44 - DWG #8

ITEM	DESCRIPTION	PART NO	QTY	ITEM	DESCRIPTION	PART NO	QTY
1	MOUNT, CONTROL LEVER LINKAGE (RIGHT)	0276897	1	10	SHAFT, CONTROL LEVER LINKAGE	0445191	1
2	BRACKET, NEUT. SAFE LATCH MTG- LEFT	0276558	1	11	LEVER, DRIVE CONTROL - OUTER	0233261	1
3	LATCH, NEUTRAL SAFETY - LEFT	0233205	1	12	HAND KNOB, BLACK	0332005	4
4	BRACKET, NEUT. SAFE LATCH MTG-RIGHT	0276559	1	13	MOUNT, CONTROL LEVER LINKAGE -RIGHT	0276787	1
5	LATCH, NEUTRAL SAFETY - RIGHT	0233206	1	14	GREASE FITTINGS	0317148	20
6	SHAFT, DRIVE CONTROL LEVER - 44" REAR	0248386	1	15	BRKT. ENG. IGNITION BOX & CONTR. CABLE	0288044	1
7	TUBE, DRIVE CONTROL LEVER SHAFT	0267694	1	16	THROTTLE CABLE, T-HANDLE LOCKING	0308040	1
8	PUSH / PULL CABLE ASSY (TRACK DRIVE)	0308036	2	17	BRACKET, 5-SECTION VALVE MOUNTING	0488023	1
9	MOUNT, CONTROL CABLES	0476581	1	18	BRACKET, AUGER CONTR. VALVE MOUNT'G	0488022	2

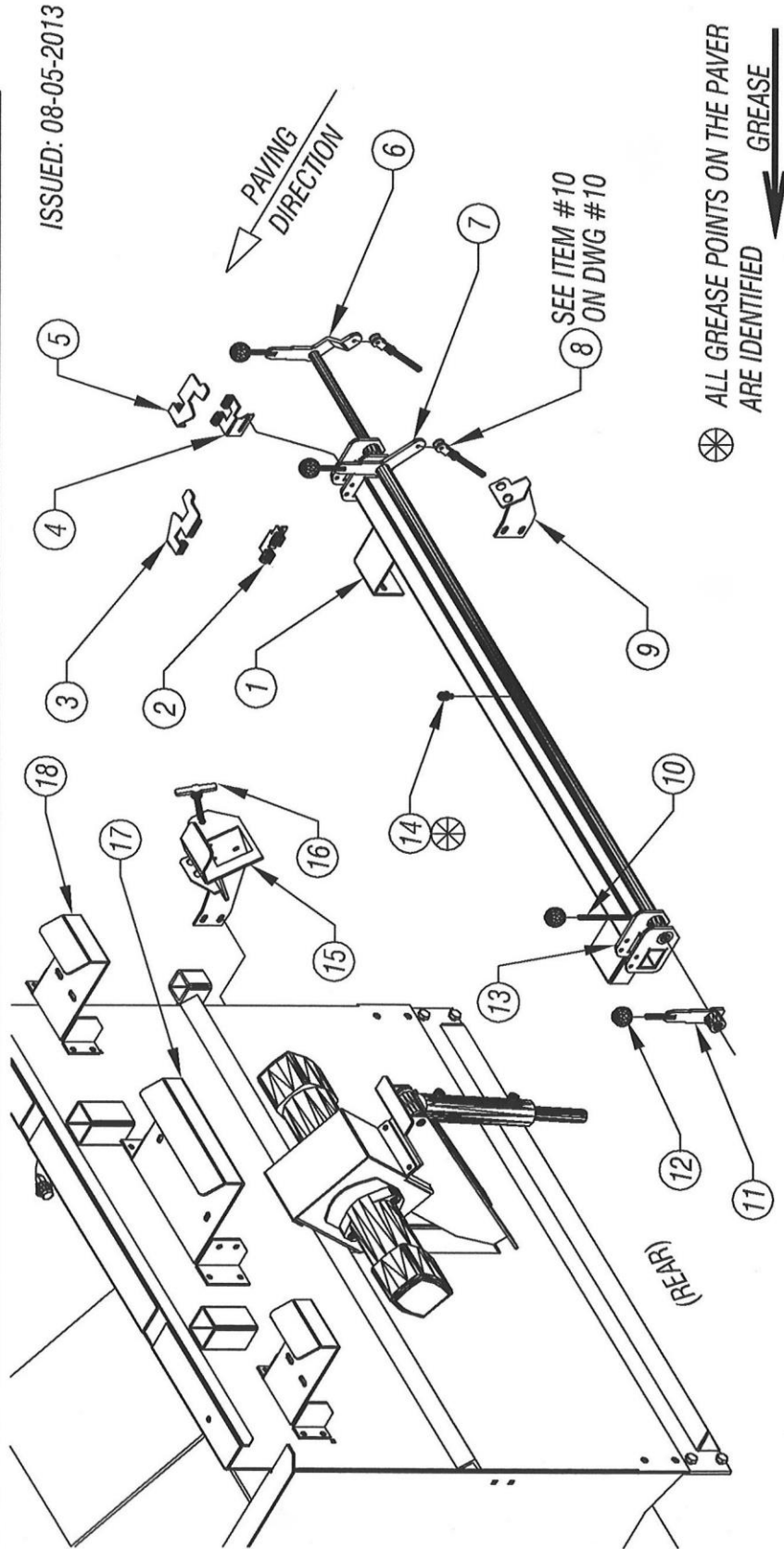

TP44 - DWG #9

ITEM	DESCRIPTION	PART NO	QTY	ITEM	DESCRIPTION	PART NO	QTY
1	ENGINE, HATZ - 14HP (SUPRA DIESEL)	0337550	1	8	TANDEM PUMP, SPLINE SHAFT	0330212	1
2	EXHAUST PIPE	0237558	1	9	LEVER, PUMP ACTUATOR	0433250	2
3	RUBBER MOUNT- (2 DIA x 1" THICK)	STOCK	4	10	PUSH/PULL CABLE ASSY (TRACK DRIVE)	0308036	2
4	SPACER, ENGINE MOUNT (STEEL)	0449281	4	11	MOUNT, PUMP FWD/REV CABLE ASSY	0145187	1
5	RUBBER MOUNT	0376339	2	12	COVER, FRAME SIDE, LEFT	0471291	1
6	BRACKET, DUAL PUMP MOUNTING-REAR	0288026	1	13	COVER, FRAME SIDE, RIGHT	0471292	1
7	DUAL PUMP, SPLINE SHAFT	0330213	1	14	FRAME, BASE	0219525	1

ISSUED: 08-05-2013

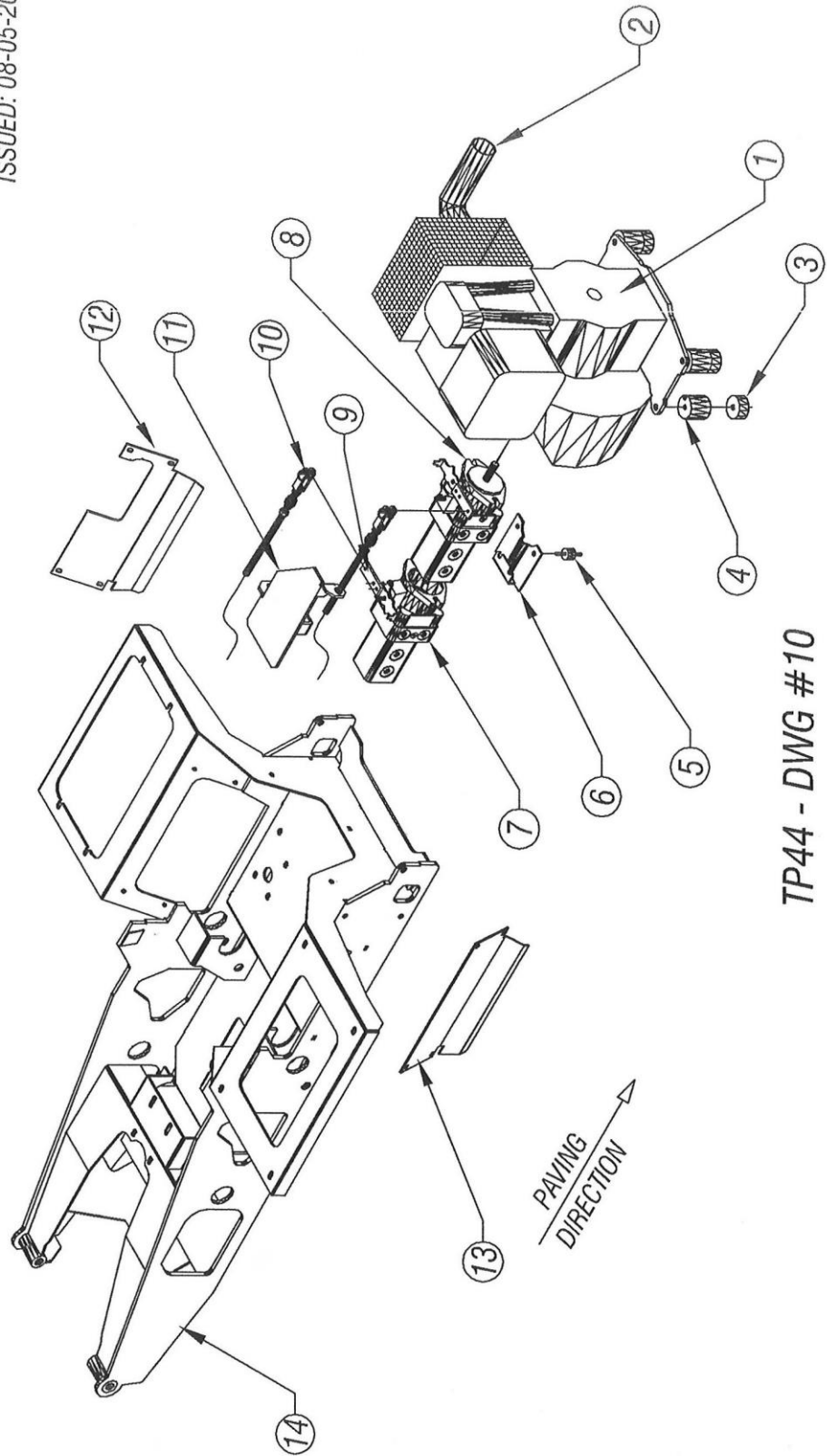

TP44 - DWG #10

ITEM	PART DESCRIPTION	PART#	QTY
1	HYD PUMP #1, (FRONT)	0330213	1
2	HYD PUMP #2, (TANDEM PUMP)	0330214	1
3	HYD PUMP #3, (AUX. PUMP)	0330212	1
4	FLOW DIVIDER, LOWER	0330215	1
5	FLOW DIVIDER, UPPER	0330215	1
6	CHECK VALVE	0330217	1
7	HYD DRIVE MOTOR (TRACKS)	0330169	2
8	HYD CYLINDER, (DUMP INNER)	0330158	2
9	HYD CYLINDER, (FLOW CONTROL)	0330220	2
10	HYD CYLINDER, (SCREED)	0330157	1
11	HYD MOTOR, (AUGERS)	0330209	2
12	HYD CYLINDER, (R & L END GATE)	0330219	2
13	MANUAL VALVE, (SINGLE SECTION)	0330210	2
14	MANUAL VALVE, (5 SECTIONS)	0330255	1
15	HYD OIL FILTER WITH HOUSING	0318022	1
16	HYD OIL FILTER, HOUSING ONLY	0318039	1
17	HYD OIL FILTER, FILTER ONLY	0318023	1

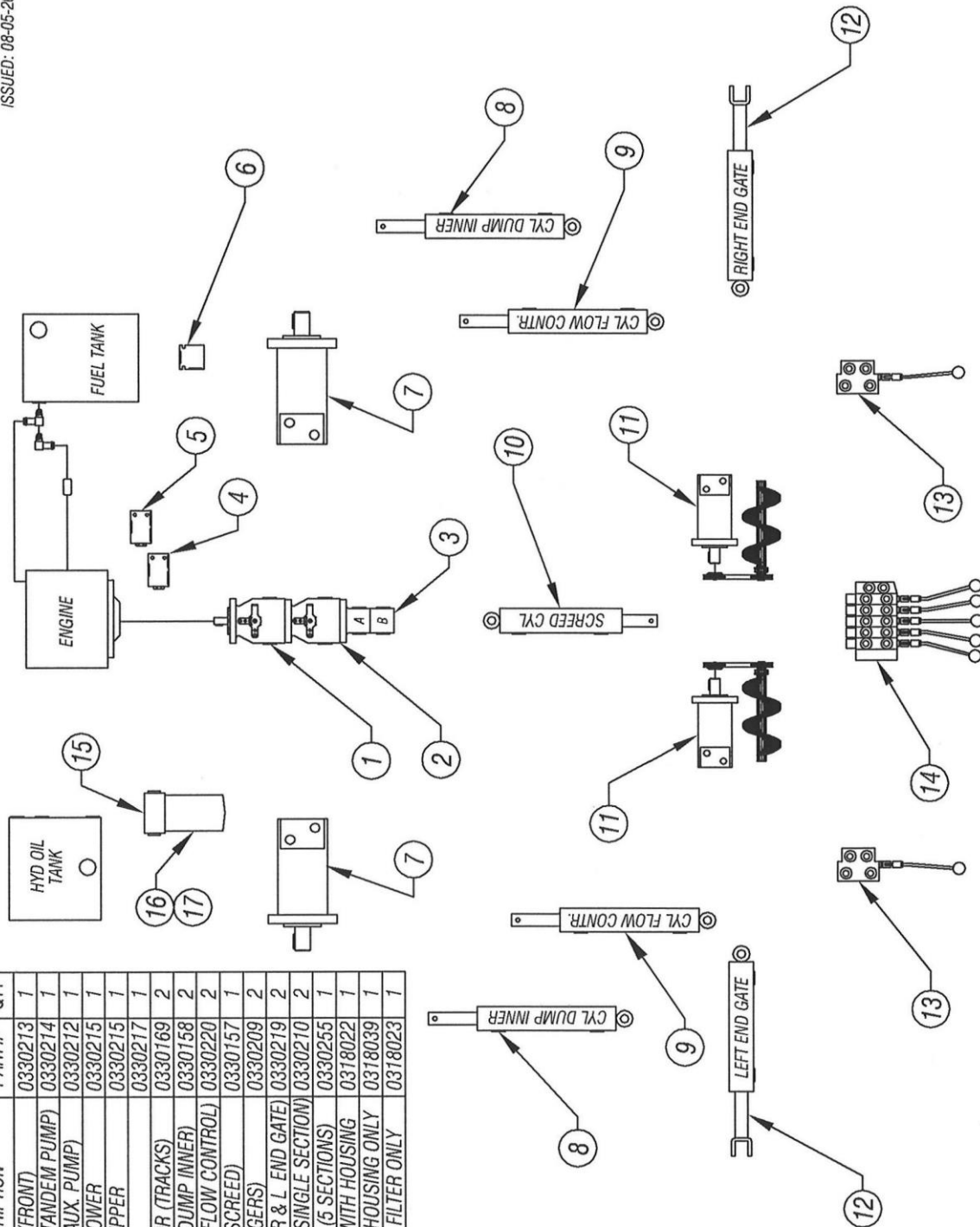

HYDRAULIC COMPONENTS
TP44 - DWG #11

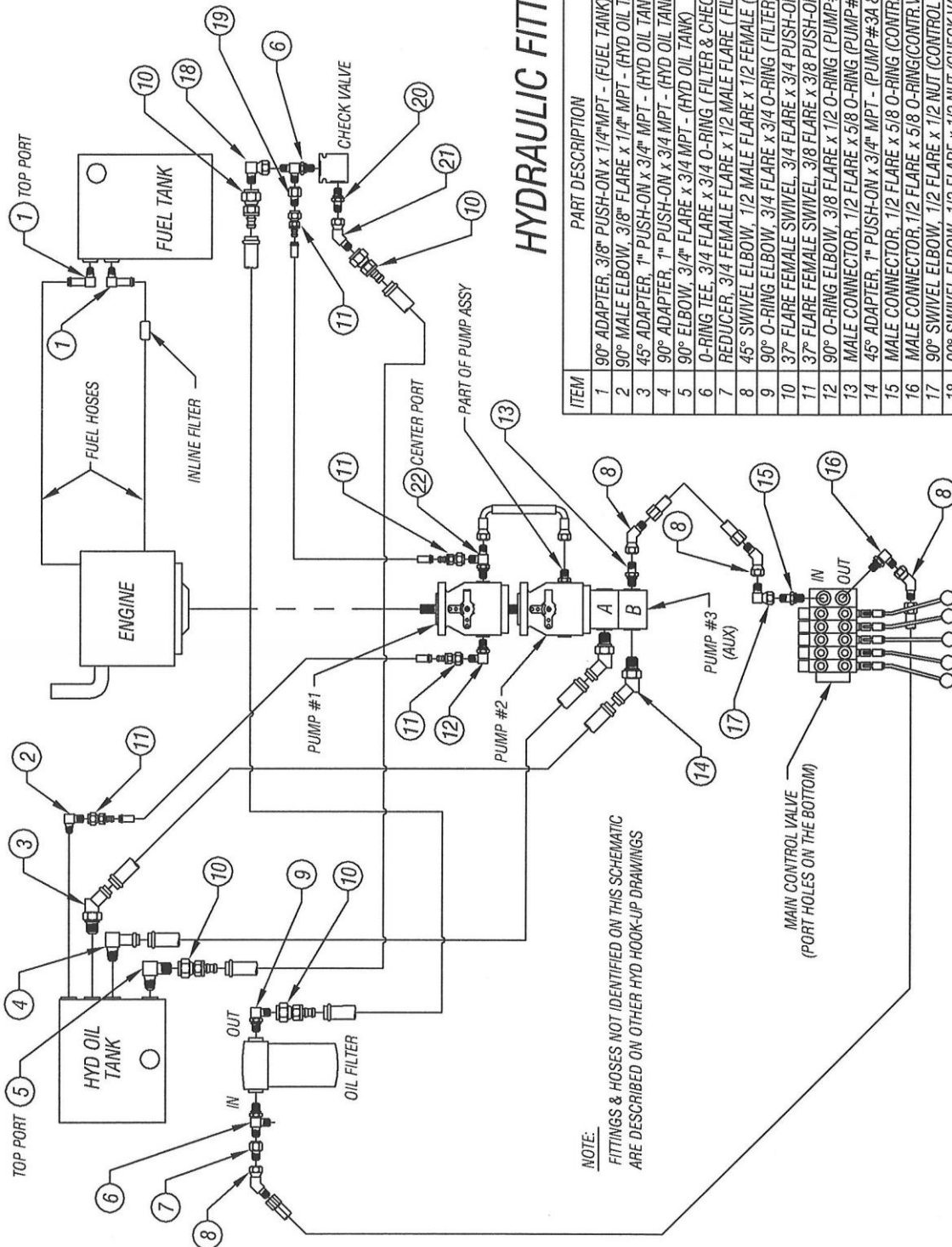

NOTE:
FITTINGS & HOSES NOT IDENTIFIED ON THIS SCHEMATIC
ARE DESCRIBED ON OTHER HYD HOOK-UP DRAWINGS

HYDRAULIC FITTINGS

ITEM	PART DESCRIPTION	PART#	QTY
1	90° ADAPTER, 3/8" PUSH-ON x 1/4" MPT - (FUEL TANK)	0317269	2
2	90° MALE ELBOW, 3/8" FLARE x 1/4" MPT - (HYD OIL TANK)	0317046	2
3	45° ADAPTER, 1" PUSH-ON x 3/4" MPT - (HYD OIL TANK)	0317308	1
4	90° ADAPTER, 1" PUSH-ON x 3/4" MPT - (HYD OIL TANK)	0317168	1
5	90° ELBOW, 3/4" FLARE x 3/4" MPT - (HYD OIL TANK)	0317163	1
6	O-RING TEE, 3/4 FLARE x 3/4 O-RING (FILTER & CHECK VALVE)	0317307	2
7	REDUCER, 3/4 FEMALE FLARE x 1/2 MALE FLARE (FILTER)	0317219	1
8	45° SWIVEL ELBOW, 1/2 MALE FLARE x 1/2 FEMALE (FILTER)	0317033	4
9	90° O-RING ELBOW, 3/4 FLARE x 3/4 O-RING (FILTER)	0317289	1
10	3" FLARE FEMALE SWIVEL, 3/4 FLARE x 3/4 PUSH-ON	0317313	4
11	3" FLARE FEMALE SWIVEL, 3/8 FLARE x 3/8 PUSH-ON	0317295	4
12	90° O-RING ELBOW, 3/8 FLARE x 1/2 O-RING (PUMP #1)	0317044	1
13	MALE CONNECTOR, 1/2 FLARE x 5/8 O-RING (PUMP #3B)	0317027	1
14	45° ADAPTER, 1" PUSH-ON x 3/4" MPT - (PUMP #3A & #3B)	0317308	2
15	MALE CONNECTOR, 1/2 FLARE x 5/8 O-RING (CONTR VALVE-IN)	0317027	1
16	MALE CONNECTOR, 1/2 FLARE x 5/8 O-RING (CONTR VALVE-OUT)	0317027	1
17	90° SWIVEL ELBOW, 1/2 FLARE x 1/2 NUT (CONTROL VALVE)	0317055	2
18	90° SWIVEL ELBOW, 1/2 FLARE x 1/2 NUT (CHECK VALVE-IN)	0317237	1
19	REDUCER, 3/4 FEMALE FLARE x 3/8 MALE FLARE (CONTR. VALVE)	0317310	1
20	MALE CONNECTOR, 3/4 FLARE x 3/4 O-RING (CHECK VALVE)	0317309	1
21	45° SWIVEL ELBOW, 3/4 M. FLARE x 3/4 FEMALE (CHECK VALVE)	0317246	1
22	O-RING TEE, 3/8" FLARE x 3/8" O-RING (PUMP #1)	0317095	1

HYDRAULIC HOOK-UP
TP44 - DWG #12

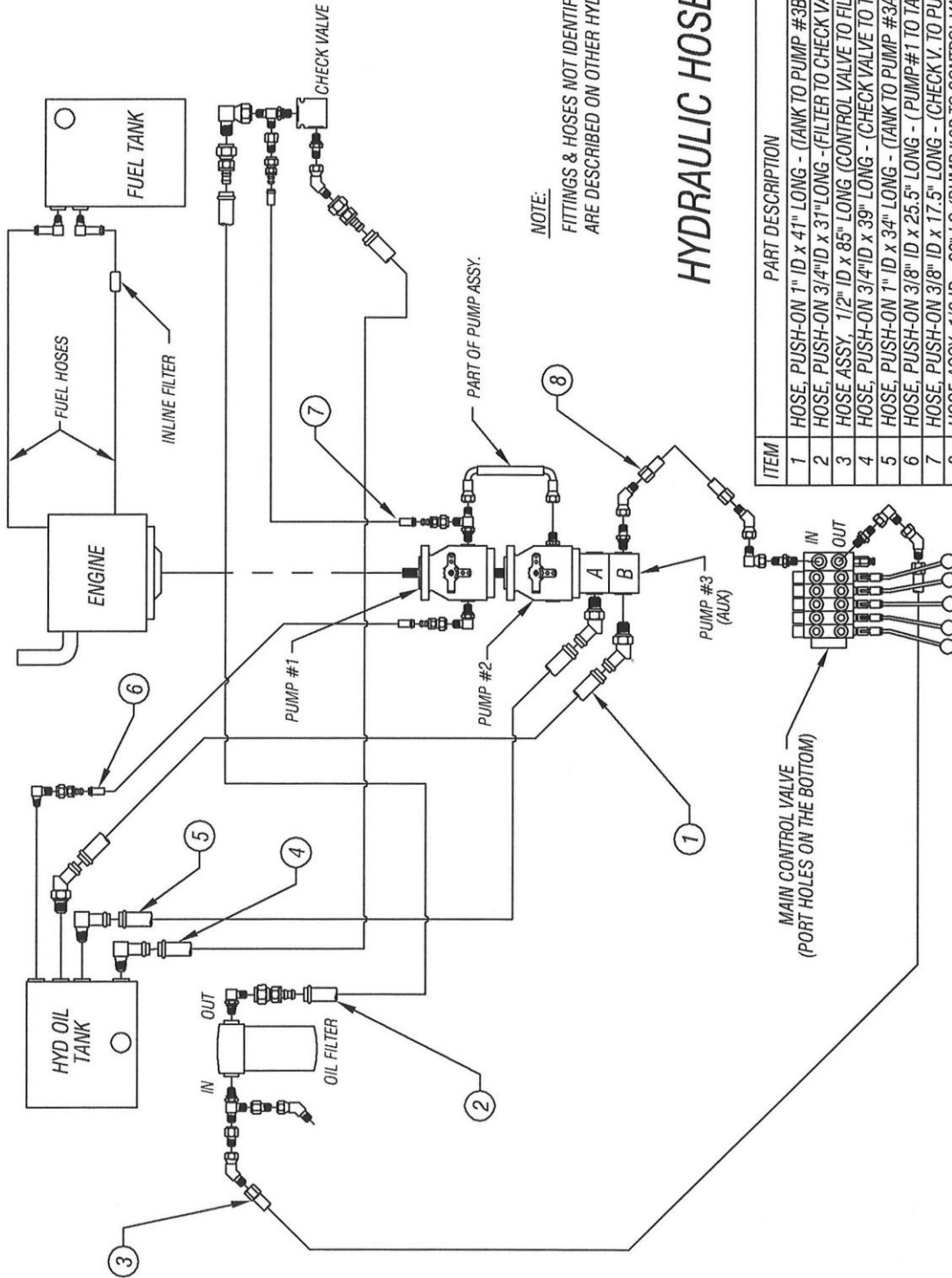

NOTE:
FITTINGS & HOSES NOT IDENTIFIED ON THIS SCHEMATIC
ARE DESCRIBED ON OTHER HYD HOOK-UP DRAWINGS

HYDRAULIC HOSES

ITEM	PART DESCRIPTION	PART #	QTY
1	HOSE, PUSH-ON 1" ID x 41" LONG - (TANK TO PUMP #3B)	BULK	1
2	HOSE, PUSH-ON 3/4" ID x 31" LONG - (FILTER TO CHECK VALVE)	BULK	1
3	HOSE ASSY, 1/2" ID x 85" LONG (CONTROL VALVE TO FILTER)	0327355	1
4	HOSE, PUSH-ON 3/4" ID x 39" LONG - (CHECK VALVE TO TANK)	BULK	1
5	HOSE, PUSH-ON 1" ID x 34" LONG - (TANK TO PUMP #3A)	BULK	1
6	HOSE, PUSH-ON 3/8" ID x 25.5" LONG - (PUMP#1 TO TANK)	BULK	1
7	HOSE, PUSH-ON 3/8" ID x 17.5" LONG - (CHECK V. TO PUMP#1)	BULK	1
8	HOSE ASSY, 1/2 ID x 90" LG (PUMP #3B TO CONTROL VALVE)	0327411	1

HYDRAULIC HOOK-UP
TP44 - DWG #13

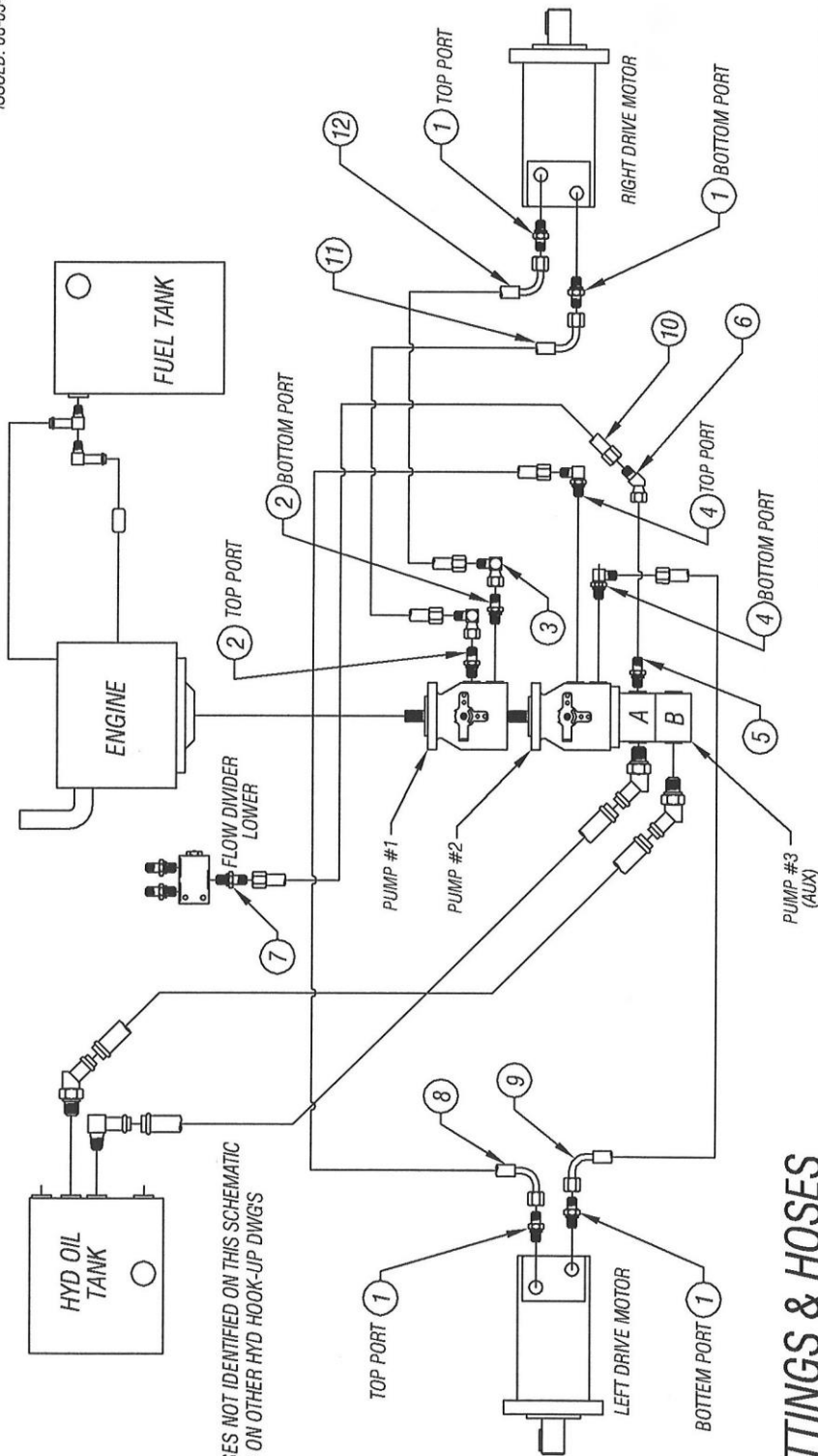

NOTE:
FITTINGS & HOSES NOT IDENTIFIED ON THIS SCHEMATIC
ARE DESCRIBED ON OTHER HYD HOOK-UP DWGS

FITTINGS & HOSES RIGHT & LEFT DRIVE MOTORS

ITEM	PART DESCRIPTION	PART#	QTY
1	MALE CONNECTOR, 3/8" FLARE x 5/8" O-RING (DRIVE MOT.)	0317248	4
2	MALE CONNECTOR, 3/8" FLARE x 1/2" O-RING (PUMP #1)	0317173	2
3	90° ELBOW, 3/8" FLARE x 3/8" NUT (PUMP #1)	0317006	2
4	90° ELBOW, 3/8" FLARE x 1/2" O-RING (PUMP #2)	0317044	2
5	MALE CONNECTOR, 1/2" FLARE x 5/8" O-RING (PUMP #3A/B)	0317027	2
6	45° SWIVEL ELBOW, 1/2" FLARE x 1/2" O-RING (PUMP #3A)	0317033	1
7	MALE CONNECTOR, 1/2" FLARE x 1/2" O-RING (FLOW DIV#R)	0317030	3
8	HOSE ASSY, 3/8" ID x 24" LONG x 90° (PUMP #2 TO LFT.D/M)	0327432	1
9	HOSE ASSY, 3/8" ID x 25" LONG x 90° (LFT.D/M TO PUMP #2)	0327383	1
10	HOSE ASSY, 1/2" ID x 15.5" LONG (PUMP #3A TO FLW.DIV#R)	0327444	1
11	HOSE ASSY, 3/8" ID x 32" LONG x 90° (PUMP #1 TO RT.D/M)	0327460	1
12	HOSE ASSY, 3/8" ID x 31" LONG x 90° (RT.D/M TO PUMP #1)	0327410	1

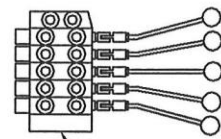

MAIN CONTROL VALVE
TRACK DRIVE MOTORS ARE CONTROLLED
BY CABLES TO HYD PUMPS
(SEE DWG #10)

HYDRAULIC HOOK-UP TP44 - DWG #14

ISSUED: 08-05-2013

NOTE:
FITTINGS & HOSES NOT IDENTIFIED ON THIS SCHEMATIC
ARE DESCRIBED ON OTHER HYD HOOK-UP DWGS

ITEM	PART DESCRIPTION	PART #	QTY
1	SWIVEL RUN TEE, 3/8" FLARE x 3/8" NUT (R. CYL)	0317257	2
2	90° ELBOW, 3/8" FLARE x 1/2" O-RING (RIGHT CYLINDER)	0317044	1
3	MALE CONNECTOR, 3/8" FLARE x 1/2" O-RING (CYL & DIVIDER)	0317173	3
4	45° O-RING ELBOW, 3/8" FLARE x 1/2" O-RING (CONR. VALVE)	0317280	2
5	HOSE ASSY, 3/8" ID x 89" LONG (C. VALVE TO RIGHT CYL TOP)	0327449	1
6	HOSE ASSY, 3/8" ID x 94.5" LONG (C. VALVE TO RIGHT CYL BTM)	0327448	1
7	HOSE ASSY, 3/8" ID x 12" LG x 90° (LEFT BTM TO RIGHT CYL BTM)	0327388	1
8	HOSE ASSY, 3/8" ID x 28" LONG (RHT CYL TOP TO LEFT CYL TOP)	0327074	1

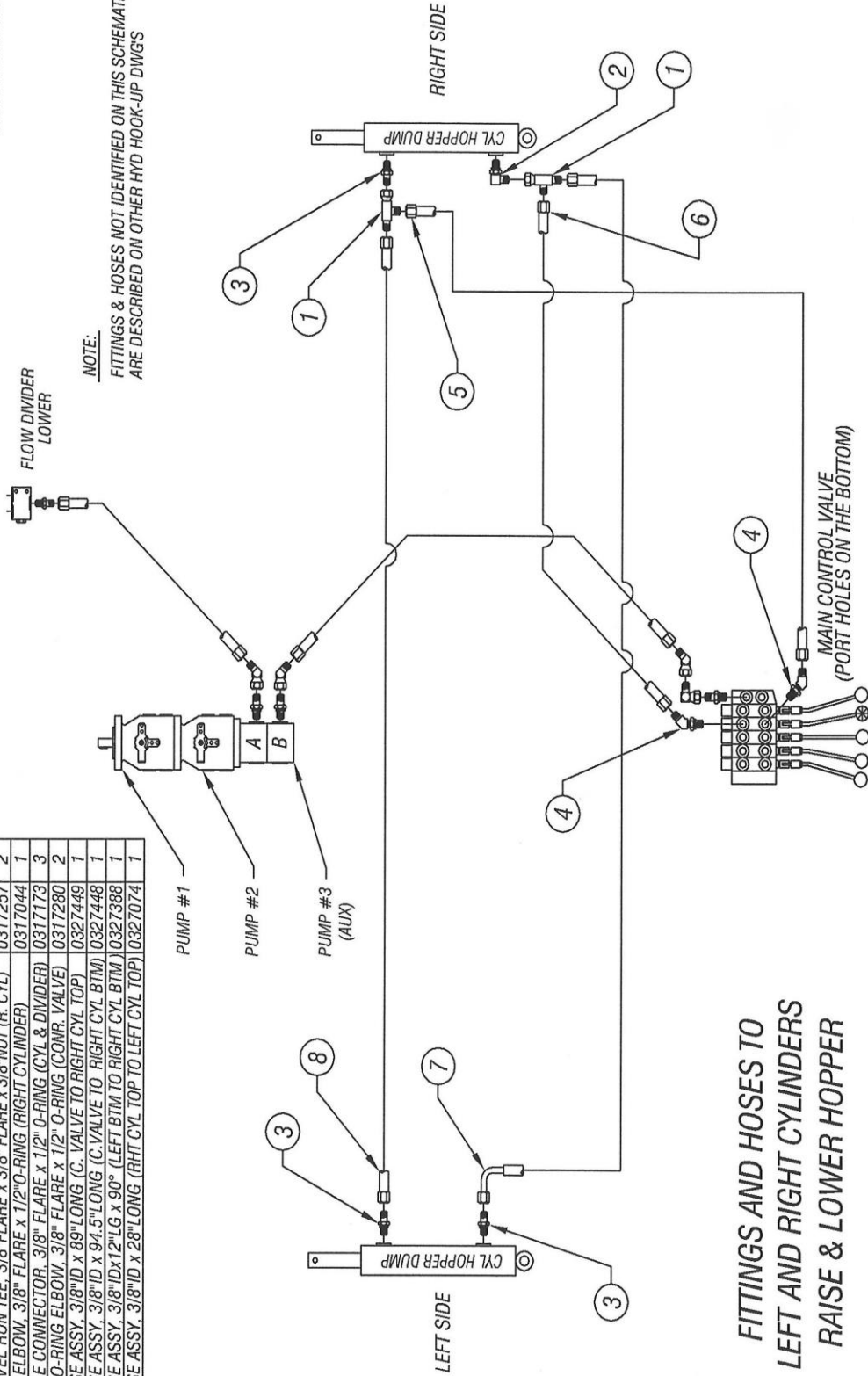

FITTINGS AND HOSES TO
LEFT AND RIGHT CYLINDERS
RAISE & LOWER HOPPER

HYDRAULIC HOOK-UP
TP44 - DWG #15

ITEM	PART DESCRIPTION	PART#	QTY
1	90° ELBOW, 3/8" FLARE x 3/8" O-RING (LEFT & RIGHT GATE CYL)	0317029	2
2	45° ELBOW, 3/8" FLARE x 3/8" O-RING (LEFT & RIGHT GATE CYL)	0317065	2
3	45° ELBOW, 3/8" FLARE x 1/2" O-RING (MAIN CONTROL VALVE)	0317280	4
4	HOSE ASSY, 3/8" ID x 53" LONG (CONTR. VALVE TO TRACK WIDTH CYL)	0327455	2
5	HOSE ASSY, 3/8" ID x 40" LONG (CONTR. VALVE TO TRACK WIDTH CYL)	0327075	2

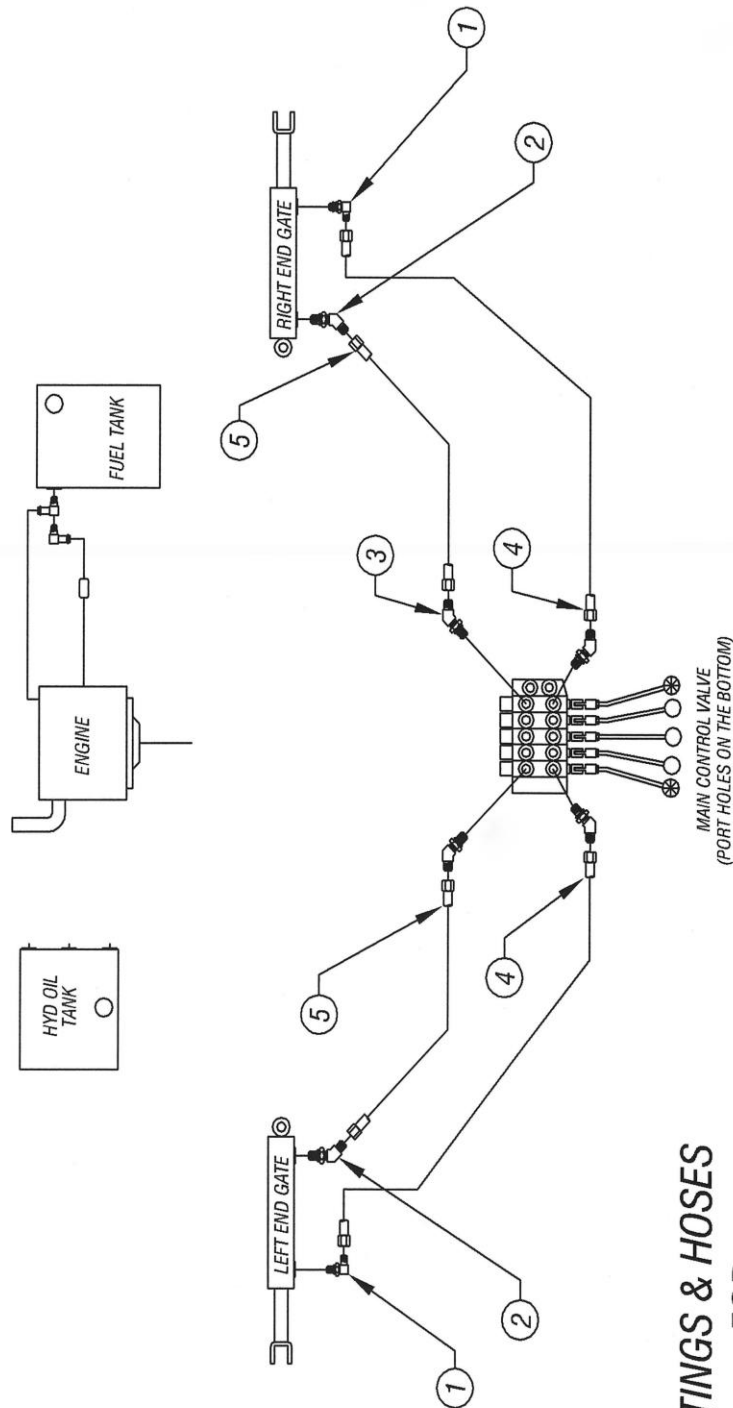

**FITTINGS & HOSES
FOR
LEFT & RIGHT END GATES**

**HYDRAULIC HOOK-UP
TP44 - DWG #16**

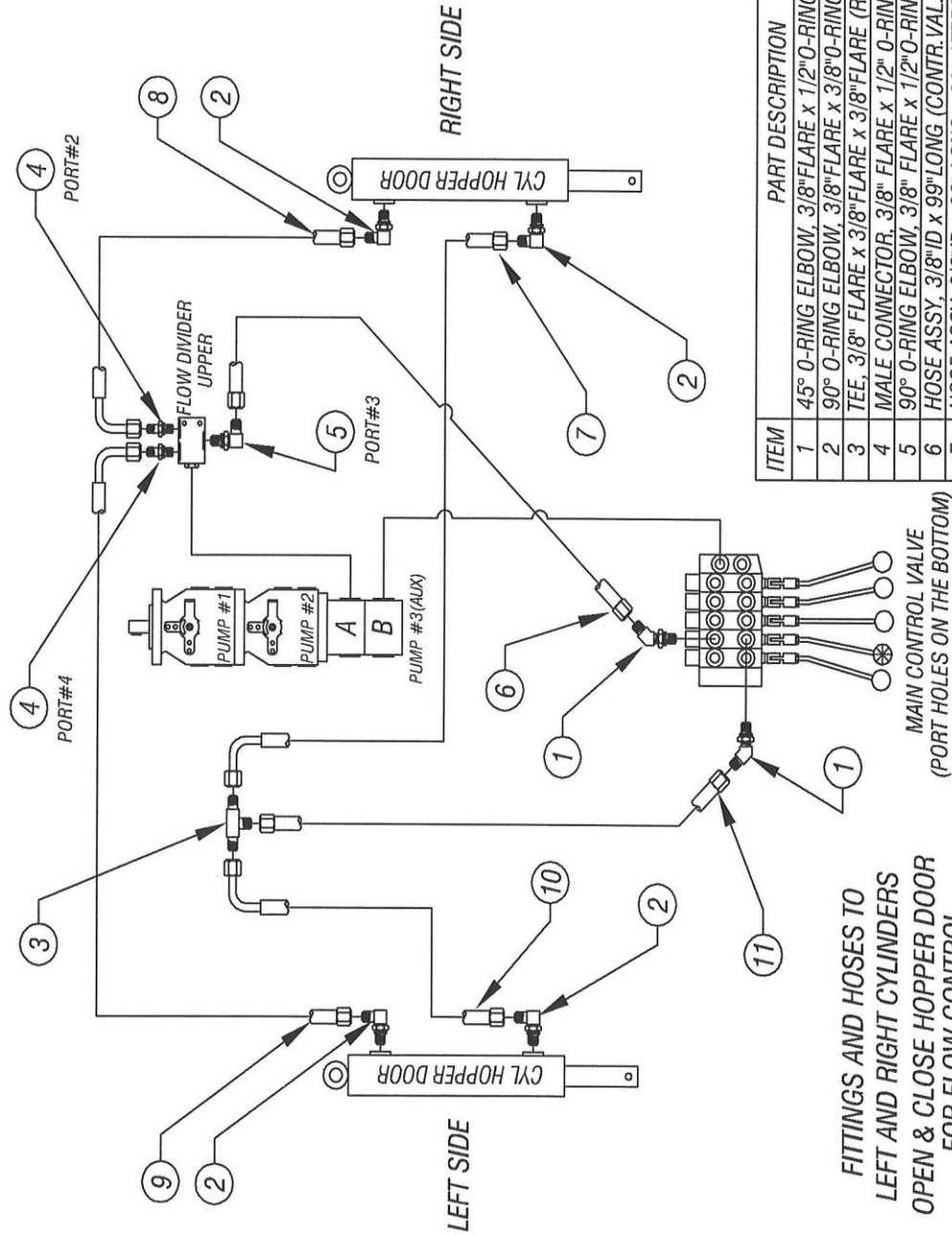

ITEM	PART DESCRIPTION	PART#	QTY
1	45° 0-RING ELBOW, 3/8" FLARE x 1/2" O-RING (CONTR. VALVE)	0317280	2
2	90° 0-RING ELBOW, 3/8" FLARE x 3/8" O-RING (CYL H. DOOR)	0317029	4
3	TEE, 3/8" FLARE x 3/8" FLARE x 3/8" FLARE (RETURN HOSES)	0317119	1
4	MALE CONNECTOR, 3/8" FLARE x 1/2" O-RING (FLOW DIVIDER)	0317173	2
5	90° 0-RING ELBOW, 3/8" FLARE x 1/2" O-RING (FLOW DIVIDER)	0317044	1
6	HOSE ASSY, 3/8" ID x 23" LONG (CONTR. VAL. TO FLOW DIVIDER)	0327450	1
7	HOSE ASSY, 3/8" ID x 99" LONG (TEE TO RIGHT SIDE CYL)	0327453	1
8	HOSE ASSY, 3/8" ID x 17.5" LONG x 90° (TEE TO RIGHT SIDE CYL)	0327459	1
9	HOSE ASSY, 3/8" ID x 13.5" LONG x 90° (FLOW DIV. TO LEFT CYL)	0327458	1
10	HOSE ASSY, 3/8" ID x 24.5" LONG x 90° (TEE TO LEFT SIDE CYL)	0327452	1
11	HOSE ASSY, 3/8" ID x 104.5" LONG (TEE TO CONTROL VALVE)	0327451	1

FITTINGS AND HOSES TO
LEFT AND RIGHT CYLINDERS
OPEN & CLOSE HOPPER DOOR
FOR FLOW CONTROL

MAIN CONTROL VALVE
(PORT HOLES ON THE BOTTOM)

HYDRAULIC HOOK-UP

TP44 - DWG #17

ITEM	PART DESCRIPTION	PART #	QTY
1	45° ELBOW, 3/8" FLARE x 1/2" O-RING (MAIN CONTROL VALVE)	0317280	2
2	45° O-RING ELBOW, 3/8" FLARE x 3/8" O-RING (SCREED CYLIND.)	0317065	1
3	90° O-RING ELBOW, 3/8" FLARE x 3/8" O-RING (SCREED CYLIND.)	0317029	1
4	HOSE ASSY, 3/8" ID x 30" LG (FWD CONTR. PORT TO CYL BTM)	0317337	1
5	HOSE ASSY, 3/8" ID x 35" LG (REAR CONTR. PORT TO CYL TOP)	0327454	1
6	HOSE ASSY, 1/2" ID x 15.5" LONG (PUMP #3A TO FLOW DIVID'R)	0327444	1

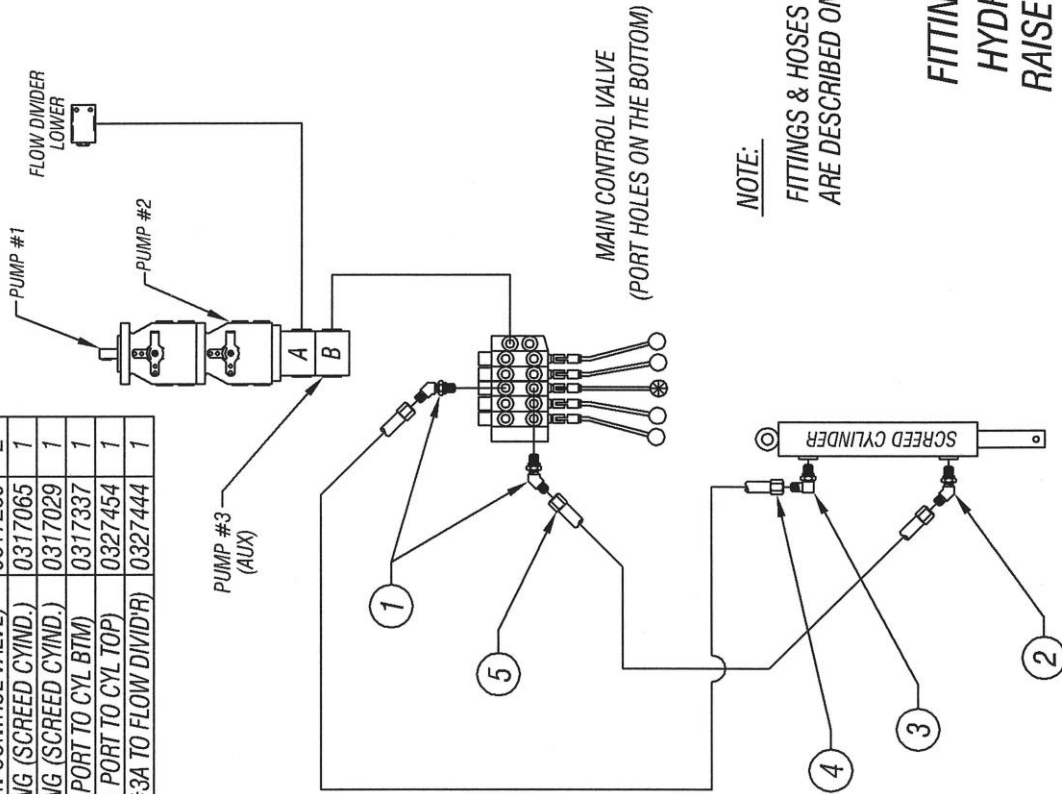

NOTE:

FITTINGS & HOSES NOT IDENTIFIED ON THIS SCHEMATIC
ARE DESCRIBED ON OTHER HYD HOOK-UP DRAWINGS

**FITTINGS AND HOSES TO
HYDRAULIC CYLINDER
RAISE & LOWER SCREED**

HYDRAULIC HOOK-UP
TP44 - DWG #18

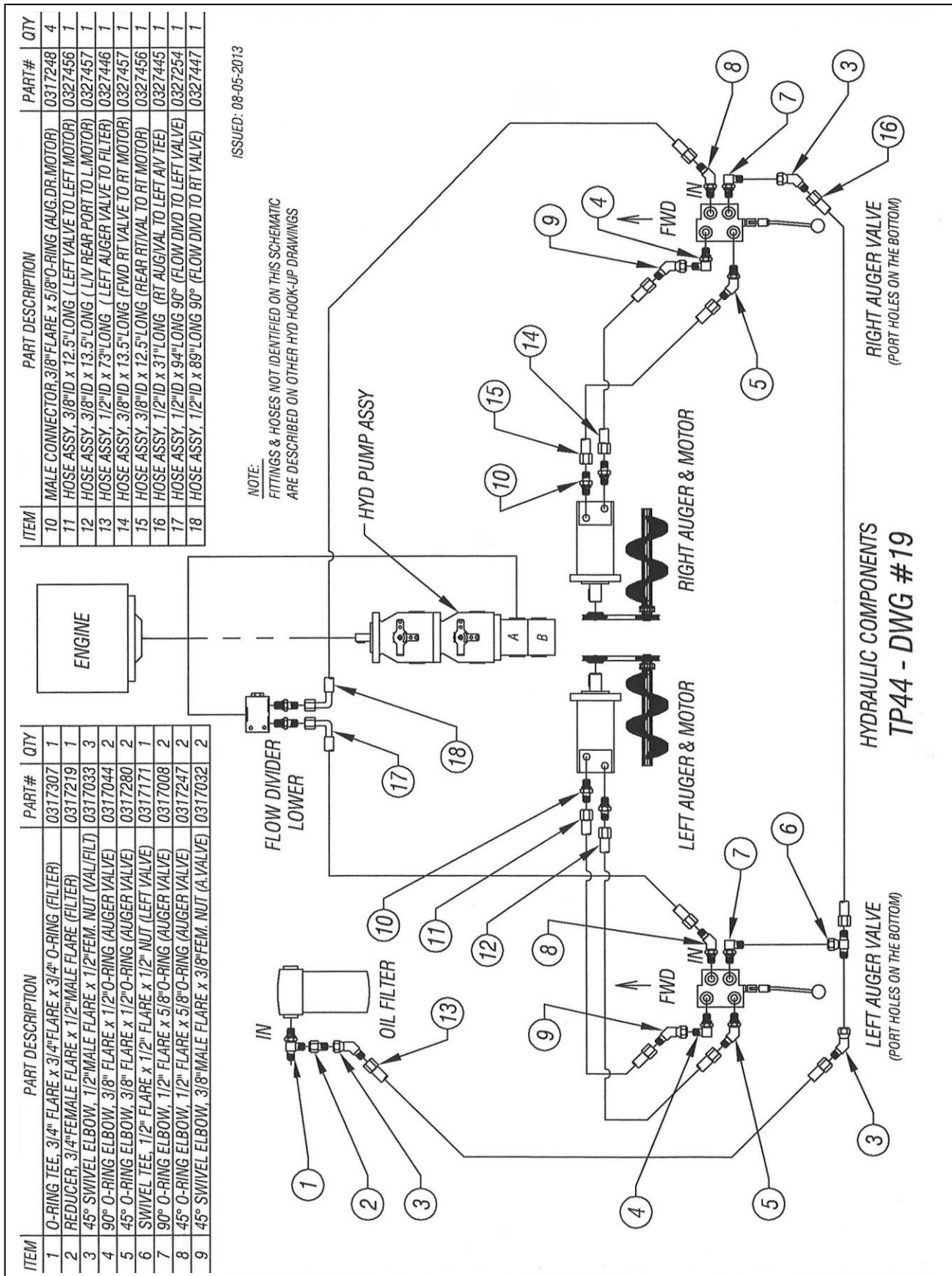

TRACK PAVER OPERATION

IT IS HIGHLY RECOMMENDED TO USE ONLY SUPER GUARD 20W-50 HYD. OIL

READ THIS MANUAL BEFORE STARTING. NEVER LET ANYONE NOT PROPERLY TRAINED OPERATE THIS MACHINE. BE SURE NO ONE THAT IS NOT FAMILIAR WITH THE OPERATION OF THIS MACHINE IS IN THE VICINITY WHEN READY TO START UP THE UNIT.

Prior to Starting:

Drive controls **MUST** be in neutral and locked.

ALL packaging & shipping materials are removed.

ALL fluid levels are filled to manufacturer's specifications. (Check engine manual for proper levels)

CAUTION: TO STOP ENGINE PUSH THE THROTTLE IN!

Start Engine – Check Controls

- 1) Turn the throttle to unlock and pull to $\frac{3}{4}$ full.
- 2) Turn key to preheat and then to the start position.
- 3) Once the engine starts, turn and push the throttle in to just above idle.
- 4) Move the hopper raise/lower handle.
- 5) Move the screed raise/lower handle.
- 6) Move the hopper door, open/close.
- 7) Unlock the forward-reverse locks.
- 8) Move the travel levers a little to get the feel of the machine. Let the unit creep along slow walk to another control position and try to control the machine from different positions.
- 9) Move the tracks, open/close. **NOTE: THIS SHOULD ONLY BE MOVED WHILE THE UNIT IS TRAVELING.**
- 10) Raise the throttle and get used to driving and steering the machine.

Getting Ready to Pave

- 1) Oil the machine with environmentally friendly oil.
- 2) Assume you wish to pave to a depth of 2".
- 3) Lay 2" x 4" board under the screed and lower the screed cylinder till the chain is loose.
- 4) Adjust the screed screws till the screed is flat on the 2" x 4" then adjust it a little more so as to make it climb towards the hopper.
- 5) Adjust the end gates to the proper width. Attach the screed extensions if needed.
- 6) Open the cut off door in the hopper.
- 7) Fill the hopper with hot asphalt.
- 8) Move the machine forward a couple of feet. Let the hot material set under the screed.
- 9) After approximately 4-5 minutes you are ready to pave.
- 10) Only use the Hydraulic Cylinder to raise the screed when you are moving the machine without paving. If you are paving, the cylinder should be in free float position.
- 11) Adjust to a slow paving speed. Only move as fast as you can to keep the hopper filled.
- 12) Adjust the screed screws as needed to get the proper thickness.
- 13) Maintain ground speed!

NOTE: THE TRICK TO THIS MACHINE IS TO KEEP A SLOW GROUND SPEED AND KEEP THE HOPPER $\frac{3}{4}$ FULL.

WARRANTY POLICY

Please remember to complete and return your Warranty Card and Dealer Delivery Report. Warranty Claims will not be considered if the Warranty Card and Dealer Delivery Report have not been returned to Salsco.

Your Salsco Commercial or Turf Equipment product is a commercial type product and is normally manufactured and sold for commercial or industrial use. **Salsco will, for the original purchaser, for one (1) year from the date of purchase (90 days if used for rental purposes) repair or replace, free of charge, any SALSCO part or parts found to be defective in material, workmanship or both.** Any transportation or shipping charges will be borne by the purchaser. If, during the warranty period stated above, the product does not function properly due to defect, simply contact Salsco and follow the Warranty Procedures included in this manual.

This warranty **does not** include:

- Incidental or consequential damages and is exclusive of any implied warranties.
- Normal maintenance parts, including, but not limited to hoses, chains, belts, filters, lubricants, etc.
- Parts or components, which are covered under the original manufacturer warranty, including, but not limited to engines, pumps, and motors.

WARRANTY PROCEDURE

In order for Salsco to consider your warranty claims in a timely manner you must follow the simple procedures listed below:

MACHINE OR PART FAILURE

- Call our service department for helpful instruction on how to correct or repair the problem. Preventive maintenance will also be suggested.
- When ordering parts for Warranty issues, you **MUST** retain possession of the old parts in question until notified with respect to returning the parts to Salsco or other disposition.
- Warranty Claims **MUST** be filed within 30-days from completion of the work performed. Contact our office for an electronic warranty claim form.
- Fill in all information requested on warranty claim form, a copy of which is included in this manual, (date of purchase, company name, address, etc.). List all parts used. Make sure part numbers are correct. You can obtain these from your manual. (include good description of problem; i.e. "leaking from spool" rather than "leaking").
- It is our goal to consider and reach a disposition on each Warranty Claim within 30-days from the date that it is received. Therefore it is important that you respond promptly to any request for further information. Claims with no response to inquiries will be closed as **"denied for lack of response"** 90-days from the date of request.
- Email, Fax or Send Warranty Claim form to our Warranty Department. – **Warranty on parts most often requires return of the parts that were replaced.** DO NOT DISCARD OLD PARTS UNTIL YOU HAVE RECEIVED A DETERMINATION AS TO WHETHER THESE PARTS MUST BE RETURNED.
- Our Warranty Department will contact and instruct you on how to return the Parts to Salsco on an RA #. Returns **MUST** be made within 30-Days from issuance of RA #. **FREIGHT CHARGES ON RETURN OF PARTS IS THE RESPONSIBILITY OF THE CUSTOMER.** Normal pre-delivery adjustments are not covered under warranty. Labor Warranties are based on reasonable time allowances as determined by Salsco, Inc. and paid at 75% of posted labor rate. **TRAVEL TIME IS NOT REIMBURSED UNDER THE WARRANTY POLICY.**
- Be sure to put the RA form inside the box that you are shipping back, also be sure to put on the outside of the box "Return of Goods" and the RA #.
- Ship returns via a traceable method such as UPS Ground Service. Be sure that the shipment is insured for the appropriate value. If uninsured parts are lost, we cannot issue a credit.

PLEASE NOTE: *Warranty forms should be filled out completely.*

PREVENTIVE MAINTENANCE IS YOUR BEST INSURANCE AGAINST EQUIPMENT FAILURE. BE SURE TO READ THIS MANUAL, ESPECIALLY THE MAINTENANCE, OPERATING AND CAUTION SECTIONS.

**SALSCO, INC., 105 School House Rd.
Cheshire, CT 06410
800-872-5726, 203-271-1682
203-271-2596 (Fax)
sales@salsco.com, www.salsco.com**

WARRANTY CLAIM FORM

SALSCO, INC.
105 School House Rd.
Cheshire, CT 06410

Phone: (203) 271-1682, (800) 872-5726
Fax: (203) 271-2596
Email: s.clark@salsco.com
Website: www.salsco.com

END OWNER**Date Submitted:**

Name:	Phone:	Work Order #:
Email:	Fax:	Office Use Only
Address:		Date Rec'd
		Cust ID:
		Salsco WC
		Salsco RA

PURCHASED FROM**Date Approved:**

Name:	Phone:	Date Rejected:
Email:	Fax:	Processed By:
Address:		Dir. Del Report on File: YES NO
		Warranty Card on File: YES NO
		Part(s) Total:

Equipment/Warranty Information (Must be complete)**Labor Total:**

Purchase Date:	Invoice #	Date Failed:	Total Approved:
Model #:	Serial #:	Repair Date:	Approved/Rejected:
			Name:
Hrs Used:	Primary Use:		Reason for Rejection:
Warranty Claim/Work Order#:			
Was a Salsco Return Authorization # issued for repairs or			
Return of Parts?	YES	NO	Suggested Preventative Maint:
Probable Cause of Failure:			

Work Performed/Comments on Repair:

Shop Labor Rate:						Submitted By:			
Total Labor Hours to Repair:						Printed Name:			
Parts Required for repair									
Salsco Part #: Description:						Qty.	Price Each	Total	Inv #
								\$	
								\$	
								\$	
								\$	

Fill in all information requested on warranty claim form.

INCOMPLETE FORMS CANNOT BE PROCESSED & WILL BE RETURNED

List all parts used. Make sure part numbers are correct. Any parts that you believe to be defective or any parts that break should be retained for possible inspection until after the warranty has been paid or part has been replaced.

SALESMAN ID # _____

SALES MANAGER'S NAME _____

800-872-5726, 203-271-1682
203-271-2596 (Fax)**SALSCO, INC.**
105 School House Road
Cheshire, CT 06410**www.salsco.com**
sales@salsco.com**DEALER DELIVERY REPORT**

MODEL:		SERIAL NO:		
DEALER:		CITY:	STATE:	ZIP:
PURCHASER:	ADDRESS:	CITY:	ST:	ZIP:
The undersigned dealer warrants that the above-described machine was carefully inspected, adjusted and prepared for delivery before delivery to the purchaser; that both the operation and maintenance of the machine were explained to the purchaser; and that a copy of the Owner's Instruction Manual were given to the purchaser and his attention called to Our Warranty and any operating instructions included in the manual and caution notes.		The undersigned purchaser certifies that the operation and maintenance of the above-described machine have been explained to him; acknowledges receipt of a copy of the Owner's Instruction Manual and Our Warranty Policy printed in said Instruction Manual and Caution Notes. I also understand that it is my responsibility to explain and make Salsco manuals available to new operators.		
DATE:		DATE:		
SIGN BY:		PURCHASER:		
PHONE:		SIGN BY:		
FAX:		PHONE:		
E-Mail:		EMAIL:		

MODEL:		SERIAL NO:		
<u>SALSCO LIMITED WARRANTY CARD</u>				
DATE PURCHASED:				
PURCHASER:	ADDRESS:	CITY:	ST:	ZIP:
EMAIL:		PHONE:		
DEALER:		STATE: CT		
Will this equipment be used commercially?		Yes	No	
Did Dealer service this equipment and instruct you in its care and safe operation?		Yes	No	
Did you receive an "Operation & Service Manual" and safety pamphlet?		Yes	No	
Signed		Purchaser		
<u>NOTICE:</u> IMPORTANT: THIS CARD MUST BE FILLED OUT COMPLETELY AND MAILED TO THE FACTORY WITHIN 10 DAYS OF PURCHASE DATE, OR YOUR LIMITED WARRANTY WILL BE VOIDED.				

SERVICE RECORD

If kept properly, this schedule will help track problems in the future.

[illegible]

MODEL # _____ S/N _____

DATE PURCHASED: _____