

**Quality of Workmanship
Innovative Design
Built to Last!**



STR-180 TURF ROLLER



MANUFACTURER OF OUTDOOR POWER EQUIPMENT

Products for Turf & Lawncare, Rental, Construction, Tree Care, Wood Processing, Nursery & Farm Industries

**3-1/2" - 18" Capacity, Gas, Diesel, & PTO Wood/Brush Chippers - Slab Chippers
Gas, Electric & Tow Behind Rollers - Tranz-Former Roller - CRV Core Recovery Vehicle
Mini-Paver - Mini-Track Paver - Cobra Curbers - Scorpion Router - Concrete Paver
Chipper Shredder Vacuums - Tailgate & Truckloader Vacuums
9 cu. yds. - 50 cu. yds. Per Hour, Electric, PTO & Diesel Powered Shaving Mills**



105 Schoolhouse Road
Cheshire, CT 06410 U.S.A.
800-872-5726 (Toll Free), 203-271-1682, 203-271-2596 (Fax)
www.salsco.com, sales@salsco.com

TABLE OF CONTENTS

MODEL STR-180 TURF ROLLER, 0009135

COVER & TABLE OF CONTENTS.....	Pages 1 – 2
STATEMENT OF FACT	Page 3
SPECIFICATIONS & OPTIONS.....	Page 4
MACHINE REGISTRATION	Page 5
OPERATING INSTRUCTIONS.....	Page 6
PARTS DIAGRAMS	Pages 7 – 16
Rotary Brush Cross Contamination System.....	Page 8
Power Pack Mounting.....	Page 15
Spike-Air Kit.....	Page 16
TORQUE CHART	Page 17
WARRANTY POLICY & PROCEDURE	Page 18
COPY OF WARRANTY CLAIM FORM.....	Pages 19 - 20
COPY OF WARRANTY CARD & DEALER DELIVERY REPORT.....	Page 21
SERVICE SCHEDULE LOG	Page 22

SALSCO, INC.

105 Schoolhouse Road
Cheshire, CT 06410 USA
800-872-5726, 203-271-1682
203-271-2596 (Fax)
www.salsco.com, sales@salsco.com

STATEMENT OF FACT

You have just purchased the highest quality, most dependable Roller on the market today. This unit has the ability to meet exact standards and perform for years with minimum downtime. **HOWEVER**, it cannot read nor will it understand this manual no matter how long you leave it on top of the machine.

It is your responsibility to read and understand this manual; it is also your responsibility to be certain this information is passed along to anyone who is expected to operate this equipment. Should you choose not to read, understand and pass along the information provided you, please expect equipment failure and possible injuries to persons around this equipment.

For the safety of the operator, it is imperative that this manual is carefully read and understood.

Once you have read this manual, it is your responsibility to be sure that all new operators read and understand this manual, especially all cautions stated.

As a manufacturer of equipment, we have a responsibility to design a safe piece of equipment. **NOTE:** The important safeguards and instructions in this manual are not meant to cover all possible conditions and situations that may occur. It must be understood that common sense, caution, and care are factors, which cannot be built into any product. These factors must be supplied by the person(s) caring for and operating this equipment.

ONLY YOU CAN PREVENT ACCIDENTS!

STR-180 - SPECIFICATIONS & FEATURES

TRACTOR CONTROL:	<u>Hoses:</u> Two (2) Quick disconnect hoses to connect to the tractor hydraulic implement. <u>Flow Control Valve:</u> Operator adjustable to maintain a steady flow of oil to the cylinders. <u>Cylinders:</u> Two (2) outer housing lift cylinders, 1.5" bore x 16" stroke; One (1) middle housing lift cylinder, 1.5" bore x 12" stroke; One (1) drop axle cylinder 1.5" bore x 12" stroke. <u>Handheld Transmitter:</u> Operator presses a button which will send a signal to the control valve to raise/lower rolls.
ROLLS:	Five (5) pivoting and floating steel rolls, 10-3/4" diameter x 40" long. Can be filled with up to 100 lbs. of water. Machined to within two thousandths of an inch concentricity. Extra-long beveled edges. Polyester powder coated black paint.
BEARINGS:	Taper lock 2-bolt flange bearings, greaseable.
GROUND PRESSURE:	Without Water: Approximately 6.6 P.S.I. With Water: Approximately 8.3 P.S.I.
FRAME:	3" x 3" x 1/4" wall tubular steel, 1/4" gussets, continuous weld.
ROLL HOUSINGS:	45" long, 7 gauge steel wraps with 3/8" thick end plates.
AXLES:	Two (2) steel, spindle type axles.
TIRES & WHEELS:	Four (4) tire & wheel assemblies. 18.5 x 8.5-8, load range C, 6 ply.
TONGUE:	2" x 3" x 1/4" tubular steel.
HITCH:	3-position, 4-bolt channel hitch specially designed, hydraulically operated, which allows the STR-180 to float independently of the tow vehicle.
COUPLER:	2" pin, steel farm type coupler, 10,000 lb. capacity.
TONGUE JACK:	2,000 lb. side-wind jack.
WARRANTY:	5-year limited warranty.
PAINT:	Orange, polyester powder coat paint provides excellent outdoor weatherability and offers protection against ultraviolet discoloration. All parts painted separately.
OPTIONS:	<u>Self-Contained Power Pack:</u> Includes 13HP Honda Engine, Hydraulic Pump, Hydraulic Filter, Hoses and Hydraulic Tank with Mounting Brackets. <u>Heavy Duty Cross Contamination Brush System:</u> Includes Rotary Brushes, Guards and Greaseable Bearings. <u>Spike-Air Kit:</u> Each roll includes Heavy Duty Spiker Frame, Rubber Enclosed Shaft, 39 Heat Treated Spiker Discs on 1" Centers and Rubber Washer Between Blades. LED Light Kit. Two Lights Mounted on Either Side with On/Off Switch.
DIMENSIONS:	Transport: Length: 9'5" Width: 8' Height: 7'8" Weight (without water): Approximately 2,080 lbs. Rolling: Length: 9'5" Width: 15' Weight (without water): Approximately 2,080 lbs

Specifications & Options Subject to Change Without Notice

REV. 2/28/2021

MACHINE REGISTRATION

MANUFACTURED BY:

SALSCO, INC.
105 Schoolhouse Rd., Cheshire, CT 06410
800-872-5726, 203-271-1682, 203-271-2596 (Fax)
sales@salsco.com www.salsco.com

THIS MANUAL COVERS MODEL(s): STR-180, Tow Behind Turf Roller

This company reserves the right to discontinue, add improvements to, or change the design of any model or product at any time without obligation to improve existing machines, either by changing the design or adding new parts.

It has been and will continue to be the policy of SALSCO to update existing machines at its own discretion. Whenever possible, new designs will be made in such a way that they can be "Retro Fit" if so desired.

Record in the space provided below the model and serial number of this unit. Please retain these numbers for future reference.

NO PARTS ORDERS will be accepted **WITHOUT A SERIAL NUMBER, MODEL NUMBER AND PART NUMBERS**. All part numbers are listed in this manual.

Serial Number

Model Number

NOTE: Be sure to complete your warranty card. This will ensure immediate processing of any warranty claims.

READ AND UNDERSTAND THIS MANUAL BEFORE STARTING THE MACHINE

Salsco STR-180 Tow Behind Roller is a tow behind, 15' wide radio-controlled roller. Options include Cross Contamination Rotary Brushes and Spiker Blades both of which are mounted to each roll. The STR-180 can also be purchased with an optional Power Pack. This option allows the STR-180 to be self-contained and needs only to be towed by a tow vehicle. As with all Salsco rollers, each roll floats independently of the total unit, allowing for 100% contact to any surface.

OPERATING INSTRUCTIONS

1) Base Machine Without Power Pack

- a. Back tractor to the machine and connect the tow bar.
- b. Connect the hydraulic hoses to the tractor.
- c. Connect the positive and negative clips to the tractor for lights and power to the radio control
- d. Stand clear of the STR-180.
- e. Press the wheels down button on the controller.
- f. The hitch should be adjusted so the STR-180 is level and the rolls clear the ground.
- g. Press the button to lower the rolls on the controller. Be SURE the wings are fully lowered.
- h. Raise the wheels so that the rolls are on the ground.
- i. Note, with the wheels in the raised position and the rolls al in the down position, the hitch lock arm is retracted. This allows the STR-180 to be towed and float over the undulations.

2) STR-180 With the Power Pack Option

- a. Check the hydraulic oil level.
- b. Check fuel and oil levels in the Honda engine.
- c. Connect to the tow unit.
- d. Repeat steps c. – i. as listed above.

3) STR-180 With Spiker Kit Option

- 4) With the wheels down and the rolls down, hold the handle for the raise/lower section of the spiker. Lower the spikers on all five rolls and lock the handle in the lower position. Each roll housing has its own raise-lower handle. When spiking the spikes will be lowered once on each roll housing. When the roll housing is raised or lowered for transport the spiker will raise or lower with the roll housing.
 - a. Raise the wheels and begin to roll.
 - b. **NOTE:** Limit turn to gradual turns with the spikers engaged.

5) STR-180 With Rotary Brush Cross Contamination System

The brushes are designed to be adjusted so they are 1/8" away from the roll. When doing heavy top dressing be sure to clean the brushes as needed.

6) General Maintenance

Grease all fittings once a week and clean the machine after each use. As with all machines look the unit over for lose bolts and hose connections.

REV	DESCRIPTION	DATE

ITEM	DESCRIPTION	PART No
1	TOW BEHIND TURF ROLLER	0009135

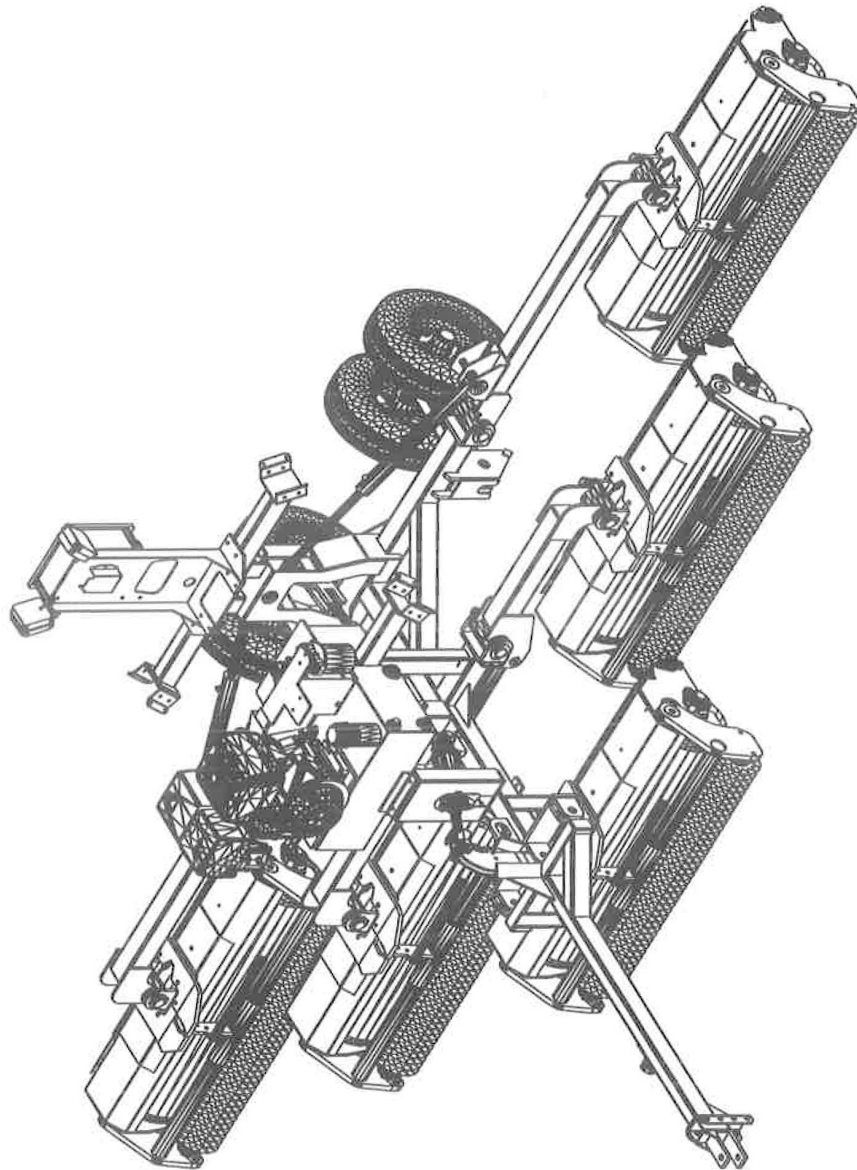

TOW BEHIND TURF ROLLER MODEL #STR-180- DWG # 1
ISSUED: MARCH 2021

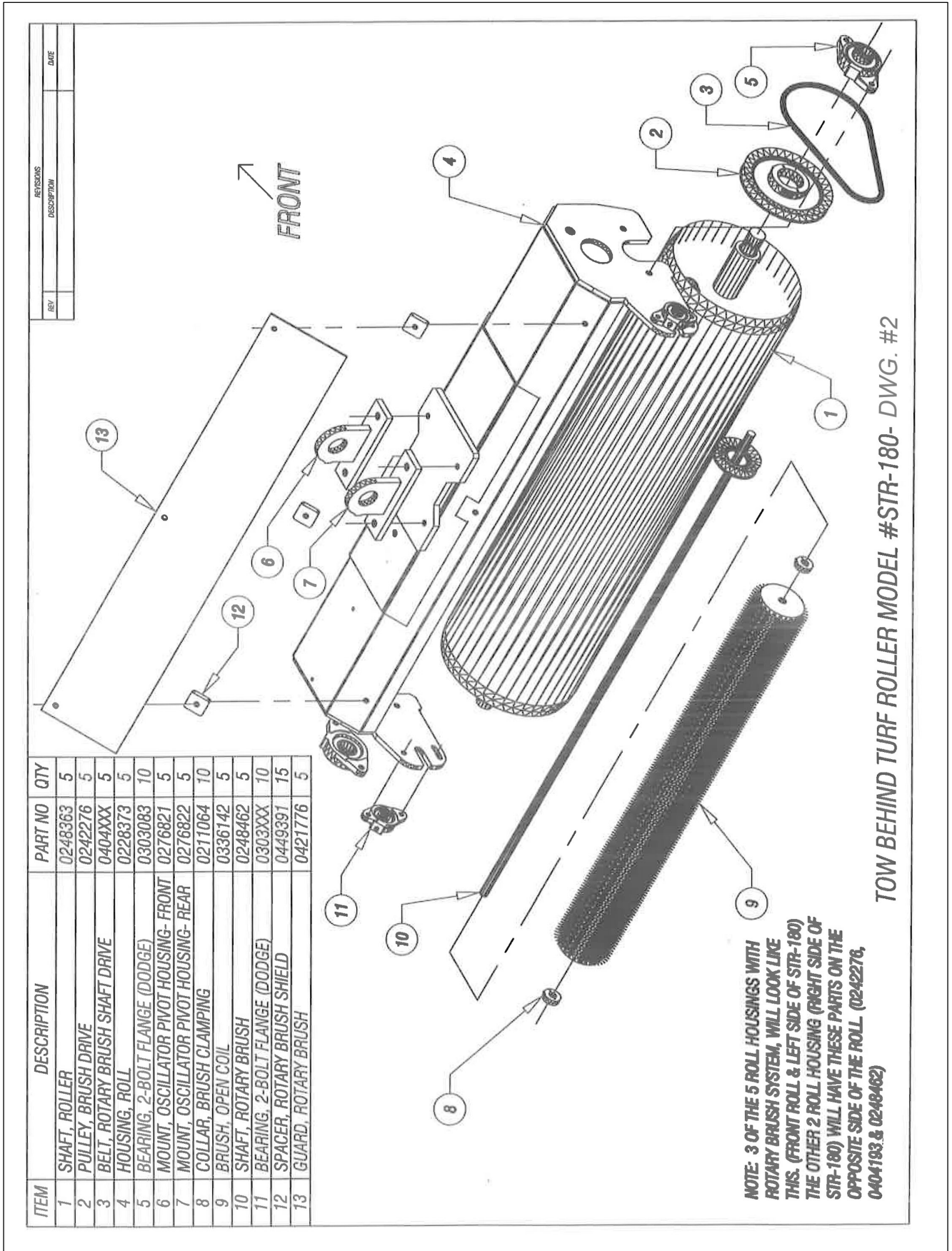

REV	DESCRIPTION	DATE

ITEM	DESCRIPTION	PART NO	QTY
1	FRAME, ARM ROLL PIVOTING- MIDDLE	0219608	2
2	FRAME, ARM ROLL PIVOTING- REAR	0219609	2
3	BEARING, ROLLER- CONE & CUP SET	0303089-0303090	16
4	O-RING	0343003	16
5	SHAFT, OSCILLATOR PIVOT HOUSING	0248358	4
6	LUG, NUT CAP 33MM	0338405	4

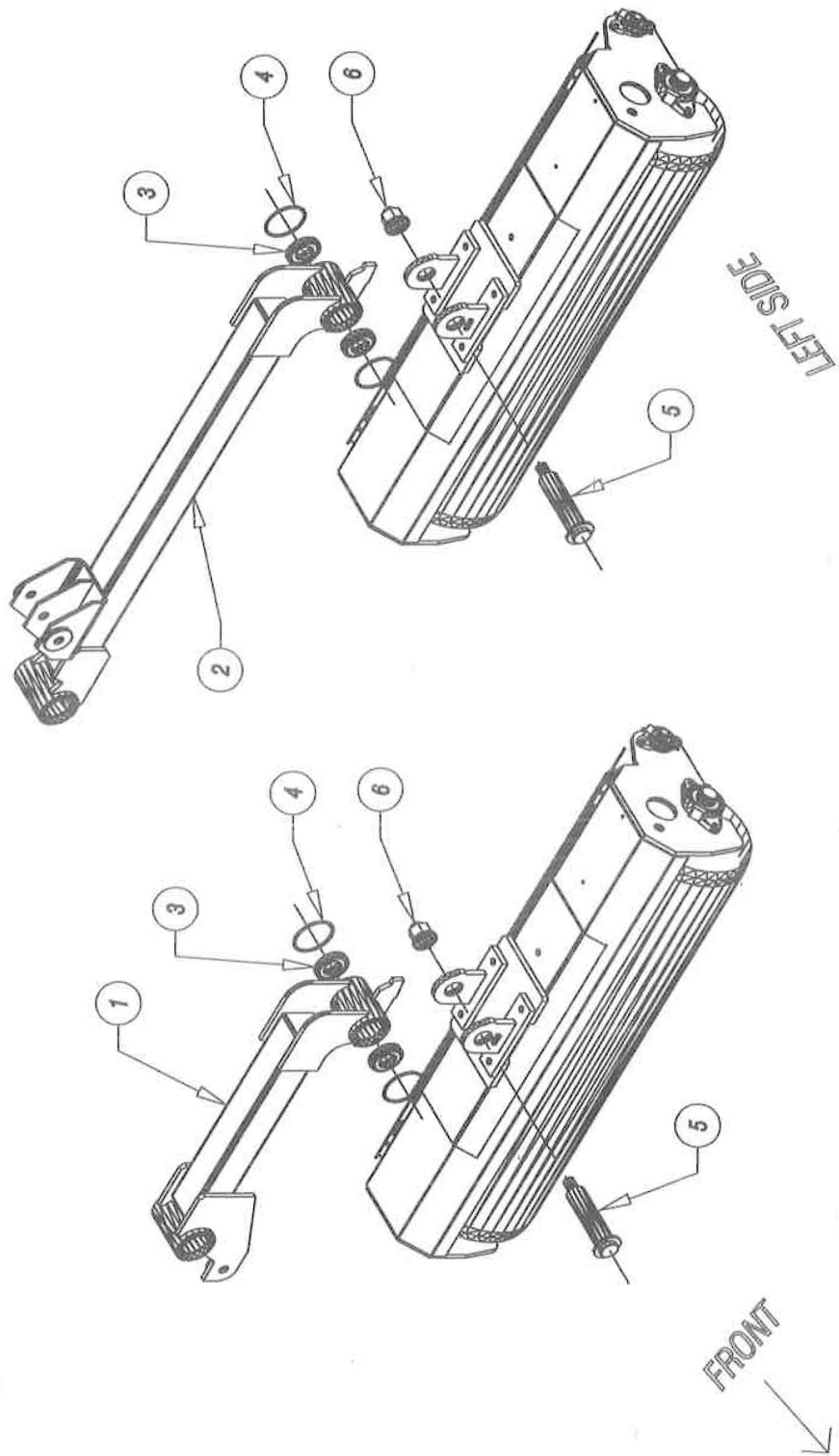

TOW BEHIND TURF ROLLER MODEL #STR-180- DWG. #3

REV	DESCRIPTION	DATE

3	O-RING	0343003	10
4	SHAFT, OSCILLATOR PIVOT HOUSING	0248358	1
5	SHAFT, ARM PIVOTING	0248461	4
6	SPACER, SIDE ARM PIVOT SHAFT- TOP	0449307	4
7	LUG, NUT CAP 33MM	0338405	5

ITEM	DESCRIPTION	PART NO	QTY
1	FRAME, STR-180	0219607	1
2	BEARING, ROLLER- CONE & CUP SET	0303038-0303094	10

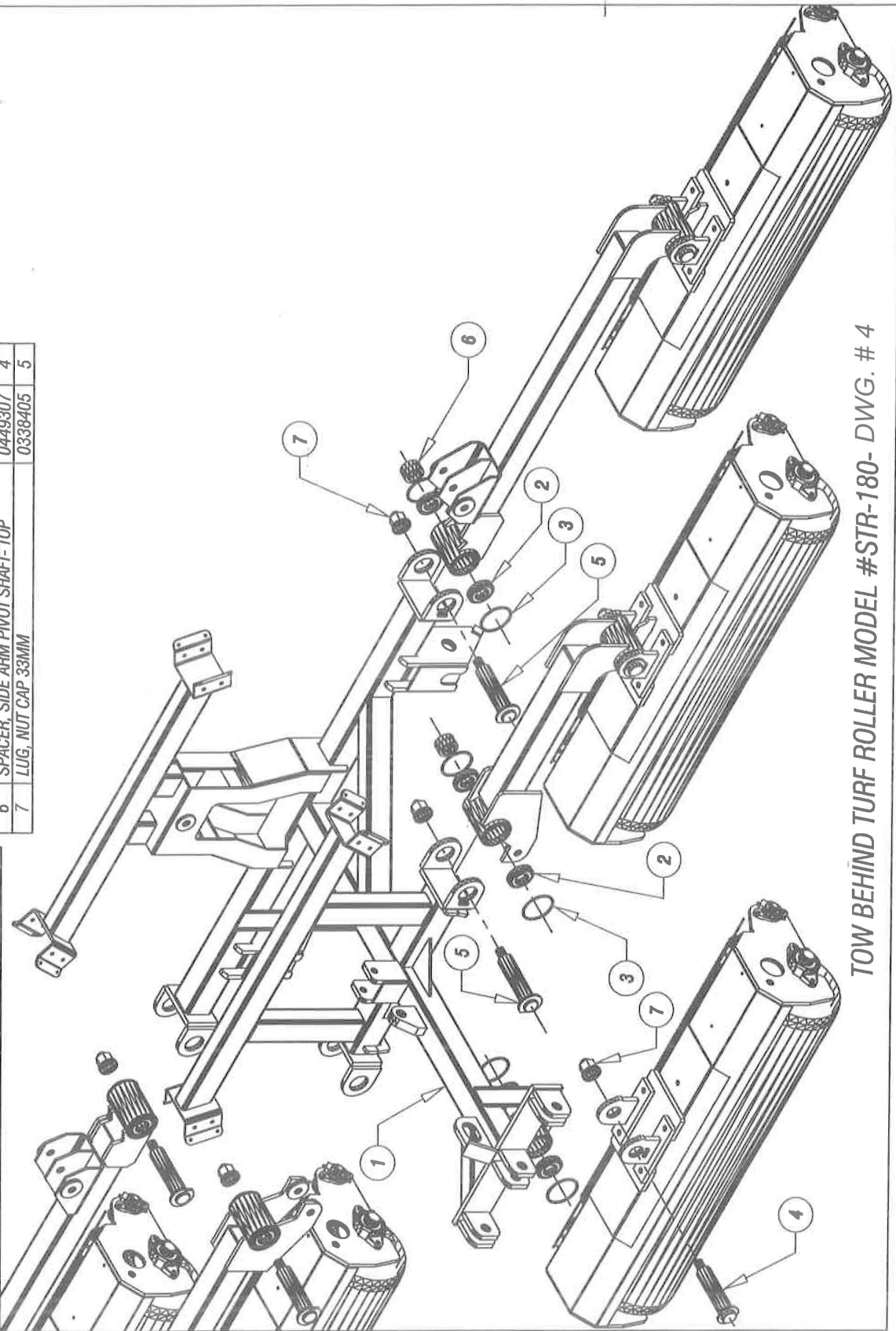

TOW BEHIND TURF ROLLER MODEL #STR-180- DWG. # 4

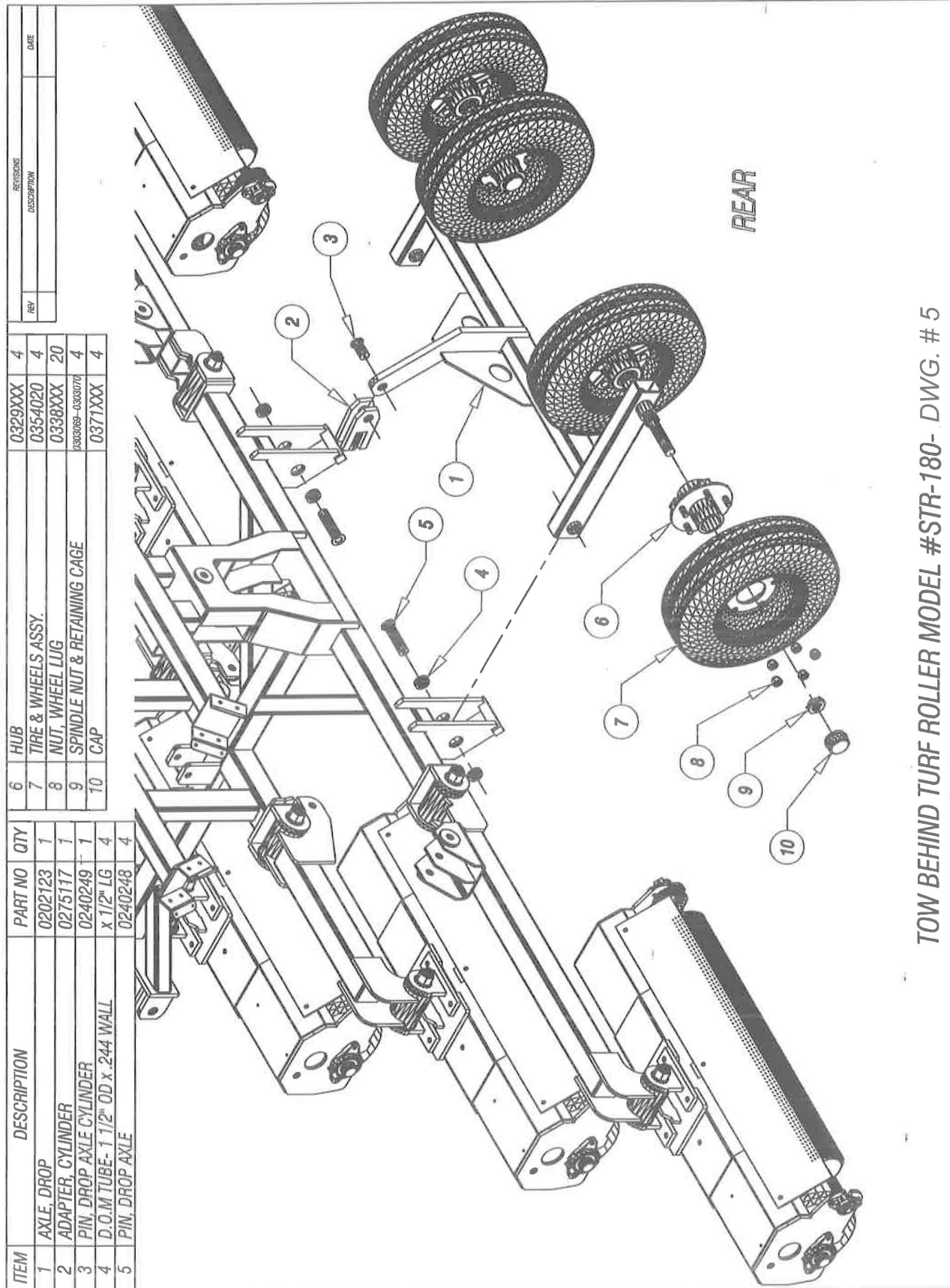

TOW BEHIND TURF ROLLER MODEL #STR-180- DWG. # 5

REV		DESCRIPTION	DATE

ITEM	DESCRIPTION	PART NO	QTY
1	TONGUE, STR-180 TOWFRAME	0225099	1
2	D.O.M TUBE- 1" O.D x .219 WALL	x 1 5/8" LG	2
3	LEVER, CYLINDER	0233355	1
4	PLATE, LEVER CYLINDER LOCKING	0492084	1
5	D.O.M TUBE- 1" O.D x .219 WALL	x 2 1/16 LG	1
6	PIN, TONGUE CYLINDER	0240253	1
7	JACK, 2000lb TOPWIND	0369005	1
8	HITCH, SUB-ASSY	0225032	1

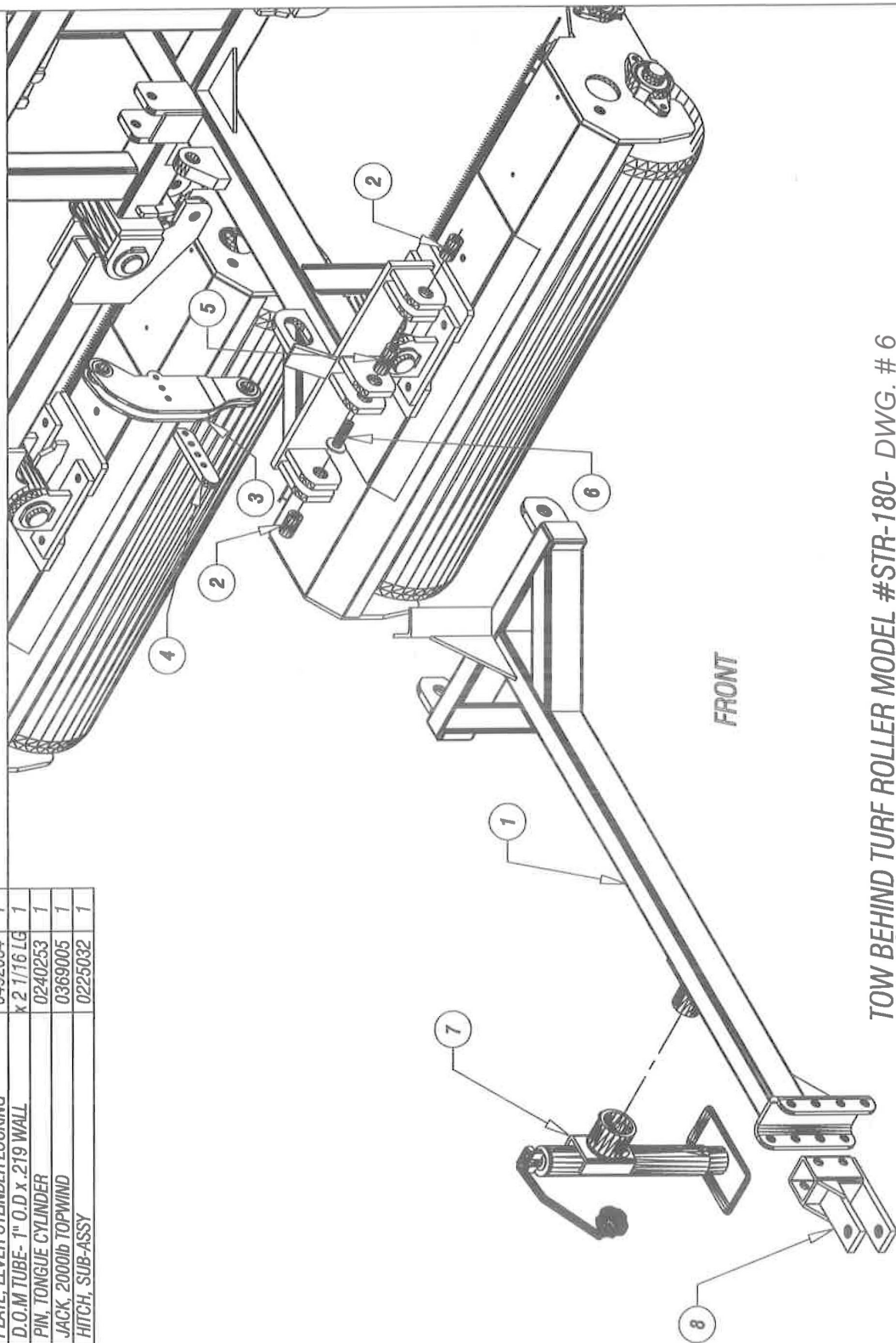

TOW BEHIND TURF ROLLER MODEL #STR-180- DWG. # 6

ITEM	DESCRIPTION	PART NO	QTY	REFERENCES		
				REV	DESCRIPTION	DATE
1	HYDRAULIC CYLINDER- CHIEF- 288-602	0330xxx	2	5	HYDRAULIC CYLINDER- CHIEF- 288-600	0330xxx
2	PIN, CYLINDER ARM- OUTER ARM	0240250	3	6	PIN, CYLINDER ARM- MIDDLE	0240251
3	HYDRAULIC CYLINDER- CHIEF- 287-204	0330220	1	7	HYDRAULIC CYLINDER- CHIEF- 211-301	0330xxx
4	PIN, TIRE CYLINDER	0240252	1			

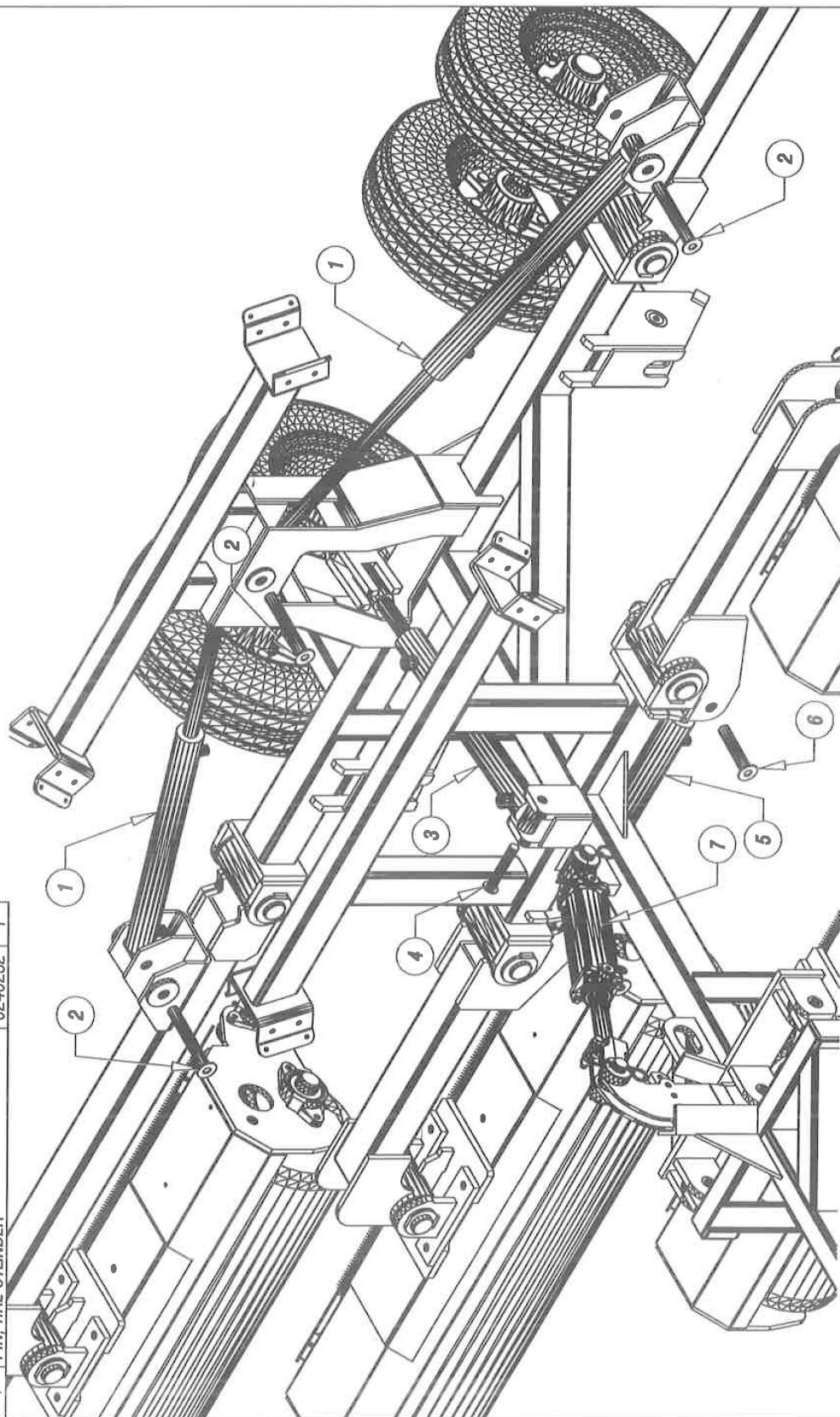

HYDRAULIC CYLINDERS
TOW BEHIND TURF ROLLER MODEL #STR-180- DWG. # 7

REV'S		DESCRIPTION	DATE
REV			

ITEM	DESCRIPTION	PART NO	QTY
1	BOX, BATTERY	0280090	1
2	PLAT, VALVE MOUNTING- REAR	0492076	1
3	PLATE, CYLINDER & TANK MOUNTING	0492071	2
4	PLATE, ANTENNA BOX MOUNTING	0492077	1
5	MOUNT, REMOTE CONTROL	0491189	1
6	SUPPORT, ANTENNA CHANNEL- LOWER	0477447	2
7	BOX, ANTENNA	0380XXX	1
8	FLOOD LIGHT- LED RECTANGULAR	0315413	2
9	REMOTE CONTROL	**	1

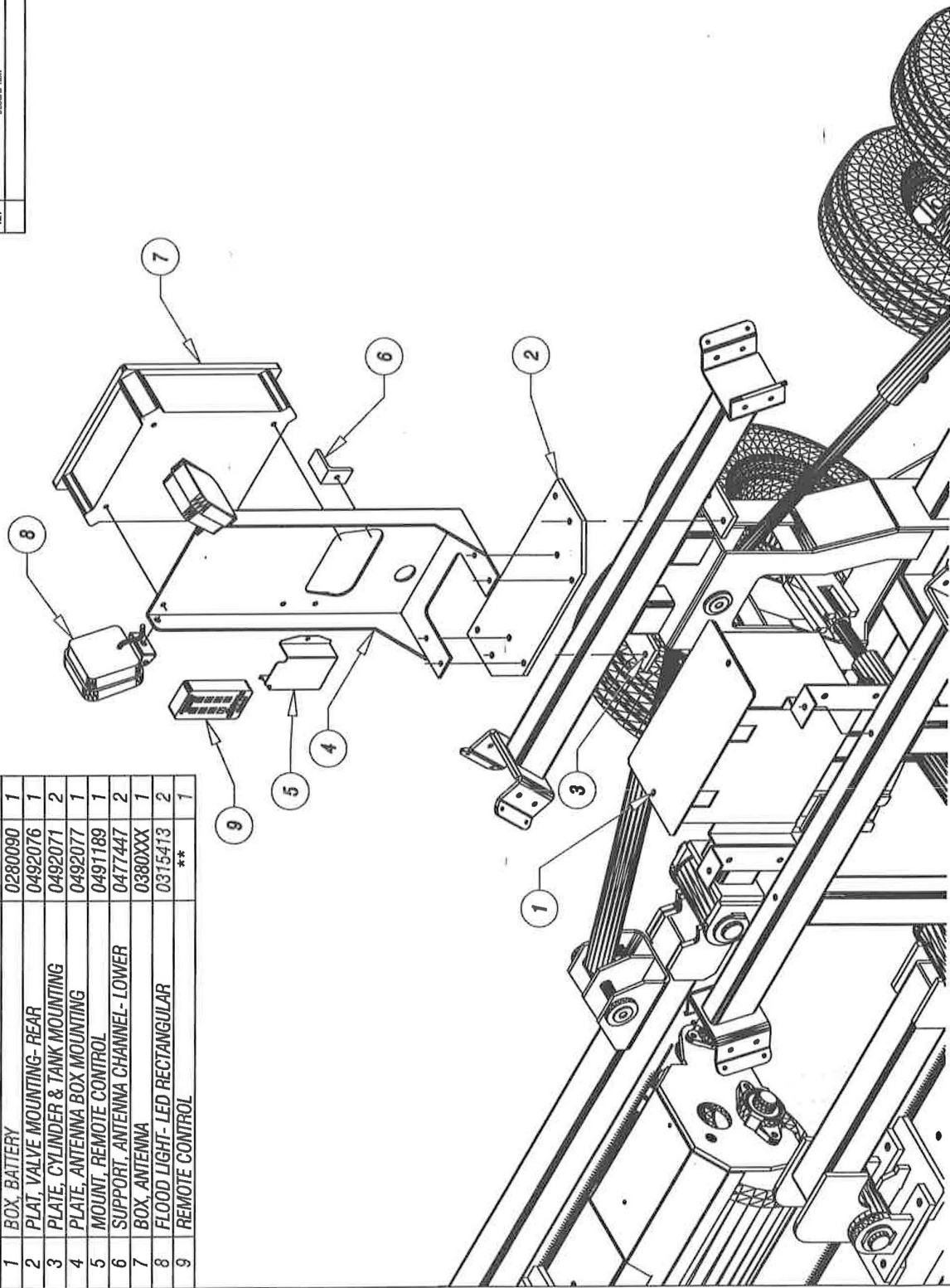

TOW BEHIND TURF ROLLER MODEL #STR-180- DWG. # 8

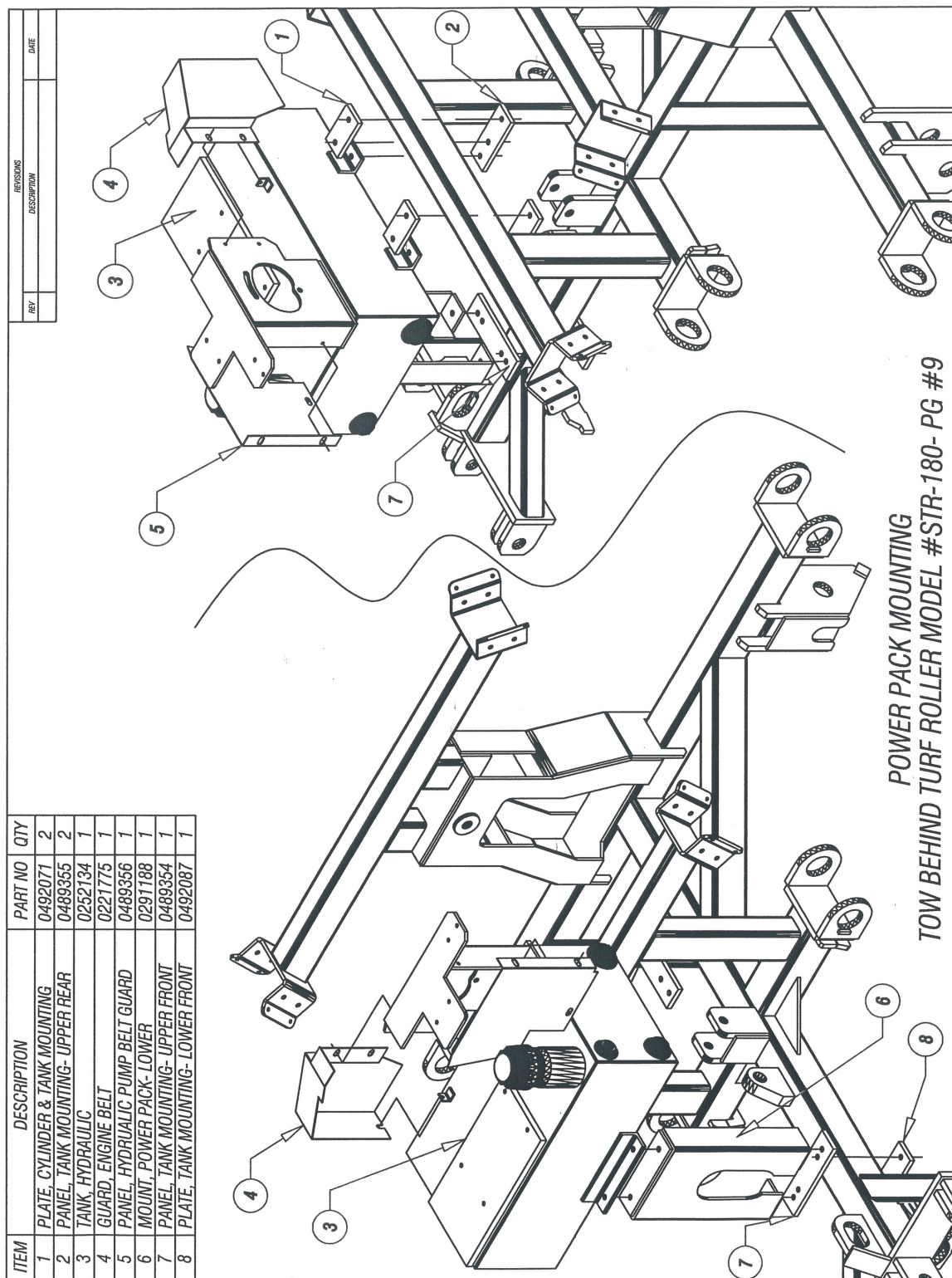

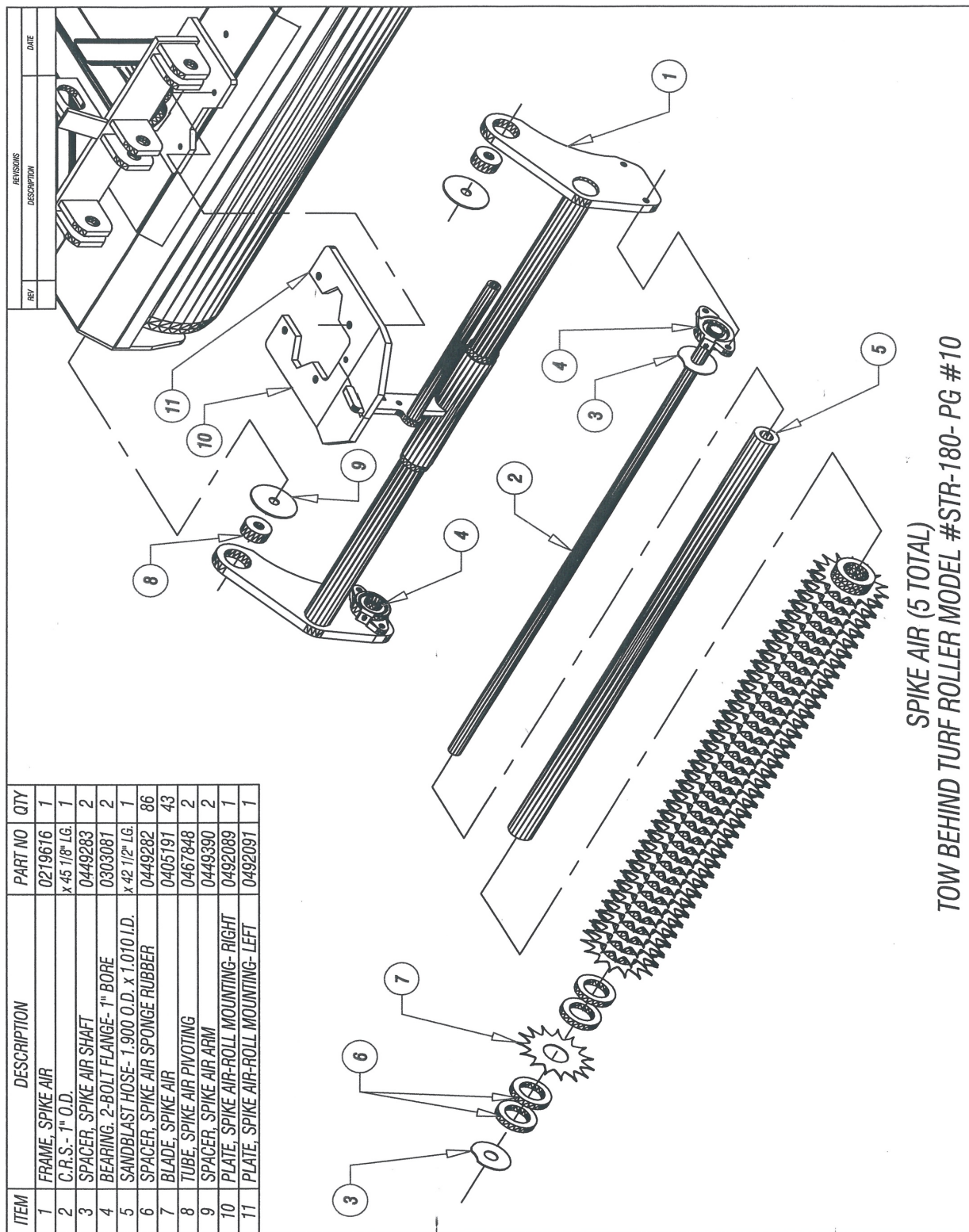

Below is a quick reference chart for various
“Flat Head Cap Screws” and the torque recommendations.

VALUES ARE STATED IN FOOT POUNDS

BOLT SIZE	Thds Per Inch	SAE Grade 5	SAE Grade 8
1/4	20 28	10 ---	14 ---
5/16	18 24	19 ---	29 ---
3/8	16 24	33 ---	47 ---
7/16	14 20	54 ---	78 ---
1/2	13 20	78 ---	119 ---
9/16	12 18	114 ---	169 ---
5/8	11 11	154 ---	230 ---
3/4	10 10	257 ---	380 ---
7/8	9 9	382 ---	600 ---
1	8 8	587 ---	700 ---

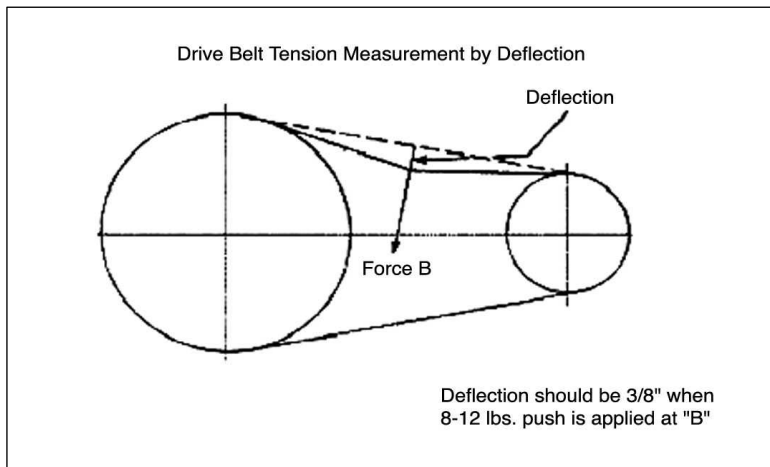

WARRANTY POLICY

Please remember to complete and return your Warranty Card and Dealer Delivery Report. Warranty Claims will not be considered if the Warranty Card and Dealer Delivery Report have not been returned to Salsco.

Your Salsco Commercial or Turf Equipment product is a commercial type product and is normally manufactured and sold for commercial or industrial use. **Salsco will, for the original purchaser, for (5) years from the date of purchase (90 days if used for rental purposes) repair or replace, free of charge, any part or parts found to be defective in material, workmanship or both.** Any transportation or shipping charges will be borne by the purchaser. If, during the warranty period stated above, the product does not function properly due to defect, simply contact Salsco and follow the Warranty Procedures included in this manual.

This warranty **does not** include:

- Incidental or consequential damages and is exclusive of any implied warranties.
- Normal maintenance parts, including, but not limited to hoses, chains, belts, filters, lubricants, etc.
- Parts or components, which are covered under the original manufacturer warranty, including, but not limited to engines, pumps, and motors.

WARRANTY PROCEDURE

In order for Salsco to consider your warranty claims in a timely manner you must follow the simple procedures listed below:

MACHINE OR PART FAILURE

- Call our service department for helpful instruction on how to correct or repair the problem. Preventive maintenance will also be suggested.
- When ordering parts for Warranty issues, you **MUST** retain possession of the old parts in question until notified with respect to returning the parts to Salsco or other disposition.
- Warranty Claims **MUST** be filed within 30-days from completion of the work performed. Contact our office for an electronic warranty claim form.
- Fill in all information requested on warranty claim form, a copy of which is included in this manual, (date of purchase, company name, address, etc.). List all parts used. Make sure part numbers are correct. You can obtain these from your manual. (include good description of problem; i.e. "leaking from spool" rather than "leaking").
- It is our goal to consider and reach a disposition on each Warranty Claim within 30-days from the date that it is received. Therefore it is important that you respond promptly to any request for further information. Claims with no response to inquiries will be closed as **"denied for lack of response"** 90-days from the date of request.
- Email, Fax or Send Warranty Claim form to our Warranty Department. – **Warranty on parts most often requires return of the parts that were replaced.** DO NOT DISCARD OLD PARTS UNTIL YOU HAVE RECEIVED A DETERMINATION AS TO WHETHER THESE PARTS MUST BE RETURNED.
- Our Warranty Department will contact and instruct you on how to return the Parts to Salsco on an RA #. Returns **MUST** be made within 30-Days from issuance of RA #. **FREIGHT CHARGES ON RETURN OF PARTS IS THE RESPONSIBILITY OF THE CUSTOMER.** Normal pre-delivery adjustments are not covered under warranty. Labor Warranties are based on reasonable time allowances as determined by Salsco, Inc. and paid at 75% of posted labor rate. **TRAVEL TIME IS NOT REIMBURSED UNDER THE WARRANTY POLICY.**
- Be sure to put the RA form inside the box that you are shipping back, also be sure to put on the outside of the box "Return of Goods" and the RA #.
- Ship returns via a traceable method such as UPS Ground Service. Be sure that the shipment is insured for the appropriate value. If uninsured parts are lost, we cannot issue a credit.

PLEASE NOTE: ***Warranty forms should be filled out completely.***

PREVENTIVE MAINTENANCE IS YOUR BEST INSURANCE AGAINST EQUIPMENT FAILURE. BE SURE TO READ THIS MANUAL, ESPECIALLY THE MAINTENANCE, OPERATING AND CAUTION SECTIONS.

**SALSCO, INC., 105 Schoolhouse Rd.
Cheshire, CT 06410**

TOLL FREE: 800-872-5726, 203-271-1682, FAX: 203-271-2596 EMAIL: sales@salsco.com, www.salsco.com

SALSCO WARRANTY CLAIM FORM

SALSCO, INC. 105 SCHOOLHOUSE RD. CHESHIRE, CT 06410		PHONE: 203-271-1682, 800-872-5726 FAX: 203-271-2596 EMAIL: f.carrington@salsco.com WEB: www.salsco.com
END OWNER	PHONE:	
NAME:	FAX:	
EMAIL:		
ADDRESS:		
PURCHASED FROM:	PHONE:	
NAME:	FAX:	
EMAIL:		
ADDRESS:		
EQUIP/WARRANTY INFO: (MUST BE COMPLETE)		
PURCHASE DATE:	INV #:	DATE FAILED:
MODEL #:	SERIAL #	REPAIR DATE:
HRS USED:		
WARRANTY CLAIM/WORK ORDER #		
WAS A SALSCO RETURN AUTH. # ISSUED FOR REPAIRS OR RETURN OF PARTS: YES NO		
IF YES, RA #:		
PROBABLE CAUSE OF FAILURE:		

SALSCO WARRANTY CLAIM FORM – Continued

WORK PERFORMED/COMMENTS ON REPAIR:				
SHOP LABOR RATE:		SUBMITTED BY:		
TOTAL LABOR HRS TO REPAIR:		PRINTED NAME:		
SALSCO PART #: DESCRIPTION:	QTY	PRICE EACH	TOTAL	INVOICE #:
FILL IN ALL INFORMATION REQUESTED ON WARRANTY CLAIM FORM. INCOMPLETE FORMS CANNOT BE PROCESSED & WILL BE RETURNED. LIST ALL PARTS USED. MAKE SURE PART NUMBERS ARE CORRECT. ANY PARTS THAT YOU BELIEVE TO BE DEFECTIVE OR ANY PARTS THAT BREAK SHOULD BE RETAINED FOR POSSIBLE INSPECTION UNTIL AFTER THE WARRANTY HAS BEEN PAID OR PART HAS BEEN RETURNED. INV. # NEEDS TO BE INCLUDED ON WARRANTY CLAIM.				
OFFICE USE ONLY				
DATE REC'D:	DLR. DEL REPORT ON FILE: YES NO			
CUST ID:	WARRANTY CLAIM ON FILE: YES NO			
SALSCO WC:	PARTS TOTAL:			
SALSCO RA:	LABOR TOTAL:			
DATE APPROVED:	TOTAL APPROVED:			
DATE REJECTED:	REJECTED DATE:			
PROCESSED BY:	REASON:			

SERIAL # _____	MODEL NO. _____
SALSCO LIMITED WARRANTY CARD	
1. DATE PURCHASED: _____	
2. PURCHASER: _____	
3. PURCHASER ADDRESS: _____	
4. EMAIL ADDRESS: _____	
5. DEALER: _____	
6. DEALER ADDRESS: _____	
7. WILL THIS EQUIPMENT BE USED COMMERCIALY? <input type="checkbox"/> YES <input type="checkbox"/> NO	
8. DID DEALER SERVICE THIS EQUIPMENT AND INSTRUCT YOU IN ITS CARE AND SAFE OPERATION ? <input type="checkbox"/> YES <input type="checkbox"/> NO	
9. DID YOU RECEIVE AN "OPERATION & SERVICE MANUAL" AND SAFETY PAMPHLET? <input type="checkbox"/> YES <input type="checkbox"/> NO	
NOTICE IMPORTANT: THIS CARD MUST BE FILLED OUT COMPLETELY AND MAILED TO THE FACTORY WITHIN 10 DAYS OF PURCHASE DATE, OR YOUR LIMITED WARRANTY WILL BE VOIDED. <div style="display: flex; justify-content: space-around;"> WHITE - DEALER YELLOW - OWNER CARD - FACTORY </div>	SIGNED _____ <div style="text-align: right; padding-right: 20px;">Purchaser</div>

SALESMAN ID # _____ SALES MANAGER'S NAME _____

Salsco, Inc. 105 School House Rd. Cheshire, CT 06410 203-271-1682		sales@salsco.com www.salsco.com
DEALER DELIVERY REPORT		
MODEL _____		SERIAL NO _____
DEALER _____	CITY _____	STATE _____ ZIP _____
PURCHASER (Last Name or Company) _____ (First Name) _____ (Middle Name) _____	ADDRESS _____	CITY _____ STATE _____ ZIP _____
The undersigned dealer warrants that the above-described machine was carefully inspected, adjusted and prepared for delivery before delivery to the purchaser; that both the operation and maintenance of the machine were explained to the purchaser; and that a copy of the Owner's Instruction Manual were given to the purchaser and his attention called to Our Warranty and any operating instructions included in the manual and caution notes.	The undersigned purchaser certifies that the operation and maintenance of the above-described machine have been explained to him; acknowledges receipt of a copy of the Owners's Instruction Manual and Our Warranty Policy printed in said Instruction Manual and Caution Notes. I also understand that it is my responsibility to explain and make Salsco manuals available to new operators.	
Date _____ Dealer _____ Sign By _____ Phone _____	Date _____ Purchaser _____ Sign By _____ Phone _____ Email _____	

FACTORY COPY WHITE - DEALER'S COPY YELLOW - OWNER'S COPY PINK

SERVICE RECORD

If kept properly, this schedule will help track problems in the future.

[illegible]

MODEL # _____ S/N _____

DATE PURCHASED: _____