

# **Salsco, INC.**

LEADER BY DESIGN

---

---

# **Colt**

CHIPPER/SHREDDER

OWNER'S MANUAL  
PARTS MANUAL  
SERVICE MANUAL



SALSCO, INC.  
TURF EQUIPMENT DIVISION  
105 SCHOOL HOUSE ROAD  
CHESHIRE, CONN. 06410 USA

---

---

## STATEMENT OF FACT

YOU HAVE JUST PURCHASED THE HIGHEST QUALITY, MOST DURABLE CHIPPER/SHREDDER ON THE MARKET TODAY. THIS UNIT HAS THE ABILITY TO MEET EXACT STANDARDS AND PERFORM FOR YEARS WITH MINIMUM DOWN TIME. HOWEVER, IT CANNOT READ NOR WILL IT UNDERSTAND THIS MANUAL NO MATTER HOW LONG YOU LEAVE IT ON TOP OF THE MACHINE. IT IS YOUR RESPONSIBILITY TO READ AND UNDERSTAND IT. IT IS ALSO YOUR RESPONSIBILITY TO BE CERTAIN THIS INFORMATION IS PASSED ALONG TO ANYONE WHO IS EXPECTED TO OPERATE THIS EQUIPMENT. SHOULD YOU CHOOSE NOT TO READ, UNDERSTAND AND PASS ALONG THE INFORMATION PROVIDED YOU, PLEASE EXPECT EQUIPMENT FAILURE AND POSSIBLE INJURIES TO PERSONS AROUND THIS EQUIPMENT.

FOR THE SAFETY OF THE OPERATOR, IT IS IMPERATIVE THAT THIS MANUAL IS CAREFULLY READ AND UNDERSTOOD.

HAVING READ THIS MANUAL, IT IS YOUR RESPONSIBILITY TO BE SURE THAT ALL NEW OPERATORS READ AND UNDERSTAND THIS MANUAL ESPECIALLY THE CAUTIONS ON PAGE 4.

AS A MANUFACTURER OF EQUIPMENT WE HAVE A RESPONSIBILITY TO DESIGN A SAFE PIECE OF EQUIPMENT. HOWEVER, ONLY YOU CAN PREVENT ACCIDENTS!!

READ AND UNDERSTAND MANUAL BEFORE OPERATING

## DESCRIPTION

### COLT CHIPPER/SHREDDER

Once in a while a product comes along that is so far above the competition even the name must say it == COLT ==. After months of testing, we have produced a line of CHIPPER/SHREDDERS, which we believe, are so advanced that they must be seen to be believed. We've made four models to introduce the line; COLT 5 h.p. Briggs Consumer Model, STALLION 5 h.p. Briggs, STALLION 7.9 h.p. OHV Kawasaki, and a STALLION 8 h.p. Briggs Commercial Models. Our units will handle, with ease, 3 1/2" logs and brush up to 3/4" thick in the shredder side. We have several options, such as electric start, 10' hose kit, transport wheel, over the road tires, and a light package. Most important is the way the COLT pulls in material and the speed at which it does it.

READ AND UNDERSTAND MANUAL BEFORE OPERATING

MANUFACTURED BY:

SALSCO, INC.  
105 SCHOOL HOUSE ROAD  
CHESHIRE, CT 06410  
(203) 271-1682  
FAX: (203) 271-2596

THIS MANUAL COVERS MODELS: 10007 5 hp Briggs (Consumer)

This company reserves the right to discontinue, add improvements to, or change the design of any model or product at any time without obligation to improve existing machines, either by changing the design or adding new parts.

It has been and will continue to be the policy of SALSCO to update existing machines at its own discretion. Whenever possible, new designs will be made in such a way, that they can be "Retro Fit" if so desired.

Record in the space provided below the model and serial number of this unit. Please retain these numbers for future reference.

No parts orders will be accepted without model numbers or part numbers. All part numbers are listed in this manual.

-----  
SERIAL NUMBER

-----  
MODEL NUMBER & NAME

NOTE: Be sure to complete your warranty card. This will insure immediate processing of any warranty claims.

READ AND UNDERSTAND THIS MANUAL BEFORE STARTING MACHINE

## CAUTIONS

### SALSCO CHIPPER/SHREDDER

- 1) ALWAYS use protective eyewear when machine is in operation
- 2) ALWAYS use gloves and wear ear protection when machine is in operation
- 3) NEVER put hands into or near Chipper/Shredder intake or discharge openings
- 4) NEVER run with guards removed.
- 5) ALWAYS allow machine to cool off and have spark plug removed before attempting any maintenance on the Colt.
- 6) DO NOT operate with loose clothing or long unrestrained hair.
- 7) DO NOT operate on ice or any other slippery surface. Be sure area around machine is clear and clean. You don't want to trip into the machine.
- 8) NEVER leave machine running unattended, especially around youngsters or persons not instructed in the safe operation of this machine.

NEVER PUT HANDS, OR ANY PART OF YOUR BODY IN INTAKE OR  
DISCHARGE OPENINGS WHILE MACHINE IS RUNNING

## REPLACING CLUTCH ROTOR ASSEMBLY

CAUTION: NEVER START ENGINE IF THE CLUTCH ROTOR ASSEMBLY IS NOT CONTAINED IN THE CLUTCH DRUM AS THE CLUTCH ASSEMBLY WILL FLY APART.

- 1) REMOVE ENGINE FROM MACHINE. (Four bolts)
- 2) REMOVE CLUTCH DRUM - (This is the part that's on the chipper shaft) HINT: This would be a good time to file any set screw marks on the 1" shaft.
- 3) REMOVE CLUTCH ROTOR FROM ENGINE SHAFT. HINT: Clean set screw marks from engine shaft.
- 4) With clutch drum and rotor off, SET ENGINE ON MOUNTING PLATE AND SLIDE UP TO CHIPPER INPUT SHAFT until both engine and chipper shafts are touching.
- 5) BE SURE BOTH SHAFTS LINE UP - THIS IS VERY IMPORTANT Be sure engine shaft is not higher or lower than input shaft. If engine shaft is HIGHER than input shaft, you will have to FILE the BASE PLATE of the engine. Usually, no more that .007 to .010. However, if the engine shaft is LOWER than the input shaft, you will have to SHIM THE ENGINE with thin washers until shafts line up.  
  
\* Newer Chipper Shredders have adjusting screws for this problem.
- 6) INSTALL CLUTCH DRUM on input shaft. Be sure to use LOCTITE.
- 7) INSTALL CLUTCH ROTOR on engine shaft. Be sure to use LOCTITE.
- 8) SLIDE ENGINE IN PLACE and put engine bolts in loosely. BE SURE rotor is not touching the clutch drum.
- 9) With engine bolts loose enough to slide the engine only, start engine and run at full throttle. THIS WILL CENTER CLUTCH. TIGHTEN ENGINE BOLTS with engine running. BE CAREFUL to let engine find center.
- 10) After bolts are tight, shut down engine. IF YOU'VE DONE IT RIGHT, chipper flywheel should continue to rotate after engine has stopped, without the shoes dragging.
- 11) After everything stops turning, PULL ROPE TO CHECK FOR RETURNS. If you are satisfied that the shoes are not dragging, then start machine and let it run at full RPM for approximately 15-20 minutes. IF YOU'VE DONE IT RIGHT, shoes should last, if not they will begin to shred powdered metal. THIS MEANS MIS-ALIGNMENT. START AGAIN.

## OPERATING INSTRUCTIONS

### SALSCO CHIPPER/SHREDDER

- 1) Be sure all guards are in place.
- 2) Check both chambers to be sure they are free and clear of debris.
- 3) Check engine oil and fuel levels, as per engine manufacturers specifications.
- 4) Set engine throttle just above idle, and set choke.
- 5) Start engine and let idle for a few minutes to warm up.  
  
\*CAUTION: Never look into either chute. Never reach, for any reason, into any part of this machine.
- 6) Set engine to full R.P.M. Machine is ready to use.
- 7) In chipper side, machine will take a maximum of 3 1/2" branches.
- 8) In shredder side, machine will take a maximum of 1/2" and smaller.

### HINTS

- 1) When putting brush in shredder side, put it in and let it go. If it gets stuck, leave it. The next branch will pull it in. DO NOT REACH INTO HOPPER.
- 2) When using the chipper side and you have a short piece of wood bouncing around in the hopper, leave it. The next branch will push it in. DO NOT REACH IN HOPPER FOR ANY REASON.
- 3) When at low idle, you may hear a loud clanking noise. This is most likely the flail blades. Noise should go away with a higher R.P.M.
- 4) When feeding leaves into the shredder side, feed them slowly. A large volumn of wet leaves at once, can clog the machine.

READ AND UNDERSTAND THIS MANUAL BEFORE STARTING MACHINE

## SERVICE SCHEDULE

### SALSCO CHIPPER/SHREDDER

- 1) Follow service schedule set forth by engine manufacturer.
- 2) Grease main bearings once a day or as needed. DO NOT OVER GREASE. Wipe extra grease off bearings.
- 3) Be sure to clean entire machine, especially around engine box.
- 4) Check all nuts and bolts daily to be sure they are tight.
- 5) When blades need to be sharpened, you must first remove spark plug, shut fuel off and then remove chipper chute. Apply heat with Oxy-Acetylene torch at about 180 . This will loosen the Loctite and allow the bolt to be removed. When you reassemble, be sure to use Loctite on all bolts.
- 6) To replace flail blades, remove spark plug wire and shut fuel off. Remove chipper chute. (This may be a good time to sharpen blades.) Remove clutch guard. Loosen clutch set screws and set screws on bearing. Unbolt Chipper/Blower housing and slide housing off impeller shaft. Now you can slide impeller shaft off machine and flail assembly off impeller shaft.
- 7) Be sure when replacing flail blades to put biting edge on leading side into rotation.
- 8) At this time, inspect all other parts for wear.
- 9) Be sure when ever machine is disassembled and clutch must be removed, you take care to line it up during reassembly. You'll want to be sure that clutch half on engine is in center of clutch hub. This adjustment is made by eye. A simple way to check is to bring engine to full R.P.M. after unit is fully assembled then shut engine down. Impeller should continue to rotate long after engine is off. This would mean clutch shoes have released and most likely are in center of hub.

NEVER PERFORM ANY SERVICE, MAINTENANCE OR REPAIR WHILE MACHINE IS RUNNING



## CHIPPER/SHREDDER

### WARRANTY

Your Salsco Commercial or Turf Equipment product is a commercial type product and is normally manufactured and sold for commercial or industrial use. Salsco will warranty new equipment, for the original purchaser, as follows for the purchaser categories as listed below:

#### Consumer Model:

Consumer. . . . .	6 Months
Commercial. . . . .	None
Rental. . . . .	None

#### Commercial Models:

Consumer. . . . .	1 Year
Commercial. . . . .	6 Months
Rental. . . . .	90 Days

Warranty: Repair or replace (at Salsco's option) free of charge, any part or parts found to be defective in material or workmanship or both. Any transportation charges to be borne by the purchaser.

If, during the Warranty Period, the product does not function properly due to defect, simply contact your Salsco Dealer and provide the unit or part for inspection. Or contact Salsco directly at: SALSCO, INC., Service Department, 105 Schoolhouse Road, Cheshire, CT 06410, 203/271-1682.

This warranty does not include incidental or consequential damages and is exclusive of any implied warranties.

This warranty does not include normal maintenance parts, including, but not limited to spark plugs, filters, lubricants, springs, blades, rubber products, etc.

This warranty does not include parts or components which are covered under the original manufacturers warranty, including, but not limited to engine and differential.

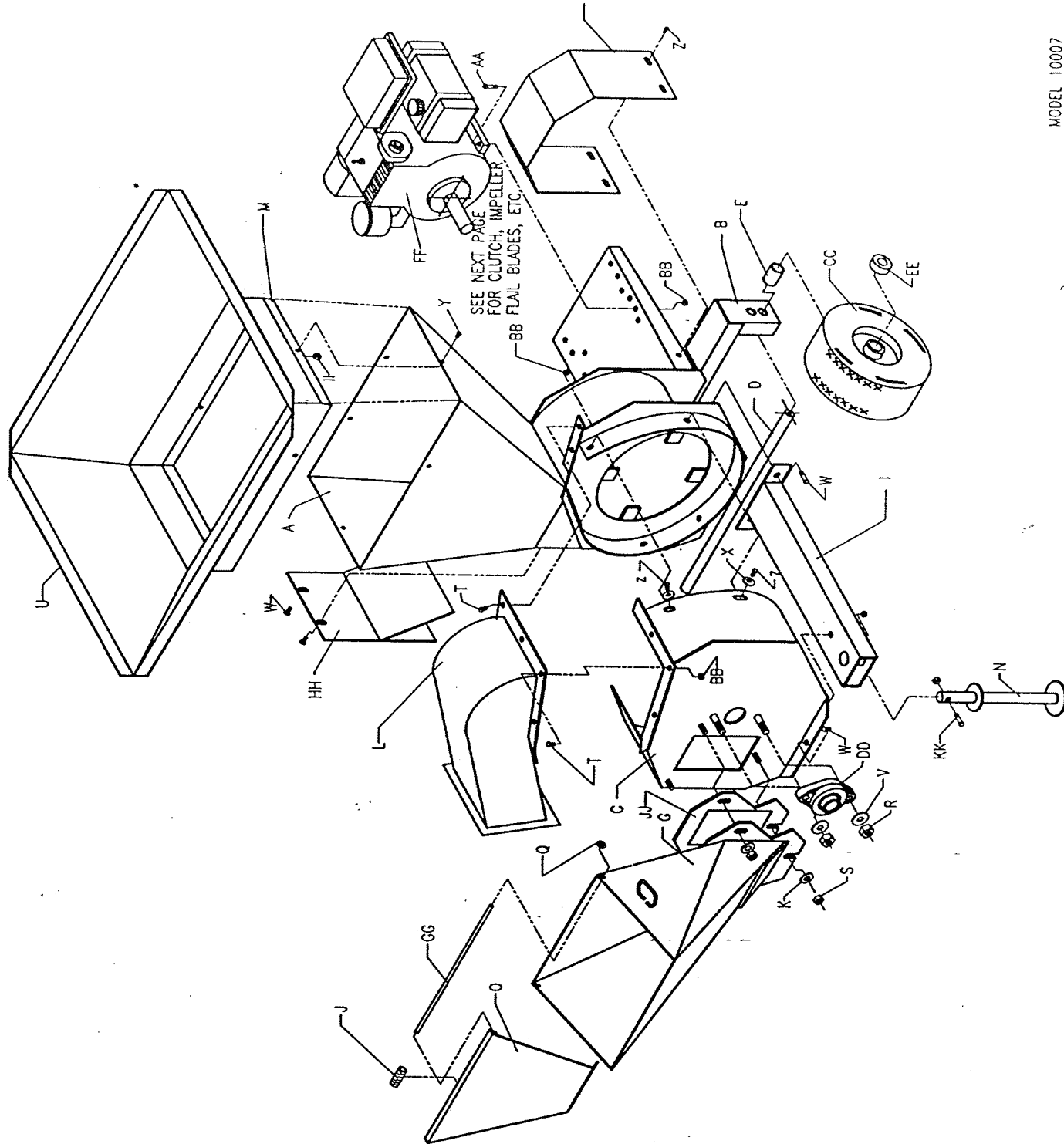

A	0228043	SHREDDER HOUSING	1
B	0206089	AXLE BRACKET	1
C	0228041	CHIPPER HOUSING	1
D	0402008	AXLE	1
E	0449016	SPACER	2
F	0421020	GUARD WRAP	1
G	0228046	INLET CHUTE HOUSING	1
H	0441353	CHUTE BASE PLATE	1
I	0206095	BOTTOM BRACKET	1
J	0350006	SPRING	1
K	0353102	3/8 FLAT WASHER	3
L	0228045	OUTLET CHUTE	1
M	0226006	SHREDDER HOPPER	1
N	0206093	FOOT BRACKET	1
O	0226004	HOPPER DOOR	1
P	0241376	MOUNTING PLATE	1
Q	0338251	1/4 PUSHNUT	2
R	0338104	1/2 LOCK NUT	4
S	0338102	3/8 LOCK NUT	3
T	0346104	5/16 HEX BOLT X 1"	16
U	0336051	HOPPER TRIM	1
V	0353115	1/2 HARD FLAT WASHER	2
W	0346203	3/8 HEX BOLT X 1"	7
X	0353002	5/16 LOCK WASHER	6
Y	0346003	1/4 HEX BOLT X 1/2"	5
Z	0346102	5/16 HEX BOLT X 3/4"	10
AA	0346134	5/16-18 HEX BOLT-2 1/4"	4
BB	0338101	5/16 HEX NUT	18
CC	0354013	WHEEL	2
DD	0303006	BEARING	2
EE	0311006	3/4 SET COLLAR	3
FF	0337011	ENGINE 5 HP B&S	1
GG	0445006	DOOR ROD	1
HH	0241365	VACUUM COVER PLATE	1
II	0338100	1/4 HEX NUT	3
JJ	0549025	CHUTE SPACER	1
KK	0346105	5/16 HEX BOLT 1 1/4"	1

ITEM	PART NO.	DESCRIPTION
A	0541392	FLAIL BLADE BRACKETS
B	0205017	IMPELLER S/A
C	0405016	CHIP BLADE
D	0405014	FLAIL BLADE
E	0405015	LARGE FLAIL BLADE
F	0448074	FLAIL SHIRT
G	0340013	COLTER PIN
H	0343001	7/8 EXTERIOR RETAINING RING
I	0331115	1/4 KEY X 1 1/2
J	0235050	DRUM S/A
K	0336047	ROTOR
L	0449017	5/16 SPACER
M	0449018	11/16 SPACER
N	0449019	3/4 SPACER
O	0449020	13/16 SPACER
P	0449021	7/8 SPACER
Q	0449022	1 SPACER
R	0449023	1 5/16 SPACER
S	0449024	1 3/4 SPACER
T	0346150	5/16-24 FLAT HD SCREW 3/4 LG
U	0449026	7/16 SPACER
V	0311013	1/2 SPLIT COLLAR
W	0541393	MIDDLE FLAIL PLATE

\* CLUTCH CONSISTS OF ITEM K AND ITEM L

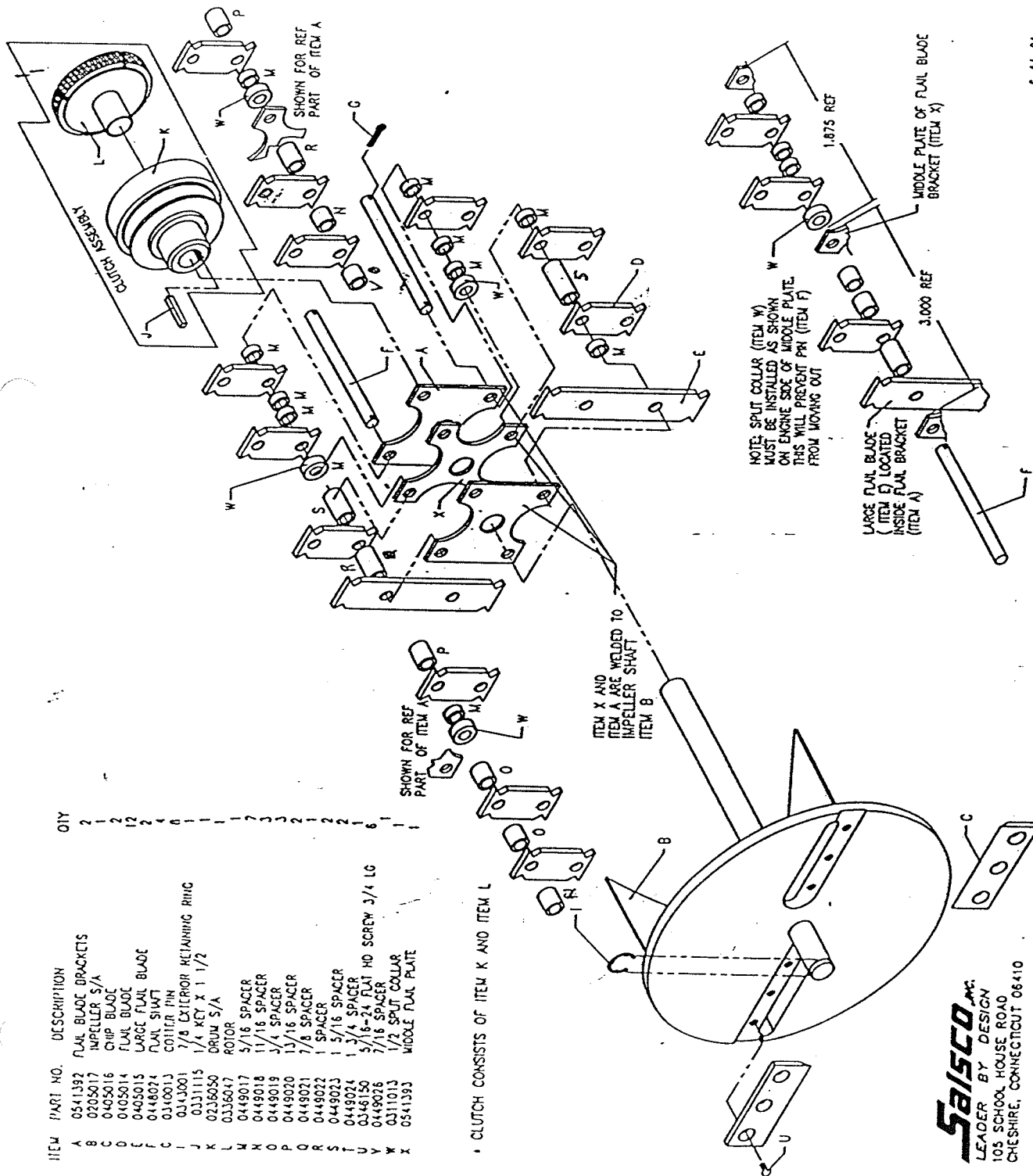

**Salsco, Inc.**  
 LEADER BY DESIGN  
 105 SCHOOL HOUSE ROAD  
 CHESHIRE, CONNECTICUT 06410

MODEL 10007  
 6-11-91  
 5-9-91

## SALSCO'S WARRANTY PROCEDURE

In order for Salsco to process your warranty claims in a timely manner you must follow the simple procedures listed below:

### 1) MACHINE OR PART FAILURE

- a) Call our service department before you try to fix the problem, for instruction on how to correct or repair the problem. Preventive maintenance will also be suggested.
- b) Fill in all information requested on warranty claim form (date of purchase, company name, address, etc.)
- c) List all parts used. Make sure part numbers are correct. You can obtain these from your manual. Any parts that you believe to be defective or any parts that break should be retained for possible inspection until after the warranty has been paid or part has been replaced.

For most engine problems it will be easier for you to contact your local engine dealer. Should you have any problem, please call Salsco.

If you have any questions, please do not hesitate to call us. Our toll free number is 1-800-8SALSCO.

READ AND UNDERSTAND THIS MANUAL BEFORE OPERATING

# WARRANTY CLAIM

SALSCO, INC.- 105 SCHOOL HOUSE ROAD, CHESHIRE, CT 06410  
 PHONE: (203) 271-1682 FAX: (203) 271-2596

OWNER: \_\_\_\_\_ PHONE# ( ) \_\_\_\_\_

ADDRESS: \_\_\_\_\_

PURCHASED FROM: \_\_\_\_\_ PHONE# ( ) \_\_\_\_\_

ADDRESS: \_\_\_\_\_

DATE FAILED: \_\_\_\_\_ DATE PURCHASED: \_\_\_\_\_ INVOICE # \_\_\_\_\_

SERIAL # \_\_\_\_\_ MODEL# \_\_\_\_\_ HOURS USED: \_\_\_\_\_

PROBABLE CAUSE OF FAILURE OR PROBLEM:(word defective not sufficient)

\_\_\_\_\_

\_\_\_\_\_

\_\_\_\_\_

\_\_\_\_\_

\_\_\_\_\_

\_\_\_\_\_

WORK PERFORMED/COMMENTS ON REPAIR:

\_\_\_\_\_

\_\_\_\_\_

\_\_\_\_\_

\_\_\_\_\_

\_\_\_\_\_

\_\_\_\_\_

\_\_\_\_\_

\_\_\_\_\_

\_\_\_\_\_

\_\_\_\_\_

\_\_\_\_\_

\_\_\_\_\_

\_\_\_\_\_

\_\_\_\_\_

\_\_\_\_\_

\_\_\_\_\_

\_\_\_\_\_

\_\_\_\_\_

\_\_\_\_\_

\_\_\_\_\_

\_\_\_\_\_

\_\_\_\_\_

\_\_\_\_\_

\_\_\_\_\_

\_\_\_\_\_

\_\_\_\_\_

\_\_\_\_\_

\_\_\_\_\_

\_\_\_\_\_

\_\_\_\_\_

\_\_\_\_\_

\_\_\_\_\_

\_\_\_\_\_

\_\_\_\_\_

\_\_\_\_\_

\_\_\_\_\_

## OFFICE USE ONLY

DT APPRD: \_\_\_\_\_ DT RJCTD: \_\_\_\_\_ ENTRD A/R: \_\_\_\_\_ ENTRD DB: \_\_\_\_\_

DEALER D/R: \_\_\_\_\_ WARRANTY CARD: \_\_\_\_\_

PART(S) TOTAL: \_\_\_\_\_ LABOR TOTAL: \_\_\_\_\_ TOTAL: \_\_\_\_\_

APPROVED/REJECTED BY: \_\_\_\_\_

NAME

TITLE

REASON FOR REJECTION:

\_\_\_\_\_

\_\_\_\_\_

\_\_\_\_\_

\_\_\_\_\_

\_\_\_\_\_

\_\_\_\_\_

\_\_\_\_\_

\_\_\_\_\_

SERVICE RECORD

THIS SCHEDULE IF KEPT PROPERLY WILL HELP TRACK PROBLEMS IN THE FUTURE

[illegible]



105 SCHOOL HOUSE ROAD  
CHESHIRE, CONNECTICUT 06410  
PHONE 203-271-1682  
FAX 203-271-2596  
1-800-8-SALSCO