

**OPERATORS AND PARTS MANUAL
CORE RECOVERY VEHICLE - MODEL CRV 0009130**



MANUFACTURER OF OUTDOOR POWER EQUIPMENT

Products for Turf & Lawncare, Rental, Construction, Tree Care, Wood Processing, Nursery & Farm Industries

3-1/2" - 18" Capacity, Gas, Diesel, & P.T.O. Wood/Brush Chippers

Gas & Electric Rollers - Tranz-Former - CRV Core Recovery Vehicle

Mini-Paver - Mini-Track Paver - Cobra Curber - Scorpion Router - Concrete Paver

Chipper Shredder Vacuums - Tailgate & Truckloader Vacuums

9 cu. yds. - 50 cu. yds. Per Hour, Electric, P.T.O. & Diesel Powered Shaving Mills

Salsco, INC.
LEADER BY DESIGN

105 Schoolhouse Road
Cheshire, CT 06410 U.S.A.
800-872-5726 (Toll Free), 203-271-1682, 203-271-2596 (Fax)
www.salsco.com, sales@salsco.com

TABLE OF CONTENTS

C.R.V. - CORE RECOVERY VEHICLE, MODEL 0009130

| | |
|---|------------|
| COVER & TABLE OF CONTENTS..... | Page 1-2 |
| STATEMENT OF FACT | Page 3 |
| MACHINE REGISTRATION | Page 4 |
| OPERATING INSTRUCTIONS / READ BEFORE OPERATING..... | Page 5-6 |
| CONTROL PHOTOS | Page 7 |
| SERVICE & MAINTENANCE..... | Page 8 |
| SAFETY DECALS | Page 9 |
| PARTS DIAGRAMS | Page 10-39 |
| TORQUE CHARTS | Page 40 |
| WARRANTY POLICY & PROCEDURE | Page 41 |
| COPY OF WARRANTY CLAIM FORM..... | Page 42-43 |
| DELIVERY REPORT / WARRANTY CARD | Page 44 |
| SERVICE RECORD..... | Page 45 |

SALSCO, INC.

105 School House Road
Cheshire, CT 06410 USA
800-872-5726; 203-271-1682
203-271-2596 (Fax)
www.salsco.com, sales@salsco.com

STATEMENT OF FACT

You have just purchased the highest quality, most dependable Core Recovery Vehicle on the market today. This unit has the ability to meet exact standards and perform for years with minimum downtime. **HOWEVER**, it cannot read nor will it understand this manual no matter how long you leave it on top of the machine.

It is your responsibility to read and understand this manual; it is also your responsibility to be certain this information is passed along to anyone who is expected to operate this equipment. Should you choose not to read, understand and pass along the information provided you, please expect equipment failure and possible injuries to persons around this equipment.

For the safety of the operator, it is imperative that this manual is carefully read and understood.

Once you have read this manual, it is your responsibility to be sure that all new operators read and understand this manual, especially all cautions stated.

As a manufacturer of equipment, we have a responsibility to design a safe piece of equipment. NOTE: The important safeguards and instructions in this manual are not meant to cover all possible conditions and situations that may occur. It must be understood that common sense, caution, and care are factors, which cannot be built into any product. These factors must be supplied by the person(s) caring for and operating this equipment.

ONLY YOU CAN PREVENT ACCIDENTS!

MACHINE REGISTRATION

MANUFACTURED BY:

SALSCO, INC.

105 Schoolhouse Road

Cheshire, CT 06410 USA

800-872-5726, 203-271-1682

203-271-2596 (Fax)

sales@salsco.com www.salsco.com

THIS MANUAL COVERS: C.R.V. - CORE RECOVERY VEHICLE, MODEL 0009130

This company reserves the right to discontinue, add improvements to, or change the design of any model or product at any time without obligation to improve existing machines, either by changing the design or adding new parts.

It has been and will continue to be the policy of SALSCO to update existing machines at its own discretion. Whenever possible, new designs will be made in such a way that they can be "Retro Fit" if so desired.

Record in the space provided below the model and serial number of this unit. Please retain these numbers for future reference.

NO PARTS ORDERS will be accepted **WITHOUT SERIAL NUMBER OR MODEL NUMBER.** Please call our parts department should you have any questions.

Serial Number

Model Number

NOTE: Be sure to complete your warranty card. This will ensure immediate processing of any warranty claims.

READ AND UNDERSTAND THIS MANUAL BEFORE STARTING AND OPERATING THIS UNIT!

OPERATING INSTRUCTIONS

IMPORTANT: The CRV will be sent via common carrier on its own trailer and secured to that trailer. It could arrive in a box truck or an open flatbed. You will find the CRV Trailer is secured to the transport trailer. Before attempting to unload the CRV and Trailer from the transport trailer, it should be up to a dock for safe removal. Use **CAUTION** when preparing to take the CRV off the trailer. Make sure the **trailer is level**. If you do not have a dock, arrange to have a flatbed truck to back up to the trailer. **(DO NOT USE RAMPS!)** Before driving the CRV off the trailer, **disconnect** any **restraining devices** securing the unit to the trailer.

Once the CRV Trailer is out of the transport trailer, read the Operating Instructions.

A. READ BEFORE OPERATING

- Understand the intended use of this equipment. It is designed to pick up cores but can also be used as a roller to smooth grass playing surfaces. It is not an all-terrain vehicle and should not be used as such.
- Do a walk around the machine looking for damage that may have occurred during transportation. Be sure to note any damage on the bill of lading. Take pictures and document all problems. If any damage or leaks are found, report them to service manager. **NOTE:** If there are no hydraulic leaks, do not open the hydraulic tank cap. If it hasn't leaked, the level will be fine.
- Check engine oil & fuel level.
- Be sure the CRV Trailer is connected to a suitable tow vehicle.
- Before climbing on the machine, **pivot the release handle on the trailer**. Unstrap the four straps holding the machine on the trailer. **NOTE:** These straps must be used to tie the machine to the trailer before moving.



- Use safety step & bar to climb on the machine and adjust the seat.
- Become familiar with the Controls.



- There are **two handles**, one on each side of the seat. These will **raise/lower the elevator conveyors**. When they are **pulled back, the elevators are in the raised position**.



- Be sure to **raise the conveyors for transportation** by pulling back both conveyor handles towards the rear of the machine.

- The **right pedal** will cause the machine to go **forward**; the **left pedal** will cause the machine to go in **reverse**. The farther you press the pedal, the faster the unit will go.
- Start the engine and allow it to warm up for a couple of minutes. Press the left pedal easy. The machine will go in reverse and the trailer will tilt and the machine will roll off the trailer to the ground.



- On the right of the seat housing are **three toggle switches**, all clearly marked. The two together will turn on each elevator, and the third will turn on the waste conveyer. The **ignition, throttle lever and choke** are also located on the right seat housing.

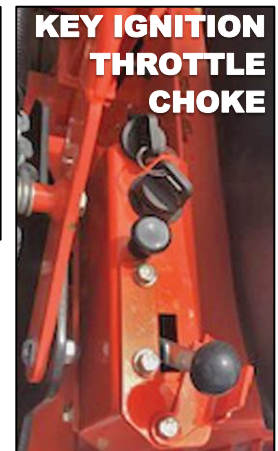

- Installing the Blades:** These are marked **LEFT** and **RIGHT** when seated in the seat.

- Blade Release Pin:**

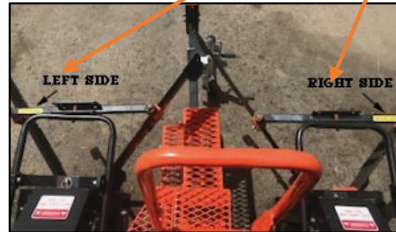

B. WHEN YOU ARE READY TO DRIVE THE CRV OFF OF THE TRANSPORT TRAILER

- Look around to make sure no one is near or behind the machine or trailer.
- Pull the choke and start the engine. Let it warm up for a few minutes.
- When ready, press the **left pedal** and the machine will **back off the trailer**.
- The locking mechanism will unlock, and the trailer will tilt allowing the CRV to exit the trailer.
- You must **shut the engine off and install the Floating Blades**. **NOTE:** They are **marked Left and Right** as you look at them **from the seat**.

C. WHEN YOU ARE READY TO REMOVE CORES

- Once the blades are installed, simply drive the CRV where the cores are to be picked up.
- Turn both Elevator Conveyors on, and lower both conveyors.
- Drive over the turf picking up cores until the Rear Hopper is at a level where you feel it needs to be emptied.
- Turn the Elevators off and drive to the waiting Waste Vehicle.
- Flip the switch for the Waste Conveyor and empty all the cores into the Waste Vehicle.
- Repeat this process until the job is done.

D. WHEN YOU ARE READY TO TRANSPORT TO ANOTHER LOCATION

- Remove both sets of blades.
- Raise both elevators.
- Drive the CRV up onto the center of the trailer into the waiting roll latch.
- The trailer will tilt to a level position and the latch will lock the roll to the trailer.
- The trailer will lock in the level position.
- Dismount the machine and secure the machine to the trailer with the two tie-down straps.
- Also tie the safety tilt strap before towing the trailer.

BE AWARE of terrain & surroundings!
 Potholes or steep hills could become a danger.
ALWAYS traverse hills "up & down"... **NEVER** across hills.

C.R.V. CORE RECOVERY VEHICLE - CONTROLS

Control Panel: Key Ignition/Throttle Lever



Pedals: Left-Reverse / Right-Forward



Toggle Switches: Right and Left Elevator will turn on each elevator; Waste turns on the Waste Conveyor.



Release Handle on Transport Trailer

Waste Conveyor Raise/Lower Handles



Safety Bar & Step

SERVICE & MAINTENANCE INSTRUCTIONS

1. Check all hydraulic hoses **DAILY** or before each scheduled use, for wear and any signs of chaffing. **REMINDER:** Drive motor hoses should be treated as wear items and should be replaced on a yearly basis.
2. Check all fittings for any signs of leaking **DAILY** or before each scheduled use.
3. Check all grease fittings as listed below on a **WEEKLY** basis, and grease as necessary. Add grease until grease leaks slightly from fitting.
 - a. Bearings on roll housings – qty. 6
 - b. Pivot bearing on main housing – qty. 12
4. Check the engine manufacturer's manual for service and maintenance instructions.
5. Fill hydraulic tank to 4-6" below filler cap. Be sure to tighten cap until cap seals.
6. After approximately 1 WEEK of use, and then every 2 WEEKS thereafter, check drive chains...one on each side on roller drive motor. Pivot motor to tighten chain. NOTE: Check and adjust the tension of all drive motor chains on a regular basis.
 - a. There is a pusher bolt to aid in adjusting and must be adjusted along with the motor.
 - b. The chain should have $\frac{3}{8}$ " play. NEVER adjust the chain tight with no play. You can reach under the guard to check for play daily.
7. Wash machine. Keep it clean. Should rust form on rolls, simply drive the unit on a rough area until rolls are clean.
8. **Oil & Filter Type** – It has been determined that your Salsco CRV will perform best using a 25 micron filter. Salsco recommends using 15W-50 full synthetic oil. The oil should have a viscosity rating of at least 122 SSU. While this is not a necessity, it will improve the overall performance of your machine. Salsco is now using this filter and hydraulic oil on all machines using hydraulics. Hydraulic oil should be changed after the first 150 hours, and every 500 hours thereafter.
9. Check the rotary brushes to be sure they are in proper adjustments. They should not touch the roll, $\frac{1}{8}$ " clearance.
10. Check the roller chains to be sure they are in proper adjustment. Chains should be adjusted so they fit and are not so tight they will be forced to stretch.
11. All elevators and conveyors are fitted with quick disconnect hydraulic hoses.
12. To remove the elevators:
 - a. Remove the blades.
 - b. Disconnect the quick disconnect hoses.
 - c. Unbolt the bolt at the end of the pivot shaft on the elevators.
 - d. Slide the elevators off the machine.
13. To remove the rear hopper and conveyors:
 - a. Disconnect the quick disconnect hoses.
 - b. Unbolt the 4 mounts built under the hopper.
 - c. Lift the hopper and frame off the CRV.
14. You now have a Roller.

SAFETY IS A PRIME CONCERN AT SALSCO. THE SAFETY DECALS ON YOUR MACHINE ARE HIGHLY VISABLE AND A CONSTANT REMINDER TO ALL OPERATORS. REPLACEMENT SAFETY DECALS MAY BE OBTAINED BY CALLING SALSCO @ 1-800-872-5726 OR THE DEALER IN YOUR AREA.

SAFETY DECALS



DANGER - HOT EXHAUST: Use extreme caution around this area. Hot parts can cause severe burns. Do not touch engine while operating or just after stopping.



CAUTION: Never operate without covers in place.



DANGER: Rotating parts can cause severe injury. Stay away from moving parts while in operation.



DANGER: Keep hands and feet away.



WARNING: Drive Chain must be checked/maintained daily.



WARNING: Synthetic Oil requirements.

| ITEM | DESCRIPTION | PART No |
|------|-----------------------|---------|
| 1 | CORE RECOVERY VEHICLE | 0009130 |

| REVISIONS | | |
|-----------|-------------|------|
| REV | DESCRIPTION | DATE |
| | | |

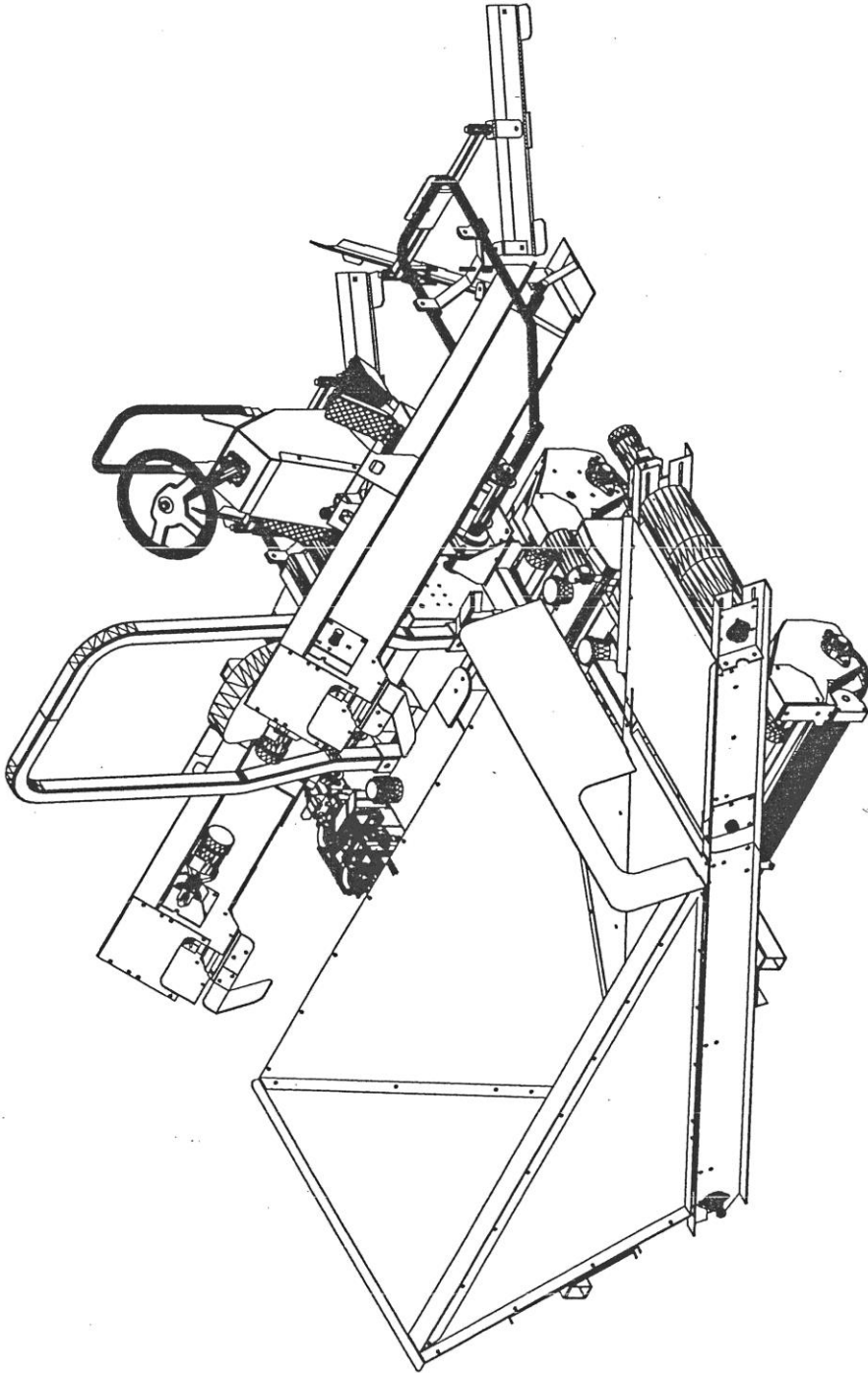

CORE RECOVERY VEHICLE- CRV MODEL 0009130- DWG #1
ISSUED: 2019

| ITEM | DESCRIPTION | PART NO | QTY |
|------|---------------------------------|---------|-----|
| 1 | CAP, LUG NUT | 0338405 | 3 |
| 2 | JAM NUT | 0338060 | 3 |
| 3 | FLAT WASHER | 0353145 | 3 |
| 4 | O-RING, 3" ID | 0343003 | 6 |
| 5 | CONE BEARING | 0303089 | 6 |
| 6 | BEARING CUP | 0303090 | 6 |
| 7 | SHAFT, ROLL HOUSING PIVOT | 0248392 | 1 |
| 8 | MOTOR, HYD. (FRONT ROLL) | 0330139 | 1 |
| 9 | HYD. CYLINDER | 0330251 | 2 |
| 10 | HOUSING, ROLL - FRONT | 0228365 | 1 |
| 11 | BALL JOINT ROD END LINKAGE | 0303110 | 2 |
| 12 | CHAIN, ROLL DRIVE #50- 55 PITCH | 0309027 | 1 |
| 13 | PLATE, FOOT STEP- DIAMOND PLATE | 0490534 | 2 |

| REVISIONS | | |
|-----------|-------------|------|
| REV | DESCRIPTION | DATE |
| | | |

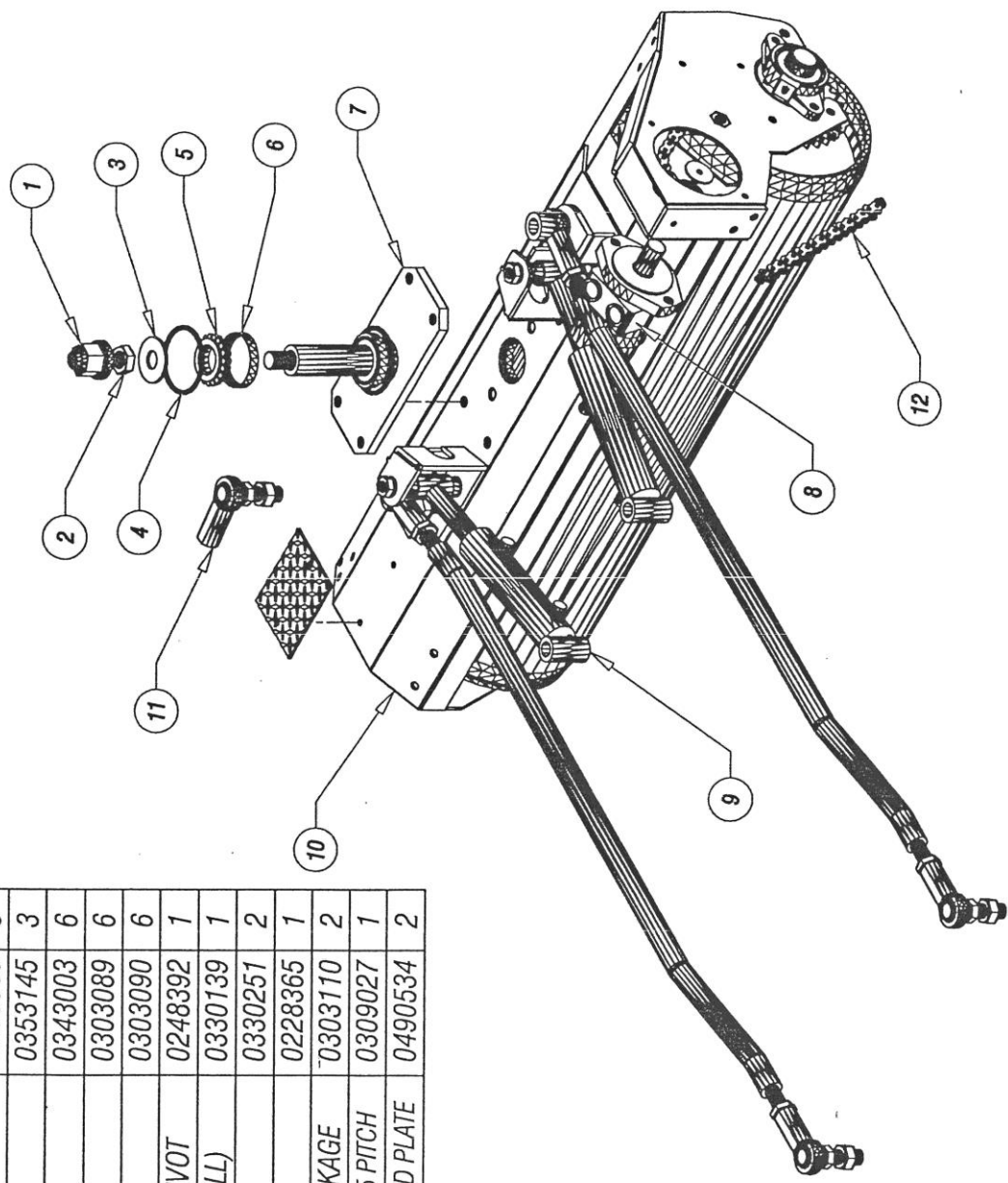

CORE RECOVERY VEHICLE- CRV MODEL 0009130- DWG #3

| REV. | DESCRIPTION | DATE |
|------|-------------|------|
| | | |
| | | |

| ITEM | DESCRIPTION | DWG NO | QTY |
|------|--|---------|-----|
| 1 | COLLAR, BRUSH CLAMPING | 0211064 | 4 |
| 2 | PULLEY, BRUSH DRIVE | 0242276 | 2 |
| 3 | SHAFT, ROLLER BRUSH | 0248421 | 2 |
| 4 | MOUNT, ROLLER BRUSH SHAFT DRIVE- RIGHT & FRONT | 0276928 | 2 |
| 5 | MOUNT, ROLLER BRUSH SHAFT IDLER- RIGHT & FRONT | 0490366 | 2 |
| 6 | MOUNT, ROLLER BRUSH DRIVE- RIGHT & FRONT | 0276932 | 2 |
| 7 | BEARING INSERT- Ø5/8" BORE (INCLUDES LOCKING COLLAR) | 0303053 | 4 |
| 8 | BEARING FLANGETTE- FOR Ø5/8" BEARING | 0303054 | 8 |
| 9 | BRACKET, ROLL BRUSH SHAFT IDLER- FRONT & RIGHT REAR | 0488176 | 2 |
| 10 | BRUSH, OPEN COIL | 0336142 | 2 |
| 11 | SCREW, HEX HEAD CAP- 3/8-16 x 1" LONG | 0346249 | 16 |

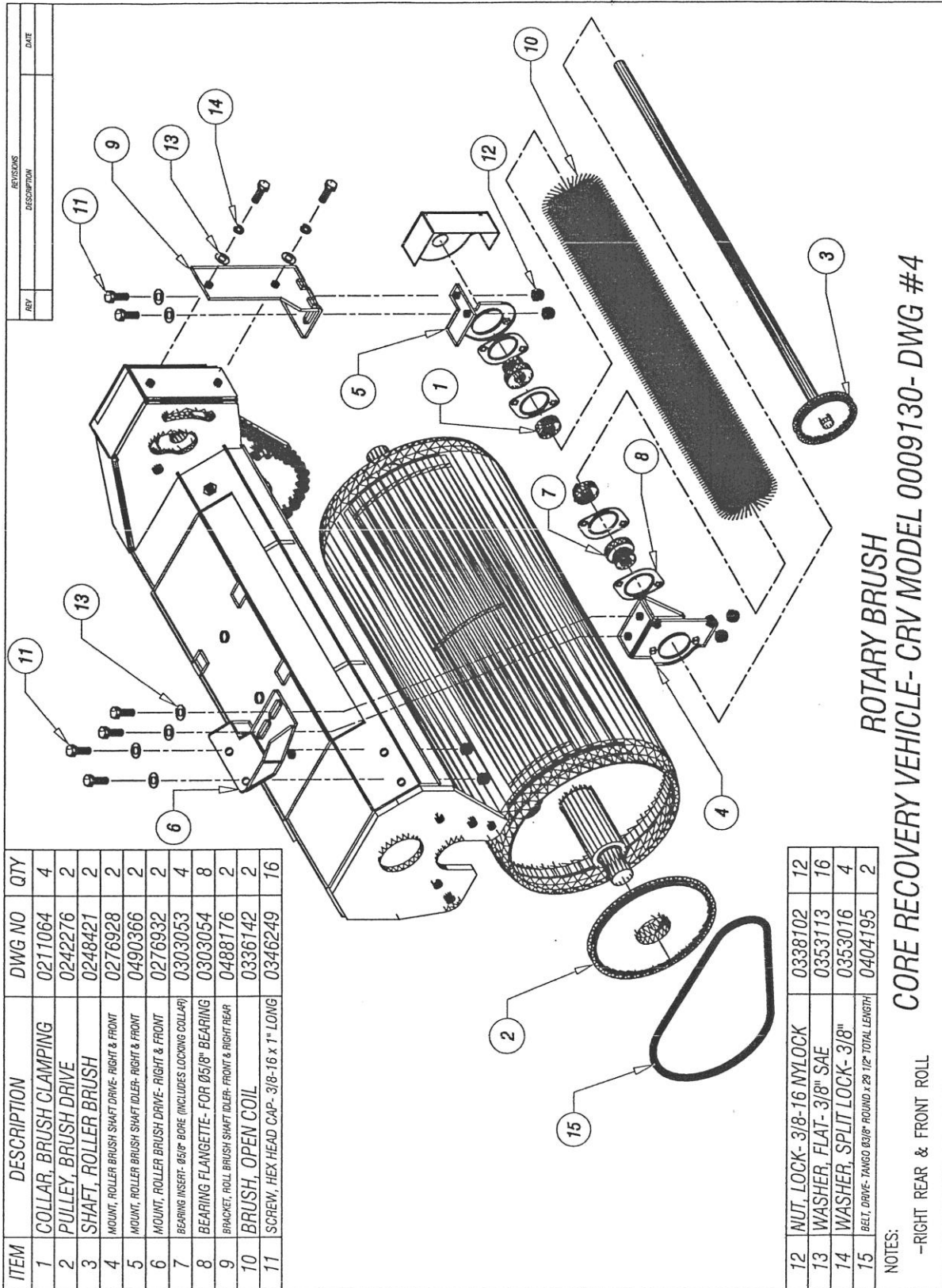

ROTARY BRUSH
CORE RECOVERY VEHICLE-CRV MODEL 0009130-DWG #4

| | | | |
|----|---|---------|----|
| 12 | NUT, LOCK- 3/8-16 NYLOCK | 0338102 | 12 |
| 13 | WASHER, FLAT- 3/8" SAE | 0353113 | 16 |
| 14 | WASHER, SPLIT LOCK- 3/8" | 0353016 | 4 |
| 15 | BELT, DRIVE- TANGO Ø3/8" ROUND x 29 1/2" TOTAL LENGTH | 0404195 | 2 |

NOTES:

-RIGHT REAR & FRONT ROLL

| REV | DESCRIPTION | DATE |
|-----|-------------|------|
| | | |

| ITEM | DESCRIPTION | DWG NO | QTY |
|------|--|---------|-----|
| 1 | COLLAR, BRUSH CLAMPING | 0211064 | 4 |
| 2 | PULLEY, BRUSH DRIVE | 0242276 | 2 |
| 3 | SHAFT, ROLLER BRUSH | 0248421 | 2 |
| 4 | MOUNT, ROLLER BRUSH SHAFT DRIVE- LEFT | 0276927 | 2 |
| 5 | MOUNT, ROLLER BRUSH SHAFT IDLER- LEFT | 0490367 | 2 |
| 6 | MOUNT, ROLLER BRUSH DRIVE- LEFT | 0276931 | 2 |
| 7 | BEARING INSERT- Ø3/8" BORE (INCLUDES LOCKING COLLAR) | 0303053 | 4 |
| 8 | BEARING FLANGETTE- FOR Ø5/8" BEARING | 0303054 | 8 |
| 9 | BRACKET, ROLL BRUSH SHAFT IDLER- LEFT | 0488174 | 2 |
| 10 | BRUSH, OPEN COIL | 0336142 | 2 |
| 11 | SCREW, HEX HEAD CAP- 3/8-16 x 1" LONG | 0346249 | 16 |

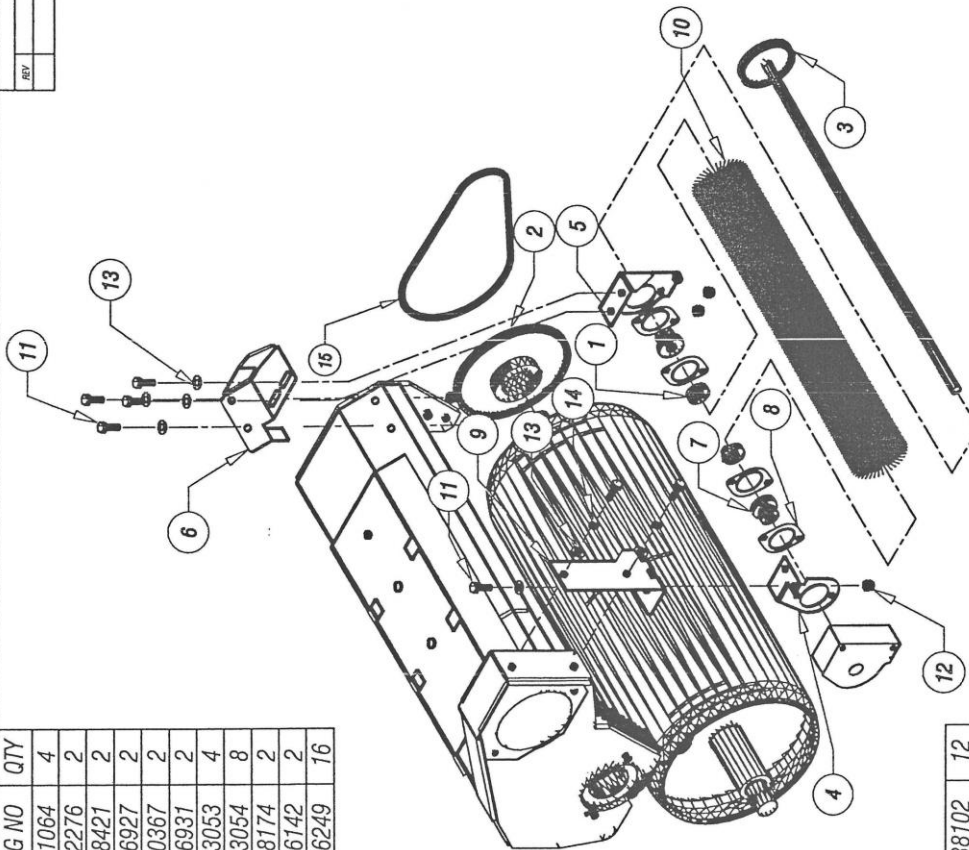

| | | | |
|----|---|---------|----|
| 12 | NUT, LOCK- 3/8-16 NYLOCK | 0338102 | 12 |
| 13 | WASHER, FLAT- 3/8" SAE | 0353113 | 16 |
| 14 | WASHER, SPLIT LOCK- 3/8" | 0353016 | 4 |
| 15 | BELT, DRIVE- TANGO Ø3/8" ROUND x 28 1/2" TOTAL LENGTH | 0404195 | 2 |

NOTES:

-LEFT REAR ROLL

ROTARY BRUSH
CORE RECOVERY VEHICLE- CRV MODEL 0009130- DWG #5

| REV | DESCRIPTION | DATE |
|-----|-------------|------|
| | | |

| ITEM | DESCRIPTION | PART No | QTY |
|------|------------------------|---------|-----|
| 1 | TANK, HYDRAULIC | 0252131 | 1 |
| 2 | HOUSING, SEAT | 0228362 | 1 |
| 3 | BOX, BATTERY | 0280085 | 1 |
| 4 | HANDLE, STEERING TOWER | 0223169 | 1 |
| 5 | STEP, CRV | 0273052 | 1 |
| 6 | STEP, SRV- SIDE | 0273053 | 1 |
| 7 | STEERING COLUMN SPLINE | 0330230 | 1 |
| 8 | WHEEL, STEERING | 0354142 | 1 |

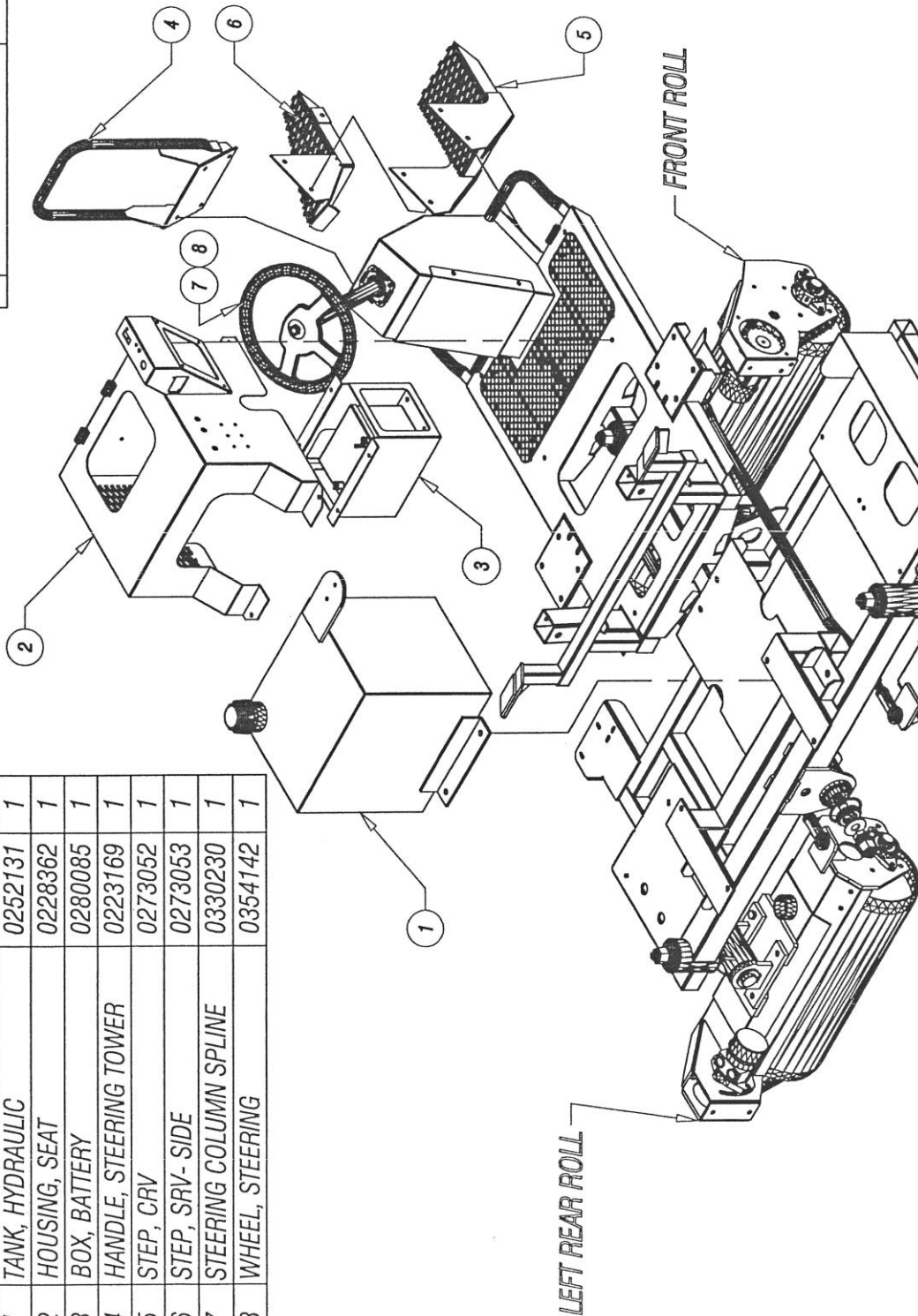

CORE RECOVERY VEHICLE- CRV MODEL 0009130- DWG #6

| REV | | REVISIONS | DATE |
|-----|-------------|-----------|------|
| REV | DESCRIPTION | | |
| | | | |

| ITEM | DESCRIPTION | PART No | QTY |
|------|--|---------|-----|
| 1 | SHAFT, PIVOT ELEVATOR | 0448448 | 1 |
| 2 | BAR, ROLL | 0270184 | 1 |
| 3 | SEAT WITH ARM REST | 0347013 | 1 |
| 4 | PLATE, SEAT MOUNTING | 0290218 | 1 |
| 5 | LEVER, ELEVATOR MOUNTING- RIGHT | 0233335 | 1 |
| 6 | LEVER, ELEVATOR LIFT- RIGHT | 0233337 | 1 |
| 7 | MOUNT, ELEVATOR PIVOT BEARING SUPPORT- RIGHT | 0291128 | 1 |
| 8 | MOUNT, ELEVATOR PIVOT- RIGHT | 0291125 | 1 |
| 9 | BEARING- 4 BOLT FLANGE | 0303002 | 2 |
| 10 | COVER, CONTROL BOX | 0471505 | 1 |

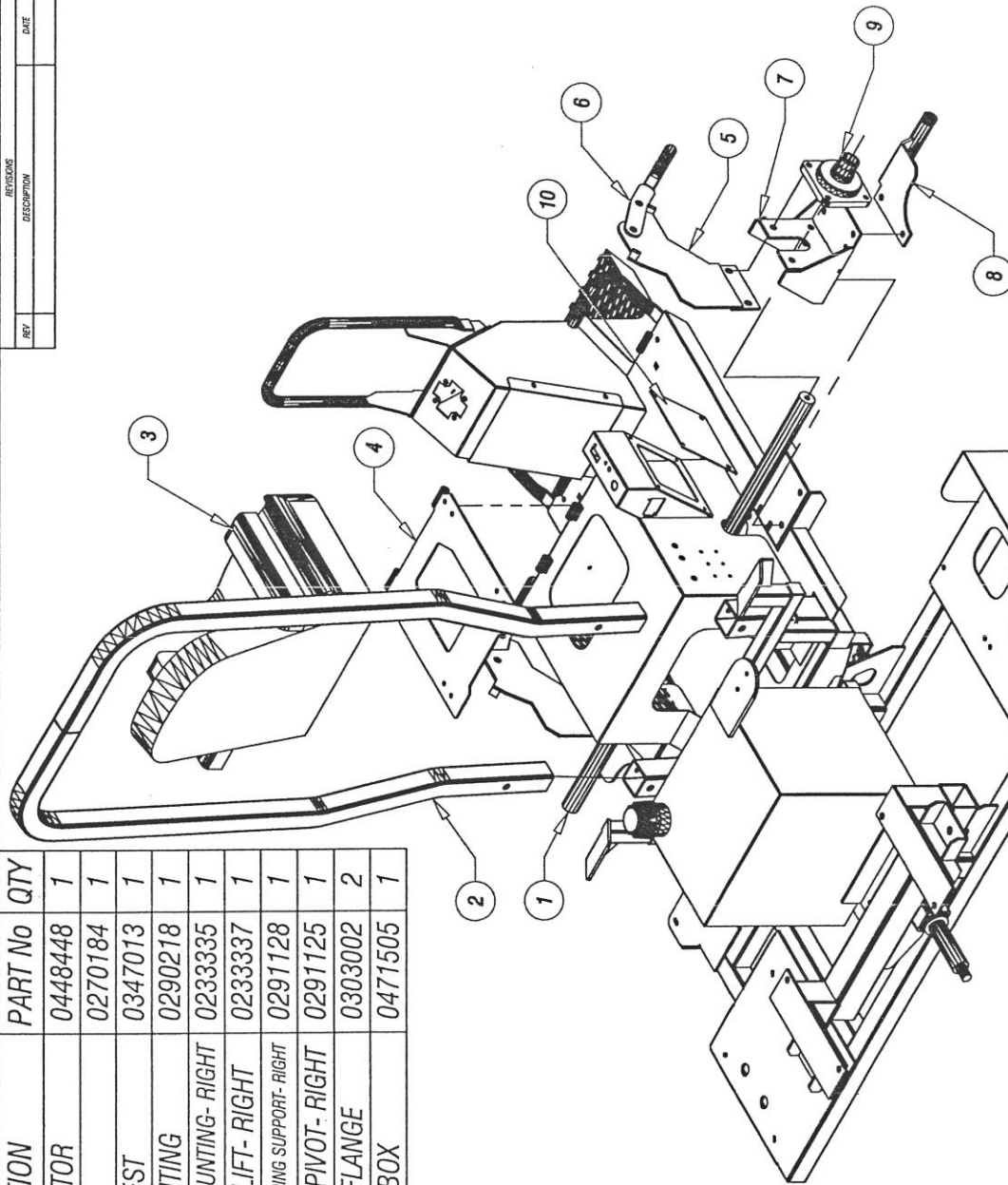

CORE RECOVERY VEHICLE- CRV MODEL 0009130- DWG #7

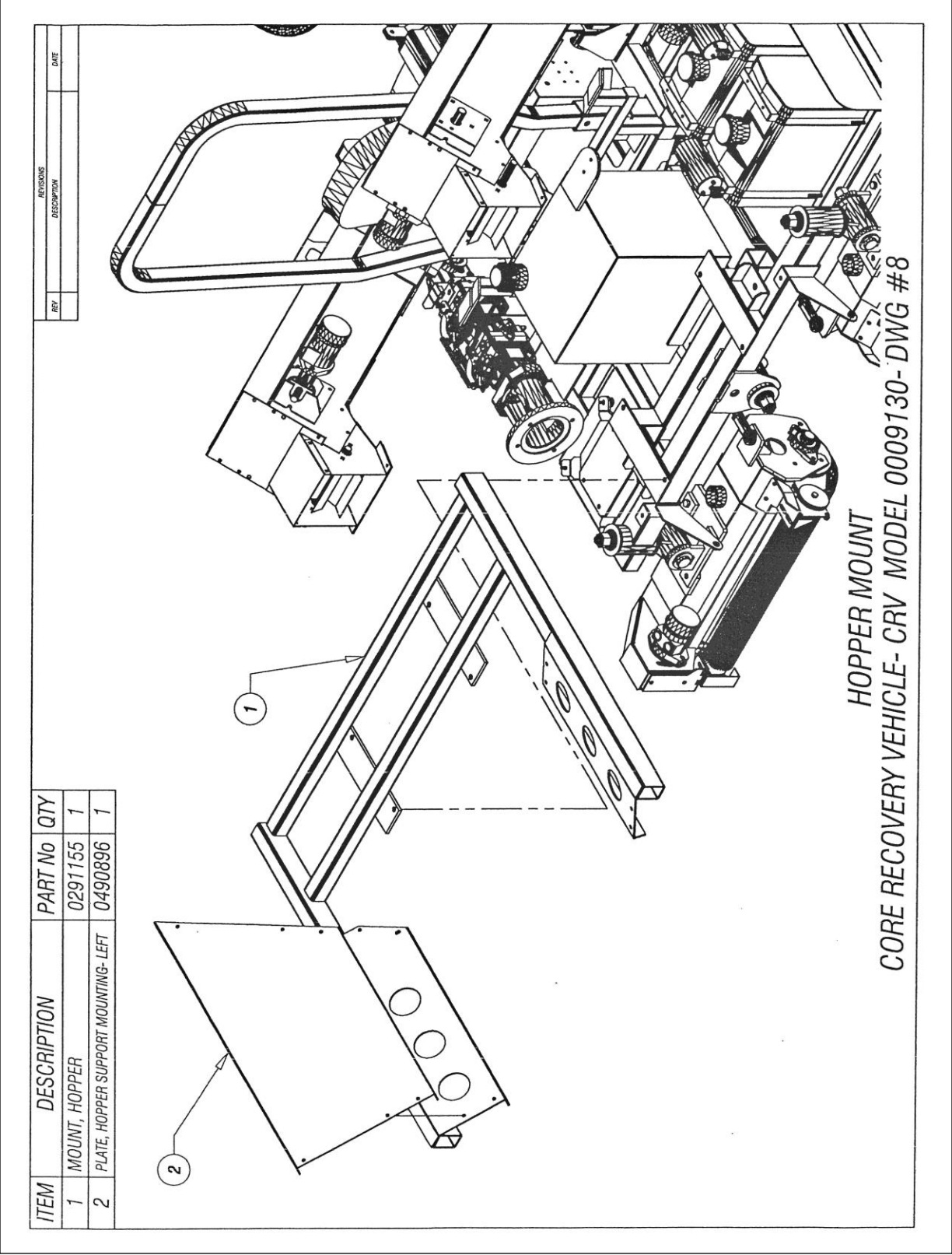

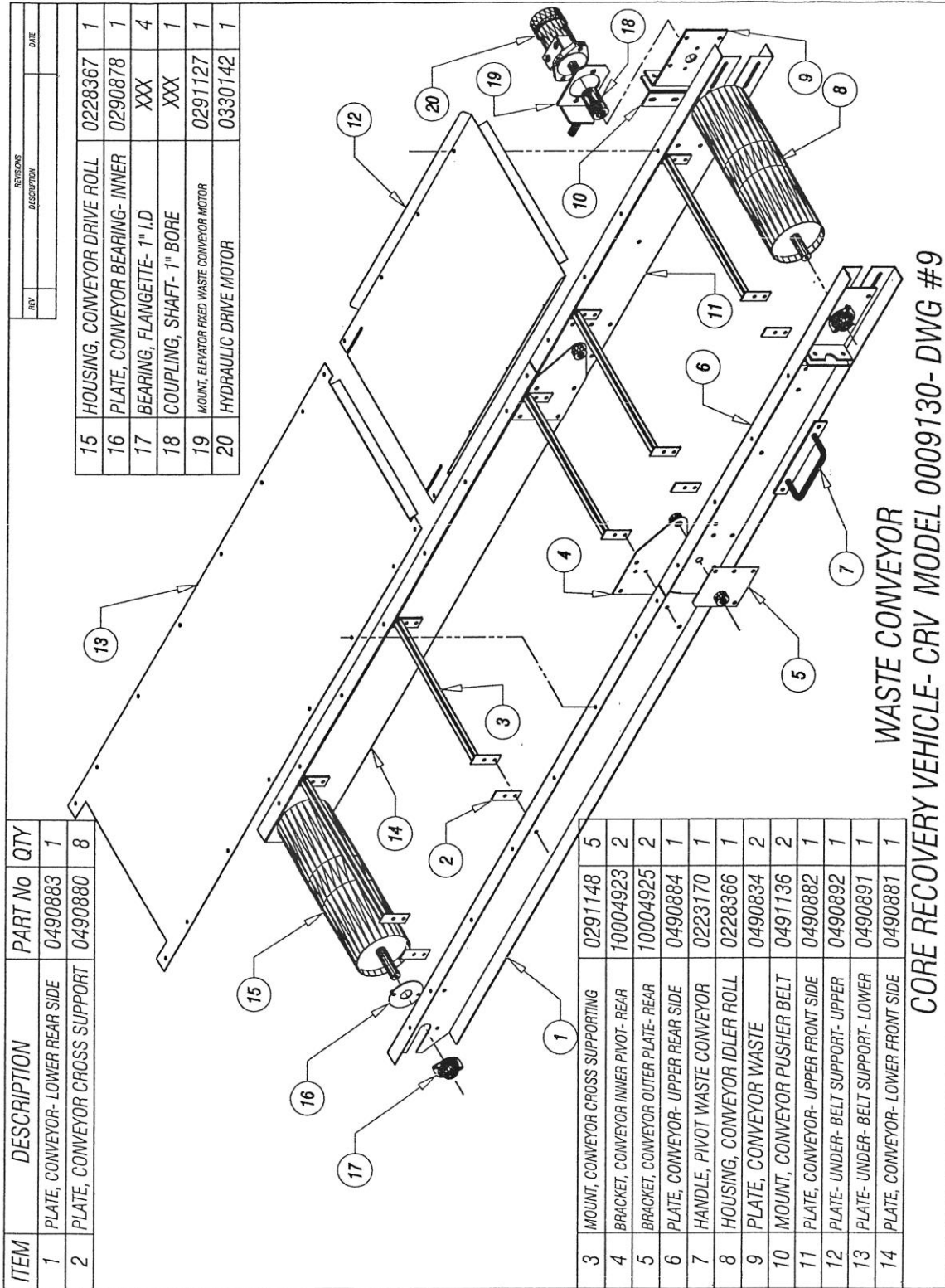

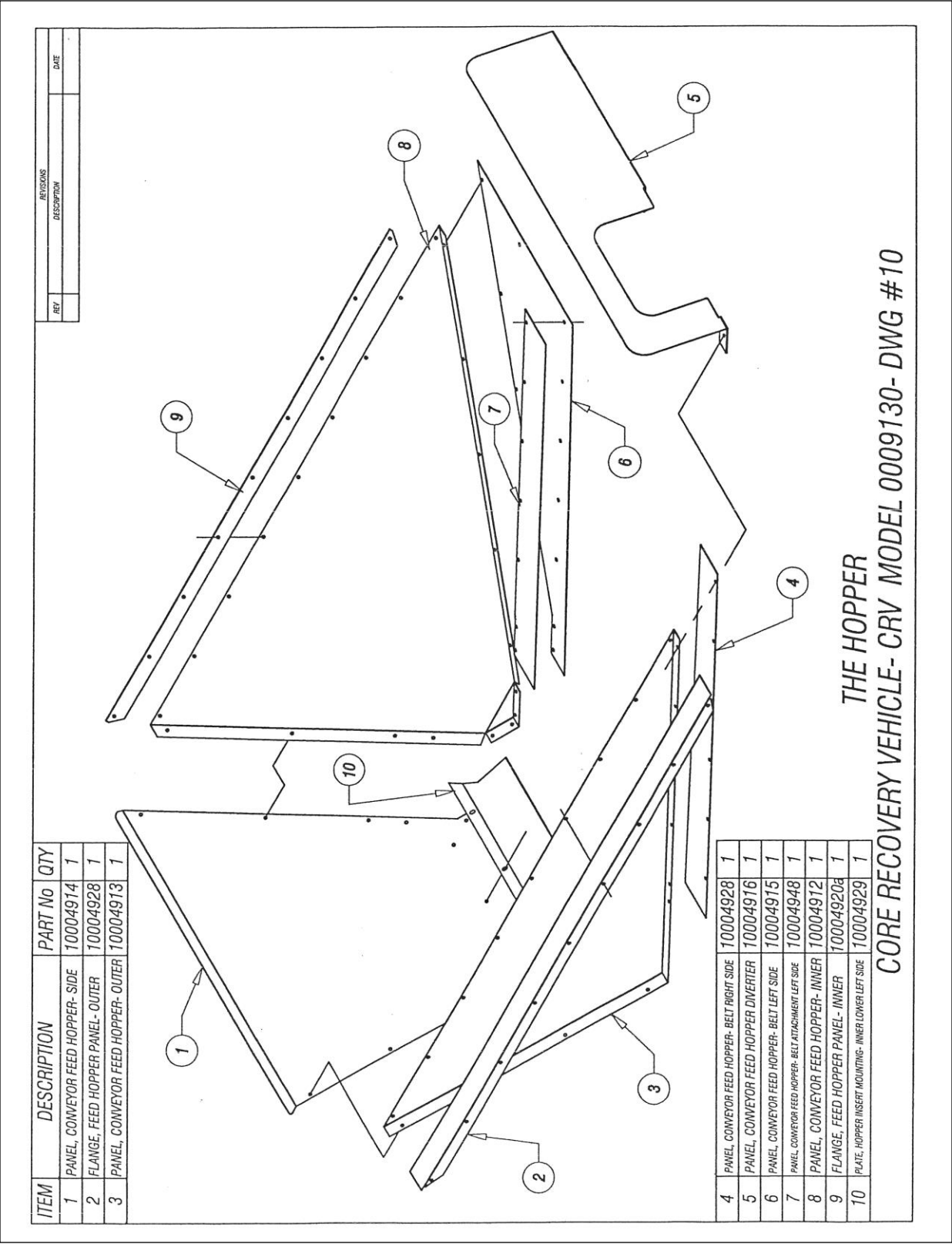

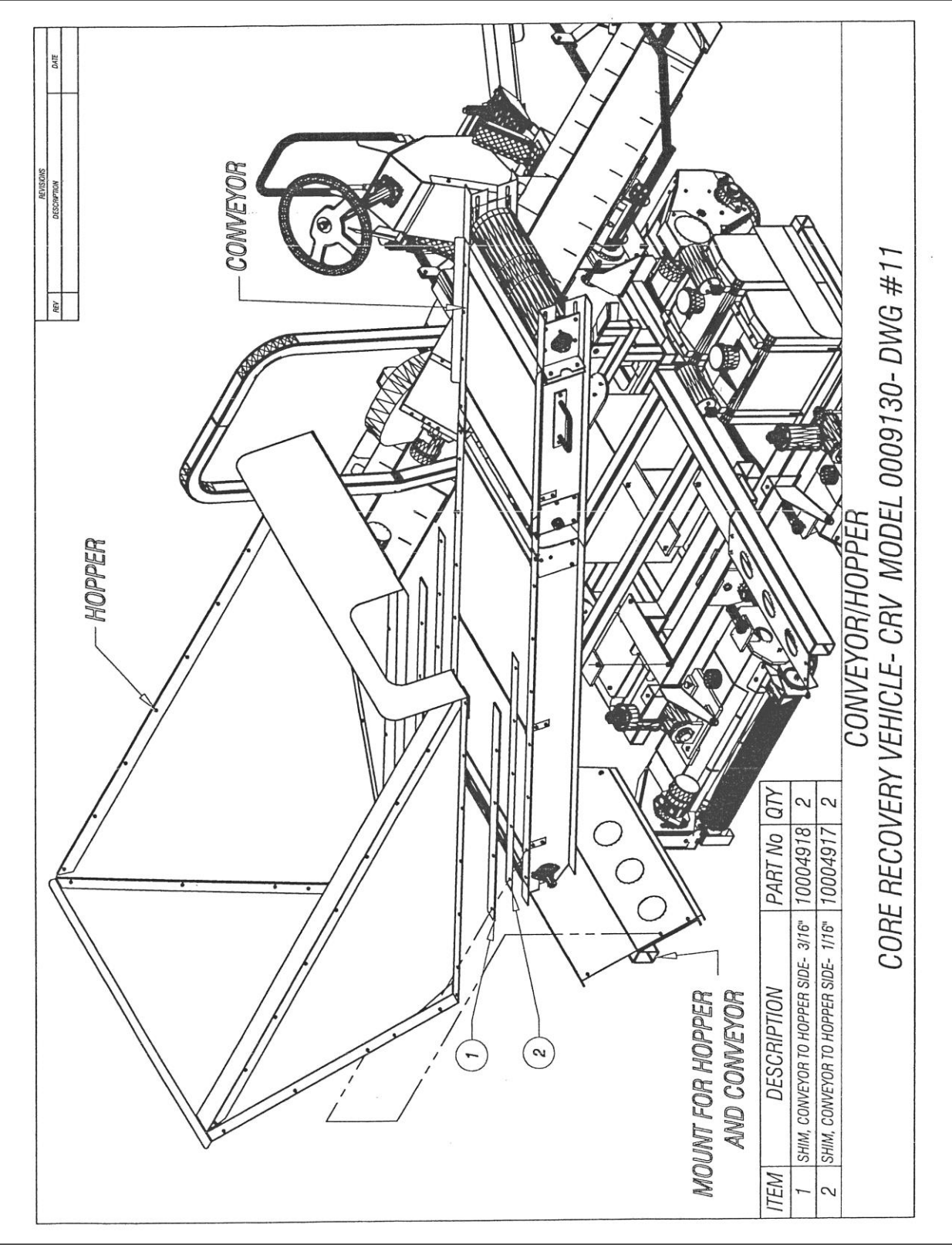

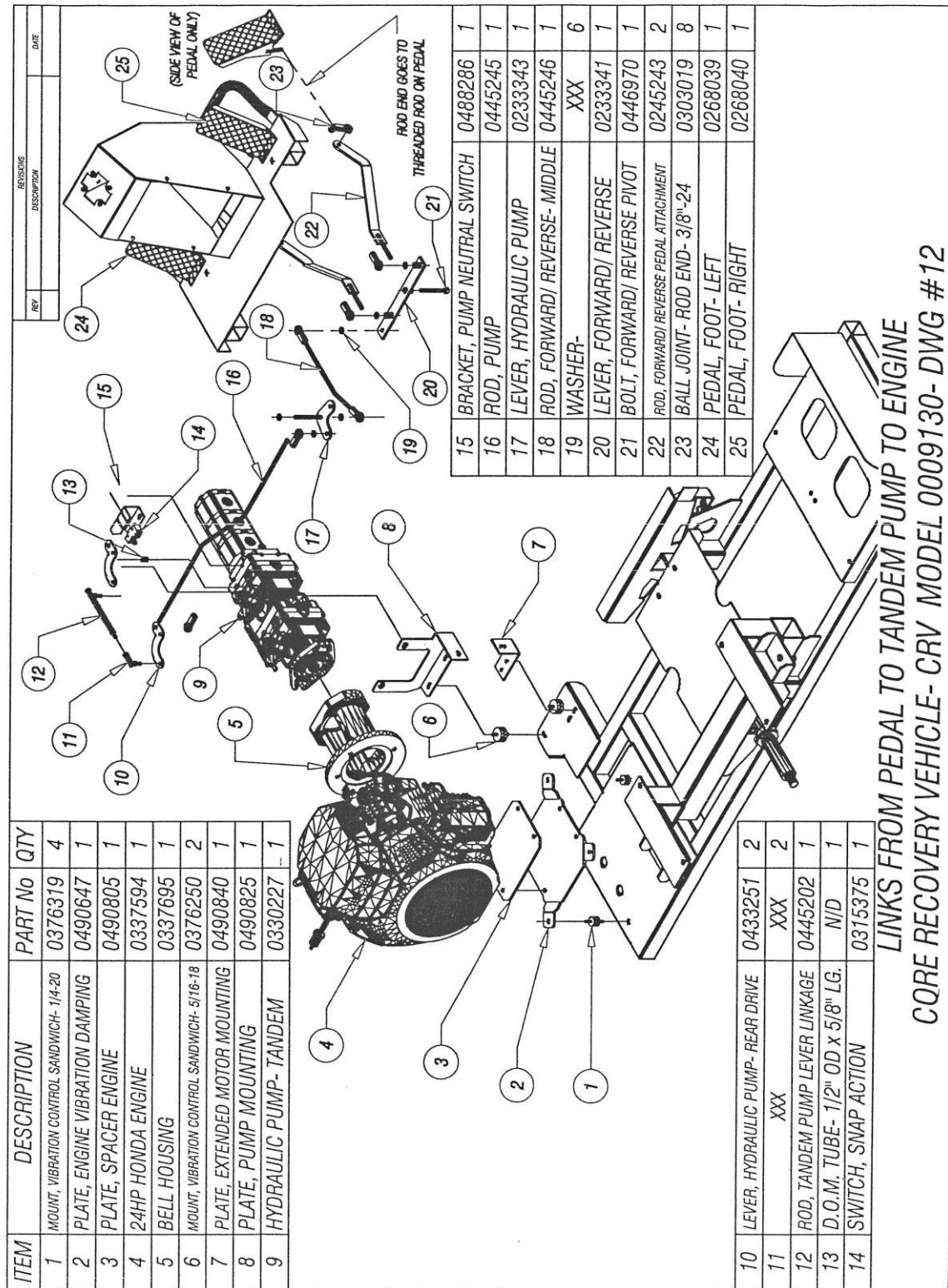

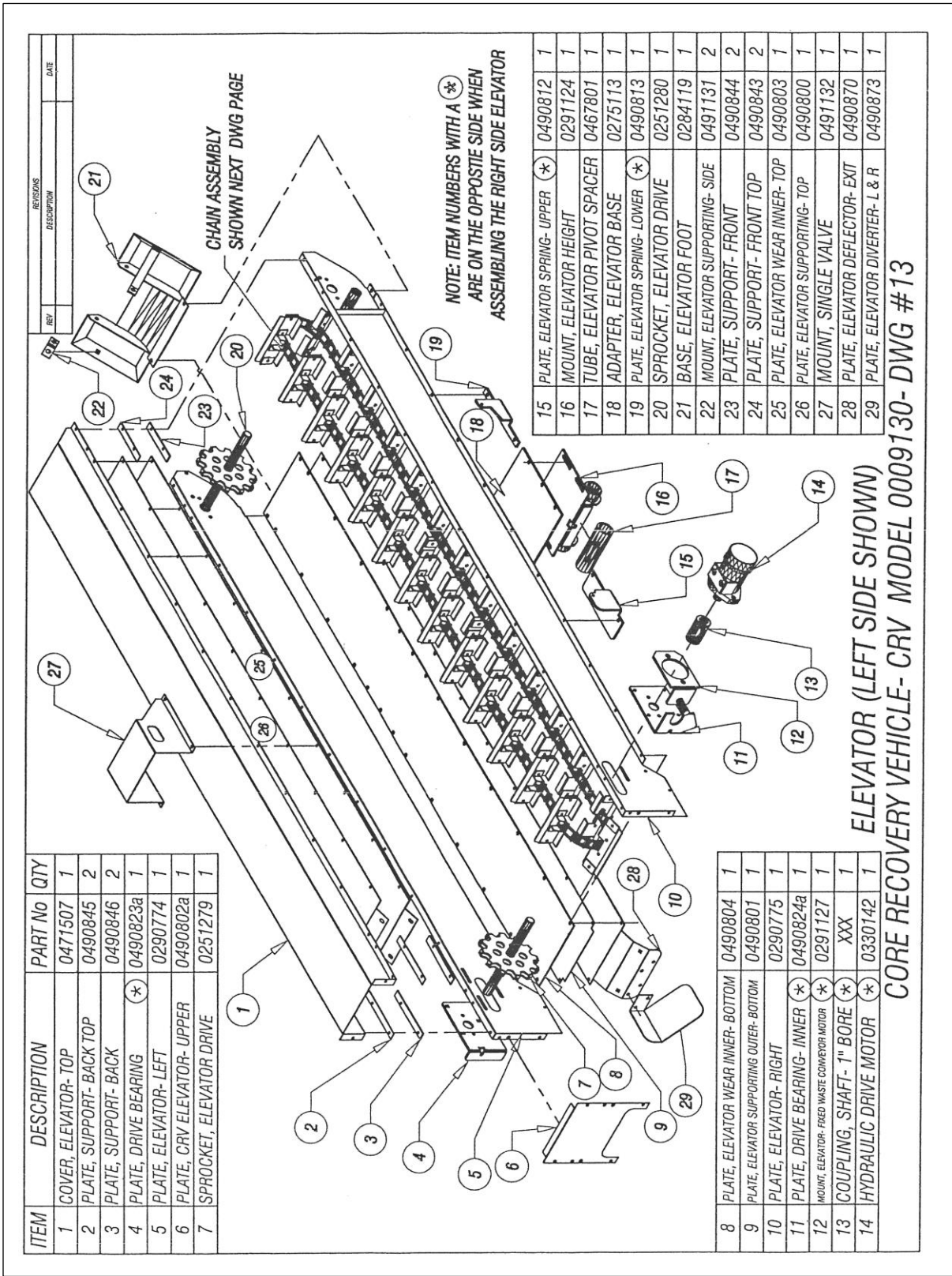

| REV | DESCRIPTION | DATE |
|-----|-------------|------|
| | | |

| ITEM | DESCRIPTION | PART No | QTY |
|------|---------------------------|---------|-----|
| 1 | 55 STEEL DETACHABLE CHAIN | XXX | 84 |
| 2 | ATTACHMENT LINK- 55SD | XXX | 27 |
| 3 | PLATE, ELEVATOR PADDLE | 0490833 | 27 |
| 4 | PLATE, PADDLE STRIP- SIDE | 0490799 | 54 |
| 5 | MASTER LINK- CD55 | XXX | 1 |

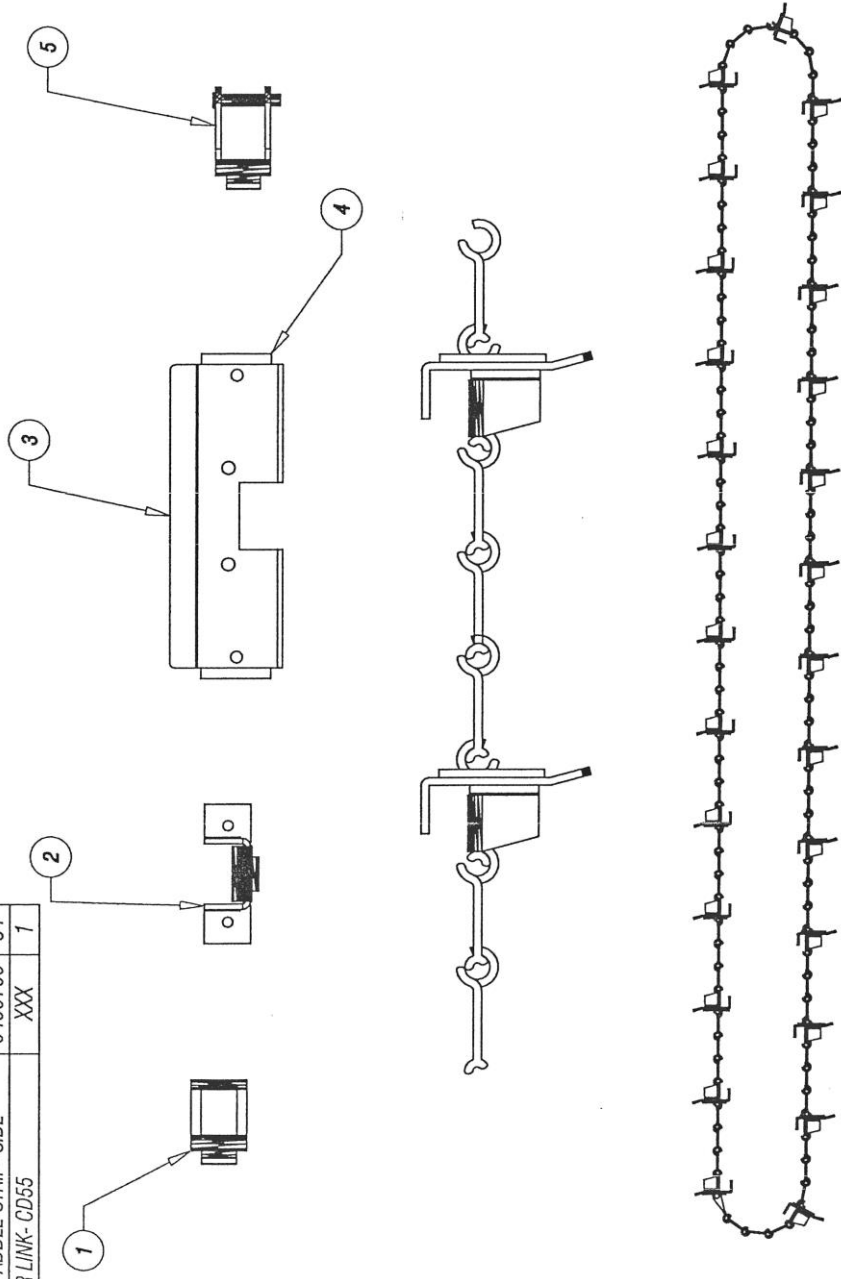

ELEVATOR CHAIN W/ BLADES ATTACHED (2 PER MACHINE)
 CORE RECOVERY VEHICLE- CRV MODEL 0009130- DWG #14

| REVISIONS | | DATE |
|-----------|-------------|------|
| REV | DESCRIPTION | |
| | | |

| ITEM | DESCRIPTION | PART No | QTY |
|------|----------------------|---------|-----|
| 1 | ELEVATOR- LEFT SIDE | N/D | 1 |
| 2 | ELEVATOR- RIGHT SIDE | N/D | 1 |

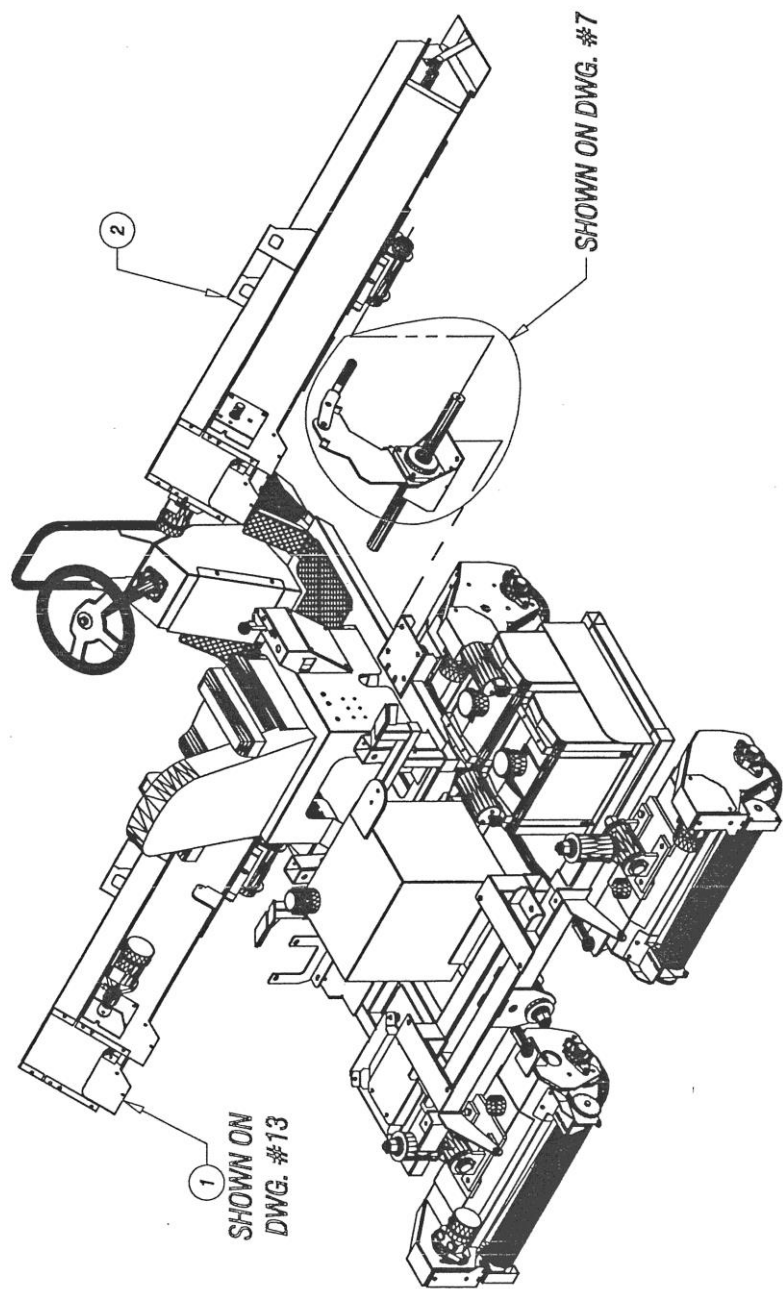

ELEVATORS (FULLY ASSEMBLED)
CORE RECOVERY VEHICLE- CRV MODEL 0009130- DWG #15

| REV | | REVISIONS | DATE |
|-----|--|-------------|------|
| | | DESCRIPTION | |

| ITEM | DESCRIPTION | PART No | QTY |
|------|---------------------------------------|---------|-----|
| 1 | TUBE, BLADE PIVOT | 0267790 | 2 |
| 2 | BUSHING, OILITE FLANGED | XXX | 8 |
| 3 | COLLAR, SET- 3/4" I.D | 0311006 | 2 |
| 4 | PIN, ELEVATOR PIVOT | 0240236 | 2 |
| 5 | ADAPTER, BLADE | 0475114 | 2 |
| 6 | PIN, CORE COLLECTION BLADE LINK PIVOT | 0440235 | 2 |

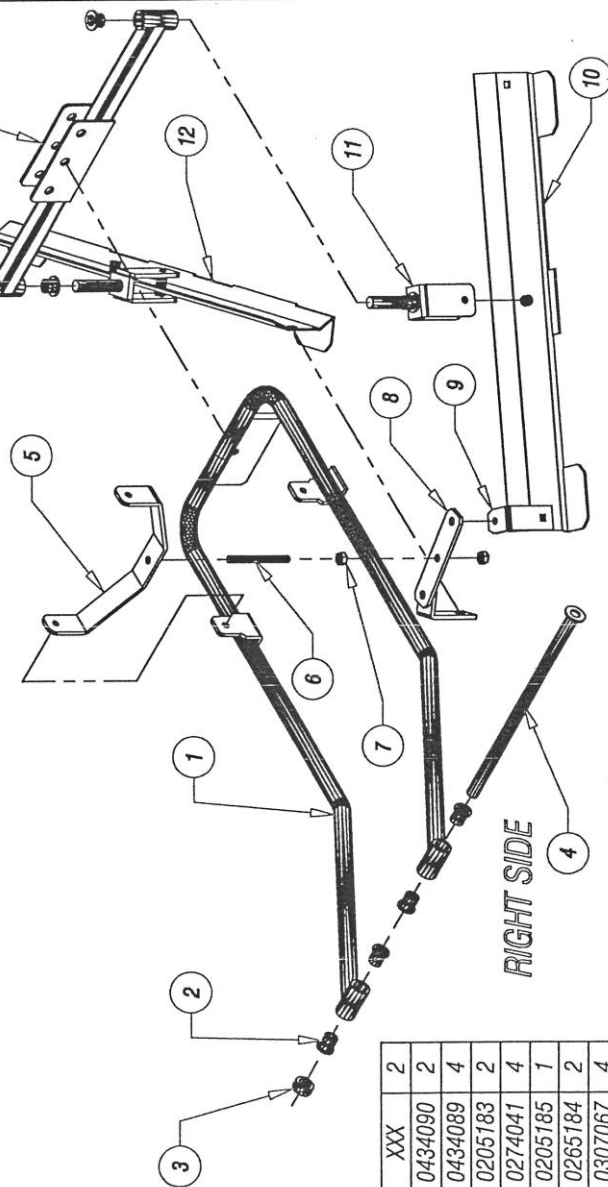
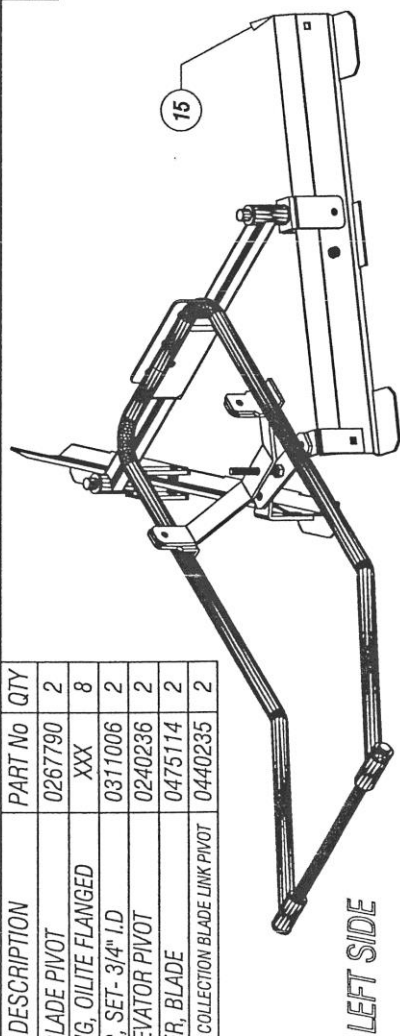

| | | | |
|----|--|---------|---|
| 7 | NUT, HEX- 7/16-14 | XXX | 2 |
| 8 | LINK, CORE COLLECTION BLADE- LOWER REAR | 0434090 | 2 |
| 9 | LINK, CORE COLLECTION BLADE- LOWER | 0434089 | 4 |
| 10 | BLADE, CORE COLLECTION- LEFT & RIGHT | 0205183 | 2 |
| 11 | YOKE, CORE COLLECTION BLADE PIVOT | 0274041 | 4 |
| 12 | BLADE, CORE COLLECTION- RIGHT SIDE INNER | 0205185 | 1 |
| 13 | ARM, BLADE SUPPORTING | 0265184 | 2 |
| 14 | BUSHING, OILITE FLANGED | 0307067 | 4 |
| 15 | BLADE, CORE COLLECTION- LEFT SIDE INNER | 0205184 | 1 |

ELEVATORS FRONTS BLADES CORE RECOVERY VEHICLE- CRV MODEL 0009130- DWG #16

| REV | DESCRIPTION | DATE |
|-----|-------------|------|
| | | |

| ITEM | DESCRIPTION | PART No | QTY |
|------|-----------------|---------|-----|
| 1 | BLADE ASSEMBLED | N/D | 2 |

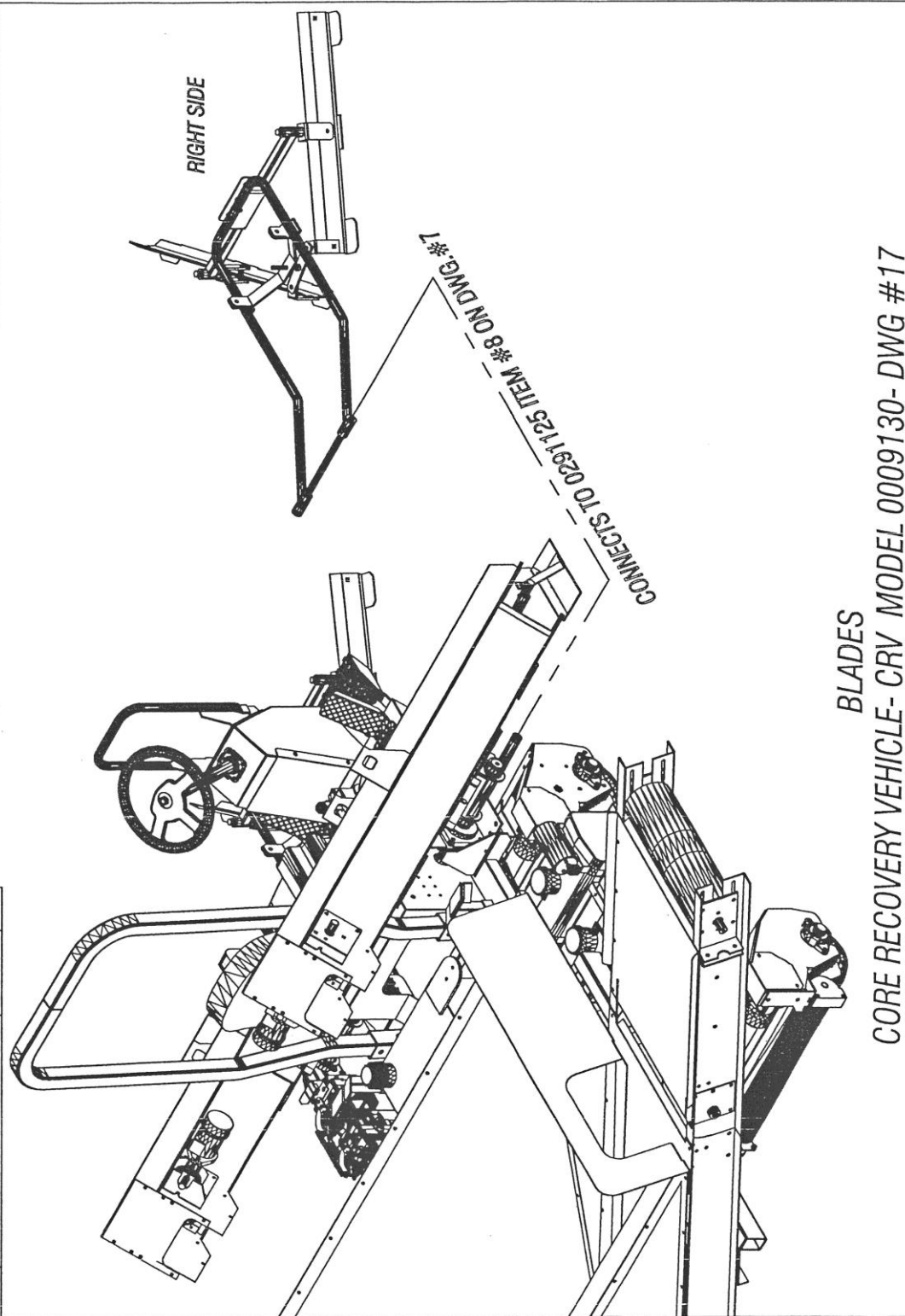

BLADES
CORE RECOVERY VEHICLE- CRV MODEL 0009130- DWG #17

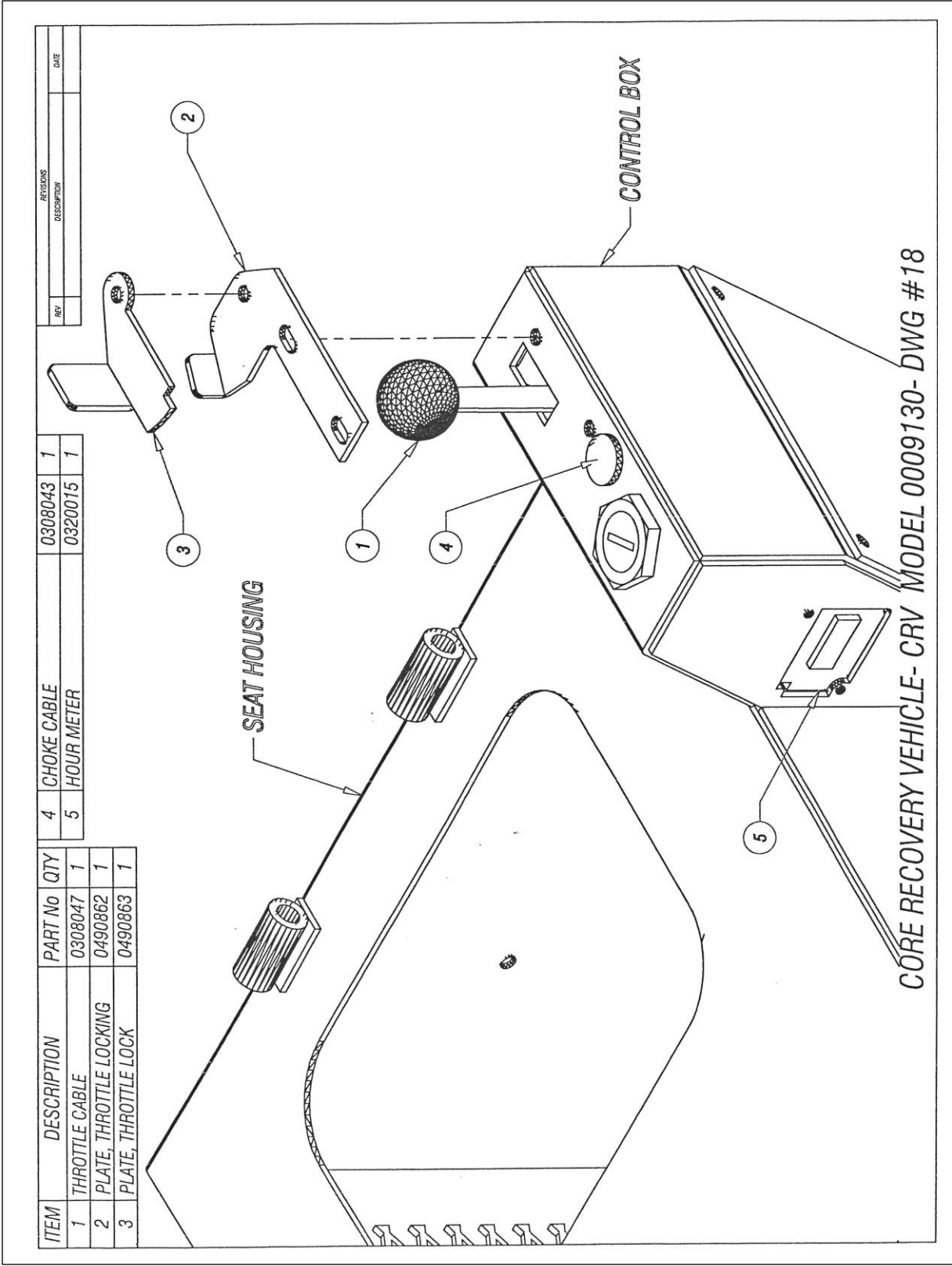

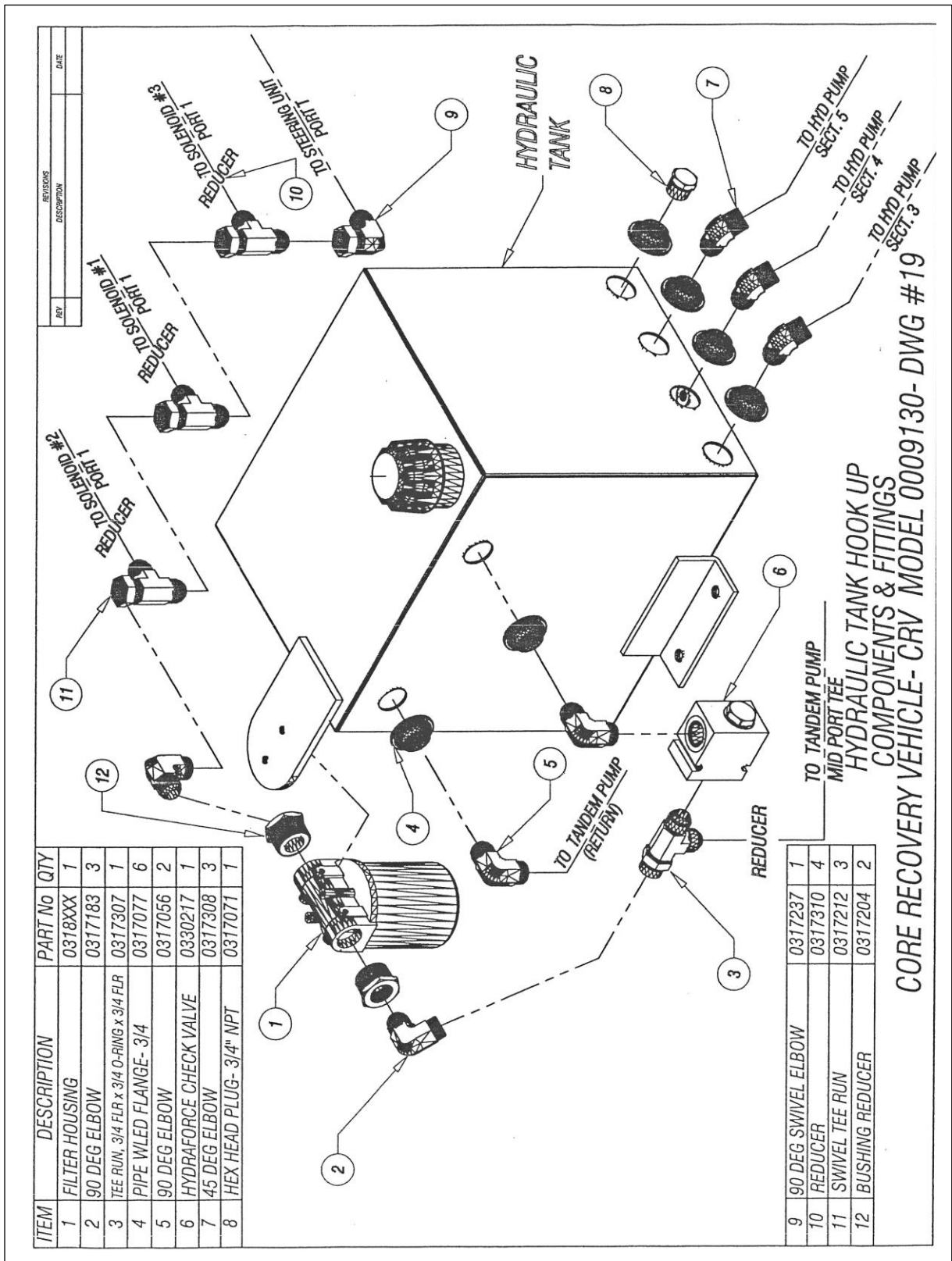

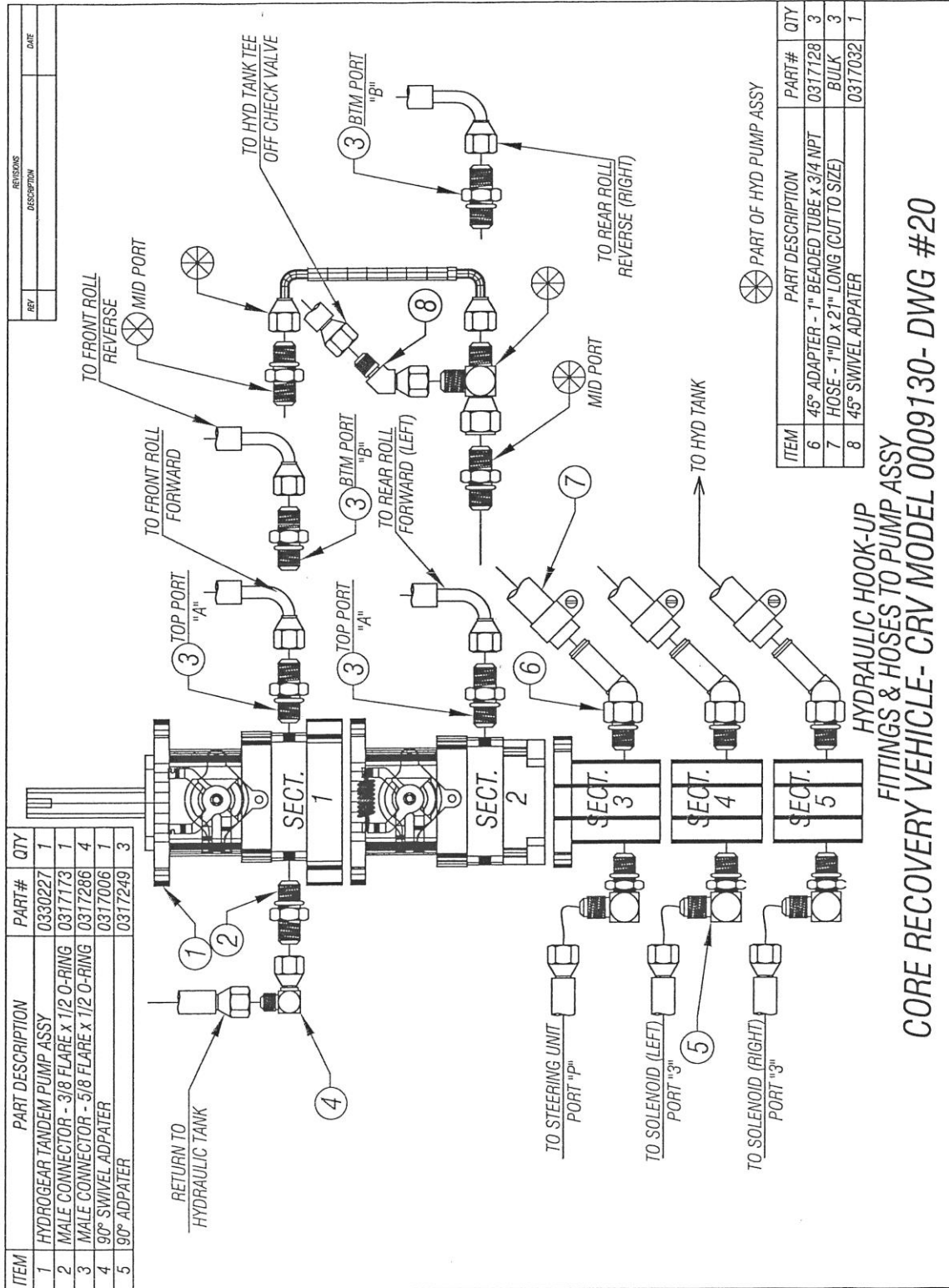

| REV | | REVISIONS DESCRIPTION | DATE |
|-----|--|--------------------------|------|
| | | | |

| ITEM | PART DESCRIPTION | PART# | QTY |
|------|--|---------|-----|
| 1 | STEERING UNIT VALVE | 0330231 | 1 |
| 2 | MALE CONNECTOR, 3/8 FLARE x 3/8 O-RING | 0317041 | 3 |
| 3 | 90° O-RING ELBOW, 3/8 FLARE x 3/8 O-RING | 0317029 | 2 |
| 4 | HOSE, 3/8 ID x 92" LONG - 90° (1) END | 0327539 | 1 |
| 5 | HOSE, 3/8 ID x 44" LONG - 90° (1) END | 0327479 | 1 |
| 6 | HOSE, 3/8 ID x 64" LONG - 90° (1) END | 0327545 | 1 |
| 7 | HOSE, 3/8 ID x 44" LONG - 90° (1) END | 0327333 | 1 |

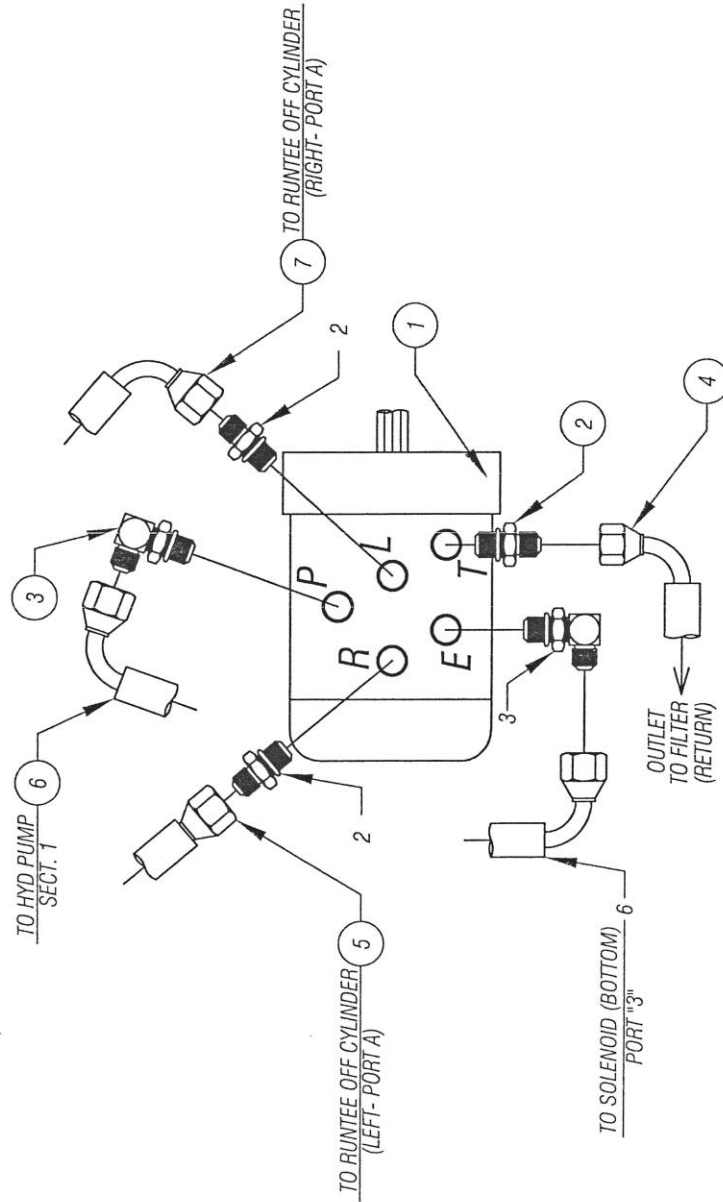

HYDRAULIC HOOK-UP
STEERING UNIT
CORE RECOVERY VEHICLE- CRV MODEL 0009130- DWG #21

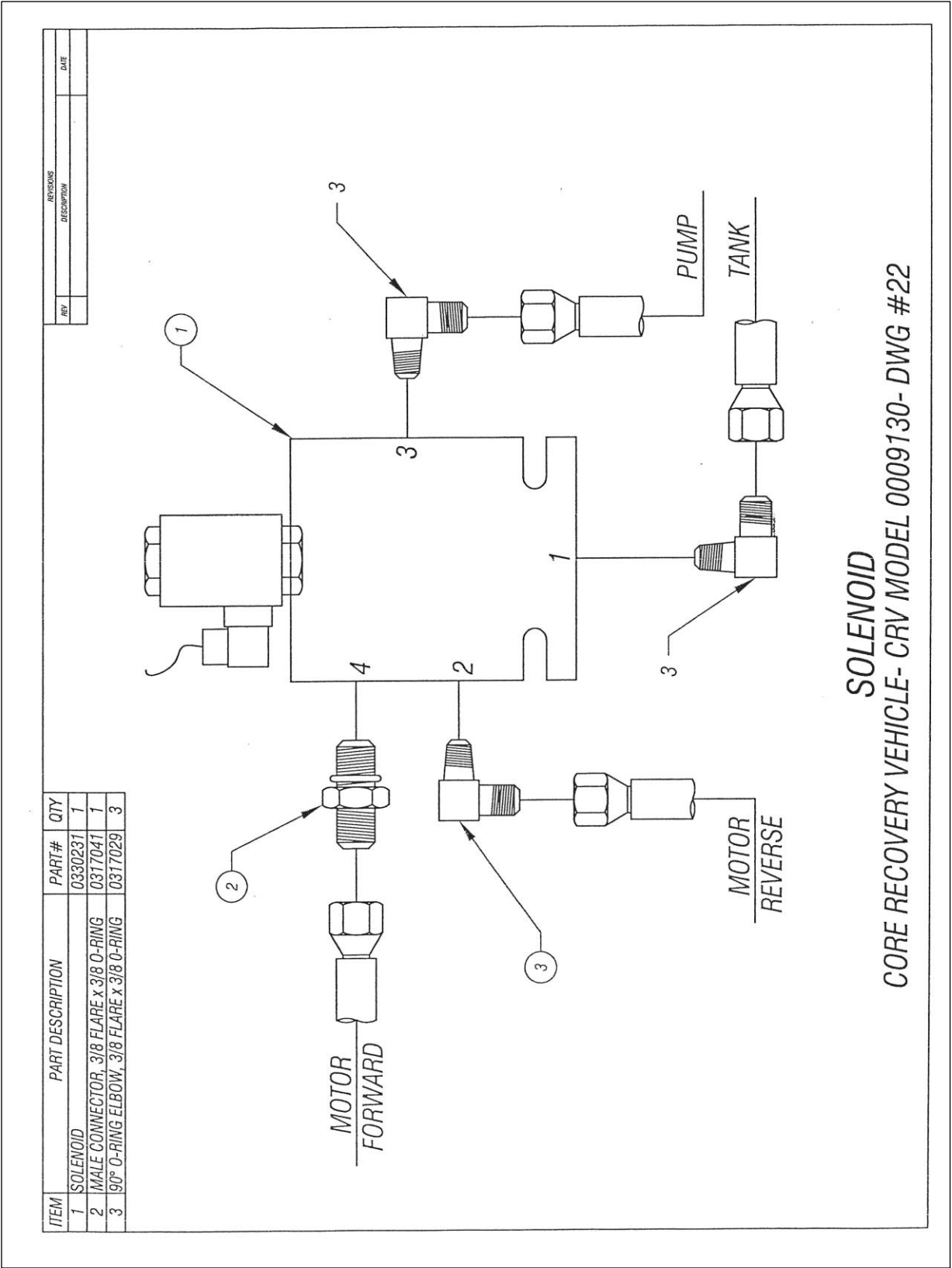

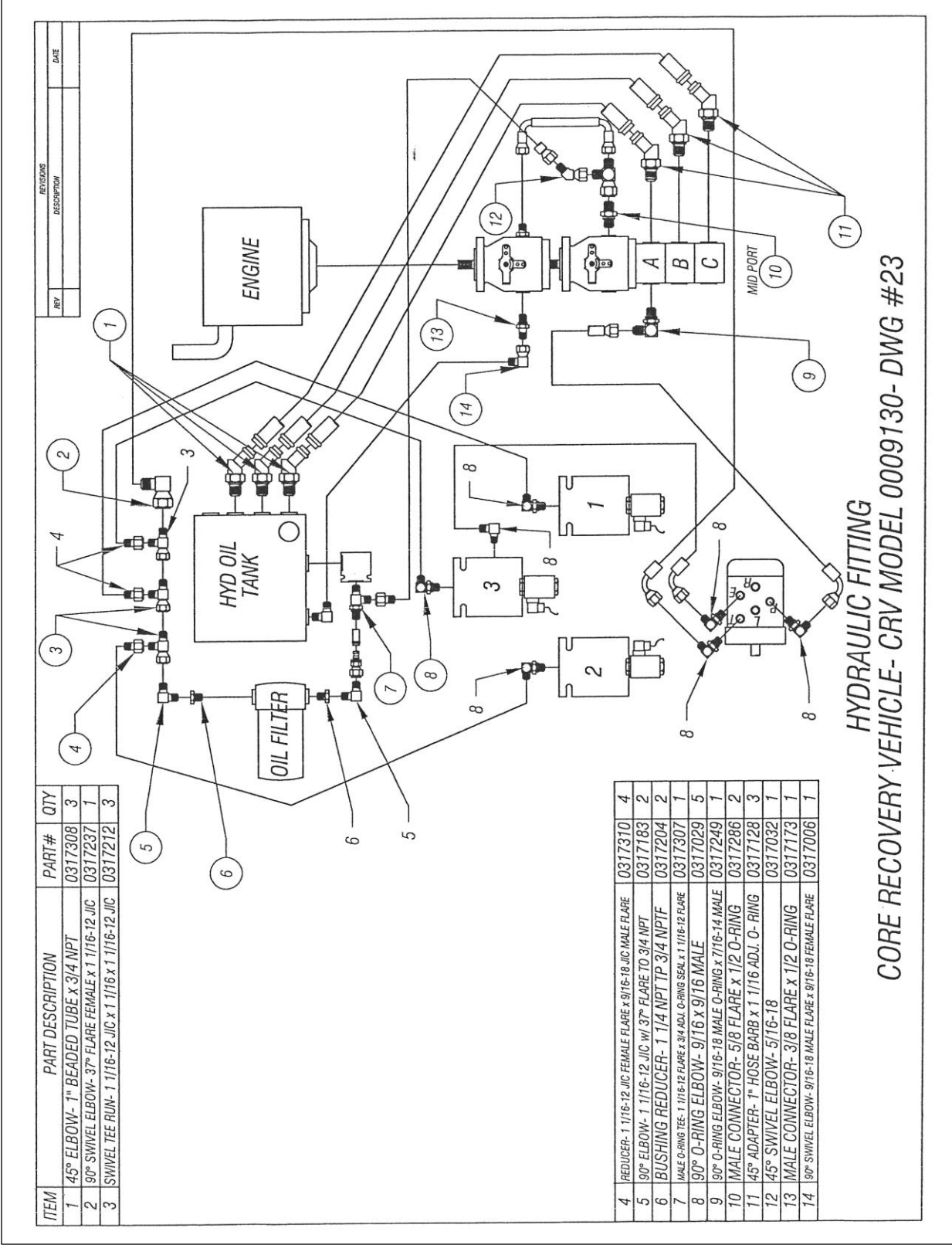

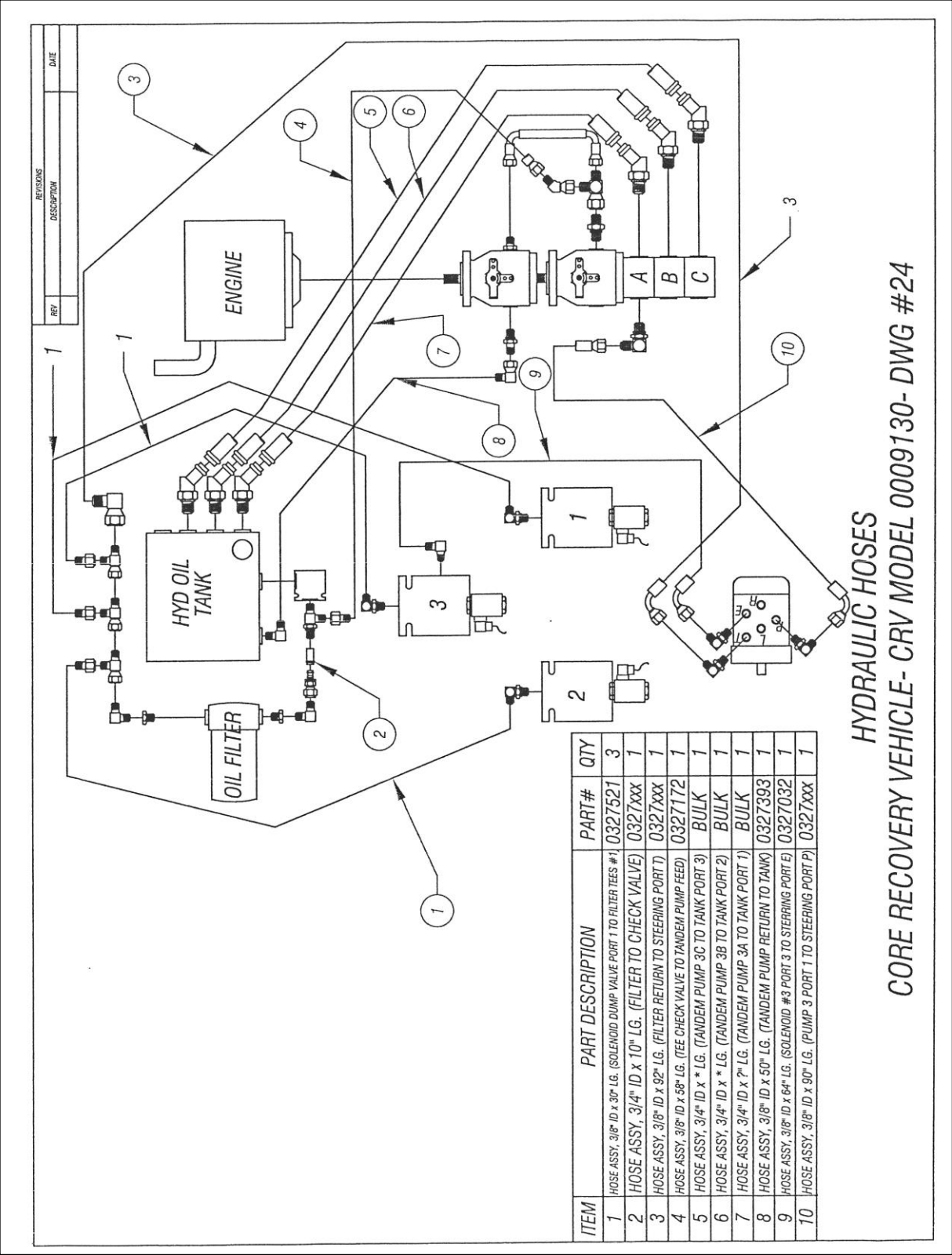

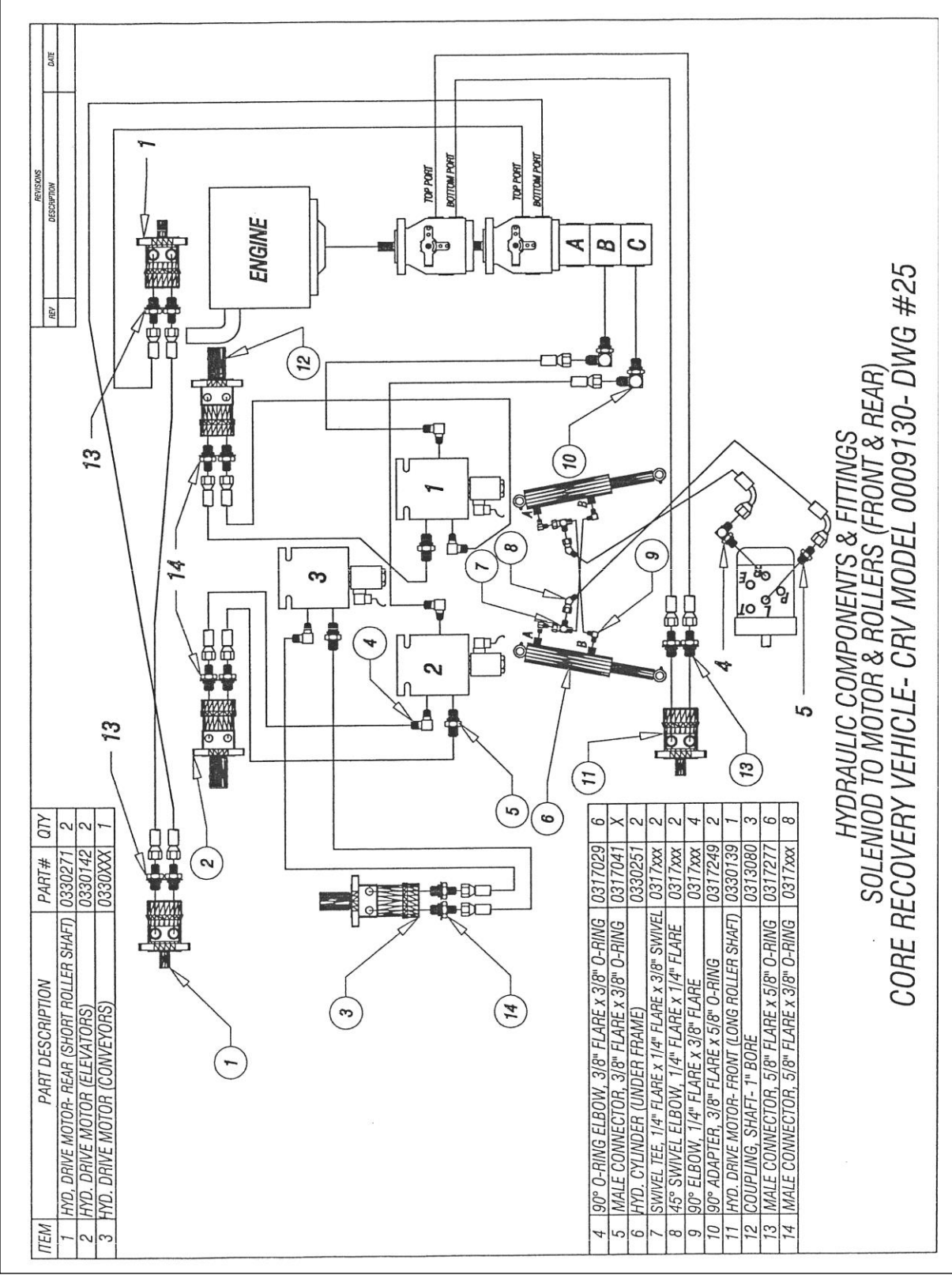

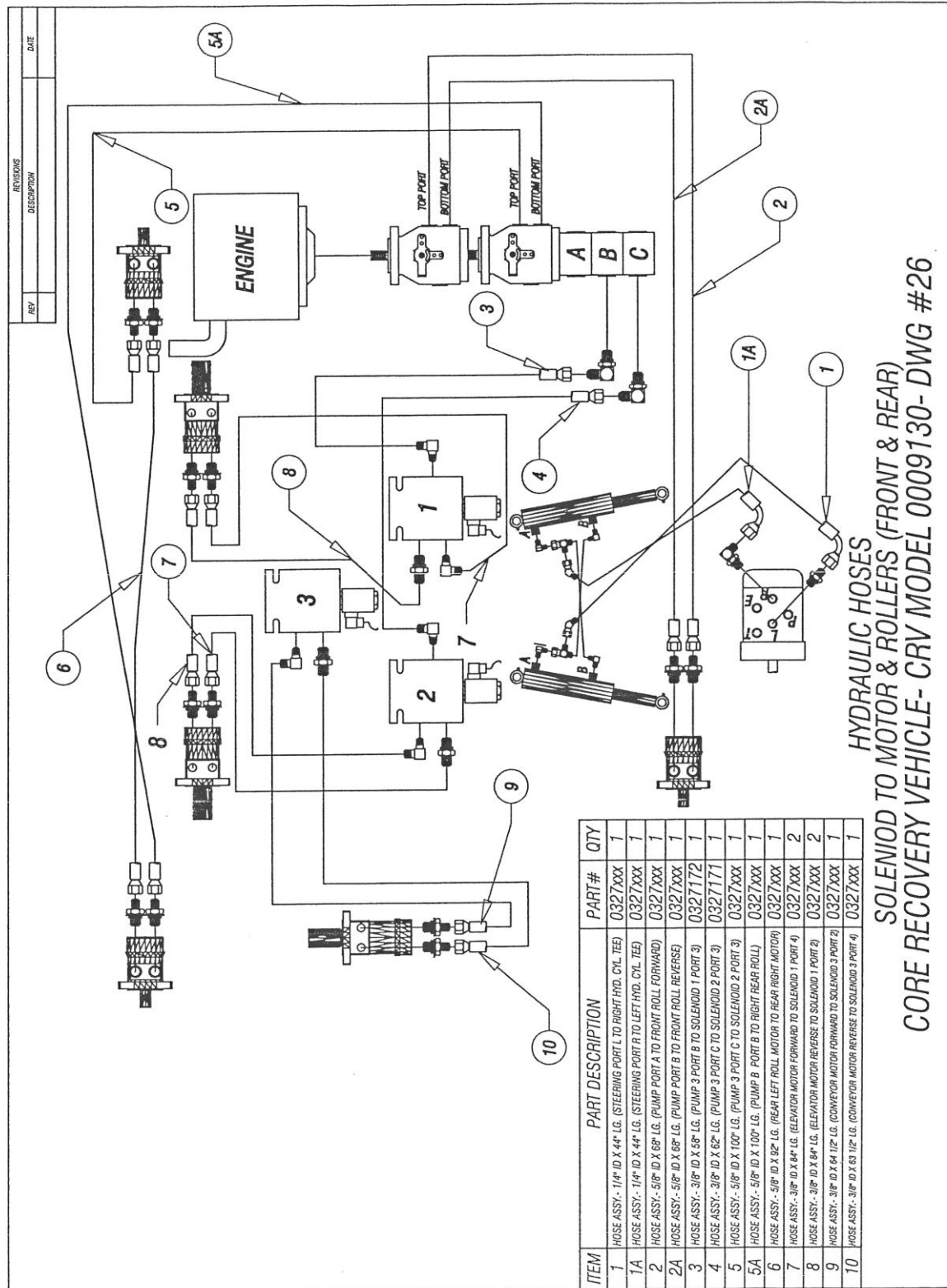

| REV | | REVISIONS | DATE |
|-----|-------------|-----------|------|
| REV | DESCRIPTION | | |
| | | | |

| ITEM | DESCRIPTION | PART No |
|------|-------------------------------|---------|
| 1 | CORE RECOVERY VEHICLE TRAILER | 0009133 |

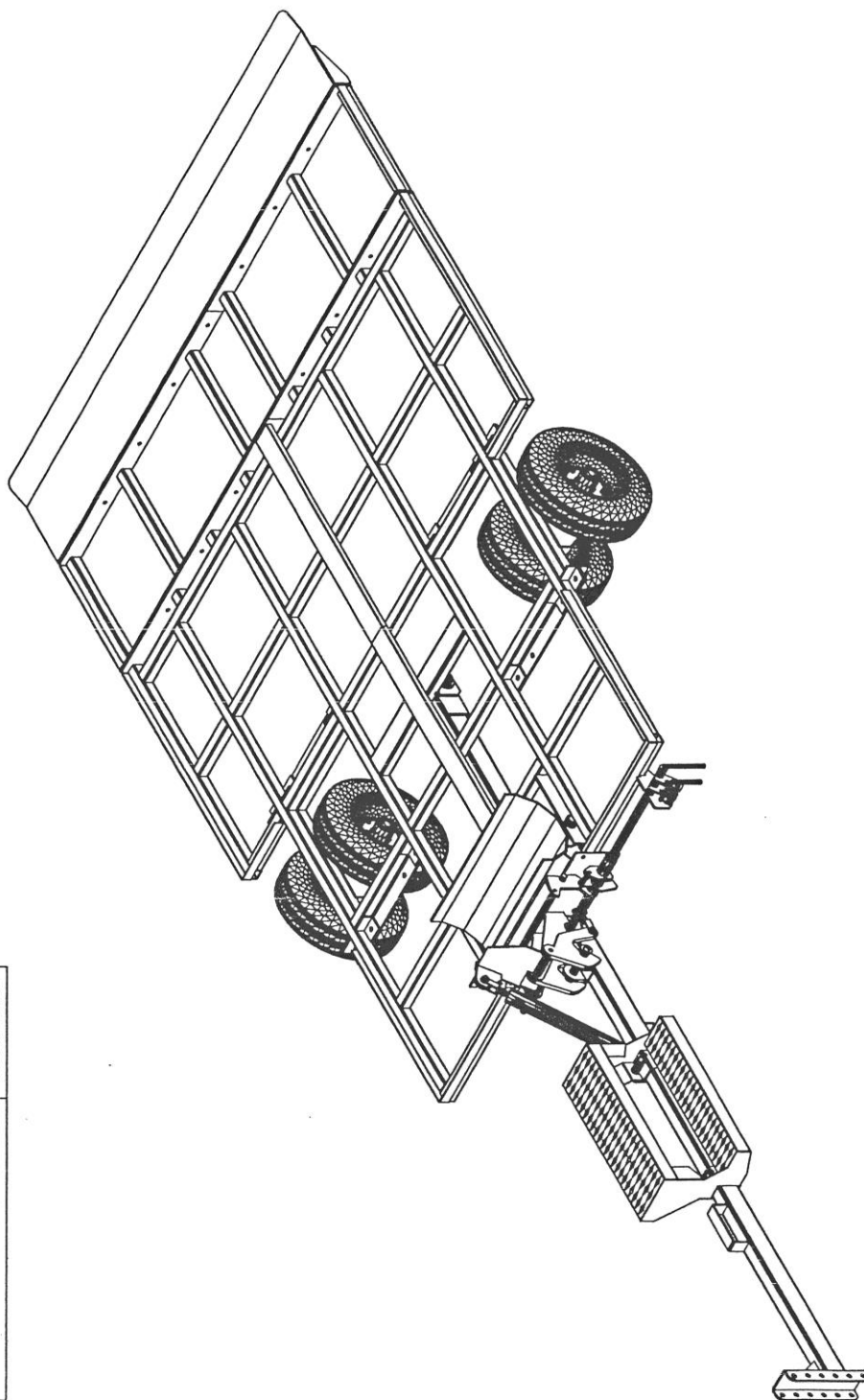

CORE RECOVERY VEHICLE- CRV TRAILER MODEL 0009133- DWG #27

| REV | | REVISIONS | |
|-----|------|-------------|--|
| REV | DATE | DESCRIPTION | |
| | | | |

| ITEM | DESCRIPTION | PART No | QTY |
|------|---------------------------|---------|-----|
| 1 | FRAME, TRAILER | 0219586 | 1 |
| 2 | ADAPTER, FRAME EXTENSION | 0275112 | 1 |
| 3 | ADAPTER, FRAME | 0275111 | 1 |
| 4 | MOUNT, SPINDLE | 0291117 | 2 |
| 5 | TIRE & WHEEL ASSY | 0354016 | 4 |
| 6 | BRACKET, PIVOT LOCKING | 0288279 | 2 |
| 7 | HOLDER, WHEEL ROLL- FRONT | 0281058 | 1 |
| 8 | TONGUE, CRV TOWFRAME | 0225095 | 1 |
| 9 | STEP, TONGUE | 0273051 | 1 |
| 10 | PLATE, TONGUE STEP | 0490725 | 2 |
| 11 | HEX, BOLT- 1/2-13 | 0346411 | 4 |

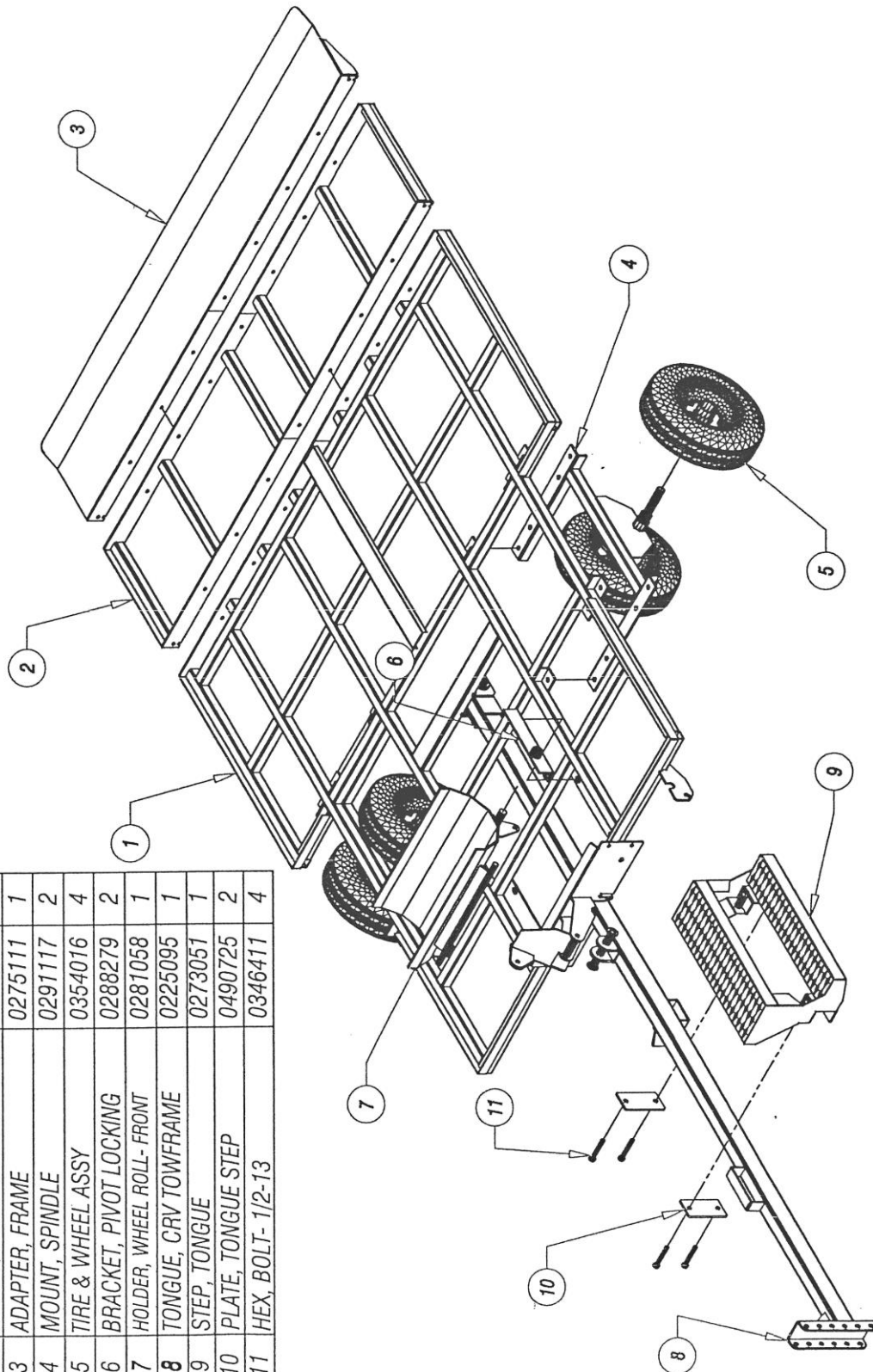

CORE RECOVERY VEHICLE- CRV TRAILER MODEL 0009133- DWG #28

| REV | DESCRIPTION | DATE |
|-----|-------------|------|
| | | |
| | | |

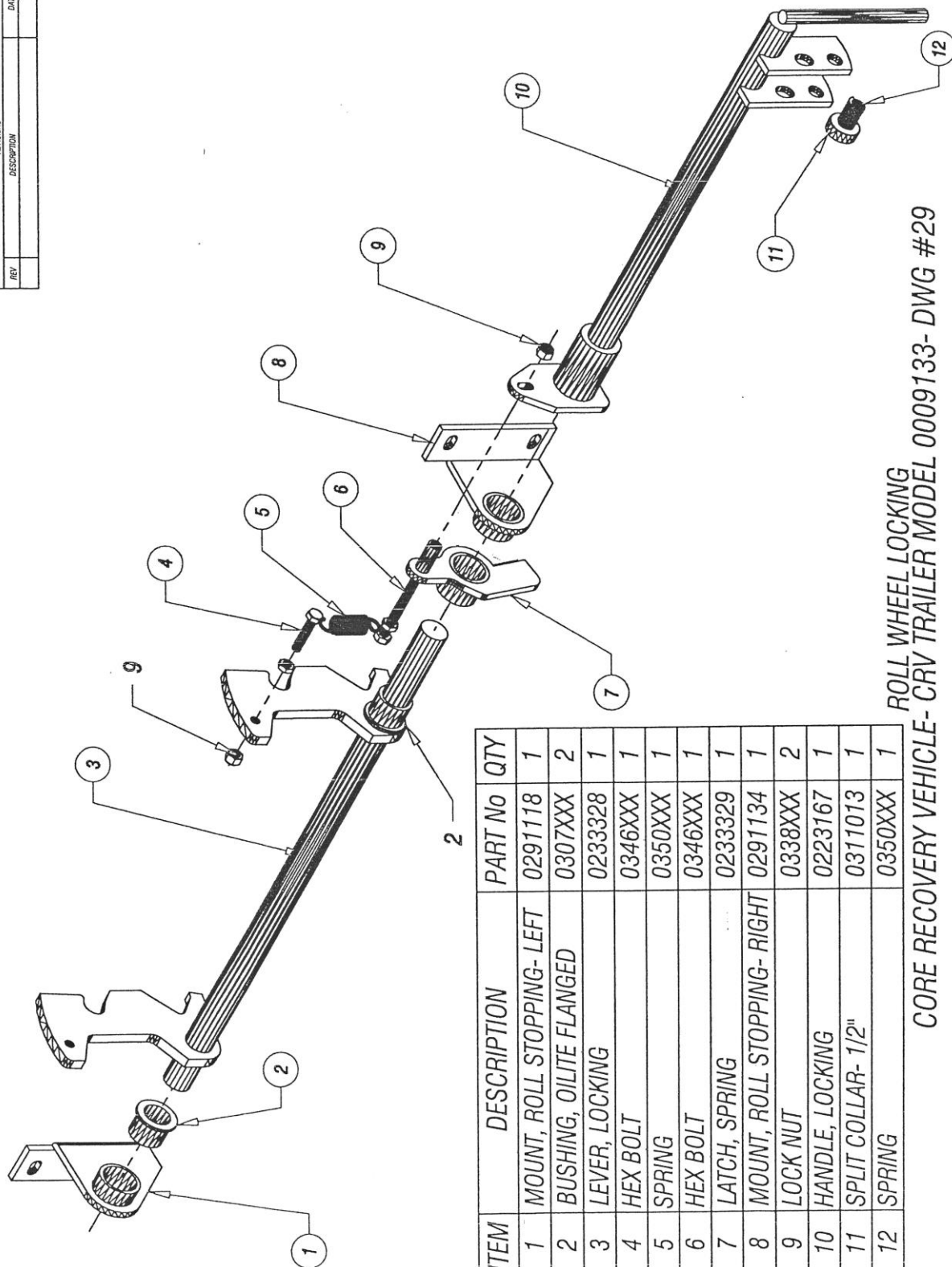

| ITEM | DESCRIPTION | PART No | QTY |
|------|-----------------------------|---------|-----|
| 1 | MOUNT, ROLL STOPPING- LEFT | 0291118 | 1 |
| 2 | BUSHING, OILITE FLANGED | 0307XXX | 2 |
| 3 | LEVER, LOCKING | 0233328 | 1 |
| 4 | HEX BOLT | 0346XXX | 1 |
| 5 | SPRING | 0350XXX | 1 |
| 6 | HEX BOLT | 0346XXX | 1 |
| 7 | LATCH, SPRING | 0233329 | 1 |
| 8 | MOUNT, ROLL STOPPING- RIGHT | 0291134 | 1 |
| 9 | LOCK NUT | 0338XXX | 2 |
| 10 | HANDLE, LOCKING | 0223167 | 1 |
| 11 | SPLIT COLLAR- 1/2" | 0311013 | 1 |
| 12 | SPRING | 0350XXX | 1 |

ROLL WHEEL LOCKING
CORE RECOVERY VEHICLE- CRV TRAILER MODEL 0009133- DWG #29

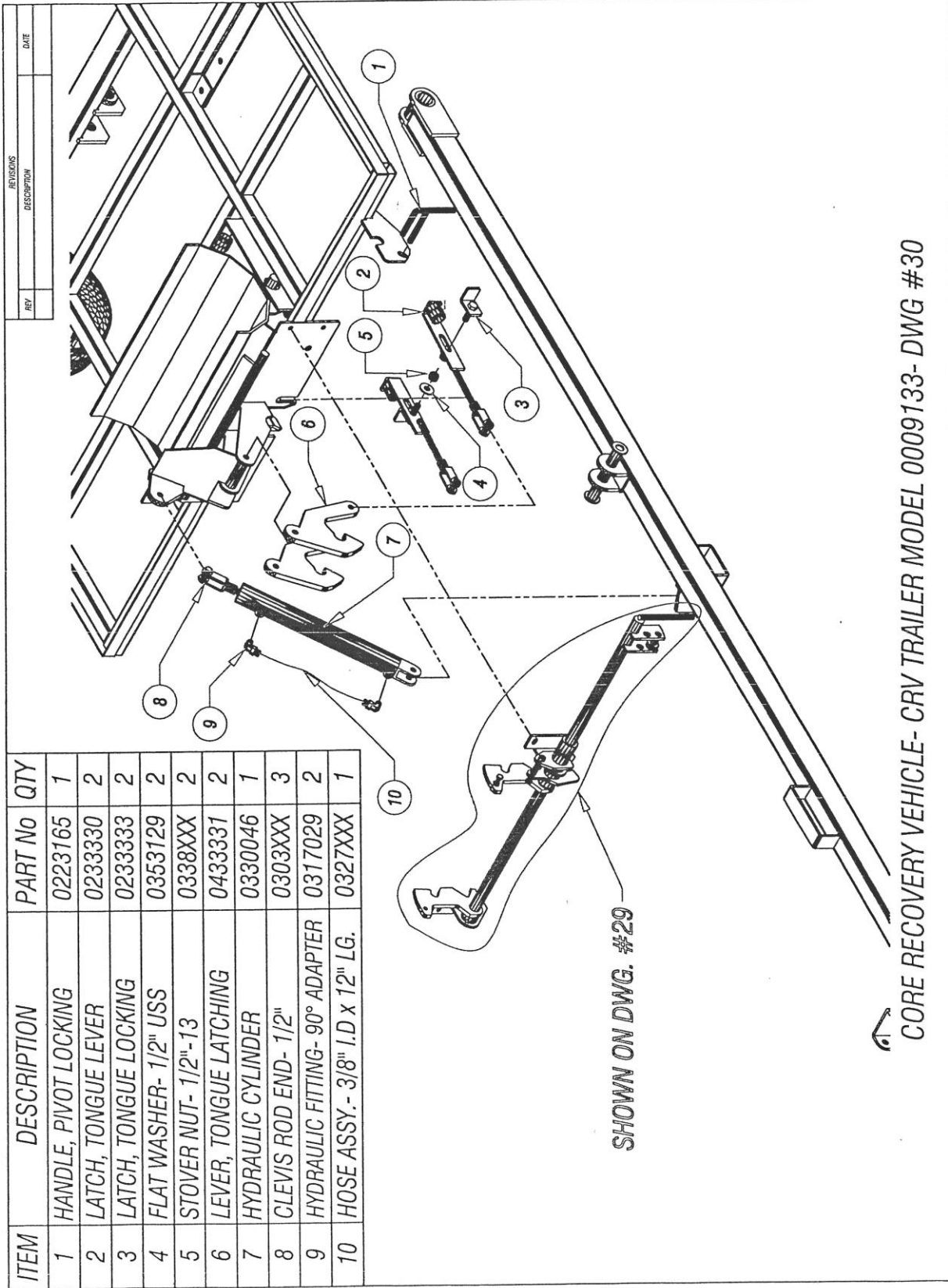

TORQUE CHART

Below is a quick reference chart for various "Flat Head Cap Screws"
and the torque recommendations.

VALUES ARE STATED IN FOOT POUNDS

| BOLT SIZE | Thds Per Inch | SAE Grade 5 | SAE Grade 8 |
|-----------|---------------|-------------|-------------|
| 1/4 | 20 | 10 | 14 |
| | 28 | --- | --- |
| 5/16 | 18 | 19 | 29 |
| | 24 | --- | --- |
| 3/8 | 16 | 33 | 47 |
| | 24 | --- | --- |
| 7/16 | 14 | 54 | 78 |
| | 20 | --- | --- |
| 1/2 | 13 | 78 | 119 |
| | 20 | --- | --- |
| 9/16 | 12 | 114 | 169 |
| | 18 | --- | --- |
| 5/8 | 11 | 154 | 230 |
| | 11 | --- | --- |
| 3/4 | 10 | 257 | 380 |
| | 10 | --- | --- |
| 7/8 | 9 | 382 | 600 |
| | 9 | --- | --- |
| 1 | 8 | 587 | 700 |
| | 8 | --- | --- |

Drive Belt Tension Measurement by Deflection

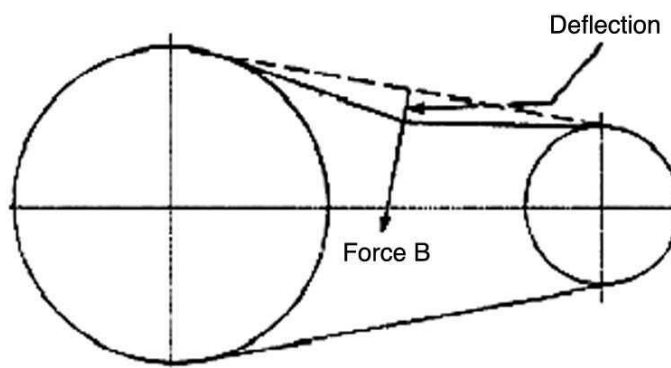

Deflection should be 3/8" when
8-12 lbs. push is applied at "B"

WARRANTY POLICY-CORE RECOVERY VEHICLE

Please complete and return your Warranty Card and Dealer Delivery Report. Warranty claims will not be considered if your Warranty Card and Dealer Delivery Report have not been returned to Salsco.

Your Salsco Commercial or Turf Equipment product is a commercial type product and is normally manufactured and sold for commercial or industrial use. **Salsco will, for the original purchaser, for (5) years from the date of purchase (90 days if used for rental purposes) repair or replace, free of charge, any SALSCO part or parts manufactured by Salsco found to be defective in material, workmanship or both.** Any transportation or shipping charges will be borne by the purchaser. If, during the warranty period stated above, the product does not function properly due to defect, simply contact Salsco and follow the Warranty Procedures included in this manual.

This warranty **does not** include:

- Incidental or consequential damages and is exclusive of any implied warranties.
- Normal maintenance parts, including, but not limited to hoses, chains, belts, filters, lubricants, etc.
- Parts or components, which are covered under the original manufacturer warranty, including, but not limited to engines, pumps, and motors.

WARRANTY PROCEDURE

In order for Salsco to consider your warranty claims, you must follow the procedure listed below:

MACHINE OR PART FAILURE

- a) Call our Service Department for helpful instruction on how to correct or repair the problem. Preventive maintenance will also be suggested.
- b) When ordering parts for warranty issues, you **MUST** retain possession of the old parts in question until notified with respect to returning the parts to Salsco or other disposition.
- c) Warranty claims **MUST** be filed within 30-days from completion of the work performed. Contact our office for an electronic Warranty Claim Form.
- d) Fill in all information requested on Warranty Claim Form, a copy of which is included in this manual, (date of purchase, company name, address, etc.). List all parts used. Make sure part numbers are correct. You can obtain these from your manual. Include a precise description of the problem (i.e., “leaking from spool,” rather than “leaking”).
- e) It is our goal to consider and reach a disposition on each warranty claim **within 30 days** from the date that it is received. Therefore, it is important that you respond promptly to any request for further information. Claims with no response to inquiries will be closed as **“denied for lack of response”** 90 days from the date of request.
- f) Email, fax or mail Warranty Claim Form to our Warranty Department. **Warranty on parts most often requires return of the parts that were replaced. DO NOT DISCARD OLD PARTS UNTIL YOU HAVE RECEIVED A DETERMINATION AS TO WHETHER THESE PARTS MUST BE RETURNED.**
- g) Our Warranty Department will contact and instruct you on how to return the parts to Salsco on an RA #. Returns **MUST** be made **within 30 days** from issuance of an RA #. **FREIGHT CHARGES ON THE RETURN OF PARTS IS THE RESPONSIBILITY OF THE CUSTOMER.** Normal pre-delivery adjustments are not covered under warranty. Labor warranties are based on reasonable time allowances as determined by Salsco, Inc. **TRAVEL TIME IS NOT REIMBURSED UNDER THE WARRANTY POLICY.**
- h) Be sure to put the RA form inside the box that you are shipping back; also be sure to put on the outside of the box “Return of Goods” and the RA #.
- i) Ship returns via a traceable method such as UPS Ground Service. Be sure that the shipment is insured for the appropriate value. If uninsured parts are lost, we cannot issue a credit.

PLEASE NOTE: ***Warranty forms should be filled out completely.***

PREVENTIVE MAINTENANCE IS YOUR BEST INSURANCE AGAINST EQUIPMENT FAILURE. BE SURE TO READ THE MANUAL, ESPECIALLY THE MAINTENANCE, OPERATING, AND CAUTION SECTIONS.

SALSCO, INC.
105 Schoolhouse Road
Cheshire, CT 06410 USA
800-872-5726, 203-271-1682; 203-271-2596 (fax)
sales@salsco.com www.salsco.com

SALSCO WARRANTY CLAIM FORM

| | | | |
|--|--|---|--|
| SALSCO, INC. 105 SCHOOLHOUSE RD. CHESHIRE, CT 06 06410 | | PHONE: 203-271-1682 TOLL-FREE: 800-872-5726 FAX: 203-271-2596 EMAIL: a.krueger@salsco.com WEB: www.salsco.com | |
| END OWNER: | | PHONE: | |
| NAME: | | FAX: | |
| EMAIL: | | | |
| ADDRESS: | | | |
| | | | |
| | | | |
| PURCHASED FROM: | | PHONE: | |
| NAME: | | FAX: | |
| EMAIL: | | | |
| ADDRESS: | | | |
| | | | |
| | | | |
| EQUIP/WARRANTY INFO: (MUST BE COMPLETE) | | | |
| PURCHASE DATE: | | INV #: | |
| DATE FAILED: | | | |
| MODEL #: | | REPAIR DATE: | |
| SERIAL # | | | |
| HRS USED: | | | |
| WARRANTY CLAIM/WORK ORDER #: | | | |
| WAS A SALSCO RETURN AUTH. # ISSUED FOR REPAIRS OR RETURN OF PARTS: | | YES NO | |
| IF YES, RA #: | | | |
| PROBABLE CAUSE OF FAILURE: | | | |
| | | | |
| | | | |
| | | | |
| | | | |
| | | | |
| | | | |
| | | | |

| SALSCO WARRANTY CLAIM FORM - Continued | | | | | |
|--|-----|--------------------------|---------------|------------|----|
| WORK PERFORMED/COMMENTS ON REPAIR: | | | | | |
| | | | | | |
| | | | | | |
| | | | | | |
| | | | | | |
| | | | | | |
| | | | | | |
| | | | | | |
| SHOP LABOR RATE: | | | SUBMITTED BY: | | |
| TOTAL LABOR HRS TO REPAIR: | | | PRINTED NAME: | | |
| SALSCO PART #: DESCRIPTION: | QTY | PRICE EACH | TOTAL | INVOICE #: | |
| | | | | | |
| | | | | | |
| | | | | | |
| | | | | | |
| | | | | | |
| | | | | | |
| | | | | | |
| FILL IN ALL INFORMATION REQUESTED ON WARRANTY CLAIM FORM. INCOMPLETE FORMS CANNOT BE PROCESSED & WILL BE RETURNED. LIST ALL PARTS USED. MAKE SURE PART NUMBERS ARE CORRECT. ANY PARTS THAT YOU BELIEVE TO BE DEFECTIVE OR ANY PARTS THAT BREAK SHOULD BE RETAINED FOR POSSIBLE INSPECTION UNTIL AFTER THE WARRANTY HAS BEEN PAID OR PART HAS BEEN RETURNED. INV. # NEEDS TO BE INCLUDED ON WARRANTY CLAIM. | | | | | |
| OFFICE USE ONLY | | | | | |
| DATE REC'D: | | DLR. DEL REPORT ON FILE: | | YES | NO |
| CUST ID: | | WARRANTY CLAIM ON FILE: | | YES | NO |
| SALSCO WC: | | PARTS TOTAL: | | | |
| SALSCO RA: | | LABOR TOTAL: | | | |
| DATE APPROVED: | | TOTAL APPROVED: | | | |
| DATE REJECTED: | | REJECTED DATE: | | | |
| PROCESSED BY: | | REASON: | | | |

SALESMAN ID # _____

SALES MANAGER'S NAME _____

800-872-5726, 203-271-1682
203-271-2596 (Fax)**SALSCO, INC.**
105 School House Road
Cheshire, CT 06410**www.salsco.com**
sales@salsco.com**DEALER DELIVERY REPORT**

| | | | |
|---|----------------|---|----------------------|
| MODEL: _____ | | SERIAL NO: _____ | |
| DEALER: _____ | CITY: _____ | STATE: _____ | ZIP: _____ |
| PURCHASER: _____ | ADDRESS: _____ | CITY: _____ | ST: _____ ZIP: _____ |
| <p>The undersigned dealer warrants that the above-described machine was carefully inspected, adjusted and prepared for delivery before delivery to the purchaser; that both the operation and maintenance of the machine were explained to the purchaser; and that a copy of the Owner's Instruction Manual were given to the purchaser and his attention called to Our Warranty and any operating instructions included in the manual and caution notes.</p> | | <p>The undersigned purchaser certifies that the operation and maintenance of the above-described machine have been explained to him; acknowledges receipt of a copy of the Owner's Instruction Manual and Our Warranty Policy printed in said Instruction Manual and Caution Notes. I also understand that it is my responsibility to explain and make Salsco manuals available to new operators.</p> | |
| DATE: _____ | | DATE: _____ PURCHASER: _____ | |
| SIGN BY: _____ | | SIGN BY: _____ | |
| PHONE: _____ FAX: _____ | | PHONE: _____ | |
| E-Mail: _____ | | EMAIL: _____ | |

| | | | |
|---|----------------|------------------------------|-----------------------------|
| MODEL: _____ | | SERIAL NO: _____ | |
| <u>SALSCO LIMITED WARRANTY CARD</u> | | | |
| DATE PURCHASED: _____ | | | |
| PURCHASER: _____ | ADDRESS: _____ | CITY: _____ | ST: _____ ZIP: _____ |
| EMAIL: _____ | | PHONE: _____ | |
| DEALER: _____ | | STATE: CT | |
| Will this equipment be used commercially? | | Yes <input type="checkbox"/> | No <input type="checkbox"/> |
| Did Dealer service this equipment and instruct you in its care and safe operation? | | Yes <input type="checkbox"/> | No <input type="checkbox"/> |
| Did you receive an "Operation & Service Manual" and safety pamphlet? | | Yes <input type="checkbox"/> | No <input type="checkbox"/> |
| Signed _____ | | Purchaser _____ | |
| <p><u>NOTICE:</u> IMPORTANT: THIS CARD MUST BE FILLED OUT COMPLETELY AND MAILED TO THE FACTORY WITHIN 10 DAYS OF PURCHASE DATE, OR YOUR LIMITED WARRANTY WILL BE VOIDED.</p> | | | |

SERVICE RECORD

If kept properly, this schedule will help track problems in the future.

[illegible]

MODEL # _____ S/N _____

DATE PURCHASED: _____