

Salsco, INC.

LEADER BY DESIGN

OPERATORS MANUAL - 720 & 725 TRUCKLOADER LEAF VACUUM

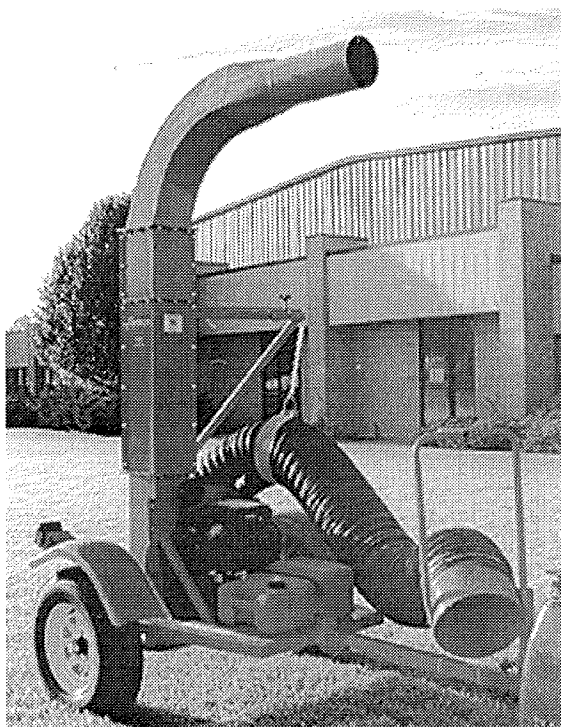

SALSCO, INC.

105 School House RoadCheshire, CT 06410, 203/271-1682, 203/271-2596 (Fax)1/800/872-5726

STATEMENT OF FACT

YOU HAVE JUST PURCHASED THE HIGHEST QUALITY, MOST EFFICIENT TRUCKLOADER VACUUM ON THE MARKET TODAY. THIS UNIT HAS THE ABILITY TO MEET EXACT STANDARDS AND PERFORM FOR YEARS WITH MINIMUM DOWN TIME. HOWEVER, IT CANNOT READ NOR WILL IT UNDERSTAND THIS MANUAL NO MATTER HOW LONG YOU LEAVE IT ON TOP OF THE MACHINE. IT IS YOUR RESPONSIBILITY TO READ AND UNDERSTAND IT. IT IS ALSO YOUR RESPONSIBILITY TO BE CERTAIN THIS INFORMATION IS PASSED ALONG TO ANYONE WHO IS EXPECTED TO OPERATE THIS EQUIPMENT. SHOULD YOU CHOOSE NOT TO READ, UNDERSTAND AND PASS ALONG THE INFORMATION PROVIDED YOU, PLEASE EXPECT EQUIPMENT FAILURE AND POSSIBLE INJURIES TO PERSONS AROUND THIS EQUIPMENT.

FOR THE SAFETY OF THE OPERATOR, IT IS IMPERATIVE THAT THIS MANUAL IS CAREFULLY READ AND UNDERSTOOD.

HAVING READ THIS MANUAL, IT IS YOUR RESPONSIBILITY TO BE SURE THAT ALL NEW OPERATORS READ AND UNDERSTAND THIS MANUAL ESPECIALLY THE CAUTIONS ON PAGE FIVE.

AS A MANUFACTURER OF EQUIPMENT WE HAVE A RESPONSIBILITY TO DESIGN A SAFE PIECE OF EQUIPMENT. HOWEVER, ONLY YOU CAN PREVENT ACCIDENTS!!

DO NOT RUN MACHINE WITHOUT GUARDS IN PLACE

DESCRIPTION

716 AND 720 TRUCKLOADER VACUUMS

Our larger vacs, 16 H.P. and up are considered the work horses of the line and are a must for anyone who has large clean up jobs in their future. As with the smaller vacs, these units also come standard with a wrapped spring steel wire hose, and the impellers are welded on a robotic welding system to insure a smooth balanced operation. No matter which model you choose, we're sure you'll agree, that not only have you purchased a unit that will increase profits; but also one that will give you years of service with minimal care. There are three great options to make the 716 and 720 independent trailer units: the LOADERVAC TRAILER 750 which makes highway trailing a cinch; the WHEEL KIT 751 which allows you to convert either truck loader to trailer units; and the 752 LOADERVAC TRAILER our deluxe model which comes standard with leaf springs, screwjack, and a place to carry two walk behind leaf blowers.

THINK

SAFETY

MANUFACTURED BY: SALSCO, INC.
TURF EQUIPMENT DIVISION
105 SCHOOL HOUSE ROAD
CHESHIRE, CONNECTICUT 06410
203/271-1682
FAX (203) 271-2596

TRUCKLOADER VACUUM MANUAL

THIS MANUAL COVERS MODELS: 716 & 720 TAILGATE LOADERS
751 & 752 TRAILERS

This company reserves the right to discontinue, add improvements to, or change the design of any model or product at any time without obligation to improve existing machines, either by changing the design or adding new parts.

It has been and will continue to be the policy of SALSCO to update existing machines at its own discretion. Whenever possible, new designs will be made in such a way, that they can be "Retro Fit" if so desired.

Record in space provided below the model and serial numbers of this unit. Please retain these numbers for future reference.

No parts orders will be accepted without Model numbers or parts numbers.

<u>Model Number</u>		<u>Serial Number</u>
<u>Model No.</u>	<u>Prefix</u>	<u>Part Number Code:</u>
		<u>Model</u> <u>Part Number*</u>
716	= 716	000 A 000

* PART NUMBER PREFIX MUST BE USED WHEN ORDERING PARTS (___A000).
PREFIX NUMBER IS LISTED ABOVE.

**** CAUTION ****

READ AND UNDERSTAND THIS MANUAL BEFORE STARTING MACHINE!!

DO NOT RUN MACHINE WITHOUT GUARDS IN PLACE

SERVICE SCHEDULE

- | | | |
|----|--|--------|
| 1. | CHECK ENGINE OIL (SEE ENGINE MANUAL) | DAILY |
| 2. | CHECK VIBRATIONS | DAILY |
| 3. | CHECK FOR TORN OR DAMAGED HOSE | DAILY |
| 4. | VISUALLY CHECK FOR LOOSE BOLTS OR DAMAGE | DAILY |
| 5. | CLEAN MACHINE | DAILY |
| 6. | CHECK TIRES (TRAILER UNITS) | DAILY |
| 7. | CHECK BATTERY FOR WATER AND ELECTRICAL CONNECTIONS | WEEKLY |

THINK

SAFETY

071389

CAUTION

BEFORE YOU START THIS MACHINE:

1. READ AND UNDERSTAND OWNER'S MANUAL.
2. DO NOT RUN WITHOUT GUARDS AND OTHER SAFETY COVERS ON MACHINE.
3. NEVER LEAVE MACHINE RUNNING WHILE UNATTENDED.
4. NEVER REACH UNDER OR INTO MACHINE FOR ANY REASON WHILE MACHINE IS RUNNING AS IT CAN CAUSE SERIOUS INJURY.
5. ALWAYS REMOVE SPARK PLUG WIRE, MAKE SURE ENGINE SWITCH IS OFF, THROTTLE IS IN STOP POSITION, AND SHUT GAS OFF WHEN WORKING ON OR CHECKING INSIDE OF MACHINE.
6. NEVER CLEAN INLET TUBE OR OUTLET TUBE WHILE ENGINE IS RUNNING.
7. EYE PROTECTION SHOULD ALWAYS BE WORN WHEN RUNNING MACHINE.
8. BE SURE AIR INTAKE ON ENGINE IS CLEAR OF LEAVES AND DEBRIS.
9. WHEN UNHITCHING FROM TOW VEHICLE BE SURE REAR JACK STANDS ARE 2" FROM GROUND AND PINNED.
10. DO NOT REMOVE CAUTION DECALS.
11. SAFETY DECALS SHOULD BE REPLACED IMMEDIATELY AFTER REPAINTING OR WHEN THEY BECOME ILLEGIBLE. ** SEE NOTE BELOW **

**** NOTE ****

SAFETY IS A PRIME CONCERN AT SALS CO AND THE SAFETY DECALS ON YOUR MACHINE ARE A HIGHLY VISIBLE AND CONSTANT REMINDER TO ALL OPERATORS. REPLACEMENT SAFETY DECALS MAY BE OBTAINED FROM YOUR LOCAL DEALER OR BY CALLING TOLL FREE 1-800-8SALSCO.

DO NOT RUN MACHINE WITHOUT GUARDS IN PLACE

(082288)

OPERATING INSTRUCTIONS

- 1) READ MANUAL THOROUGHLY.
- 2) ON TRAILER UNITS, LOWER TRAILER LEG STANDS.
- 3) BE SURE INTAKE HOSE IS CONNECTED TO BLOWER HOUSING.
- 4) PLACE INLET HOSE ON GROUND NEAR PILE OF DEBRIS.
- 5) START MOTOR AND LET IDLE TILL IT WARMS UP (SEE ENGINE MANUAL).
- 6) BRING UP TO FULL R.P.M. SLOWLY, CHECKING FOR VIBRATIONS.
- 7) YOU SHOULD BE ABLE TO DO 90% OF YOUR WORK WITH THE ENGINE AT 3/4 THROTTLE. THIS WILL LESSEN FUEL CONSUMPTION AND ADD TO ENGINE LIFE.
- 8) YOU CAN EITHER MOVE INLET BY HAND OR BLOW LEAVES TO INLET TUBE. IT WILL PICK UP MOST OF THE PILE BY ITSELF.

**** NOTE ****

BE CAREFUL NOT TO PICK UP ROCKS, BOTTLES ETC. AS THIS COULD RESULT IN DAMAGE TO THE UNIT AND POSSIBLY INJURE THE OPERATOR.

DO NOT RUN MACHINE WITHOUT GUARDS IN PLACE

(082288)

ITEM	QTY	NAME
1	1	FRAME
2	1	HOUSING
3	1	WHEEL
4	1	HANGER ASSY
5	1	HOSE HANDLE
6	1	OUTLET TUBE 80"
7	2	SHORT TUBE
8	2	HOSE HANGER
9	2	LONG TUBE
10	2	20 H.P. MOTOR
11	2	BATTERY
12	2	HANGER PLATE 12"
13	2	S HOOK
14	2	BATTERY CLAMP
15	2	HEX SCREW
16	20	LOCK NUT
17	16	HEX SCREW
18	2	LOCK WASHER
19	2	HOSE CLAMP
20	2	12" FLEX HOSE
21	2	RETG PLATE
22	3	CARRIAGE BOLT
23	3	FLAT WASHER 5/8
24	1	FUEL TANK 5/8
25	1	LOCK WASHER 5/8
26	1	HEX SCREW 5/8 X 2
27	1	LOCK NUT
28	1	HEX SCREW
29	1	FLAT WASHER
30	1	LOCK NUT
31	1	HEX SCREW
32	1	FLAT WASHER
33	1	LOCK NUT
34	1	SO KEY
35	1	KNOB
36	1	THT ROD
37	1	HEX SCREW
38	1	LOCK NUT
39	1	LOCK WASHER
40	1	BATTERY CABLE 6"
41	1	LOCK NUT
42	1	CARRIAGE BOLT
43	1	SPACER
44	1	CAUTION DECAL
45	1	CAUTION DECAL
46	1	DECAL ID TAG
47	1	FILLER CAP
48	1	DECAL SALSOCO
49	1	DECAL PEDAL SCREEN
50	1	DECAL SAFETY
51	1	DECAL OIL
52	1	DECAL MODEL
53	1	LOCK WASHER
54	1	ELBOW
55	1	RUBBER FUEL LINE
56	1	5/16 CRAMP CONN.
57	1	3/8 CRAMP CONN.
58	1	HOSE CLAMP

MODEL 720 LOADERVAC
20 H.P. MOTOR
12" INLET HOSE

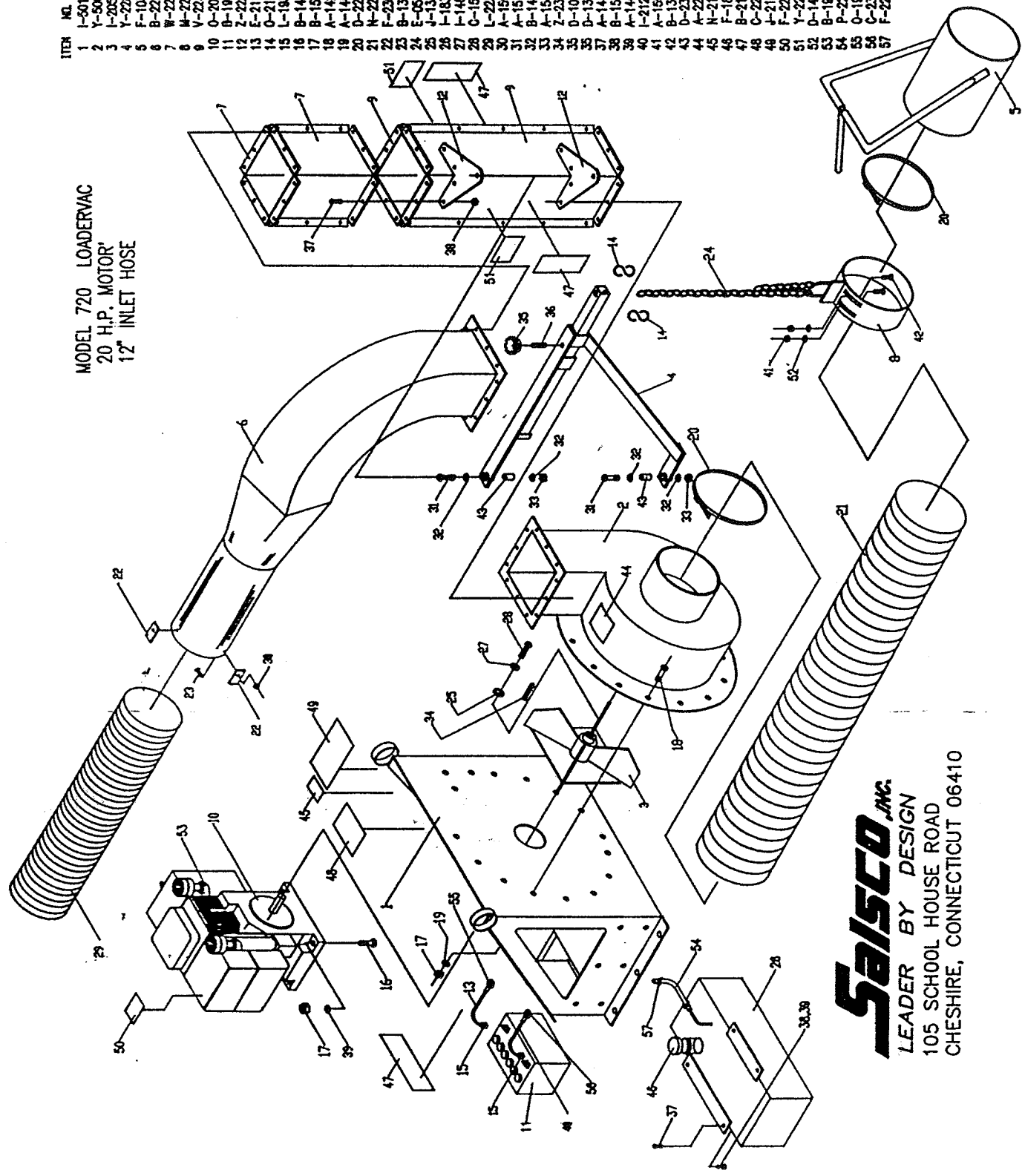

SALSOCO INC.
LEADER BY DESIGN
105 SCHOOL HOUSE ROAD
CHESHIRE, CONNECTICUT 06410

MODEL 752 TRAILER FOR 716 & 720 VAC

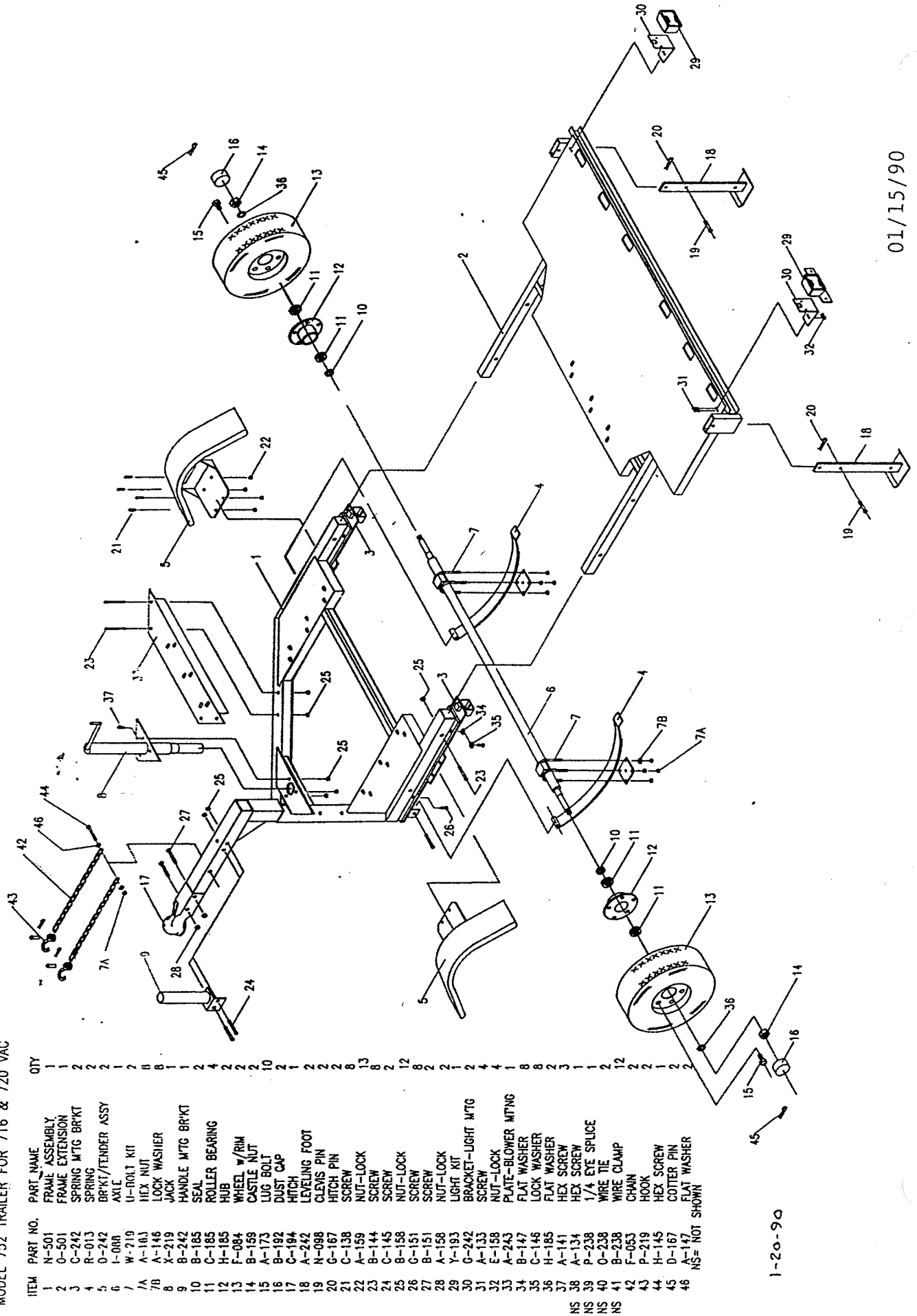

ITEM	PART NO.	PART NAME	QTY
1	N-501	FRAME ASSEMBLY	1
2	O-501	FRAME EXTENSION	1
3	C-242	SPRING M/TG BRKT	2
4	R-013	SPRING	2
5	O-242	DRKTY/TENDER ASSY	2
6	I-088	AXLE	1
7	W-210	U-BOLT KIT	2
7A	A-101	HEX NUT	8
7B	A-146	LOCK WASHER	8
8	X-219	JACK	1
9	B-242	HANDLE M/TG BRKT	1
10	B-185	SEAL	2
11	C-185	ROLLER BEARING	4
12	H-185	HUB	2
13	F-084	WHEEL & RIM	2
14	B-158	CASTLE NUT	2
15	A-173	LUG BOLT	10
16	B-192	DUST CAP	2
17	C-194	HITCH	1
18	A-242	LEVELING FOOT	2
19	N-098	CLEVIS PIN	2
20	G-167	HITCH PIN	2
21	C-138	SCREW	8
22	A-159	NUT-LOCK	8
23	B-144	SCREW	13
24	C-145	SCREW	8
25	B-158	NUT-LOCK	2
26	G-151	SCREW	12
27	B-151	SCREW	8
28	A-158	NUT-LOCK	2
29	Y-193	LIGHT KIT	2
30	G-242	BRACKET-LIGHT M/TG	1
31	A-133	SCREW	2
32	E-158	NUT-LOCK	4
33	A-243	PLATE-BLOWER M/TG	1
34	B-147	FLAT WASHER	8
35	C-146	LOCK WASHER	8
36	H-185	FLAT WASHER	2
37	A-141	HEX SCREW	3
38	A-134	HEX SCREW	1
39	P-238	1/4 EYE SPLICE	1
40	O-238	WIRE TIE	1
41	B-238	WIRE CLAMP	2
42	F-053	CHAIN	12
43	P-219	HOOK	2
44	H-145	HEX SCREW	2
45	D-167	COTTER PIN	1
46	A-147	FLAT WASHER	2
NS= NOT SHOWN			

1-20-90

01/15/90

Salsco, INC.
LEADER BY DESIGN