

SALSCO, INC.

LEADER BY DESIGN

Operators and parts manual - Models 708 & 713 Tailgate Vacuums

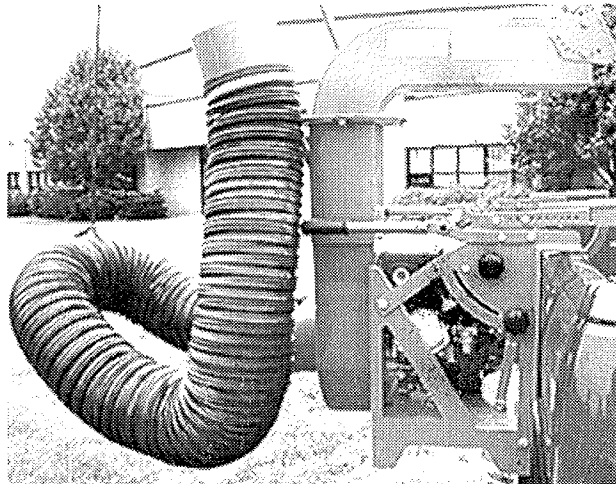

SALSCO, INC.

105 School House Road, Cheshire, CT 06410.

203/271-1682, 800/872-5726, 203/271-2596 (fax)

STATEMENT OF FACT

You have just purchased the highest quality, most efficient Tailgate Vacuum on the market today. This unit has the ability to meet exact standards and perform for years with minimum down time. HOWEVER, it cannot read nor will it understand this manual, no matter how long you leave it on top of the machine. It is your responsibility to read and understand it. It is also your responsibility to be certain this information is passed along to anyone who is expected to operate this equipment. Should you choose not to read, understand and pass along the information provided you, please expect equipment failure and possible injuries to persons around this equipment.

For the safety of the operator, it is imperative that this manual is carefully read and understood.

Having read this manual, it is your responsibility to be sure that all new operators read and understand this manual, especially all the cautions stated.

As a manufacturer of equipment we have a responsibility to design a safe piece of equipment. NOTE: The important safeguards and instructions in this manual are not meant to cover all possible conditions and situations that may occur. It must be understood that common sense, caution, and care are factors which cannot be built into any product. These factors must be supplied by the person(s) caring for and operating this equipment

DO NOT RUN MACHINE WITHOUT GUARDS IN PLACE

DESCRIPTION

700 SERIES TAILGATE AND TRUCK LOADERS

Within the family of loadervacs, we have several horse powers and models to choose from. The last two digits of this series indicate the horse power of the unit. The 14 H.P. and lower are designed for easy use in a tailgate application. These units are light and have an external clamping mechanism. There are many improvements this year to the loadervac line. All tailgate models, 14 H.P. and down, are designed in such a way that owners can change horse power of these vacs at will from 7 1/2 to 14 H.P. We've upgraded the hoses on all vacs to a 2 ply neoprene impregnated nylon material hose, with a yellow scuff strip for severe abrasion resistance. All our impellers are welded on a robotic welding system which insures proper balance and a smooth running unit. As with all Salsco quality products, these vacs have a baked enamel finish to insure excellent appearance for years to come.

THINK

SAFETY

MANUFACTURED BY: SALSCO, INC.
TURF EQUIPMENT DIVISION
105 SCHOOL HOUSE ROAD
CHESHIRE, CONNECTICUT 06410
203/271-1682
FAX (203) 271-2596

TAILGATE LOADER VACUUM MANUAL

THIS MANUAL COVERS MODELS: ~~707~~, 708, ~~710~~, ~~712~~ &
713 TAILGATE LOADERS

This company reserves the right to discontinue, add improvements to, or change the design of any model or product at any time without obligation to improve existing machines, either by changing the design or adding new parts.

It has been and will continue to be the policy of SALSCO to update existing machines at its own discretion. Whenever possible, new designs will be made in such a way, that they can be "Retro Fit" if so desired.

Record in space provided below the model and serial numbers of this unit. Please retain these numbers for future reference.

No parts orders will be accepted without Model numbers or parts numbers.

| <u>Model Number</u> | | <u>Serial Number</u> |
|---------------------|---------------|----------------------------------|
| <u>Model No.</u> | <u>Prefix</u> | <u>Part Number Code:</u> |
| 710 | = 710 | <u>Model</u> <u>Part Number*</u> |
| | | 000 A 000 |

* PART NUMBER PREFIX MUST BE USED WHEN ORDERING PARTS (___A000).
PREFIX NUMBER IS LISTED ABOVE.

**** CAUTION ****

READ AND UNDERSTAND THIS MANUAL BEFORE STARTING MACHINE!!

DO NOT RUN MACHINE WITHOUT GUARDS IN PLACE

SERVICE SCHEDULE

- | | | |
|----|--|--------|
| 1. | CHECK ENGINE OIL (SEE ENGINE MANUAL) | DAILY |
| 2. | CHECK VIBRATIONS | DAILY |
| 3. | CHECK FOR TORN OR DAMAGED HOSE | DAILY |
| 4. | VISUALLY CHECK FOR LOOSE BOLTS OR DAMAGE | DAILY |
| 5 | CLEAN MACHINE | DAILY |
| 6. | CHECK BATTERY FOR WATER AND ELECTRICAL CONNECTIONS | WEEKLY |

THINK

SAFETY

CAUTION

BEFORE YOU START THIS MACHINE:

1. READ AND UNDERSTAND OWNER'S MANUAL.
2. DO NOT RUN WITHOUT GUARDS AND OTHER SAFETY COVERS ON MACHINE.
3. NEVER LEAVE MACHINE RUNNING WHILE UNATTENDED.
4. NEVER REACH UNDER OR INTO MACHINE FOR ANY REASON WHILE MACHINE IS RUNNING AS IT CAN CAUSE SERIOUS INJURY.
5. ALWAYS REMOVE SPARK PLUG WIRE, MAKE SURE ENGINE SWITCH IS OFF, THROTTLE IS IN STOP POSITION, AND SHUT GAS OFF WHEN WORKING ON OR CHECKING INSIDE OF MACHINE.
6. NEVER CLEAN INLET TUBE OR OUTLET TUBE WHILE ENGINE IS RUNNING.
7. EYE PROTECTION SHOULD ALWAYS BE WORN WHEN RUNNING MACHINE.
8. BE SURE AIR INTAKE ON ENGINE IS CLEAR OF LEAVES AND DEBRIS.
9. DO NOT REMOVE CAUTION DECALS.
10. SAFETY DECALS SHOULD BE REPLACED IMMEDIATELY AFTER REPAINTING OR WHEN THEY BECOME ILLEGIBLE. ** SEE NOTE BELOW **

**** NOTE ****

SAFETY IS A PRIME CONCERN AT SALSco AND THE SAFETY DECALS ON YOUR MACHINE ARE A HIGHLY VISIBLE AND CONSTANT REMINDER TO ALL OPERATORS. REPLACEMENT SAFETY DECALS MAY BE OBTAINED FROM YOUR LOCAL DEALER OR BY CALLING TOLL FREE 1-800-BSALSco.

DO NOT RUN MACHINE WITHOUT GUARDS IN PLACE

OPERATING INSTRUCTIONS

- 1) ADJUST CLAMPING MECHANISM TO FIT YOUR TAILGATE.
- 2) AFTER CHECKING ENGINE OIL, CLAMP UNIT TO TAILGATE.
- 3) CONNECT INPUT HOSE AND BE SURE EXHAUST ISN'T POINTED AT YOUR REAR WINDOW AS THE UNIT WILL BEGIN THROWING DEBRIS AS SOON AS IT IS STARTED.
- 4) START ENGINE AND PASS INLET TUBE OVER MATERIAL TO BE PICKED UP.

**** NOTE ****

BE CAREFUL NOT TO PICK UP ROCKS, BOTTLES ETC. AS THIS COULD RESULT IN DAMAGE TO THE UNIT AND POSSIBLY INJURE THE OPERATOR.

DO NOT RUN MACHINE WITHOUT GUARDS IN PLACE

WARRANTY

Your Salsco Commercial or Turf Equipment product is a commercial type product and is normally manufactured and sold for commercial or industrial use. Salsco will, for the original purchaser, for one (1) year from the date of purchase (90 days if used for rental purposes;) repair or replace, free of charge, any part or parts found to be defective in material or workmanship or both. Any transportation charges to be borne by the purchaser.

If, during the Warranty Period, the product does not function properly due to defect, simply contact your Salsco Dealer and provide the unit or part for inspection or contact directly:

SALSCO, INC.
Service Department
105 School House Road
Cheshire, CT 06410

203/271-1682
FAX: 203/271-2596

This warranty does not include incidental or consequential damages and is exclusive of any implied warranties.

This warranty does not include normal maintenance parts, including, but not limited to spark plugs, filters, lubricants, springs, tines, tine overlays, nylon bars, and blades.

This warranty does not include parts or components which are covered under the original manufacturers warranty, including, but not limited to engine and differential.

Salsco, Inc.
LEADER BY DESIGN
 105 SCHOOL HOUSE ROAD
 CHESHIRE, CONNECTICUT 06410

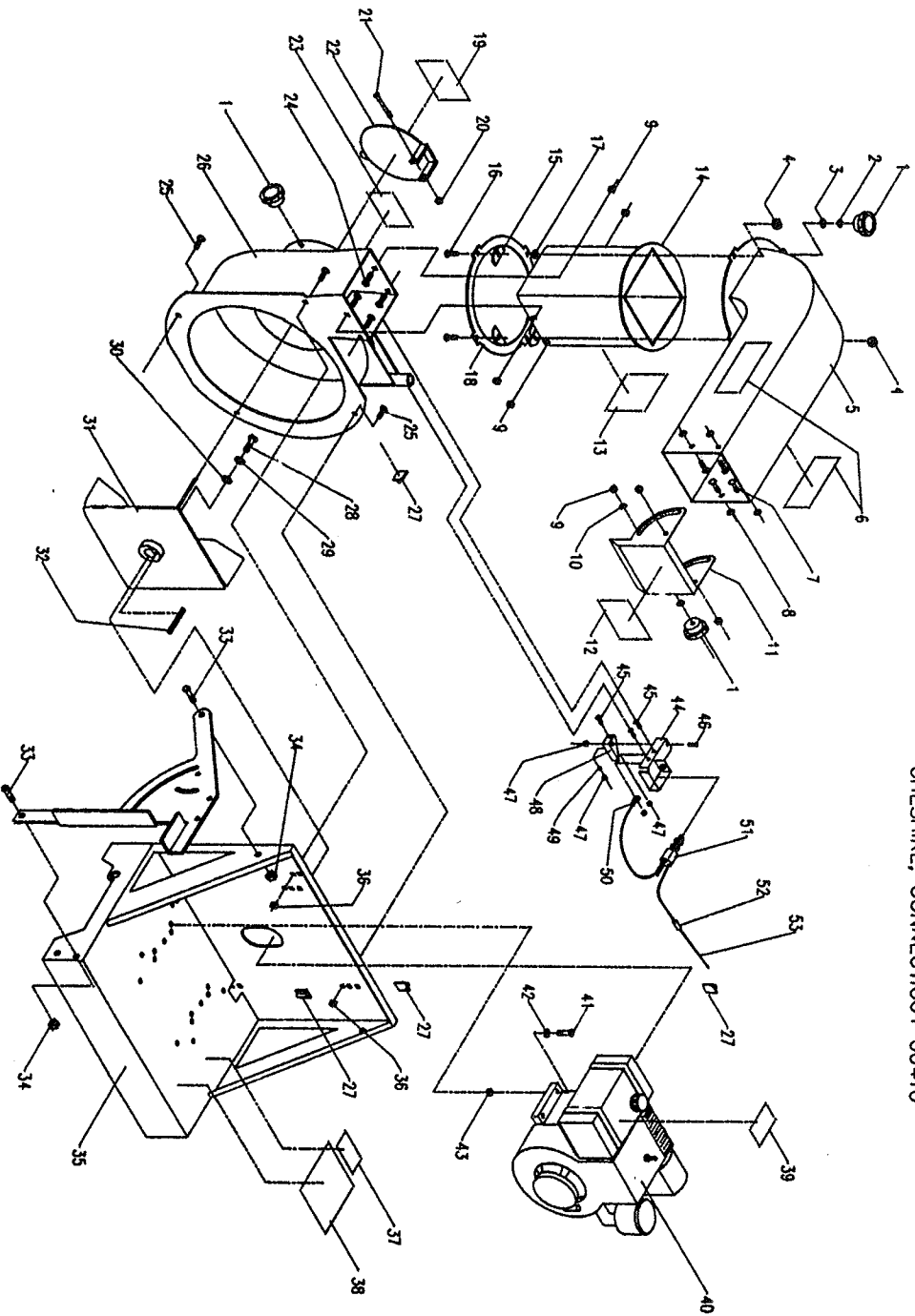

| ITEM NO. | NAME | QTY |
|----------|----------------------|-----|
| 1 | 1-104 KNOB | 3 |
| 2 | D-146 LOCK WASHER | 1 |
| 3 | A-139 FLAT WASHER | 1 |
| 4 | A-159 LOCK NUT | 1 |
| 5 | S-223 EXHAUST ELBOW | 3 |
| 6 | B-210 DECAL | 1 |
| 7 | A-135 CARTRIDGE BOLT | 2 |
| 8 | A-147 FLAT WASHER | 4 |
| 9 | A-159 LOCK NUT | 4 |
| 10 | A-139 FLAT WASHER | 7 |
| 11 | U-223 EXHAUST COVER | 2 |
| 12 | C-210 CAUTION DECAL | 1 |
| 13 | J-210 DECAL RULES | 1 |
| 14 | T-223 EXHAUST TUBE | 1 |
| 15 | N-135 SPACER | 3 |
| 16 | A-136 CARTRIDGE BOLT | 3 |
| 17 | A-147 WASHER | 4 |
| 18 | D-239 CLAMP RING | 1 |
| 19 | C-210 CAUTION DECAL | 1 |
| 20 | A-159 LOCK NUT | 1 |
| 21 | I-138 HEX SCREW | 1 |
| 22 | C-223 INLET CONER | 1 |
| 23 | A-225 DECAL | 1 |
| 24 | B-136 CARTRIDGE BOLT | 4 |
| 25 | B-136 CARTRIDGE BOLT | 4 |
| 26 | W-500 BLOWER HOUSING | 1 |
| 27 | B-238 WIRE CLIP | 1 |
| 28 | K-148 HEX SCREW | 1 |
| 29 | E-146 LOCK WASHER | 1 |
| 30 | C-135 FLAT WASHER | 1 |
| 31 | SEE OPTIONAL CHART | 1 |
| 32 | I-230 SQUARE KEY | 1 |
| 33 | A-149 HEX SCREW | 4 |
| 34 | M-501 LOCK NUT | 4 |
| 35 | M-501 MAIN FRAME | 1 |
| 36 | A-159 LOCK NUT | 1 |
| 37 | N-210 ID DECAL | 1 |
| 38 | C-225 CAUTION DECAL | 1 |
| 39 | F-225 OIL DECAL | 1 |
| 40 | SEE OPTIONAL CHART | 1 |
| 41 | B-143 HEX SCREW | 4 |
| 42 | A-147 FLAT WASHER | 4 |
| 43 | B-158 LOCK NUT | 4 |
| 44 | V-228 SWITCH COVER | 1 |
| 45 | K-136 CARTRIDGE BOLT | 3 |
| 46 | D-132 HEX SCREW | 1 |
| 47 | E-158 LOCK NUT | 3 |
| 48 | V-208 SWITCH LEVER | 1 |
| 49 | D-146 LOCK WASHER | 1 |
| 50 | O-193 EYE TERMINAL | 1 |
| 51 | R-193 REL SWITCH | 1 |
| 52 | Q-193 CONNECTOR | 1 |
| 53 | L-212 RED WIRE | 1 |

~~MODEL 707
 7 1/2 H.P. KOHLER
 NAME
 ITEM NO. QTY
 31 L-208 IMPELLER 1" ID 1
 40 M-200 MOTOR 7 1/2 H.P. 1~~

~~MODEL 708
 8 H.P. BRIGGS & STRATTON
 NAME
 ITEM NO. QTY
 31 L-205 IMPELLER 1" ID 1
 40 M-200 MOTOR 8 H.P. 1~~

~~MODEL 710
 10 H.P. KOHLER
 NAME
 ITEM NO. QTY
 31 M-205 IMPELLER 1 1/8 ID 1
 40 R-200 MOTOR 10 H.P. 1~~

~~MODEL 712
 12 H.P. KOHLER
 NAME
 ITEM NO. QTY
 31 M-205 IMPELLER 1 1/8 ID 1
 40 S-200 MOTOR 12 H.P. 1~~

~~MODEL 714
 14 H.P. KOHLER
 NAME
 ITEM NO. QTY
 31 M-205 IMPELLER 1 1/8 ID 1
 40 T-200 MOTOR 14 H.P. 1~~

Salsco, Inc.
 LEADER BY DESIGN
 105 SCHOOL HOUSE ROAD
 CHESHIRE, CONNECTICUT 06410

| ITEM NO | NAME | QTY |
|----------|-------------------|-----|
| 60 0-104 | RUBBER GRIP PAD | 4 |
| 61 I-224 | CLAMP FOOT | 2 |
| 62 A-143 | HEX SCREW | 2 |
| 63 A-146 | LOCK WASHER | 2 |
| 64 B-158 | LOCK NUT | 2 |
| 65 W-228 | CLAMP ASSY | 2 |
| 66 B-158 | LOCK NUT | 2 |
| 67 A-143 | HEX SCREW | 4 |
| 68 Q-227 | LIFT HANDLE | 4 |
| 69 A-143 | HEX SCREW | 1 |
| 70 N-231 | RIGHT BRACKET | 1 |
| 71 O-231 | LEFT BRACKET | 1 |
| 72 J-227 | RIGHT CLAMP LEVER | 1 |

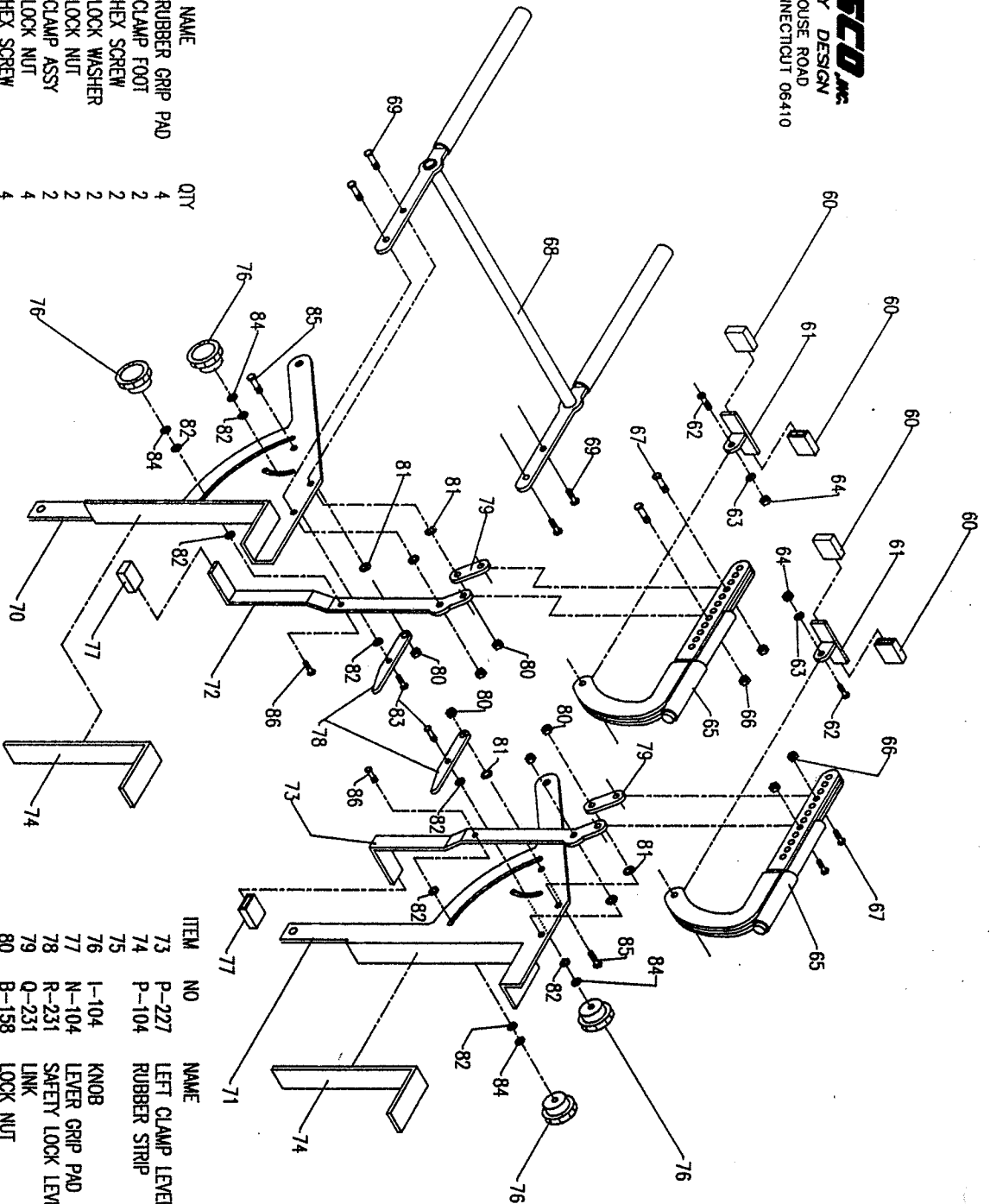

| ITEM NO | NAME | QTY |
|----------|-------------------|-----|
| 73 P-227 | LEFT CLAMP LEVER | 1 |
| 74 P-104 | RUBBER STRIP | 2 |
| 75 | | |
| 76 I-104 | KNOB | 4 |
| 77 N-104 | LEVER GRIP PAD | 2 |
| 78 R-231 | SAFETY LOCK LEVER | 2 |
| 79 Q-231 | LINK | 2 |
| 80 B-158 | LOCK NUT | 2 |
| 81 A-147 | FLAT WASHER | 6 |
| 82 A-139 | FLAT WASHER | 6 |
| 83 M-138 | HEX SCREW | 3 |
| 84 D-146 | LOCK WASHER | 2 |
| 85 A-142 | HEX SCREW | 4 |
| 86 M-138 | HEX SCREW | 2 |

Salsco, INC.
LEADER BY DESIGN