

Salsco, INC.

LEADER BY DESIGN

TAILGATE LOADER VAC

MODEL 707 7 1/2 H.P. KAWASAKI
708 8 H.P. BRIGGS & STRATTON
710 10 H.P. KOHLER
712 12 H.P. KOHLER
714 14 H.P. KOHLER

OWNER'S MANUAL
PARTS MANUAL
SERVICE MANUAL

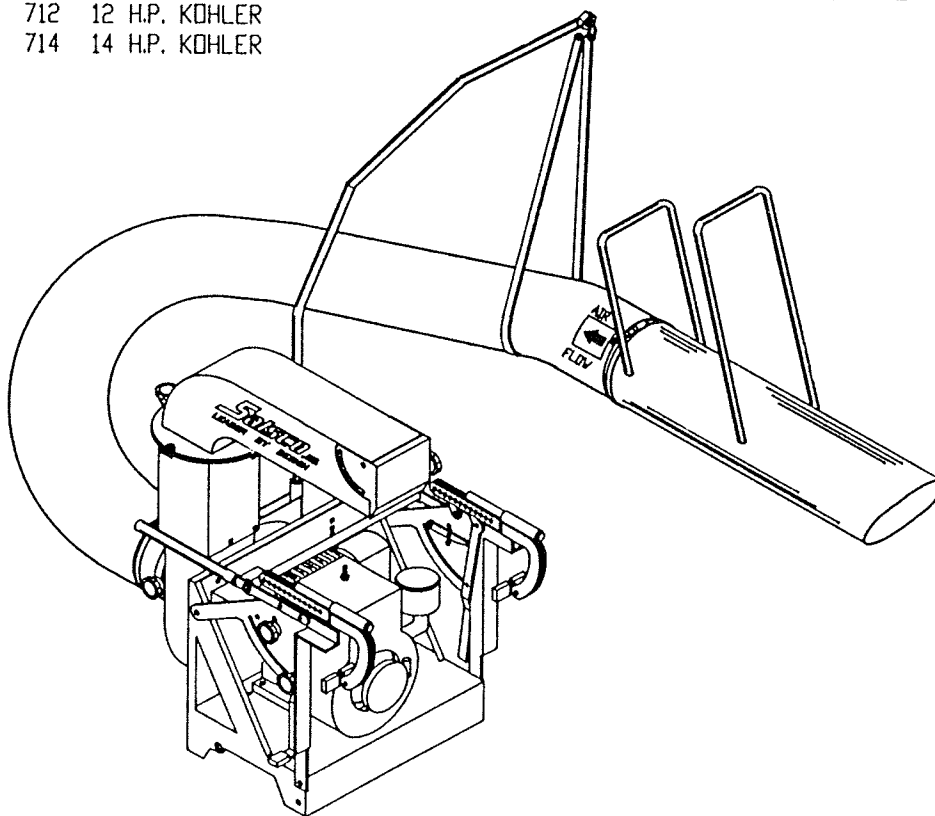

SALSCO, INC.
TURF EQUIPMENT DIVISION
105 SCHOOL HOUSE ROAD
CHESHIRE, CONN. 06410 USA

* NOTE: PLEASE READ "CAUTIONS" IN THIS MANUAL

STATEMENT OF FACT

YOU HAVE JUST PURCHASED THE HIGHEST QUALITY, MOST EFFICIENT TAILGATE VACUUM ON THE MARKET TODAY. THIS UNIT HAS THE ABILITY TO MEET EXACT STANDARDS AND PERFORM FOR YEARS WITH MINIMUM DOWN TIME. HOWEVER, IT CANNOT READ NOR WILL IT UNDERSTAND THIS MANUAL NO MATTER HOW LONG YOU LEAVE IT ON TOP OF THE MACHINE. IT IS YOUR RESPONSIBILITY TO READ AND UNDERSTAND IT. IT IS ALSO YOUR RESPONSIBILITY TO BE CERTAIN THIS INFORMATION IS PASSED ALONG TO ANYONE WHO IS EXPECTED TO OPERATE THIS EQUIPMENT. SHOULD YOU CHOOSE NOT TO READ, UNDERSTAND AND PASS ALONG THE INFORMATION PROVIDED YOU, PLEASE EXPECT EQUIPMENT FAILURE AND POSSIBLE INJURIES TO PERSONS AROUND THIS EQUIPMENT.

FOR THE SAFETY OF THE OPERATOR, IT IS IMPERATIVE THAT THIS MANUAL IS CAREFULLY READ AND UNDERSTOOD.

HAVING READ THIS MANUAL, IT IS YOUR RESPONSIBILITY TO BE SURE THAT ALL NEW OPERATORS READ AND UNDERSTAND THIS MANUAL ESPECIALLY THE CAUTIONS ON PAGE FIVE.

AS A MANUFACTURER OF EQUIPMENT WE HAVE A RESPONSIBILITY TO DESIGN A SAFE PIECE OF EQUIPMENT. HOWEVER, ONLY YOU CAN PREVENT ACCIDENTS!!

DO NOT RUN MACHINE WITHOUT GUARDS IN PLACE

DESCRIPTION

700 SERIES TAILGATE AND TRUCK LOADERS

Within the family of loadervacs, we have several horse powers and models to choose from. The last two digits of this series indicate the horse power of the unit. The 14 H.P. and lower are designed for easy use in a tailgate application. These units are light and have an external clamping mechanism. There are many improvements this year to the loadervac line. All tailgate models, 14 H.P. and down, are designed in such a way that owners can change horse power of these vacs at will from 7 1/2 to 14 H.P. We've upgraded the hoses on all vacs to a 2 ply neoprene impregnated nylon material hose, with a yellow scuff strip for severe abrasion resistance. All our impellers are welded on a robotic welding system which insures proper balance and a smooth running unit. As with all Salsco quality products, these vacs have a baked enamel finish to insure excellent appearance for years to come.

THINK

SAFETY

MANUFACTURED BY: SALSCO, INC.
TURF EQUIPMENT DIVISION
105 SCHOOL HOUSE ROAD
CHESHIRE, CONNECTICUT 06410
203/271-1682
FAX (203) 271-2596

TAILGATE LOADER VACUUM MANUAL

THIS MANUAL COVERS MODELS: 707, 708, 710, 712 &
714 TAILGATE LOADERS

This company reserves the right to discontinue,
add improvements to, or change the design of any
model or product at any time without obligation to
improve existing machines, either by changing the
design or adding new parts.

It has been and will continue to be the policy of
SALSCO to update existing machines at its own
discretion. Whenever possible, new designs will
be made in such a way, that they can be "Retro
Fit" if so desired.

Record in space provided below the model and
serial numbers of this unit. Please retain these
numbers for future reference.

No parts orders will be accepted without Model
numbers or parts numbers.

----- Model Number		----- Serial Number		
<u>Model No.</u>	<u>Prefix</u>	<u>Part Number Code:</u>		
		<u>Model</u>	<u>Part Number*</u>	
710	= 710	000	A	000

* PART NUMBER PREFIX MUST BE USED WHEN ORDERING PARTS (___A000).
PREFIX NUMBER IS LISTED ABOVE.

**** CAUTION ****

READ AND UNDERSTAND THIS MANUAL BEFORE STARTING MACHINE!!

DO NOT RUN MACHINE WITHOUT GUARDS IN PLACE

SERVICE SCHEDULE

- | | | |
|----|--|--------|
| 1. | CHECK ENGINE OIL (SEE ENGINE MANUAL) | DAILY |
| 2. | CHECK VIBRATIONS | DAILY |
| 3. | CHECK FOR TORN OR DAMAGED HOSE | DAILY |
| 4. | VISUALLY CHECK FOR LOOSE BOLTS OR DAMAGE | DAILY |
| 5. | CLEAN MACHINE | DAILY |
| 6. | CHECK BATTERY FOR WATER AND ELECTRICAL CONNECTIONS | WEEKLY |

THINK

SAFETY

CAUTION

BEFORE YOU START THIS MACHINE:

1. READ AND UNDERSTAND OWNER'S MANUAL.
2. DO NOT RUN WITHOUT GUARDS AND OTHER SAFETY COVERS ON MACHINE.
3. NEVER LEAVE MACHINE RUNNING WHILE UNATTENDED.
4. NEVER REACH UNDER OR INTO MACHINE FOR ANY REASON WHILE MACHINE IS RUNNING AS IT CAN CAUSE SERIOUS INJURY.
5. ALWAYS REMOVE SPARK PLUG WIRE, MAKE SURE ENGINE SWITCH IS OFF, THROTTLE IS IN STOP POSITION, AND SHUT GAS OFF WHEN WORKING ON OR CHECKING INSIDE OF MACHINE.
6. NEVER CLEAN INLET TUBE OR OUTLET TUBE WHILE ENGINE IS RUNNING.
7. EYE PROTECTION SHOULD ALWAYS BE WORN WHEN RUNNING MACHINE.
8. BE SURE AIR INTAKE ON ENGINE IS CLEAR OF LEAVES AND DEBRIS.
9. DO NOT REMOVE CAUTION DECALS.
10. SAFETY DECALS SHOULD BE REPLACED IMMEDIATELY AFTER REPAINTING OR WHEN THEY BECOME ILLEGIBLE. ** SEE NOTE BELOW **

**** NOTE ****

SAFETY IS A PRIME CONCERN AT SALS CO AND THE SAFETY DECALS ON YOUR MACHINE ARE A HIGHLY VISIBLE AND CONSTANT REMINDER TO ALL OPERATORS. REPLACEMENT SAFETY DECALS MAY BE OBTAINED FROM YOUR LOCAL DEALER OR BY CALLING TOLL FREE 1-800-8SALSCO.

DO NOT RUN MACHINE WITHOUT GUARDS IN PLACE

OPERATING INSTRUCTIONS

- 1) ADJUST CLAMPING MECHANISM TO FIT YOUR TAILGATE.
- 2) AFTER CHECKING ENGINE OIL, CLAMP UNIT TO TAILGATE.
- 3) CONNECT INPUT HOSE AND BE SURE EXHAUST ISN'T POINTED AT YOUR REAR WINDOW AS THE UNIT WILL BEGIN THROWING DEBRIS AS SOON AS IT IS STARTED.
- 4) START ENGINE AND PASS INLET TUBE OVER MATERIAL TO BE PICKED UP.

**** NOTE ****

BE CAREFUL NOT TO PICK UP ROCKS, BOTTLES ETC. AS THIS COULD RESULT IN DAMAGE TO THE UNIT AND POSSIBLY INJURE THE OPERATOR.

DO NOT RUN MACHINE WITHOUT GUARDS IN PLACE

Salsco, Inc.
LEADER BY DESIGN
 105 SCHOOL HOUSE ROAD
 CHESHIRE, CONNECTICUT 06410

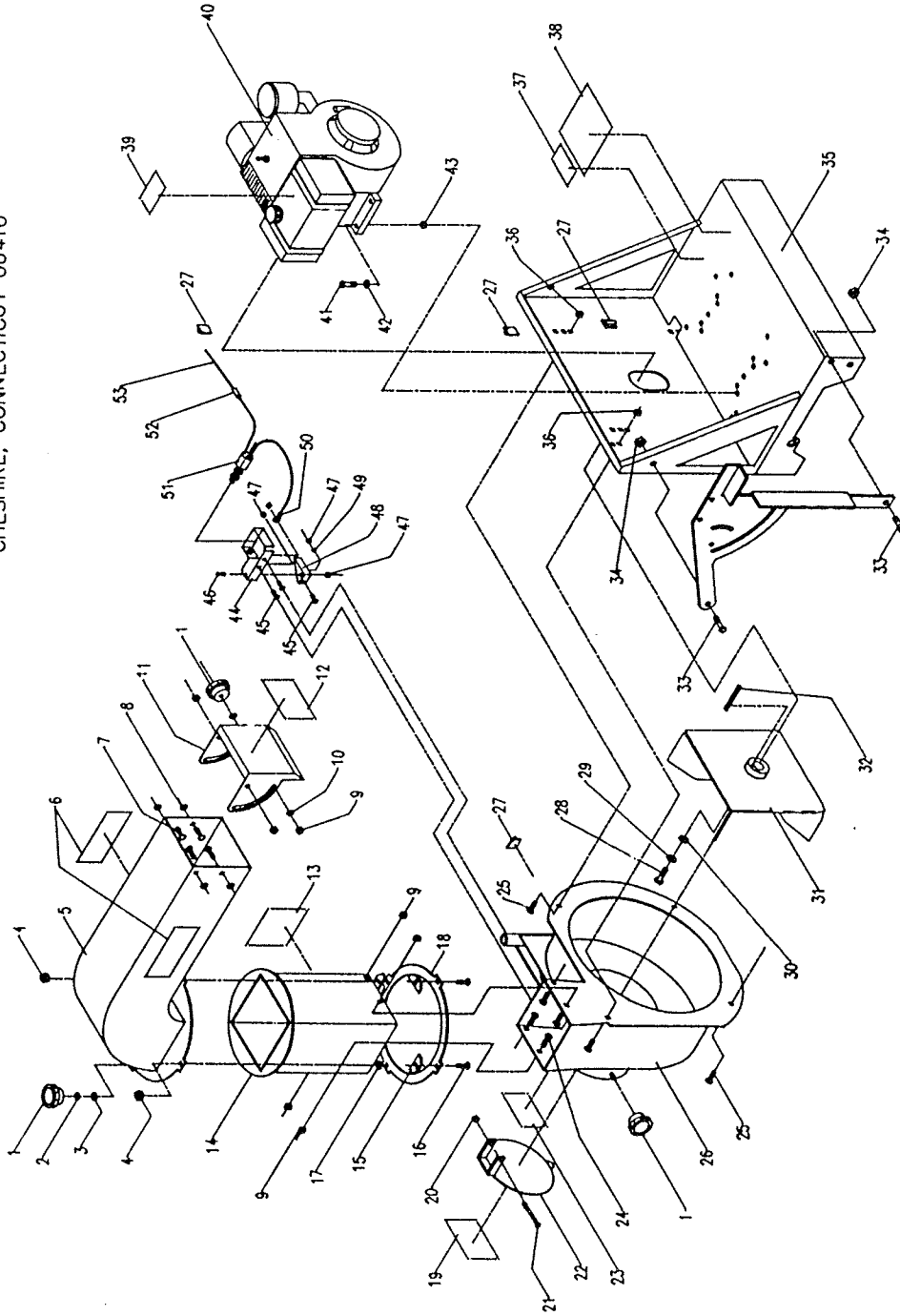

ITEM	NO	NAME	QTY
1	I-104	KNOB	3
2	D-146	LOCK WASHER	1
3	A-139	FLAT WASHER	1
4	A-159	LOCK NUT	3
5	S-223	EXHAUST ELBOW	1
6	B-210	DECAL	2
7	A-136	CARRIAGE BOLT	4
8	A-147	FLAT WASHER	4
9	A-159	LOCK NUT	7
10	A-139	FLAT WASHER	2
11	U-223	EXHAUST COVER	1
12	C-210	CAUTION DECAL	1
13	J-210	DECAL RULES	1
14	T-223	EXHAUST TUBE	1
15	N-135	SPACER	3
16	A-136	CARRIAGE BOLT	4
17	A-147	FLAT WASHER	1
18	D-239	CLAMP RING	1
19	C-210	CAUTION DECAL	1
20	A-159	LOCK NUT	1
21	I-138	HEX SCREW	1
22	C-223	INLET COVER	1
23	A-225	DECAL	1
24	B-136	CARRIAGE BOLT	4
25	B-136	CARRIAGE BOLT	4
26	W-500	BLOWER HOUSING	1
27	B-238	WIRE CLIP	1
28	K-148	HEX SCREW	1
29	E-146	LOCK WASHER	1
30	C-135	FLAT WASHER	1
31	SEE OPTIONAL CHART		
32	I-230	SQUARE KEY	1
33	A-149	HEX SCREW	4
34	A-159	LOCK NUT	4
35	M-501	MAIN FRAME	1
36	A-159	LOCK NUT	4
37	N-210	LD DECAL	1
38	C-225	CAUTION DECAL	1
39	F-225	OIL DECAL	1
40	SEE OPTIONAL CHART		
41	B-143	HEX SCREW	4
42	A-147	FLAT WASHER	4
43	B-158	LOCK NUT	4
44	V-228	SWITCH COVER	1
45	K-136	CARRIAGE BOLT	3
46	D-132	HEX SCREW	1
47	E-158	LOCK NUT	3
48	V-208	SWITCH LEVER	1
49	D-146	LOCK WASHER	1
50	O-193	EYE TERMINAL	1
51	R-193	KILL SWITCH	1
52	Q-193	CONNECTOR	1
53	L-212	RED WIRE	1
			60

MODEL 707
 7 1/2 H.P. KAWASAKI

MODEL 708
 8 H.P. BRIGGS & STRATTON

MODEL 710
 10 H.P. KOHLER

MODEL 712
 12 H.P. KOHLER

MODEL 714
 14 H.P. KOHLER

ITEM	NO	NAME	QTY
31	L-205	IMPELLER 1" ID	1
40	N-200	MOTOR 7 1/2 H.P.	1
31	L-205	IMPELLER 1" ID	1
40	M-200	MOTOR 8 H.P.	1
31	M-205	IMPELLER 1 1/8 ID	1
40	R-200	MOTOR 10 H.P.	1
31	M-205	IMPELLER 1 1/8 ID	1
40	S-200	MOTOR 12 H.P.	1
31	M-205	IMPELLER 1 1/8 ID	1
40	T-200	MOTOR 14 H.P.	1

Salsco, Inc.

LEADER BY DESIGN
105 SCHOOL HOUSE ROAD
CHESHIRE, CONNECTICUT 06410

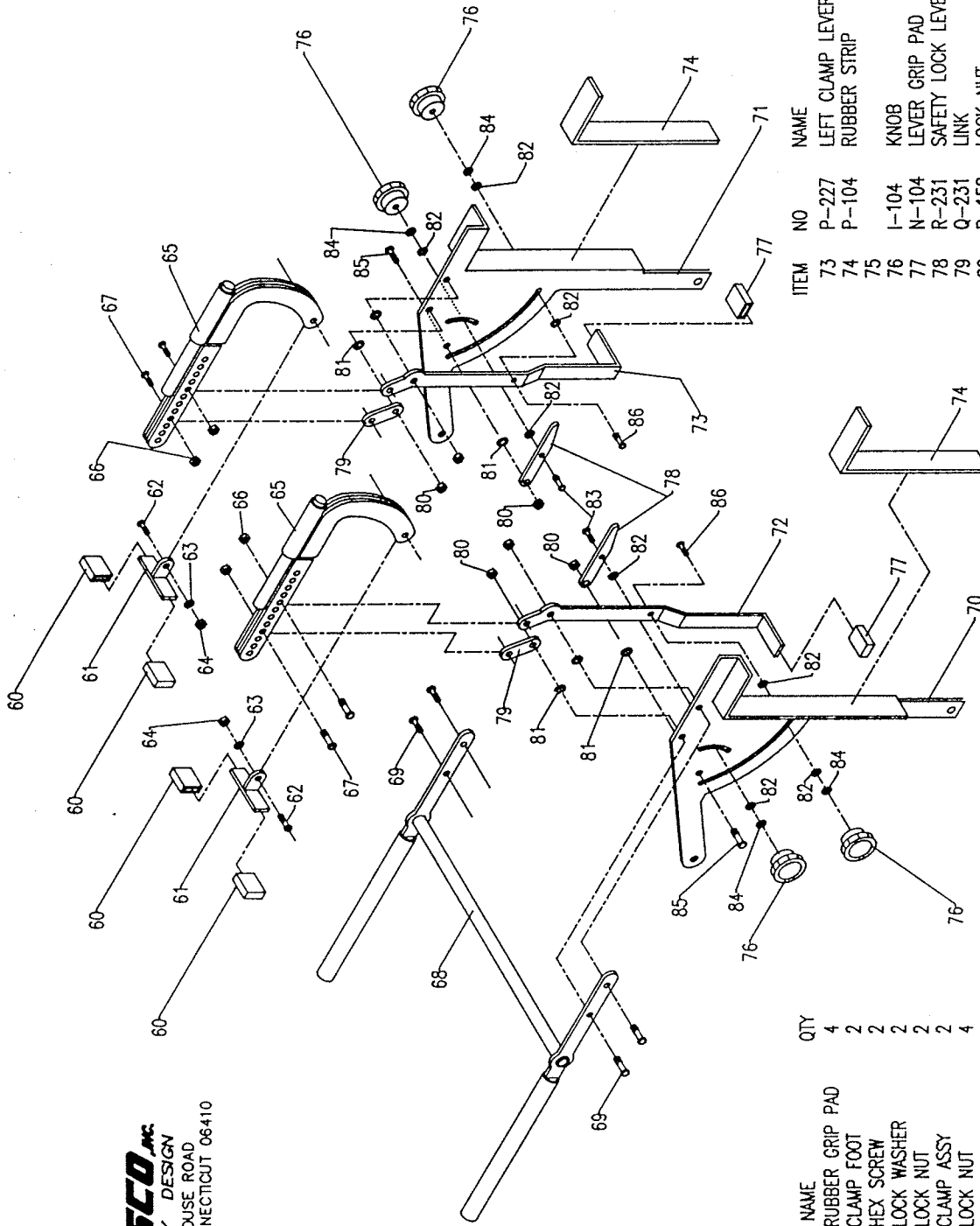

ITEM	NO	NAME	QTY
73	P-227	LEFT CLAMP LEVER	1
74	P-104	RUBBER STRIP	2
75			
76	I-104	KNOB	4
77	N-104	LEVER GRIP PAD	2
78	R-231	SAFETY LOCK LEVER	2
79	Q-231	LINK	2
80	B-158	LOCK NUT	6
81	A-147	FLAT WASHER	6
82	A-139	FLAT WASHER	3
83	M-138	HEX SCREW	2
84	D-146	LOCK WASHER	4
85	A-142	HEX SCREW	2
86	M-138	HEX SCREW	2

ITEM	NO	NAME	QTY
60	O-104	RUBBER GRIP PAD	4
61	I-224	CLAMP FOOT	2
62	A-143	HEX SCREW	2
63	A-146	LOCK WASHER	2
64	B-158	LOCK NUT	2
65	W-228	CLAMP ASSY	2
66	B-158	LOCK NUT	4
67	A-143	HEX SCREW	4
68	Q-227	LIFT HANDLE	1
69	A-143	HEX SCREW	4
70	N-231	RIGHT BRACKET	1
71	O-231	LEFT BRACKET	1
72	J-227	RIGHT CLAMP LEVER	1

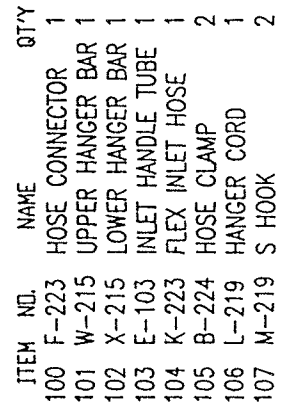

WARRANTY

Your Salsco Commercial or Turf Equipment product is a commercial type product and is normally manufactured and sold for commercial or industrial use. Salsco will, for the original purchaser, for one (1) year from the date of purchase (90 days if used for rental purposes;) repair or replace, free of charge, any part or parts found to be defective in material or workmanship or both. Any transportation charges to be borne by the purchaser.

If, during the Warranty Period, the product does not function properly due to defect, simply contact your Salsco Dealer and provide the unit or part for inspection or contact directly:

SALSCO, INC.
Service Department
105 School House Road
Cheshire, CT 06410

203/271-1682
FAX: 203/271-2596

This warranty does not include incidental or consequential damages and is exclusive of any implied warranties.

This warranty does not include normal maintenance parts, including, but not limited to spark plugs, filters, lubricants, springs, tines, tine overlays, nylon bars, and blades.

This warranty does not include parts or components which are covered under the original manufacturers warranty, including, but not limited to engine and differential.

[illegible]

Salsco, INC.

LEADER BY DESIGN

105 SCHOOL HOUSE ROAD
CHESHIRE, CONNECTICUT 06410