

6507552 TOUCH SCREEN CONVERSION KIT INSTALLATION INSTRUCTIONS

CONVERTS AN OLDER CIMREX TOUCH SCREEN OR EXTER TOUCH SCREEN

THIS TOUCH SCREEN CONVERSION KIT APPLIES TO 650 ACCU-MASTER GRINDERS WITH THE ACCU-TOUCH CONTROL USING A CIMREX OR EXTER TOUCHSCREEN.

INSTALLATION:

1. Unplug the Grinder from the wall outlet to remove all power to the machine.
2. Remove the two fasteners (A) below the Handle and tilt the Control Panel Top (B) back to access the wiring.
3. Remove the screws (C) holding the Handle (D) to the Control Panel Top (B). Save the Handle and all fasteners to install on the new Control Panel Top.
4. Disconnect the cable that connects the Touchscreen to the PLC and disconnect all wires to the Control Panel Switches, Buttons and Knobs. (You may want to take a picture to aid in reattaching wires or use the Wiring Diagram from the [Service Manual](#)). See FIG. 2.

To remove Knobs: Loosen Set Screw and pull off Knob. Remove retaining nut.

To remove Buttons: Use a small, flat blade screwdriver to pry the spring to remove the wire terminal block and then unscrew the retaining nut.

To remove Switches: Push in locking tabs on the ends of the Switch and push Switch through the opening.

5. Remove the fasteners (E) from the Hinge (F) and remove the Control Panel Top.
6. Attach the new Control Panel Top using the fasteners (E) to the Hinge (F).
7. Apply the Decal (G) to the new Control Panel Top (6509606)
8. Attach the Handle (D) to the new Control Panel Top using Fasteners (C).
9. Transfer each Button, Switch, and Knob from the old Control Panel Top to the new Control Panel Top. There is a new Decal 3706077 in the Update Kit to use for machines with the newer Spin Drive Control.
10. Install the new Touch Screen (H), item 6529565, and secure with the screw clips.
11. Install the new cord to the COM1 Port on the Touchscreen and the other end to the PLC port.
12. Connect all wires to Buttons, Switches, and Knobs. (Use Wiring Diagram in [Service Manual](#)).
13. Lower the Control Panel Top (B) and secure the Top to the Control Panel using the 2 Fasteners (A).
14. Reconnect the power to the machine and turn ON and test all functions.

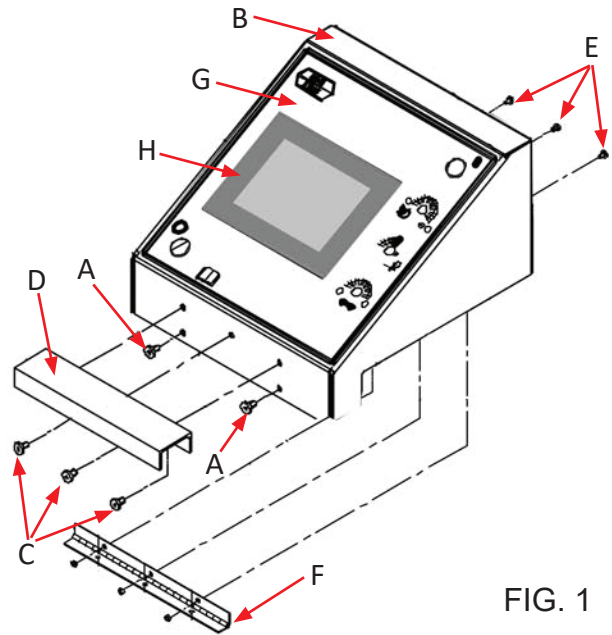

FIG. 1

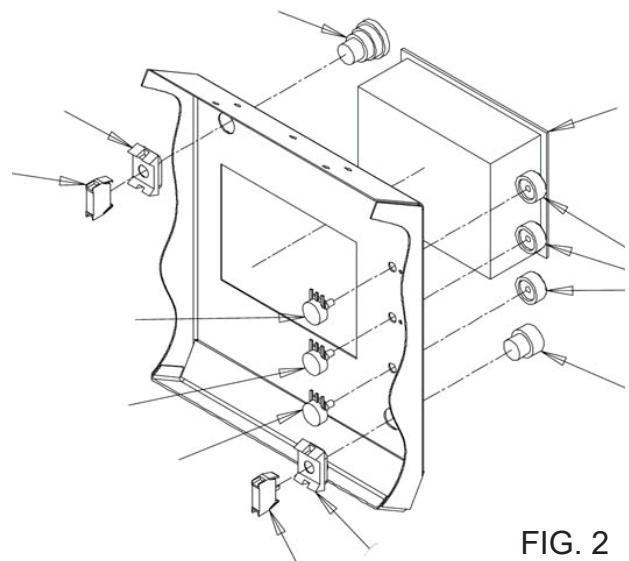
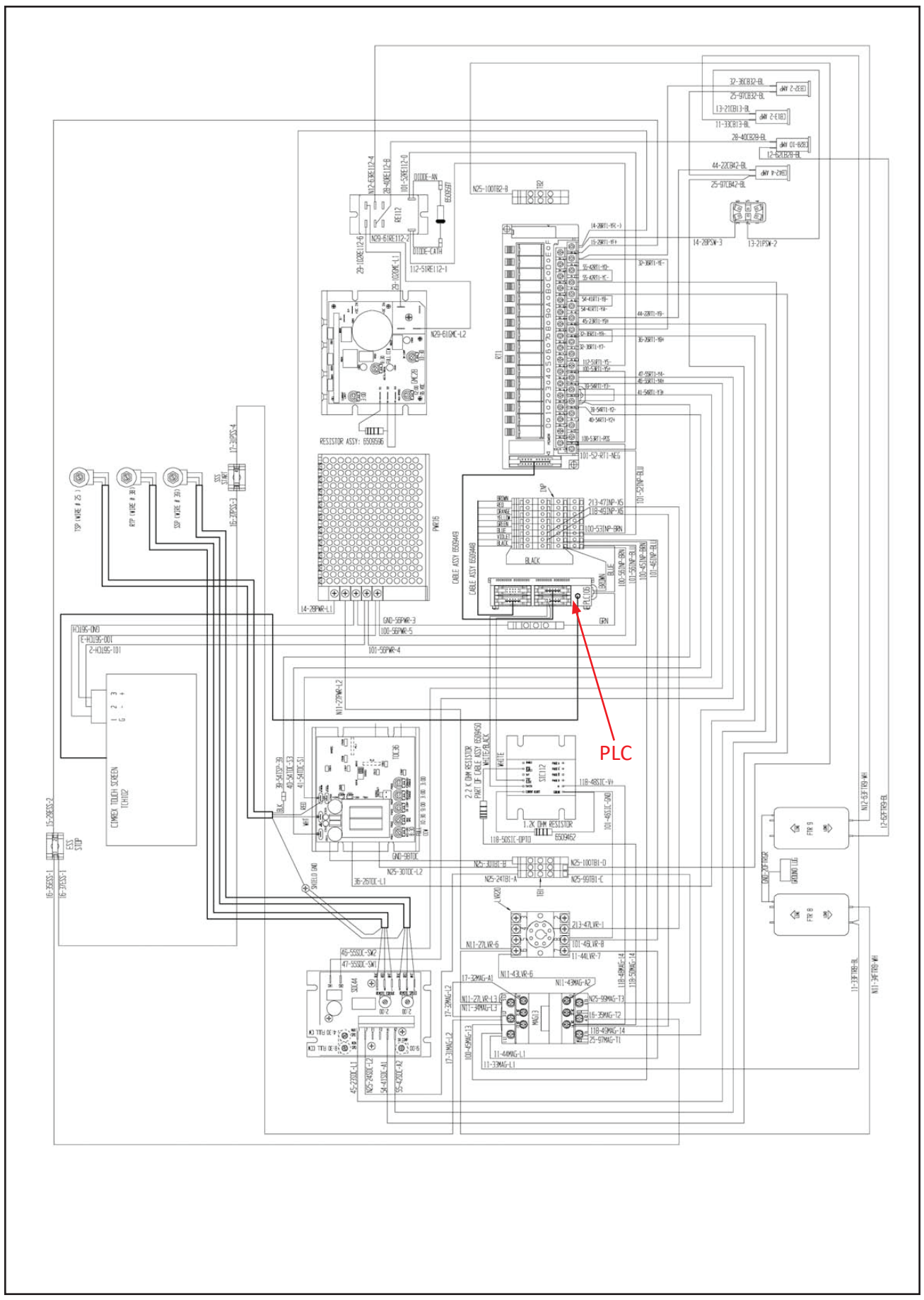

FIG. 2



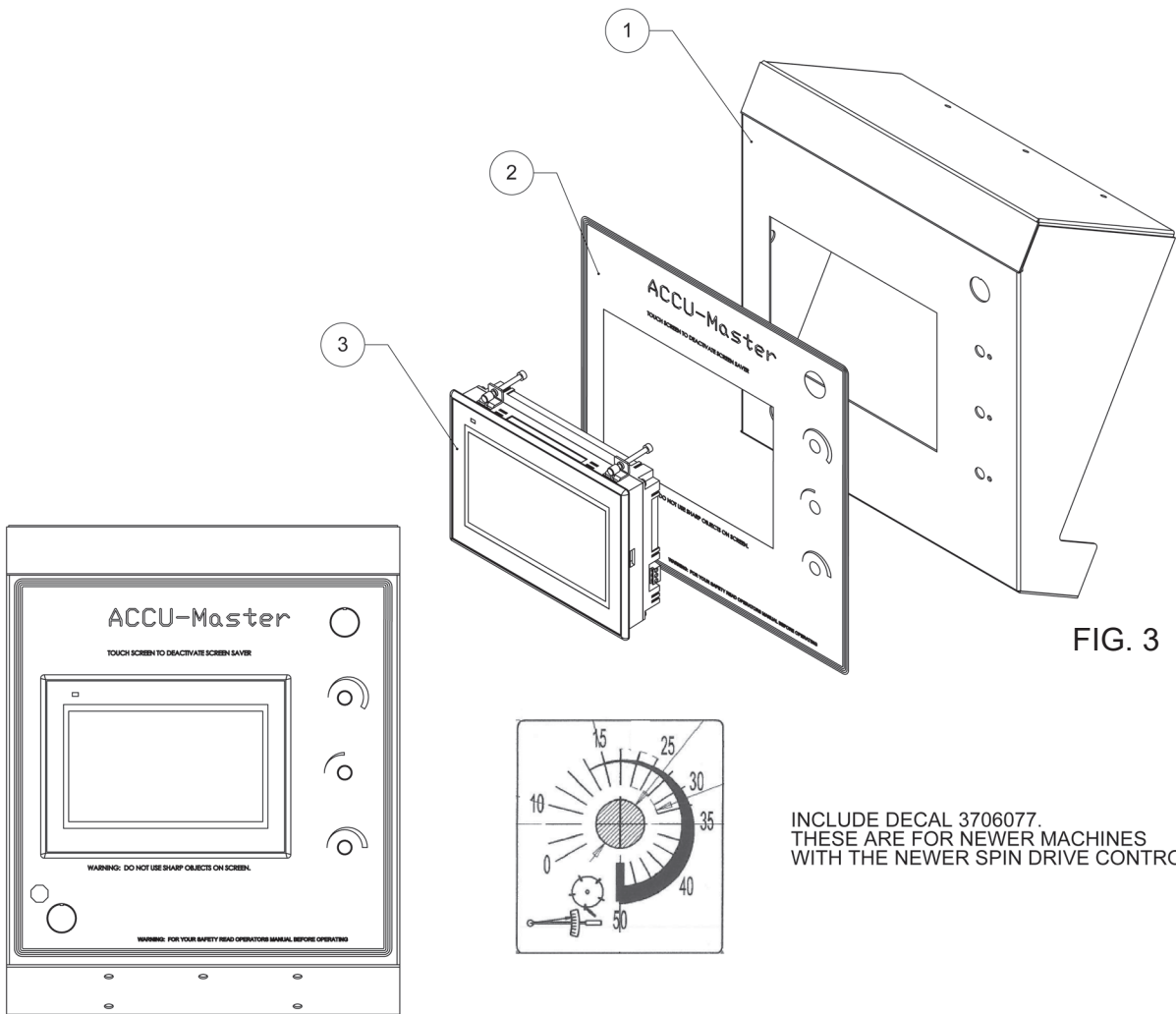

FIG. 3

INCLUDE DECAL 3706077.
THESE ARE FOR NEWER MACHINES
WITH THE NEWER SPIN DRIVE CONTROL

DRAWING NO.	PART NO.	DESCRIPTION
1.....	6509606	PANEL - CONTROL TOP
2.....	6509603	DECAL - CONTROL PANEL 650
3.....	6529565	7" TOUCHSCREEN 652 PROGRAMMED
4.....	3706077	TORQUE POT DECAL
NOT SHOWN...	6529112	TOUCHSCREEN CABLE ASSEMBLY