

MODEL 6200960 MANUAL WINCH AND BOOM KIT



INSTALLATION AND OPERATORS MANUAL



You must thoroughly read and understand this manual before operating the equipment, paying particular attention to the Warning & Safety instructions.

TABLE OF CONTENTS

Safety Instructions	Page 2-3
Installation.....	Page 4
Operation.....	Page 5
Exploded Parts List.....	Page 6-9

 This boom is designed to be installed on the ACCU-Pro 632 Reel Mower Sharpener and used to lift reel type mowing units into the machine. Failure to install this correctly or any use other than that specified may cause personal injury and void the warranty. Be sure to read and understand all safety instructions in this manual and the manual for the machine in which this will be attached BEFORE using this equipment. 

To assure the quality and safety of your equipment and to maintain the warranty, you **MUST** use original equipment manufacturer's replacement parts and have any repair work done by a qualified professional.

ALL operators of this equipment must be thoroughly trained **BEFORE** operating the equipment.



READ AND UNDERSTAND AND LOCATE ALL DECALS ON THIS MACHINE BEFORE OPERATING THIS EQUIPMENT.



WINCH AND BOOM CAPACITY IS A MAXIMUM OF 180Kg OR 400 LBS. Exceeding the capacity may result in personal injury or damage to the equipment.

Throughout this manual, the following safety symbols will be used to indicate the degree of certain hazards.



This symbol is used to indicate important information.



This symbol is used throughout this manual to call attention to the safety procedures.

 **DANGER**

The word **DANGER** indicates an immediate hazardous situation, which if not avoided, will result in death or serious injury.

 **WARNING**

The word **WARNING** indicates a potential hazardous situation, which if not avoided, could result in death or serious injury.

 **CAUTION**

The word **CAUTION** preceded with a safety alert symbol indicates a potential hazardous situation which, if not avoided, may result in minor or moderate injury.

WARNING

CAREFULLY READ ALL THE INSTRUCTIONS BELOW BEFORE ATTEMPTING TO OPERATE OR SERVICE YOUR WINCH! FAILURE TO COMPLY WITH INSTRUCTIONS COULD RESULT IN PERSONAL INJURY, DEATH AND/OR PROPERTY DAMAGE!

1. Maximum lifting capacity is 400 pounds (180 kg.) in a single line operation. **DO NOT ATTEMPT TO MOVE LOADS GREATER THAN THE RATING.**
2. **NEVER CARRY** personnel on the hook or the load.
3. **NEVER MOVE A LOAD** with this winch until all personnel are clear.
4. **NEVER HOOK THE WIRE ROPE BACK ON ITSELF. USE THE SPREADER BAR ASSEMBLY.** Hooking the wire rope back on itself creates an unacceptable strain on the wire rope.
5. **DO NOT ALLOW** unqualified personnel to operate this unit.
6. **KEEP CLEAR OF WINCH WIRE ROPE AND HOOK WHEN OPERATING WINCH. DO NOT ATTEMPT** to guide wire rope by hand as it rewinds.
7. **DO NOT** use the wire rope as a ground for welding.
8. **NEVER TOUCH** a welding electrode to the wire rope.
9. **WHEN SPREADER BAR ASSEMBLY IS USED** be sure it is properly seated in the saddle of the hook.
10. **AVOID** excessive inching and quick reversals of load.
11. **BE SURE** that the power supply is disconnected before performing maintenance and repair procedure.
12. **DO NOT OPERATE** this unit if it is not functioning properly.
13. **MAINTAIN A MINIMUM OF 4 TURNS OF WIRE ROPE** around the winch drum to prevent the wire rope from pulling off under load.
14. **KEEP WINCHING AREA CLEAR.** Do not allow people to remain in the winching area. Do not stand between the winch and the load.
15. **INSPECT WIRE ROPE FREQUENTLY.** A frayed wire rope with broken strands should be replaced immediately. Never replace the wire rope with rope of any kind or with wire rope other than the type and size specified in the repair parts section of this manual.
16. **USE HEAVY LEATHER GLOVES** when handling the wire rope to eliminate the possibility of cuts or scratches from burrs and slivers from broken strands.
17. **ALLOW WINCH TO COOL DOWN FREQUENTLY (Electric Winch),** as the motor is designed for intermittent duty only. When the metal motor housing is hot to touch, it is time to let the winch cool down
18. **DO NOT OPERATE WINCH WHEN UNDER THE INFLUENCE OF DRUGS, ALCOHOL, OR MEDICATION.**
19. **DO NOT USE WINCH TO HOLD LOADS IN PLACE.** Use other means of securing loads, such as tie down straps.
20. **USE ONLY FACTORY APPROVED PARTS, SWITCHES, REMOTE CONTROLS AND ACCESSORIES.** Use of non-factory approved components may cause injury or property damage and could void your warranty.
21. **DO NOT MACHINE OR WELD ANY PART OF THE WINCH.** Such alterations may weaken the structural integrity of the winch and could result in personnel injury and void your warranty.
22. **DO NOT OPERATE THIS WINCH OUT DOORS OR IN A CORROSIVE OR EXPLOSIVE ENVIRONMENT.**

INSTALLATION

INSTALLING WINCH AND BOOM

Remove the Boom Hole Cover from the Left Side Guard and discard. See FIG. 1.

To install the Boom Socket Weldment to the Left Side Guard, first remove the four screws on the left side Guard. See FIG. 1. Discard the screws, nuts and washers. Next remove the socket head screws that attach the left side guard to the main cabinet. See FIG. 2. Discard the screws, but save the flat washers and lockwashers. Attach the Boom Socket Weldment to the Left Side Guard with the two B371611 3/8-16 x 1" Socket Head Screws in the Bag Assembly (Reuse the Flat Washers and lockwashers that were previously removed). Secure the bottom of the side with the four Button Head Socket Cap Screws B371616 3/8-16 x 1", 3/8" flat washers K370001, and four Locknuts J3707100. See Page 6 Exploded Assembly.

Install the Hook and Cable Assembly through the two pulleys on the Boom Assembly and down the center of the Boom Assembly. Route the cable assembly through the boom housing and out the hole in the bottom. Install the Boom Assembly into the boom weldment.

Install the third Pulley 3709795 with B372801 3/8-16 x 1-3/4 Hex Head Cap Screw, K371501 3/8 Lockwasher and 6059003 Pulley Guard Bracket. See Page 6 Exploded Assembly.

Install the Winch 3708578 using B371601 3/8-16 x 1" Hex Head Cap Screw (2), K371501 3/8 Lockwasher (2), K370001 3/8 Flat Washer (2) and J371000 3/8-16 Hex Nut (2). When installing the Winch, do not put on the 11" handle that comes with the winch, discard it and install the 7" winch handle shipped separately.

Loop the cable around the lower pulley and install the cable on the winch per the winch instructions included with the kit.

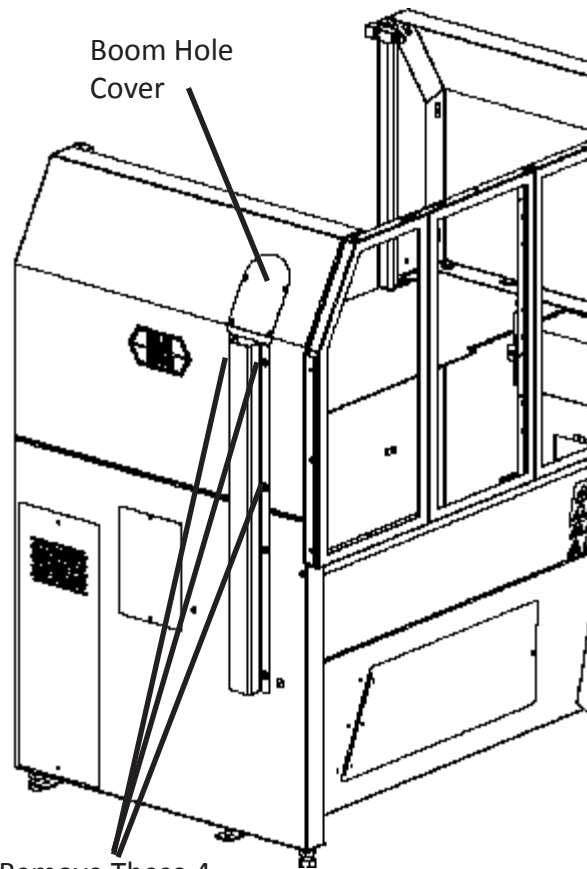

Remove These 4 Screws and Discard

FIG. 1

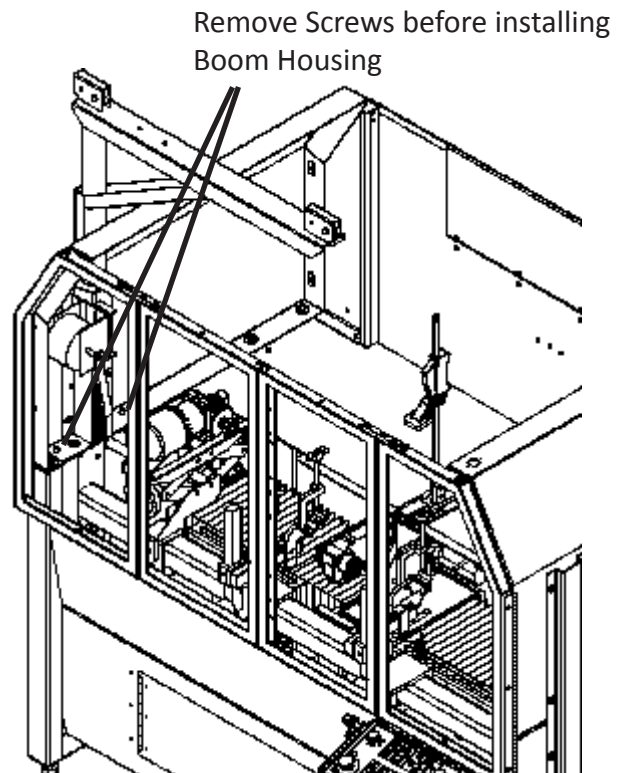

FIG. 2

OPERATION

LIFTING THE REEL INTO POSITION

Position the reel in front of the grinder on the floor so the front of the mower faces in the same direction as the front of the machine. See FIG. 3. Hook the winch spreader bar onto the reel. The clamps on the spreader bar should be spaced evenly along the mower, so they do not slide as the mower is being raised. Stand between the mowing unit and the winch and slowly raise the mowing unit into place.

For walker greensmowers, position the mowing unit so the handle points toward the winch. Then stand between the mowing unit and the grinder frame to winch the mowing unit to height. Then walk around the mowing unit and guide it into position.

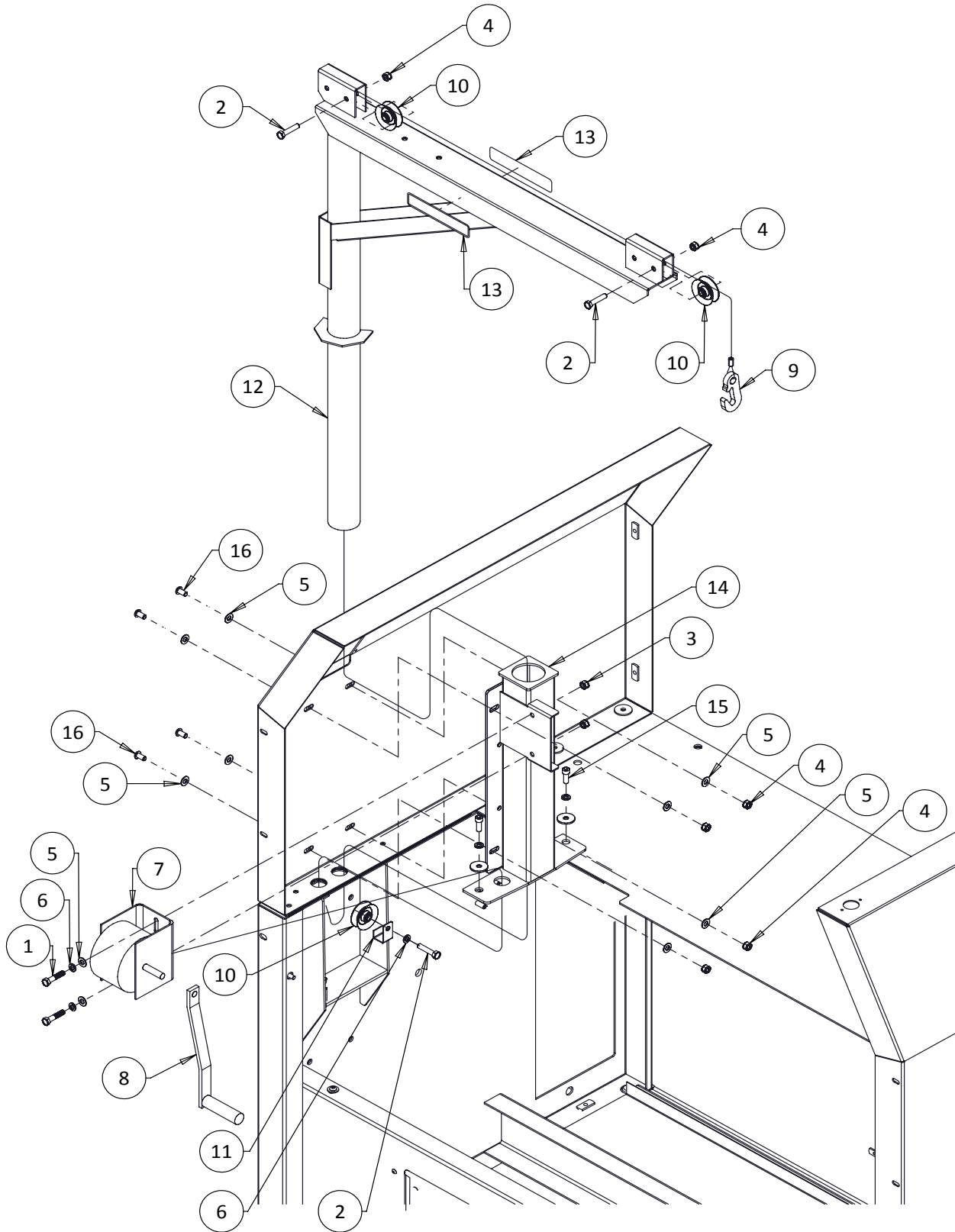

FIG. 3

WARNING

THE OPERATOR SHOULD BE POSITIONED AWAY FROM THE REEL. DO NOT STAND UNDERNEATH THE REEL AS IT IS BEING RAISED. GUIDE REEL AT ARMS LENGTH.

EXPLODED VIEW



PARTS LIST

<u>DIAGRAM NUMBER</u>	<u>PART NUMBER</u>	<u>DESCRIPTION</u>
1.....	B371601.....	Hex Head Cap Screw 3/8-16 x 1Long
2.....	B372801.....	Hex Head Cap Screw 3/8-16 x 1 3/4 Long
3.....	J371000.....	3/8-16 hex Nut
4.....	J377100.....	3/8-16 Nylon Locknut
5.....	K370001.....	3/8 Flat Washer
6.....	K371501.....	3/8 Split Lockwasher
7.....	3708578.....	Winch
8.....	3708647.....	7" Winch Handle
9.....	3709407*.....	Hook and Cable Assembly
10.....	3709795.....	Pulley
11.....	6059003.....	Pulley Guard Bracket
12.....	6059527.....	Boom Weldment
13.....	3706111.....	Boom Capacity Decal
14.....	6329541.....	Boom Support Weldment
15.....	B371611.....	Socket Head Cap Screw 3/8-16 x 1" Long
16.....	B371616.....	Button Head Cap Screw 3/8-16 x 1" Long

*Hook & Cable Assembly is packed in carton. Install as shown (cable runs down middle of boom tube).

EXPLODED VIEW

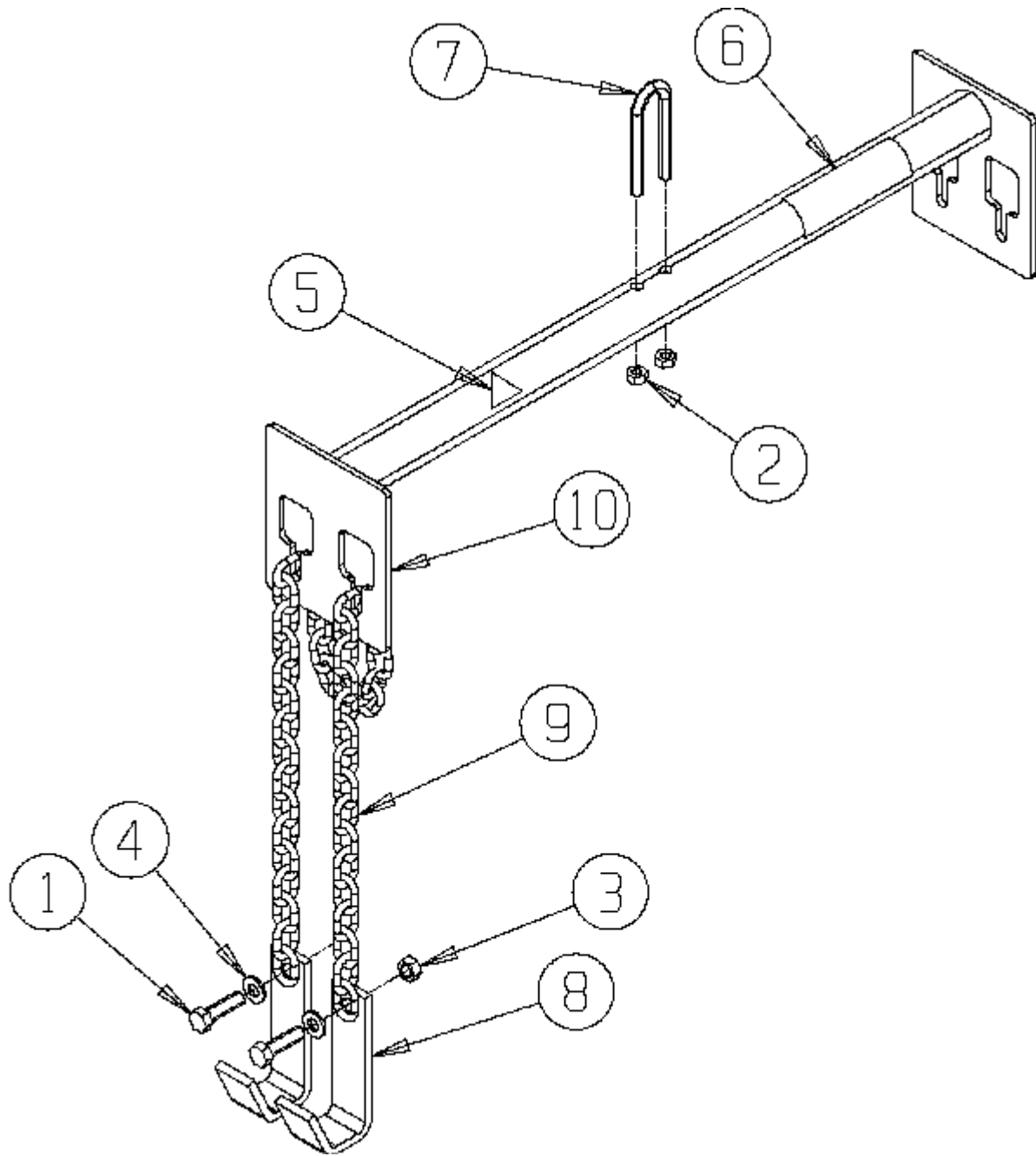

PARTS LIST

<u>DIAGRAM NUMBER</u>	<u>PART NUMBER</u>	<u>DESCRIPTION</u>
1.....	B372011.....	Socket Head Cap Screw 3/8-16 x 1-1/4 Long
2.....	J317100.....	5/16-18 Nylon Locknut Full
3.....	J377100.....	3/8-16 Nylon Locknut Full
4.....	3599028.....	Flat Washer .375 x 1.0 x .188 Thick
5.....	3708456.....	Load Capacity Warning Decal
6.....	3708856.....	Spreader Bar Decal
7.....	3709316.....	U-Bolt 5/16-18 x 3
8.....	6009102.....	Grab Hook
9.....	6329061.....	Chain 44.6"
10.....	6509590.....	Spreader Bar Weldment