

## OPERATION

Place the grinder at the left end of the bedknife with the Angle Guide Bracket flat against the bottom of the bedknife. **NOTE:** With the Angle Guide Bracket flat against the bottom of the bedknife you will get a  $5^\circ$  front face angle. (See Fig. 2)

The Reel Guide Bracket will push on the back side of the reel blade to move it out of the way.

With a smooth consistent stroke grind the bedknife from left to right. **NOTE:** You will grind from left to right on most reels which have normal helix reel blades. If you are grinding a reverse helix reel you will be grinding from right to left.

If you tilt the grinder into the reel you will reduce the front face angle. Figure 3 illustrates a  $0^\circ$  front face angle by tilting the grinder into the reel  $5^\circ$ .

If you tilt the grinder away from the reel you will increase the front face angle. Figure 4 illustrates a  $10^\circ$  front face angle by tilting the grinder away from the reel  $5^\circ$ .

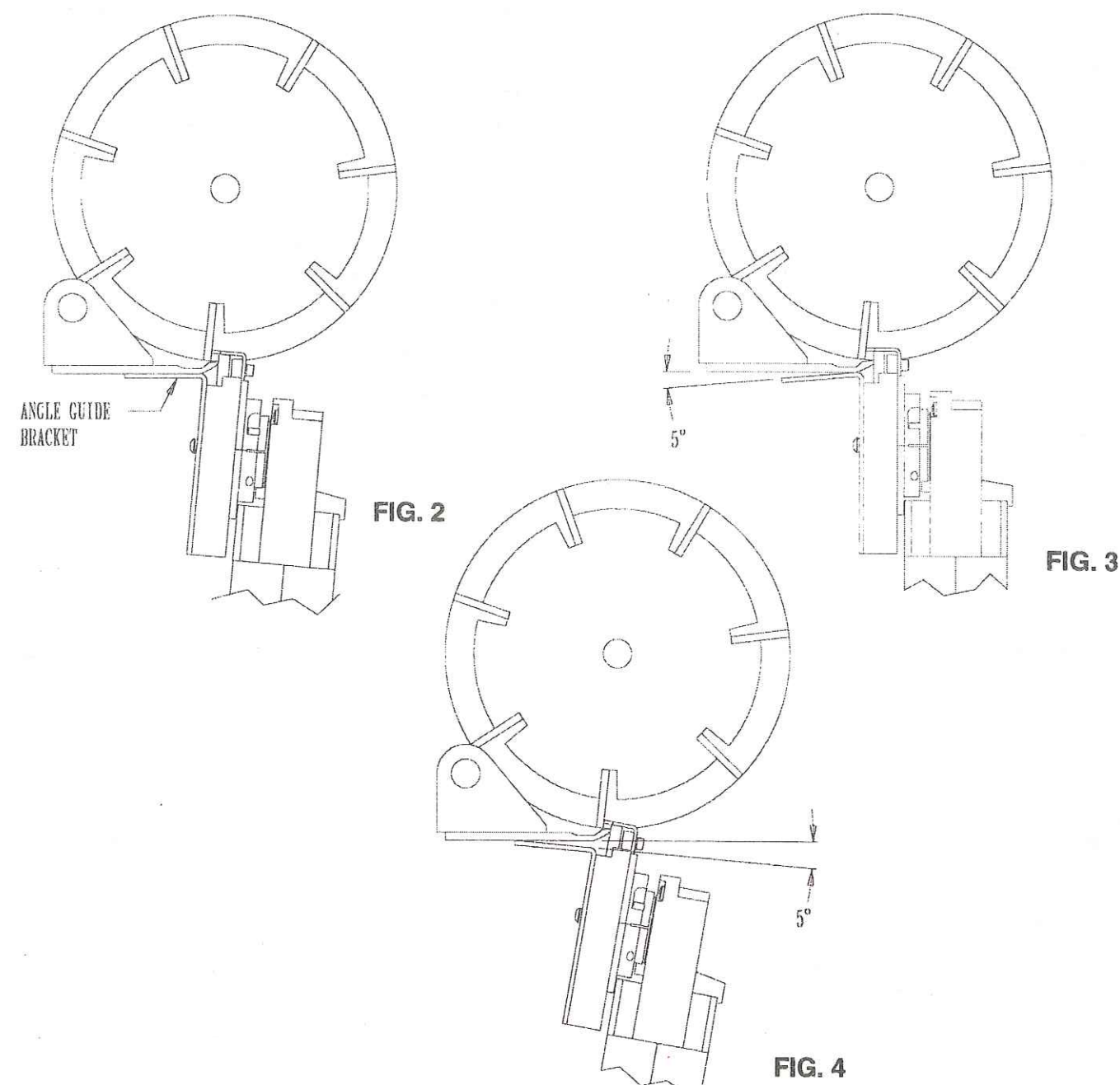

# 6200940 BEDKNIFE FACING TOOL

## OWNERS MANUAL



### WARNING

You must thoroughly read and understand this manual before operating the equipment, paying particular attention to the Warning & Safety instructions.



## SAFETY INSTRUCTIONS



Symbol that operators and people in close proximity must wear safety glasses.



Symbol that operators and people in close proximity must wear respirators or have adequate ventilation systems.



Symbol for sharp object which will cause serious injury

### ASSEMBLY

Remove the grinding wheel from your 4 1/2" angle grinder. (Black & Decker Model 2750 & 2750 G or Sears Craftsman Model 900.277230)

Remove grinding wheel guard from grinder.

Assemble the 620050-Facing Tool Base to your grinder. (See Fig. 1) **NOTE:** Make sure the counter bore in the base is seated against the face of the grinder head.

Position the Base at the proper angle you prefer to grind and clamp into place with the (2) #8-32 X 5/8" Socket Head Cap Screws.

Replace the grinding wheel flange, grinding wheel and grinding wheel nut. **NOTE:** Check clearances between grinding wheel and base. If wheel is rubbing against base, recheck that base is properly seated.

Assemble the Angle Guide Bracket and Reel Guide Bracket with hardware as shown. (See Fig. 1) The Angle Bracket is mounted with the bottom set of holes for most bedknives, but if the front face grinding surface is more that approximately 5/16" above the bottom of the bedknife you will need to mount the bracket in the top set of holes.

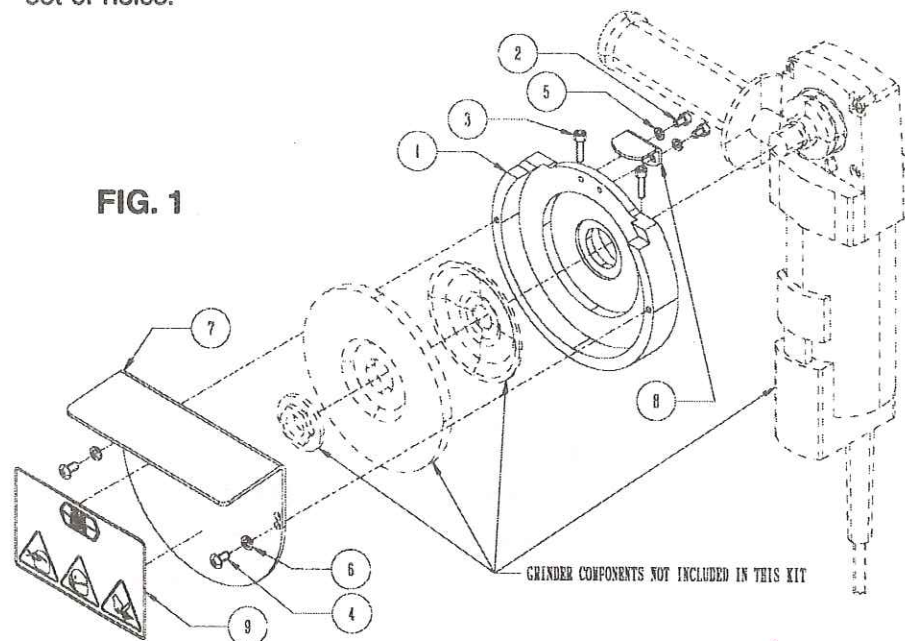

### PARTS LIST

1. 6209050-Facing Tool Base
- 2. B160411-#8-32 x 1/4" Socket Head Screws
3. B161011-#8-32 x 5/8" Socket Head Screws
4. B190613-#10-24 x 3/8" Button Cap Screws
5. K161501-#8 Lockwasher Split
6. K191501-#10 Lockwasher Split
7. 6209051-Angle Guide
8. 6209052-Reel Guide
9. 6209053-Facing Tool Decal

## SAFETY INSTRUCTIONS



**Safety Awareness Symbols** are inserted into this manual to alert you to possible **Safety Hazards**. Whenever you see these symbols, follow their instructions.



The **Warning Symbol** identifies special instructions or procedures which, if not correctly followed, could result in personal injury.

The **Caution Symbol** identifies instructions or procedures which, if not strictly observed, could result in damage to or destruction of equipment.

1. **KEEP GUARDS IN PLACE** and in working order.
2. **REMOVE WRENCHES AND OTHER TOOLS.**
3. **KEEP WORK AREA CLEAN.**
4. **DON'T USE IN DANGEROUS ENVIRONMENT.** Don't use facing tool in damp or wet locations, or expose it to rain.
5. **KEEP ALL VISITORS AWAY.** All visitors should keep a safe distance from work area.
6. **DON'T FORCE THE FACING TOOL.** It will do the job better and safer if used as specified in this manual.
7. **WEAR PROPER APPAREL.** Wear no loose clothing, gloves, neckties, or jewelry which may get caught in moving parts. Nonslip footwear is recommended. Wear protective hair covering to contain long hair.
8. **ALWAYS USE SAFETY GLASSES.**
9. **DISCONNECT POWER BEFORE SERVICING.**
10. **REDUCE THE RISK OF UNINTENTIONAL STARTING.** Make sure the switch is **OFF** before plugging in the facing tool.
11. **CHECK DAMAGED PARTS.** A guard or other part that is damaged or will not perform its intended function, should be properly repaired or replaced.
12. **KNOW YOUR EQUIPMENT.** Read this manual carefully. Learn its application and limitations as well as specified potential hazards.
13. **KEEP ALL SAFETY DECALS CLEAN AND LEGIBLE.** If safety decals become damaged or illegible for any reason, replace immediately. Refer to replacement parts illustrations in this manual for the proper location and part numbers of safety decals.
14. **DO NOT OPERATE THE FACING TOOL UNDER THE** influence of drugs, alcohol, or medication.



**This tool is intended for grinding the front face of Bedknives ONLY. Any use other than this may cause personal injury and void the warranty.**

**To assure the quality and safety of your tool and to maintain the warranty, you MUST use original equipment, manufacturers replacement parts and have any repair work done by a qualified professional.**

**ALL operators of this equipment must be thoroughly trained BEFORE operating this equipment.**

**Do not use compressed air to clean dust from the tool.**