

460 –PROCEDURE TO ALIGN BOTH HEADS EQUAL TO THE CENTER.

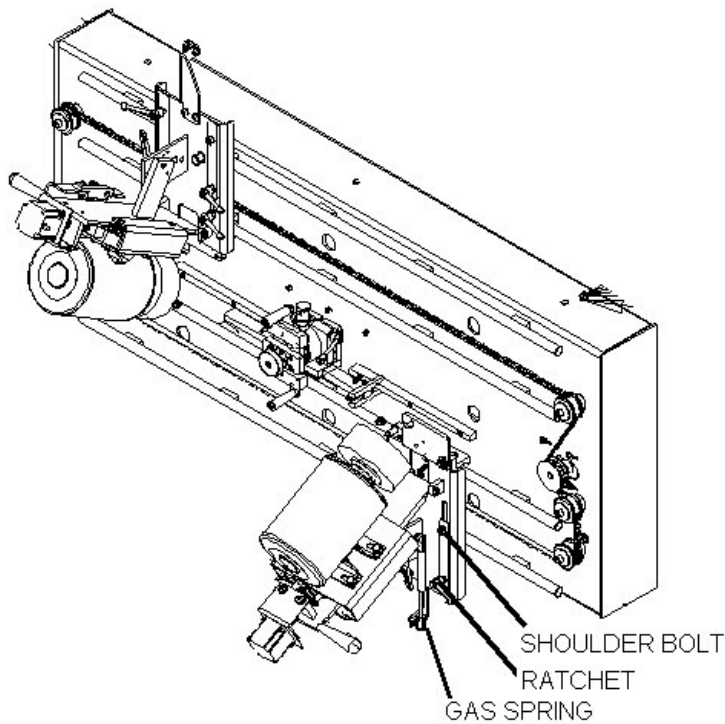

1. **REMOVE THE GAS SPRING:** Disconnect the gas springs on the bottom grinding heads. Use a screw driver and insert in the black metal clip on the plastic tip of the air spring. Pry this up gently, the air spring should come off the silver metal ball it is attached to.
2. **REMOVE THE SHOULDER BOLTS & ADJUSTABLE LOCK HANDLES:** Block up the motor so that it does not fall when you remove these fasteners. Remove the shoulder bolts and springs and set to the side. Remove the adjustable lock handles. **CAUTION:** The grinding heads are heavy and will be free after you remove the fasteners. Take care to use appropriate measures so they do not cause personal injury or damage to the machine. Note: The slide/cover plates will be free at this time as well, set them aside.

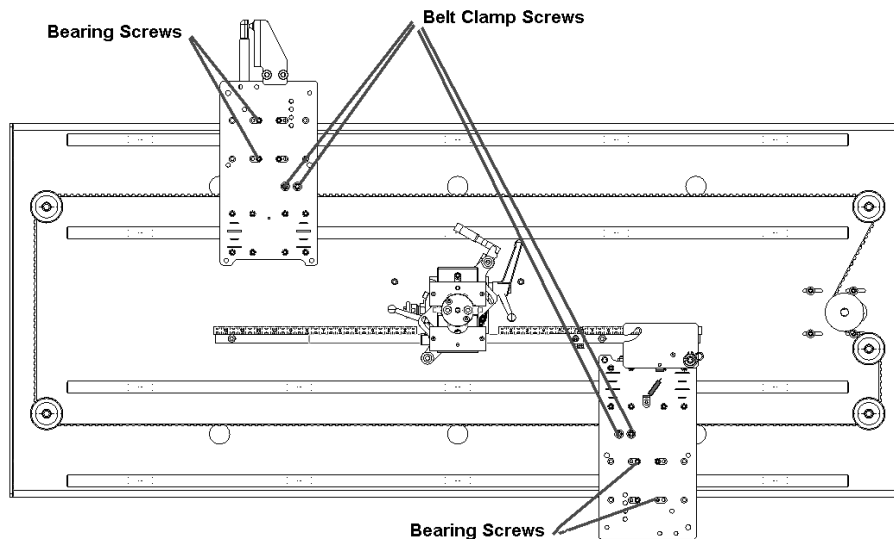

- 3.
4. **REMOVE THE BELT CLAMP SCREWS:** Remove the 5/16-18 socket head screws that hold the bottom belt clamp block in place. Slide the carriage to the side and make the adjustment to the belt clamp.
5. **REINSTALL THE BELT CLAMP:** Move the carriage over the belt clamp and bolt in position. Measure from the Carriage base to the center shaft to verify this is the same distance on the top as the bottom. If this is not the same distance then the blade will not be ground the same distance from the center. Make any adjustments if necessary.
6. **REINSTALL THE GRINDING HEAD:** Reinstall the Slide/Cover Plates, Grinding Heads, Adjustable Lock Handles, Springs and Shoulder bolts. There are two slides behind the motor plate and two on top on each grinding head. The shoulder bolt should fit inside the hole on the cover slide plate.
7. Attach the air springs. Retest all functions and make any adjustments necessary.

