

460 and 465 Balancer Pin Adjustment.

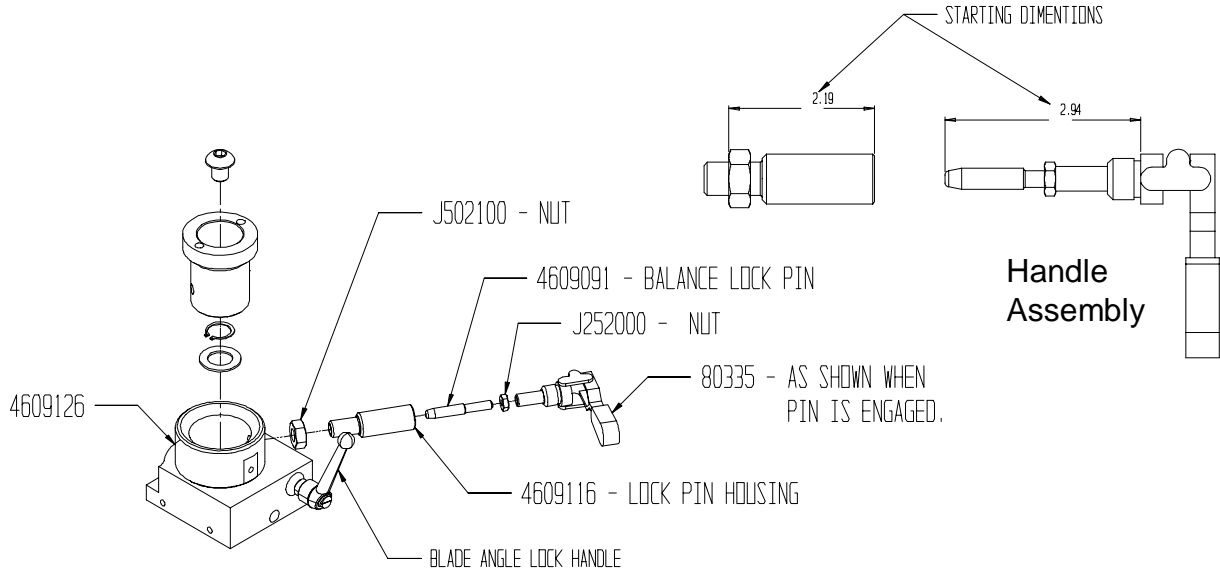

If there is movement in the center support assembly after the blade has been securely positioned in the clamps, check the following:

1. Verify that the Blade Angle Lock Handle is tight. If this is loose this could cause there to be some movement in the assembly.
2. Adjust the Balance Lock Pin. The Balance Lock Pin engages the center balancer assembly. The tapered pin should fully engage in the tapered slot. If there is play between these, the pin can be adjusted. To adjust the pin:
 - a) Remove the handle and Balance Lock Pin assembly from the Lock Pin Housing. Use a 3/4" wrench on the square base of the handle and rotate it counter-clockwise to remove. Try not to move the Lock Pin Housing.
 - If the Lock Pin Housing comes loose, remove housing with the Handle assembly. Use a clamp and separate the Handle assembly from the Lock Pin Housing.
 - b) To make the adjustment, loosen the jam Nut on the Balance Lock Pin. Then rotate the Balance Lock Pin 1/16th of a turn. Retighten the jam nut to lock in the new position. (*Reinstall the Lock Pin Housing if it was removed.*) Install the Handle assembly into the Lock Pin Housing and test. The correct setting should be so there is no free play but there should not take much force to rotate the balancer Handle into the Lock Position. If the adjustment is not correct remove the handle assembly and repeat the processes with the jam nut until the load on the pin is correct. This usually takes multiple attempts to correctly set the tension.

! BALANCE LOCK PIN MUST BE ADJUSTED TO CORRECTLY. TOO MUCH LOAD WILL CAUSE THE BEARINGS TO FAIL. NOT ENOUGH WILL ALLOW THE BLADE TO ROTATE.