

# **Salsco, INC.**

LEADER BY DESIGN

---

---

MODEL 380 SEEDER DETHATCHER  
04001 - 380 with 10 Blades

OWNER'S MANUAL  
PARTS MANUAL  
SERVICE MANUAL

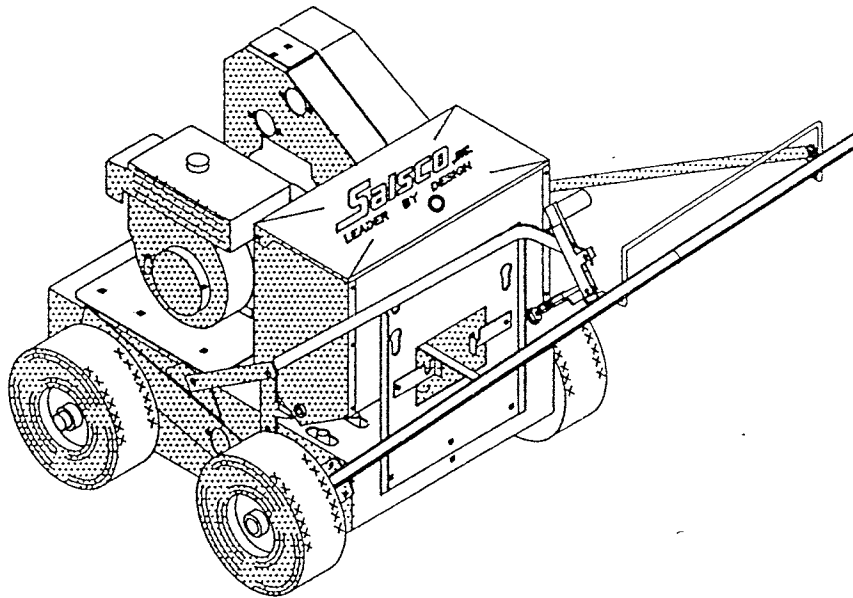

SALSCO, INC.  
TURF EQUIPMENT DIVISION  
105 SCHOOL HOUSE ROAD  
CHESHIRE, CONN. 06410 USA

---

---

\* NOTE: PLEASE READ "CAUTIONS" IN THIS MANUAL

STATEMENT OF FACT

YOU HAVE JUST PURCHASED THE HIGHEST QUALITY, MOST EFFECTIVE SEEDER DETHATCHER ON THE MARKET TODAY. THIS UNIT HAS THE ABILITY TO MEET EXACT SEEDING STANDARDS AND PERFORM FOR YEARS WITH MINIMUM DOWN TIME. HOWEVER, IT CANNOT READ NOR WILL IT UNDERSTAND THIS MANUAL NO MATTER HOW LONG YOU LEAVE IT ON TOP OF THE MACHINE. IT IS YOUR RESPONSIBILITY TO READ AND UNDERSTAND IT. IT IS ALSO YOUR RESPONSIBILITY TO BE CERTAIN THIS INFORMATION IS PASSED ALONG TO ANYONE WHO IS EXPECTED TO OPERATE THIS EQUIPMENT. SHOULD YOU CHOOSE NOT TO READ AND UNDERSTAND AND PASS ALONG THE INFORMATION PROVIDED YOU, PLEASE EXPECT EQUIPMENT FAILURE AND POSSIBLE INJURIES TO PERSONS AROUND THIS EQUIPMENT.

FOR THE SAFETY OF THE OPERATOR IT IS IMPERATIVE THAT THIS MANUAL IS CAREFULLY READ AND UNDERSTOOD.

HAVING READ THIS MANUAL, IT IS YOUR RESPONSIBILITY TO BE SURE THAT ALL NEW OPERATORS READ AND UNDERSTAND THIS MANUAL ESPECIALLY THE CAUTIONS ON PAGE FIVE

020189

DESCRIPTION

**SEEDER DETHATCHER 380**

This unit has some features which are very exciting and we believe will be setting the standard for years to come. The 380 has 4-wheel posi-track, while maintaining the ability to turn at the end of your pass. This is accomplished through individual rear wheel clutches developed by Salsco. It has an up milling cutter shaft which is a must when being used as a Dethatcher. The quick disconnect hopper allows the customer to change seed blends as many times a day as he feels is necessary. The operator's comfort is controlled through ease of operation. He simply pulls the handles back and this engages drive, cutters, and seed. As soon as his hands leave the machine, everything shuts down, making it not only easy to use, but safe. From a maintenance stand point we've removed all belt adjustments.

020189

MANUFACTURED BY: SALSCO, INC.  
 TURF EQUIPMENT DIVISION  
 105 SCHOOL HOUSE ROAD  
 CHESHIRE, CONNECTICUT 06410  
 203/271-1682  
 FAX (203) 271-2596

SEEDER DETHATCHER OWNER'S MANUAL

THIS MANUAL COVERS MODEL: 380 SEEDER DETHATCHER

This company reserves the right to discontinue, add improvements to, or change the design of any model or product at any time without obligation to improve existing machines, either by changing the design or adding new parts.

It has been and will continue to be the policy of SALSCO to update existing machines at its own discretion. Whenever possible, new designs will be made in such a way, that they can be "Retro Fit" if so desired.

Record in space provided below the model and serial numbers of this unit. Please retain these numbers for future reference.

No parts orders will be accepted without Model numbers or parts numbers.

<u>Model Number</u>		<u>Serial Number</u>
<u>Model No.</u>	<u>Prefix</u>	<u>Part Number Code:</u>
380	= 380	<u>Model Part Number*</u>
		000 A 000

\* PART NUMBER PREFIX MUST BE USED WHEN ORDERING PARTS (\_\_\_A000).  
 PREFIX NUMBER IS LISTED ABOVE.

\*\*\*\* CAUTION \*\*\*\*

READ AND UNDERSTAND THIS MANUAL BEFORE STARTING MACHINE!!

SERVICE SCHEDULE

<u>ITEM</u>	<u>FREQUENCY</u>
CHECK ENGINE OIL	DAILY
CHECK NUTS AND BOLTS FOR TIGHTENING	DAILY
CHECK SPROCKETS FOR ALIGNMENT & TIGHTNESS	DAILY
WASH MACHINE (as needed)	WEEKLY
CHECK ENGINE AIR CLEANER	DAILY
CHECK ENGINE MANUAL FOR ROUTINE MAINTENANCE	

THINK

SAFETY

CAUTION

BEFORE YOU START THIS MACHINE:

1. READ AND UNDERSTAND OWNERS MANUAL.
2. DO NOT RUN WITHOUT GUARDS AND OTHER SAFETY COVERS ON MACHINE.
3. NEVER LEAVE MACHINE RUNNING WHILE UNATTENDED.
4. NEVER REACH UNDER OR INTO MACHINE FOR ANY REASON WHILE MACHINE IS RUNNING AS IT CAN CAUSE SERIOUS INJURY.
5. BEFORE REMOVING SEED BOX ALWAYS SHUT MOTOR OFF.
6. DO NOT LET ANYONE WALK NEXT TO OR IN FRONT OF MACHINE WHILE IN OPERATION.
7. NEVER RUN OVER ASPHALT, CONCRETE OR ANY OTHER MATERIAL WHICH CANNOT BE CUT WITH THE BLADES IN THE LOWERED POSITION.
8. ALWAYS REMOVE SPARK PLUG WIRE, MAKE SURE ENGINE SWITCH IS OFF, THROTTLE IS IN STOP POSITION, AND SHUT GAS OFF WHEN WORKING ON OR CHECKING INSIDE OF MACHINE.
9. NEVER DO ANYTHING WITH BELTS, SUCH AS REMOVING OR REPLACING THEM, ETC., WHILE ENGINE IS RUNNING.
10. DO NOT REMOVE CAUTION DECALS.
11. SAFETY DECALS SHOULD BE REPLACED IMMEDIATELY AFTER REPAINTING OR WHEN THEY BECOME ILLEGIBLE.  
\*\* SEE NOTE BELOW \*\*
12. THIS UNIT HAS NO PARKING BRAKE AND MUST NOT BE LEFT ON HILLS OR INCLINES UNATTENDED.

**\*\* NOTE \*\***

SAFETY IS A PRIME CONCERN AT SALSICO AND THE SAFETY DECALS ON YOUR MACHINE ARE A HIGHLY VISIBLE AND CONSTANT REMINDER TO ALL OPERATORS. REPLACEMENT SAFETY DECALS MAY BE OBTAINED FROM YOUR LOCAL DEALER OR BY CALLING TOLL FREE 1-800-BSALSICO.

DO NOT RUN MACHINE WITHOUT GUARDS IN PLACE

## OPERATING INSTRUCTIONS

PRIOR TO STARTING THE MACHINE, BE SURE YOU READ THE CAUTIONS ON PAGE 5 OF THIS MANUAL AND ALSO READ THE ENTIRE MANUAL, SO THAT YOU FAMILIARIZE YOURSELF WITH THIS PRODUCT. CHECK THE ENGINE OIL, GASOLINE AND THE ENGINE MANUFACTURERS SPECIFICATIONS. AFTER HAVING DONE THIS IT IS RECOMMENDED THAT YOU RUN THE MACHINE FOR AT LEAST TWO OR THREE HOURS, SO THAT YOU FAMILIARIZE YOURSELF WITH THE SAFE OPERATION OF THIS PIECE OF EQUIPMENT.

### TO SET THE PROPER CUTTER DEPTH: (WITH MOTOR OFF)

NOTE CORRECT SEEDING DEPTH OF THIS MACHINE SHOULD BE NO MORE THAN 1/4" BELOW THE SURFACE OF THE SOIL, AFTER CUTTING THROUGH THE THATCH LAYER.

- 1) PLACE THE MACHINE ON A FLAT, HARD SURFACE.
- 2) PULL HANDLE, ITEM # 68, BACK TOWARD THE HANDLE BAR, SLOWLY, WATCHING ITEM # 160.
- 3) IF THE CUTTERS ARE SET RIGHT, ITEM # 160 WILL ENGAGE AND YOU WILL SEE THE SPRING BEGIN TO MOVE, WHICH IT SHOULD. HOWEVER, IF SET TOO DEEP IT WILL BIND UP. IF THIS IS THE CASE, BACK OFF ON ITEM # 70 TO LENGTHEN THE CONTROL ROD #66.
- 4) IF YOU PULL ITEM # 68 ALL THE WAY TO THE HANDLES, WITHOUT THE SPRING BINDING UP TO ITEM # 160, AT THIS TIME YOU WOULD JUST BE TOUCHING THE SURFACE. THIS IS A GOOD STARTING POINT AT WHICH TO SET THE DEPTH.

### TO SET SEED ADJUSTMENT: (WITH MOTOR OFF)

- 1) SQUEEZE HANDLE, ITEM # 68, WHICH WILL LOWER THE CUTTERS AND ACTIVATE THE SEED BOX.
- 2) PUSH THE MACHINE FORWARD.

NOTE IT IS RECOMMENDED THAT YOU BEIGIN ON A SETTING #5, AND THEN OPEN AND CLOSE, DEPENDING ON HOW MUCH SEED DESIRED PER INCH.

TO CHANGE THE CUTTER BLADES: (WITH THE MOTOR OFF)

- 1) BACK OFF ADJUSTING NUT ITEM # 70, TO THE DEEPEST SETTING POSSIBLE.
- 2) TIE HANDLE, ITEM # 68, BACK AGAINST THE HANDLE BAR, ITEM # 74, WITH A STRING.

NOTE CAUTION SHOULD BE TAKEN IN CHOOSING A STRING TO TIE THE HANDLE. KEEP IN MIND THE CUTTERS ARE SPRING LOADED UP AND SHOULD YOUR STRING BREAK, THE CUTTER WILL GO TO RAISED POSITION. KEEP YOUR HANDS CLEAR AS THIS COULD CAUSE POSSIBLE INJURIES.

- 3) TIP THE MACHINE BACK ON THE HANDLE BARS AND REMOVE BOLT # 36, AND SPREAD BAR, ITEM # 133, OPPOSITE THE PULLEY SIDE.
- 4) THE CUTTERS WILL SLIDE OFF THE 1" SQUARE SHAFT ITEM # 147.

TO ADJUST THE TRANSPORT DRIVE CHAIN: (ITEMS # 21 & 22) WITH MOTOR OFF

- 1) LOOSEN UP BOLT, ITEM # 11.
- 2) TIGHTEN UP THE IDLER SPROCKET, ITEM # 19.

IF FOR SOME REASON YOU'RE AT MAXIMUM ADJUSTMENT, YOU NEED TO MOVE THE IDLER SPROCKET UNTIL THE CHAIN BECOMES LOOSE, THEN REMOVE A HALF LINK FROM THE CHAIN.

TO SHUT THE HOPPER DOOR: (ITEM # 112) WITH MOTOR OFF

TO BE SURE ITEM # 112 IS CLOSING ALL THE WAY AGAINST THE HOPPER THERE IS A SLIGHT ADJUSTMENT ON ITEM #131.

- 1) LOOSEN UP CAP SCREWS, ITEM # 54, AND SLIDE ITEM # 132, UNTIL IT PUSHES AGAINST THE DOOR.

TO REMOVE THE HOPPER: WITH MOTOR OFF

- 1) SET THE SEED ADJUSTMENT LEVER, ITEM # 111, TO ZERO, SO THAT THE HOPPER IS CLOSED AND THE SEED WON'T DUMP.
- 2) SLIDE CLIPS ITEMS # 90 & # 91, OPEN.
- 3) TAKE THE HOPPER OFF THE MACHINE.

TO PUT THE HOPPER BACK:

- 1) SET THE HOPPER ON TOP OF THE SLOTS THAT ARE IN BRACKETS, ITEM # 92 & # 93.
- 2) REACH ON THE SIDE OF THE HOPPER AND CLOSE THE DOOR, ITEM # 112, MANUALLY SO THAT IT FITS BEHIND ADJUSTING ARM, ITEM # 132, AND THE HOPPER WILL DROP INTO PLACE.
- 3) CLOSE CLIPS, ITEMS # 90 & 91.

THIS MACHINE HAS NO PARKING BRAKE. DO NOT LEAVE ON HILLS OR INCLINES UNATTENDED.

ITEM	NO	NAME	QTY	ITEM	NO	NAME	QTY
1	A-159	LOCK NUT	16	14	U-094	8 H.P. MOTOR	1
2	A-136	CARRIAGE BOLT	6	15	V-164	FOOT GUARD	1
3	A-144	HEX SCREW	4	16	J-099	MOTOR PLATE	1
4	B-158	LOCK NUT	4	17	K-099	RIGHT PLATE	1
5	B-136	CARRIAGE BOLT	10	18	A-049	LEFT PLATE	1
6	D-158	LOCK NUT	2	19	F-074	IDLER SPROCKET	2
7	A-132	HEX SCREW	6	20	D-054	JACK SHAFT	1
8	B-146	LOCK WASHER	6	21	A-058	CHAIN	1
9	H-230	SQ KEY	1	22	H-168	MASTER LINK	1
10	I-135	FLAT WASHER	8	23	N-070	CHAIN GUARD	1
11	A-152	HEX SCREW	2	24	D-065	V BELT	1
12	A-109	BEARING	1	25	B-046	PULLEY	1
13	A-110	FLANGETTE	2	26		SPROCKET	1

Jack Shaft Assembly

- 1" Pillow Block Bearings - 03003 - 2
- 40B15x1" Sprocket - H046 - 2
- #40 Chain - A057 -
- Jackshaft, 1" - 0248069 -

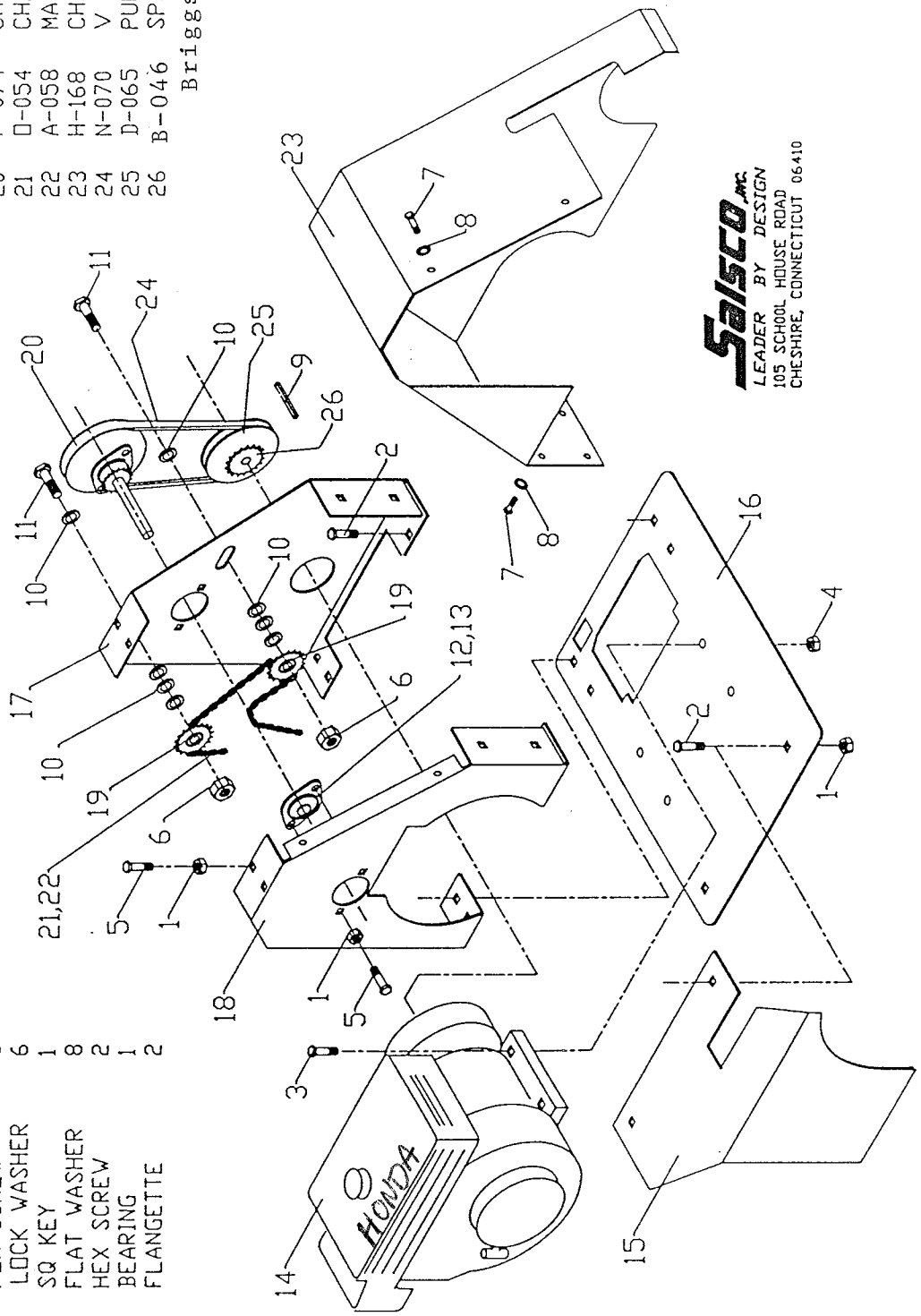

Briggs & Stratton

**Salsco**  
 LEADER BY DESIGN  
 105 SCHOOL HOUSE ROAD  
 CHESHIRE, CONNECTICUT 06410

ITEM	NO	NAME	QTY
30	A-159	LOCK NUT	18
31	B-158	LOCK NUT	11
32	H-158	STOYER NUT	2
33	B-141	HEX SCREW	4
34	A-133	HEX SCREW	1
35	B-143	HEX SCREW	2
36	B-136	CARRIAGE BOLT	16
37	M-148	HEX SCREW	1
38	L-148	HEX SCREW	1
39	L-229	SO KEY	2
41	P-054	CHAIN 50 1/2 LINKS	1
42	A-147	FLAT WASHER	2
43	A-146	LOCK WASHER	4
44	E-158	LOCK NUT	4
45	C-135	WASHER	6
46	D-054	CHAIN 28 LINKS	1
47	F-125	THIN WASHER	1
48	G-158	LOCK NUT	4
49	I-158	STOYER NUT	2
50	C-146	LOCK WASHER	2
51	B-147	FLAT WASHER	12
52	A-158	LOCK NUT	6
53	A-149	HEX SCREW	3
54	C-138	HEX SCREW	2
55	B-145	HEX SCREW	2
56	A-144	HEX SCREW	1
57	A-143	HEX SCREW	1
60	A-080	COLLAR	6
61	A-080	FRONT WHEEL	2
62	A-058	MASTER LINK	1
63	V-076	FRONT SHAFT	1
64	A-109	BEARING	1
65	A-110	FLANGETTE	2
66	B-231	CUTTER RAISE LINK	2
67	B-173	CAP	4
68	H-167	HANDLE PIN	4
69	K-009	LOCK KNOB	2
70	D-231	THREADED ADJUSTER	1
71	E-231	CONNECTING LINK	1
72	G-103	CUTTER RAISE HANDLE	1
73	H-103	CLUTCH HANDLE	1
74	E-227	HANDLE BARS	1
75	F-231	SPRING LINK	1
76	M-013	SPRING	1
77	C-231	CLUTCH LINK	1
78	A-114	BEARING	1
79	A-113	CAH BEARING	2
80	E-065	SPRCKET & PULLEY	1
81	A-015	SPRING	1
82	P-208	CLUTCH LEVER	1
83	H-099	RIGHT PIVOT PLATE	1
84	P-070	V BELT	1
85	A-064	IDLER PULLEY	2
86	D-221	SPACER	1
87	D-013	SPRING	1
88	Q-208	IDLER LEVER	1
89	A-231	RAISE LINK	1
130	N-500	MAIN HOUSING	2
131	C-228	SHUT OFF BRACKET	1
132	Q-099	ADJUSTMENT PLATE	1
133	L-099	LEFT PIVOT PLATE	1
134	E-150	SPECIAL SCREW LEFT	1
135	F-150	SPECIAL SCREW RIGHT	1
136	H-085	REAR WHEEL	1
137	K-013	YELLOW CLUTCH SPRING	2
138	L-013	RIGHT CLUTCH SPRING	1
139	Y-076	REAR SHAFT	1
160	A-014	SPRING	1
161	G-135	FENDER WASHER	1
162	A-057	HALF LINK	1
164	I-166	SPACER	1

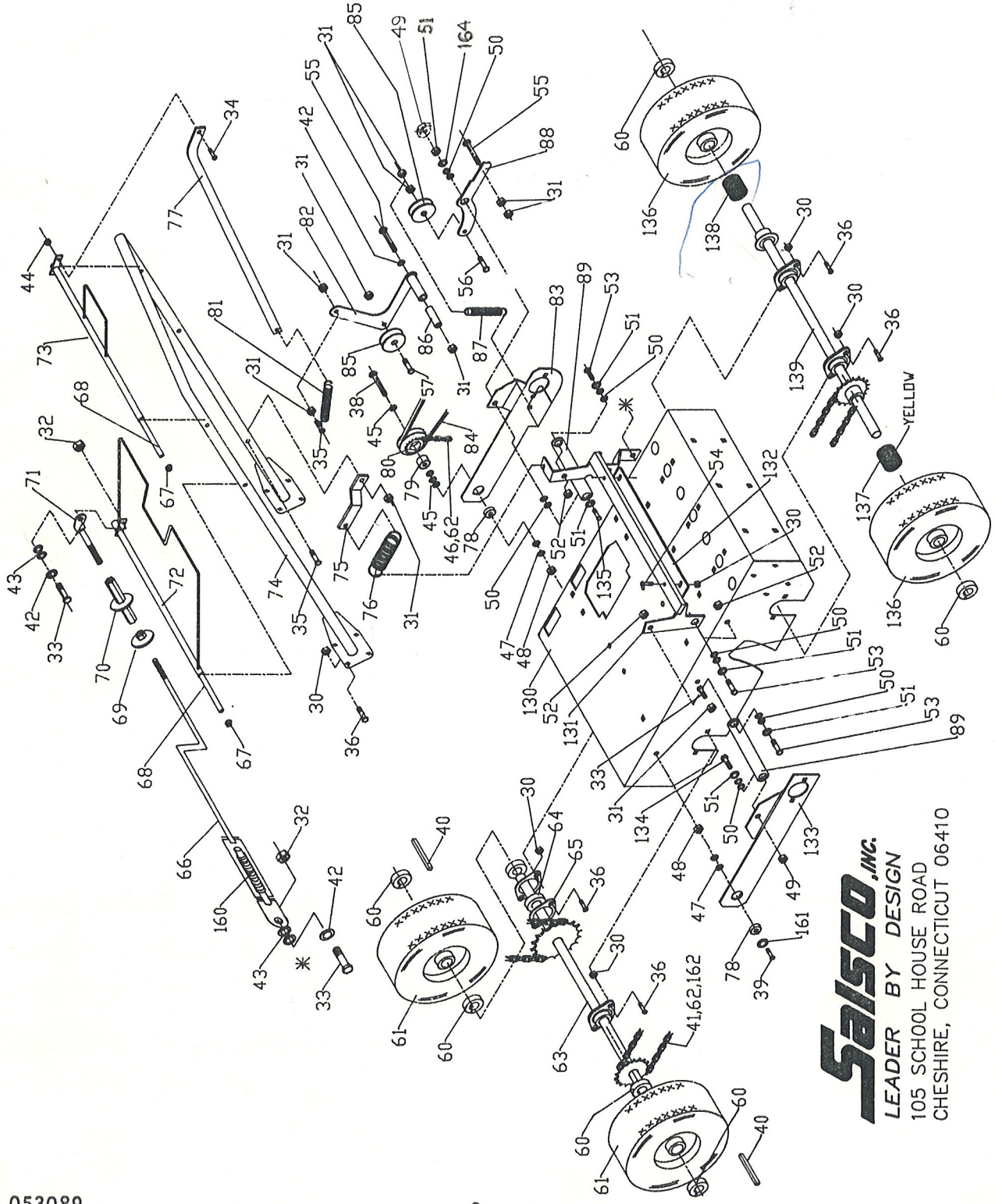

\*NOTE-Item 79-A113 Bearing is included with Item 80-E065 Pulley and Sprocket Assembly and is locktited in place

**Saisco, Inc.**  
**LEADER BY DESIGN**  
 105 SCHOOL HOUSE ROAD  
 CHESHIRE, CONNECTICUT 06410

**Saisco, Inc.**  
 LEADER BY DESIGN  
 105 SCHOOL HOUSE ROAD  
 CHESHIRE, CONNECTICUT 06410

380 SUPPORT BAR UP DATE KIT

- TO INSTALL FRAME SUPPORT PLATE ITEM 2
- 1 REMOVE FOOT GUARD ITEM 15 IN MANUAL
  - 2 REMOVE ALL SCREWS AND WASHERS MARKED WITH \*  
 INSTALL NEW SUPPORT PLATE ON THE INSIDE OF THE  
 HOUSING, IT WILL LINE UP WITH THE BOLTS THAT WERE  
 REMOVED, REPLACE ITEM 3 1/2-13 X 1 1/4 WITH  
 NEW BOLT 1/2-13 X 1 1/2 AND INSTALL ALL OTHER  
 BOLTS AND WASHERS THAT WERE REMOVED

ITEM NO.	NAME	QTY
1	WHEEL SUPPORT BAR ASSY	1
2	FRAME SUPPORT PLATE	1
3	HEX BOLT 1/2-13 X 1 1/2	1

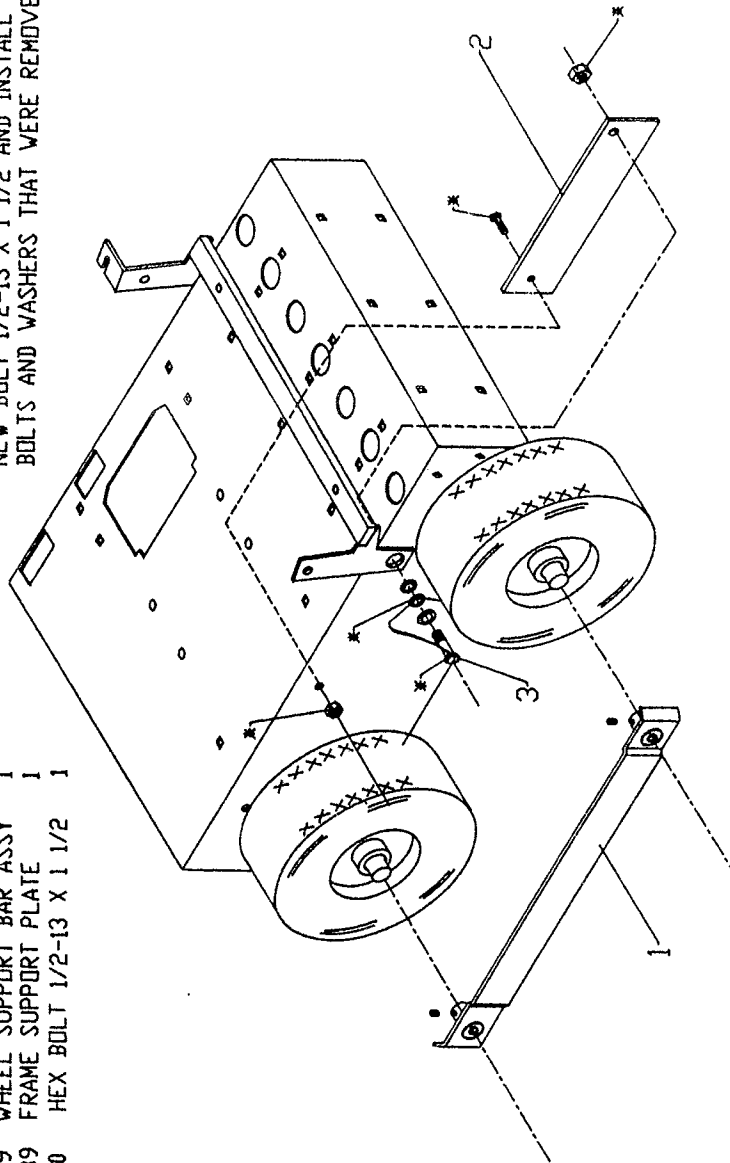

TO INSTALL WHEEL SUPPORT BAR ITEM 1

- 1 REMOVE TWO SET SCREW COLLARS ITEM 60 IN MANUAL ON WHEEL SHAFTS  
 NOTE: BE SURE THAT REAR WHEEL DOES NOT MOVE OUT  
 ON SHAFT, THIS COULD DISENGAGE YOUR 4 WHEEL DRIVE
- 2 SLIDE ITEM 1 WHEEL SUPPORT BAR ASSY ONTO WHEEL SHAFTS UNTIL  
 THEY BOTTOM OUT, TIGHTEN FOUR SET SCREWS TO LOCK HUBS TO  
 WHEEL SHAFTS

ITEM	NO	NAME	QTY	ITEM	NO	NAME	QTY
30	A-159	LOCK NUT	4	148	K-221	SPACER	1
36	B-136	CARRIAGE BOLT	4	149	H-146	WASHER	1
64	A-109	BEARING	2	150	B-229	SQ KEY	1
65	A-110	FLANGETTE	4	151	H-166	WASHER	1
140	A-141	HEX SCREW	2	152	R-221	SPACER	1
141	A-146	LOCK WASHER	2	153	P-066	PULLEY	1
142	C-135	FLAT WASHER	2	154	P-070	V BELT	1
143	A-147	FLAT WASHER	2	155	OPTIONAL BLADE	SEE CHART	
144	A-089	FLAT WASHER	1				
145	G-166	WASHER	1				
146	A-205	CUTTER BLADE	10				
147	X-076	CUTTER SHAFT	1				

**Saisco, Inc.**  
**LEADER BY DESIGN**  
 105 SCHOOL HOUSE ROAD  
 CHESHIRE, CONNECTICUT 06410

OPTIONAL BLADES

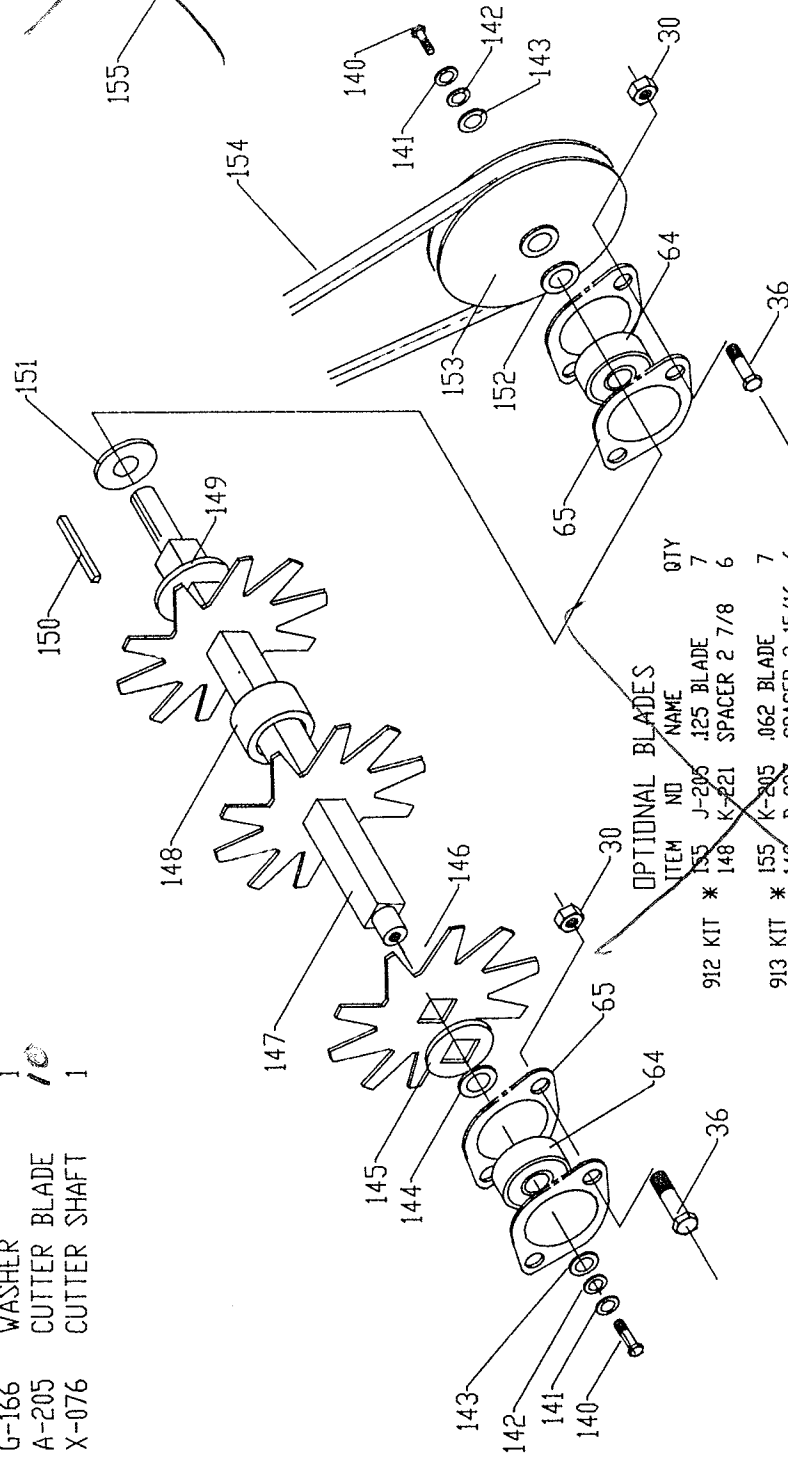
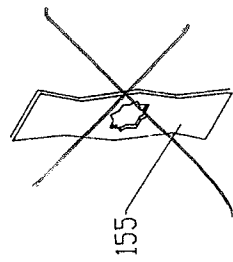

ITEM	NO	NAME	QTY
912 KIT *	155	J-205 .125 BLADE	7
913 KIT *	148	K-221 SPACER 2 7/8	6
914 KIT *	155	K-205 .062 BLADE	7
	148	B-237 SPACER 2 15/16	6
	155	N-205 .031 BLADE	7
	148	C-237 SPACER 3'	6

ITEM	NO	NAME	QTY	ITEM	NO	NAME	QTY	ITEM	NO	NAME	QTY	ITEM	NO	NAME	QTY
90	K-505	LOCK PLATE	2	110	D-209	METER PLATE	1	114	B-136	CARRIAGE BOLT	22	119	E-158	LOCK NUT	40
91	L-505	LOCK PLATE	2	111	D-208	METER LEVER	1	115	A-159	LOCK NUT	22	120	A-141	HEX SCREW	6
92	J-505	HOPPER MT'G PLATE	1	112	B-226	SHUT OFF BK'T	1	116	K-135	WAVE WASHER	8	121	A-146	LOCK WASHER	17
93	I-505	HOPPER MT'G PLATE	1	113	Y094	FOAM STRIP	1	117	J-133	HEX SCREW	32	122	B-158	LOCK NUT	6
94	Q-223	TUBE EXTENDERS	7					118	A-135	FLAT WASHER	4	123	A-140	HEX SCREW	1
95	B-104	TUBE BRACKET	1					119	E-158	LOCK NUT	4	124	A-147	FLAT WASHER	6
96	B-104	KNOB	1					120	A-141	HEX SCREW	6	125	D-132	HEX SCREW	1
97	A-505	HOPPER COVER	1					121	A-146	LOCK WASHER	6	126	A-133	HEX SCREW	2
98	B-505	HOPPER PLATE	1					122	B-158	LOCK NUT	17	127	C-081	COLLAR	3
99	B-505	HOPPER PLATE	1					123	A-140	HEX SCREW	6	128	A-134	HEX SCREW	2
100	C-505	HOPPER PLATE	1					124	A-147	FLAT WASHER	6	129	G-014	SPRING	2
101	A-207	WINDOW	1					163	Z-094	FOAM STRIP	4				
102	H-084	WHEEL	1												
103	C-121	FLANGED BUSHING	1												
104	V-076	ADJ. SHAFT	2												
105	I-081	COLLAR ASSY	1												
106	E-505	SPACER PLATE	1												
107	A-505	SLIDE METER PLATE	1												
108	G-505	SLIDE PIVOT PLATE	1												
109	G-505	SLIDE RET'G PLATE	1												

26030  
41616  
41615  
41613

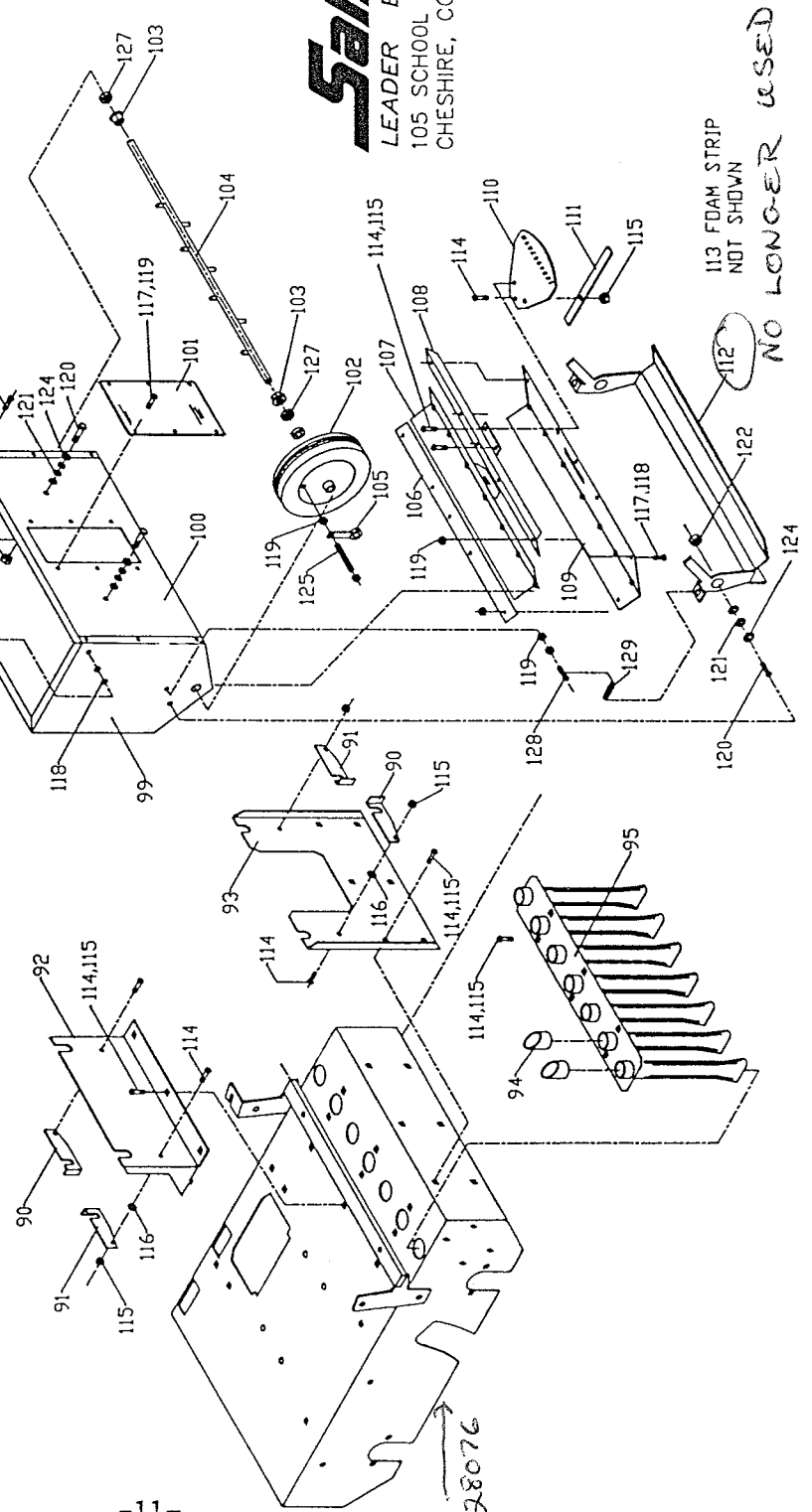

**Saisco, Inc.**  
LEADER BY DESIGN  
105 SCHOOL HOUSE ROAD  
CHESHIRE, CONNECTICUT 06410

# Suggested Tightening Torques For Alloy 1960 Inch Series Socket Head Cap Screws

NOMINAL SIZE	BASIC SCREW DIAMETER INCHES	TORQUE TO TIGHTEN SCREWS TO YIELD (in-lb)		TIGHTENING TORQUE* (in-lb)	
		UNRC	UNRF	UNRC	UNRF
0	0.0600	—	3.5	—	2.6
1	0.0730	6	6.5	4.5	4.8
2	0.0860	10	11	7.5	8
3	0.0990	15	16	11	12
4	0.1120	22	24	16	18
5	0.1250	32	33	24	24
6	0.1380	40	45	30	34
8	0.1640	74	78	55	58
10	0.1900	105	120	79	90
		(ft-lb)		(ft-lb)	
1/4	0.2500	22	25	17	19
5/16	0.3125	46	51	35	38
3/8	0.3750	83	93	62	70
7/16	0.4375	132	146	100	109
1/2	0.5000	203	230	150	172
5/8	0.6250	380	430	283	317
3/4	0.7500	667	750	500	562
7/8	0.8750	917	1020	688	767
1	1.0000	1390	1520	1040	1080
1-1/4	1.2500	2780	3080	2080	2310
1-1/2	1.5000	4850	5450	3625	4080

Nominal Sizes	Tensile Strength P.S.I. Min.	Yield Strength P.S.I. Min.	Elongation* In 2 Inches Per Cent Min.	Reduction of Area* Per Cent Min.	Minimum Hardness Rockwell C
0 to 1/2	180,000	162,000	12	35	39
Over 1/2	170,000	153,000	14	40	38

\* Listed tightening torques are 75 percent of the torque to yield based on ASTM574. Specification listing tensile strength of 180,000 PSI for screw size 0.500 and smaller and 170,000 PSI for screw size 0.625 and larger. Values based on plated and non-lubricated fasteners.

Tightening torques are only recommended for proper applications. Refer to your engineering stats.

# Suggested Tightening Torques For Other Alloy Socket Screw Products (INCH-POUND)

Nom. size	Basic Screw Diameter	Button Head Flat Head Hex Key Size	Flat Head		Button Head		Nominal Size	Hex Key Size	Shoulder Screw	Low Head
			Tightening Torque	Tightening Torque	Tightening Torque	Tightening Torque				
0	.060	.035	—	1.5	—	1.5	—	—	—	
1	.073	.050	2.5	2.5	2.5	2.5	—	—	—	
2	.086	.050	4.5	4.5	4.5	4.5	—	—	—	
3	.099	1/16	7	7	7	7	—	—	—	
4	.112	1/16	8	8	8	9	4	.050	5.0	
5	.125	5/64	12	13	12	12	5	.062	9.5	
6	.138	5/64	15	17	16	16	6	.062	9.5	
8	.164	3/32	30	31	30	30	8	5/64	19.4	
10	.190	1/8	40	45	40	45	10	3/32	33.5	
1/4	.250	5/32	100	110	100	110	1/4	1/8	50	77.9
5/16	.312	3/16	200	220	200	220	5/16	5/32	125	156.0
3/8	.375	7/32	350	400	350	400	3/8	3/16	265	273.0
7/16	.437	1/4	560	625	—	—	7/16	7/32	—	428.0
1/2	.500	5/16	850	1,000	850	1,000	1/2	1/4	470	615.0
9/16	.562	5/16	1,200	1,360	—	—	—	—	—	—
5/8	.625	3/8	1,700	1,900	1,700	1,800	5/8	5/16	1,150	1,315.0
3/4	.750	1/2	3,000	3,200	—	—	3/4	3/8	2,000	—
7/8	.875	9/16	5,000	5,400	—	—	—	—	—	—
1	1.000	5/8	8,000	7,600	—	—	1	1/2	4,000	—

\* Listed tightening torques are 75 percent of the torque to yield based on ASTM574. Specification listing tensile strength of 180,000 PSI for screw size 0.500 and smaller and 170,000 PSI for screw size 0.625 and larger. Values based on plated and non-lubricated fasteners.

Tightening torques are only recommended for proper applications. Refer to your engineering stats.

## WARRANTY

Your Salsco Commercial or Turf Equipment product is a commercial type product and is normally manufactured and sold for commercial or industrial use. Salsco will, for the original purchaser, for one (1) year from the date of purchase (90 days if used for rental purposes; RENTAL IN THIS CASE MEANS MACHINE DOING PROPERTIES NOT OWNED BY ORIGINAL PURCHASER) repair or replace, free of charge, any part or parts found to be defective in material or workmanship or both. Any transportation charges to be borne by the purchaser.

If, during the Warranty Period, the product does not function properly due to defect, simply contact your Salsco Dealer and provide the unit or part for inspection or contact directly:

SALSCO, INC.  
Service Department  
105 School House Road  
Cheshire, CT 06410

203/271-1682  
FAX: 203/271-2596

This warranty does not include incidental or consequential damages and is exclusive of any implied warranties.

This warranty does not include normal maintenance parts, including, but not limited to spark plugs, filters, lubricants, springs, tines, tine overlays, nylon bars, and blades.

This warranty does not include parts or components which are covered under the original manufacturers warranty, including, but not limited to engine and differential.



