

# **Salsco**, INC.

LEADER BY DESIGN

DE-THATCHER

MODEL 375

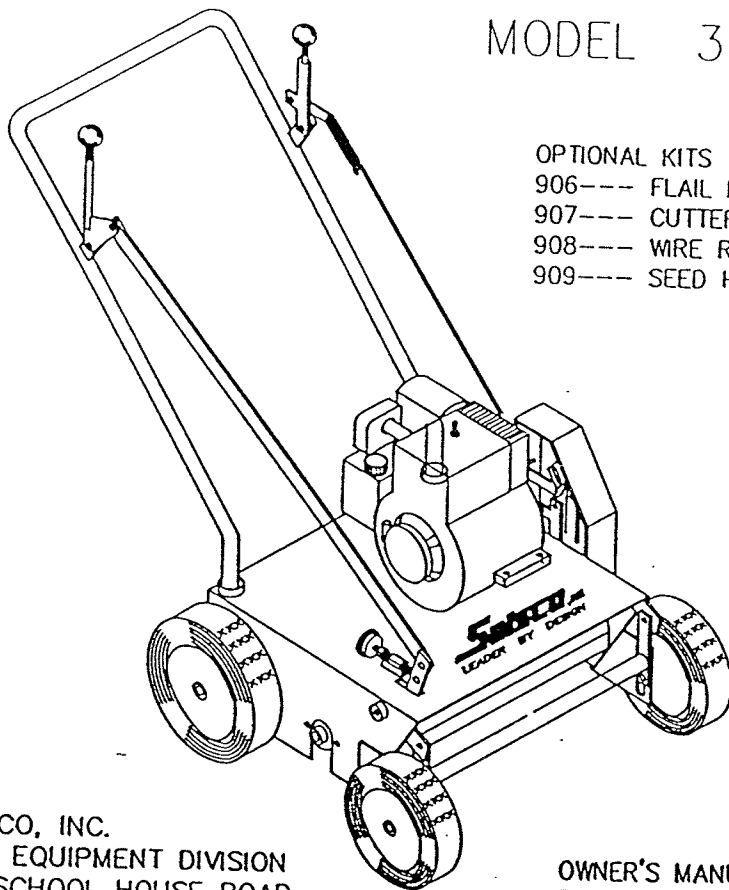

OPTIONAL KITS

- 906--- FLAIL BLADE KIT STANDARD
- 907--- CUTTER BLADE KIT
- 908--- WIRE RAKE KIT
- 909--- SEED HOPPER KIT

SALSCO, INC.  
TURF EQUIPMENT DIVISION  
105 SCHOOL HOUSE ROAD  
CHESHIRE, CONN. 06410 USA

OWNER'S MANUAL  
PARTS MANUAL  
SERVICE MANUAL

\* NOTE: PLEASE READ "CAUTIONS" IN THIS MANUAL

# **Salsco**, INC.

LEADER BY DESIGN

DE-THATCHER

WITH SEED HOPPER KIT

MODEL 375

MODEL 909 KIT

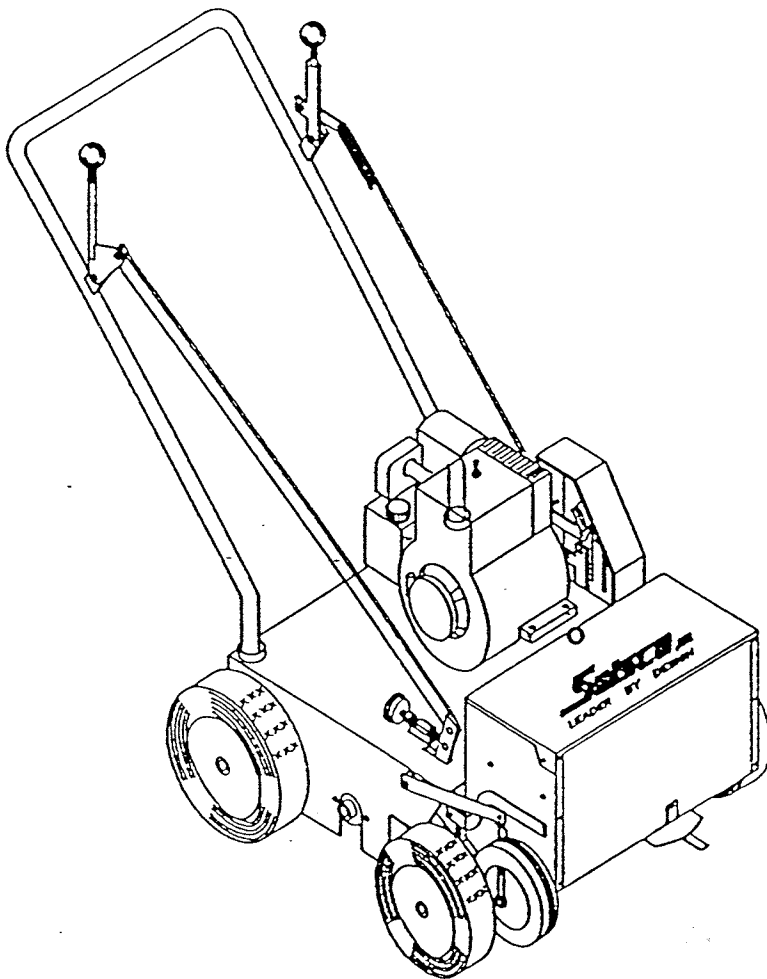

STATEMENT OF FACT

YOU HAVE JUST PURCHASED THE HIGHEST QUALITY, MOST EFFECTIVE DETHATCHER ON THE MARKET TODAY. THIS UNIT HAS THE ABILITY TO MEET EXACT DETHATCHING STANDARDS AND PERFORM FOR YEARS WITH MINIMUM DOWN TIME. HOWEVER, IT CANNOT READ NOR WILL IT UNDERSTAND THIS MANUAL NO MATTER HOW LONG YOU LEAVE IT ON TOP OF THE MACHINE. IT IS YOUR RESPONSIBILITY TO READ AND UNDERSTAND IT. IT IS ALSO YOUR RESPONSIBILITY TO BE CERTAIN THIS INFORMATION IS PASSED ALONG TO ANYONE WHO IS EXPECTED TO OPERATE THIS EQUIPMENT. SHOULD YOU CHOOSE NOT TO READ AND UNDERSTAND AND PASS ALONG THE INFORMATION PROVIDED YOU, PLEASE EXPECT EQUIPMENT FAILURE AND POSSIBLE INJURIES TO PERSONS AROUND THIS EQUIPMENT.

FOR THE SAFETY OF THE OPERATOR IT IS IMPERATIVE THAT THIS MANUAL IS CAREFULLY READ AND UNDERSTOOD.

HAVING READ THIS MANUAL, IT IS YOUR RESPONSIBILITY TO BE SURE THAT ALL NEW OPERATORS READ AND UNDERSTAND THIS MANUAL ESPECIALLY THE CAUTIONS ON PAGE FIVE.

AS A MANUFACTURER OF EQUIPMENT WE HAVE A RESPONSIBILITY TO DESIGN A SAFE PIECE OF EQUIPMENT. HOWEVER, ONLY YOU CAN PREVENT ACCIDENTS!!

DESCRIPTION

Designed to remove excessive thatch from the most thatch-bound lawns, the 375 Dethatcher is a must for any lawncare professional. powered by either a 5 h.p. Briggs & Stratton or 5 h.p. Kawasaki engine, the 375 is capable of dethatching 21,000 square feet per hour. This standard Dethatcher with Flail-type blades, Verti-cut Slicer blades or Spring type for raking will provide years of profitable service. When the 909 Seed Hopper is installed on our 375 Dethatcher you have one of the most durable spot seeding machines on the market today.

REMEMBER THIS IS A GROUND ENGAGING PIECE OF EQUIPMENT. ITS DESIGN TELLS YOU TO KEEP HANDS AND FEET AND ALL BODY PARTS OUT FROM UNDER IT WHEN IT'S RUNNING TO PREVENT POSSIBLE INJURIES.

THINK      SAFETY

MANUFACTURED BY: SALSCO, INC.  
 TURF EQUIPMENT DIVISION  
 105 SCHOOL HOUSE ROAD  
 CHESHIRE, CONNECTICUT 06410  
 203/271-1682  
 FAX (203) 271-2596

DETHATCHER OWNER'S MANUAL

THIS MANUAL COVERS MODEL: 375 DETHATCHER

This company reserves the right to discontinue, add improvements to, or change the design of any model or product at any time without obligation to improve existing machines, either by changing the design or adding new parts.

It has been and will continue to be the policy of SALSCO to update existing machines at its own discretion. Whenever possible, new designs will be made in such a way, that they can be "Retro Fit" if so desired.

Record in space provided below the model and serial numbers of this unit. Please retain these numbers for future reference.

No parts orders will be accepted without Model numbers or parts numbers.

----- Model Number		----- Serial Number
<u>Model No.</u>	<u>Prefix</u>	<u>Part Number Code:</u>
375	= 375	<u>Model Part Number*</u>
		000 A 000

\* PART NUMBER PREFIX MUST BE USED WHEN ORDERING PARTS (375A000).

\*\*\*\* CAUTION \*\*\*\*

READ AND UNDERSTAND THIS MANUAL BEFORE STARTING MACHINE!!  
 SEE CAUTIONS ON PAGE 5 OF THIS MANUAL!!

SERVICE SCHEDULE

BE SURE TO DISCONNECT SPARK PLUG WIRE BEFORE DOING MAINTENANCE ON THE MACHINE!!

<u>ITEM</u>	<u>FREQUENCY</u>
CHECK ENGINE OIL	DAILY
CHECK NUTS AND BOLTS FOR TIGHTENING	DAILY
CHECK SPROCKETS AND PULLEYS FOR ALIGNMENT & TIGHTNESS	DAILY
WASH MACHINE (as needed)	WEEKLY
CHECK ENGINE AIR CLEANER	DAILY
CHECK FOR WEAR ON GROUND ENGAGING ITEMS	WEEKLY
CHECK ENGINE MANUAL FOR ROUTINE MAINTENANCE	

THINK

SAFETY

CAUTION

BEFORE YOU START THIS MACHINE:

1. READ AND UNDERSTAND OWNERS MANUAL.
2. DO NOT RUN WITHOUT GUARDS AND OTHER SAFETY COVERS ON MACHINE.
3. NEVER LEAVE MACHINE RUNNING WHILE UNATTENDED.
4. NEVER REACH UNDER OR INTO MACHINE FOR ANY REASON WHILE MACHINE IS RUNNING AS IT CAN CAUSE SERIOUS INJURY.
5. DO NOT LET ANYONE WALK NEXT TO OR IN FRONT OF MACHINE WHILE IN OPERATION.
6. NEVER RUN OVER ASPHALT, CONCRETE OR ANY OTHER MATERIAL WHICH CANNOT BE CUT WITH THE GROUND ENGAGING ITEMS IN THE LOWERED POSITION.
7. ALWAYS REMOVE SPARK PLUG WIRE, MAKE SURE ENGINE SWITCH IS OFF, THROTTLE IS IN STOP POSITION, AND SHUT GAS OFF WHEN WORKING ON OR CHECKING INSIDE OF MACHINE.
8. NEVER DO ANYTHING WITH BELTS, SUCH AS REMOVING OR REPLACING THEM, ETC., WHILE ENGINE IS RUNNING.
9. DO NOT REMOVE CAUTION DECALS.
10. SAFETY DECALS SHOULD BE REPLACED IMMEDIATELY AFTER REPAINTING OR WHEN THEY BECOME ILLEGIBLE. \*\* SEE NOTE BELOW \*\*

**\*\* NOTE \*\***

SAFETY IS A PRIME CONCERN AT SALSCO AND THE SAFETY DECALS ON YOUR MACHINE ARE A HIGHLY VISIBLE AND CONSTANT REMINDER TO ALL OPERATORS. REPLACEMENT SAFETY DECALS MAY BE OBTAINED FROM YOUR LOCAL DEALER OR BY CALLING TOLL FREE 1-800-8SALSCO.

DO NOT RUN MACHINE WITHOUT GUARDS IN PLACE

## OPERATING INSTRUCTIONS

- A) BE SURE THE WHEEL RAISE HANDLE, ITEM # 3, IS IN THE DOWN POSITION SO THAT THE CUTTERS ARE OFF THE GROUND.
- B) MAKE SURE THE CLUTCH LEVER, ITEM # 12, IS DIS-ENGAGED.
- C) CHECK THE OIL AND THE FUEL.
- D) PLACE THE SWITCH ON THE MOTOR TO THE ON POSITION.
- E) PLACE THE CHOKE LEVER ON TO CHOKE.  
CAUTION: DO NOT PLACE FOOT UNDER MACHINE WHEN STARTING
- F) PULL CORD, START ENGINE.
- G) WHEN THE ENGINE WARMS UP, PUT THE CHOKE IN NORMAL POSITION. REMEMBER TO MOVE THE MACHINE TO SOIL OR TURF BEFORE CONTINUING.
- H) ENGAGE CLUTCH LEVER ITEM #12, TO ACTIVATE CUTTER SHAFT.
- I) ENGAGE WHEEL RAISE HANDLE ITEM #3, TO LOWER UNIT TO WORKING DEPTH.
- J) ALL THAT IS REQUIRED NOW IS TO WALK MACHINE OVER TURF AREA WHERE THATCH REMOVAL IS REQUIRED OR SPOT SEEDNG IS DESIRED.

DO NOT LEAVE MACHINE RUNNING UNATTENDED!!

WE CANNOT REPLACE COMMON SENSE WITH SAFETY SWITCHES

THINK

SAFETY

### HELPFUL HINTS

- A) You may wish to crisscross heavy thatched lawns.
- B) The machine will be easier to operate on hills if you go across them rather than up and down.
- C) Be sure to keep your machine clean. This will help your preventive maintenance program.
- D) When using the 375 Dethatcher with the 909 Seed Hopper you may, depending on the amount of thatch, wish to dethatch first. Pick up thatch and then seed with the machine.
- E) Study the parts break down. It's important for performance, life of the machine, quality of the job, and your safety, that you understand how this machine works.
- F) At this time we suggest you re-read the manual. You may see something you missed the first time and it will only take a few minutes to do.

LAST BUT NOT LEAST, PLEASE FEEL FREE TO CALL US AT 1/800-8SALSCO. WE WANT YOUR COMMENTS. THERE IS NO STRONGER TOOL WE CAN GET THAN CUSTOMER FEED BACK.

THINK

SAFETY

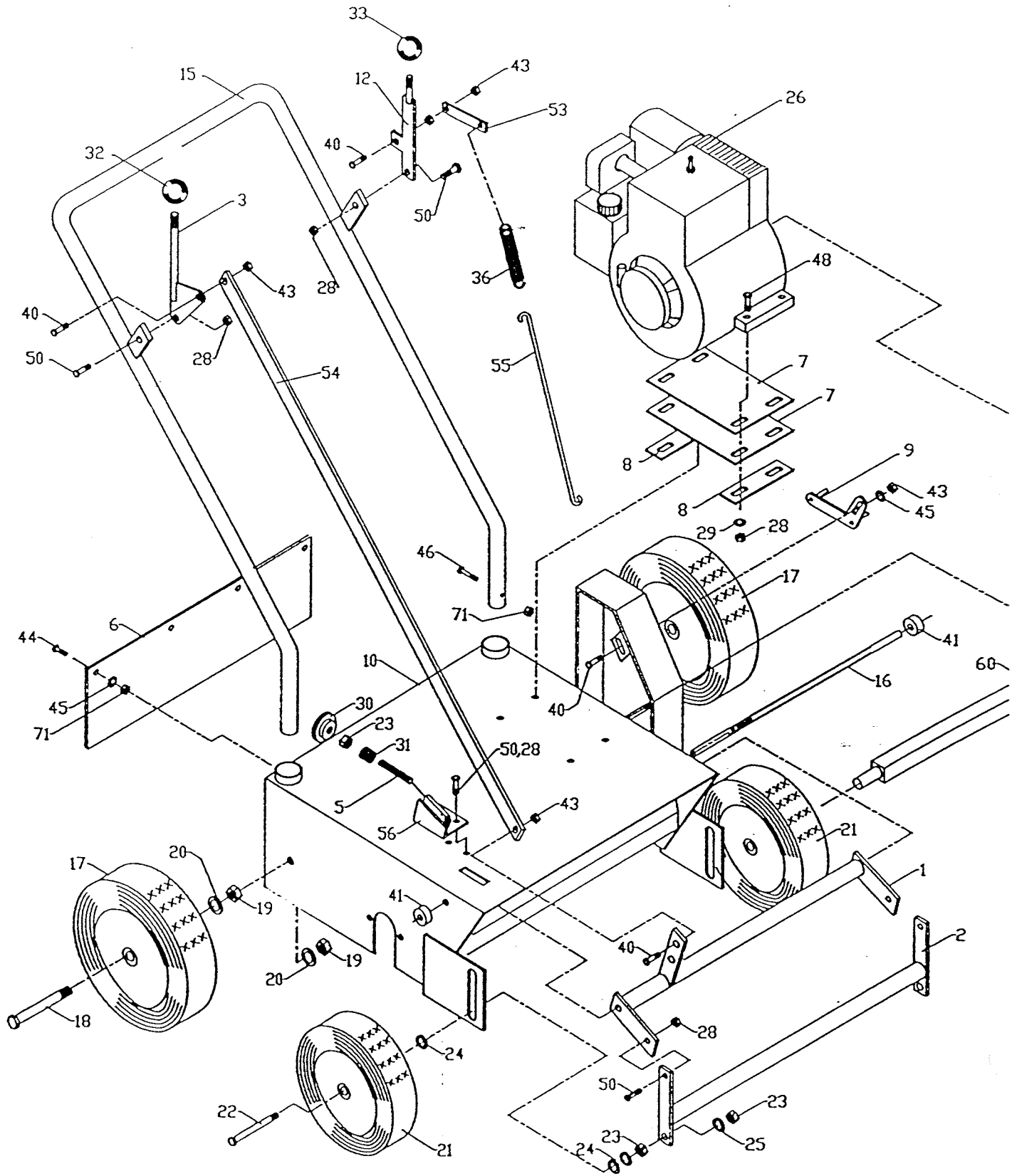

**375 DETATCHER**

053089

ITEM NO.	NAME	QTY
60	H-232 CUTTER SHAFT	1
61	F-205 CUTTER BLADE	28
62	T-164 BLADE M'T'G PLATE	4
63	U-164 BLADE M'T'G PLATE	1
64	V-221 BLADE SPACER 1 1/8"	22
65	D-221 SQUARE SPACER 4 1/4"	2
66	E-221 SQUARE SPACER 4 5/8"	2
67	F-221 BEARING SPACER	1
68	F-167 BLADE RET'G PIN	4
69	A-089 WASHER	1
70	C-136 CARRIAGE BOLT	4
71	E-158 LOCK NUT	4
72	A-109 BEARING	1
73	A-110 FLANGETTE	2
74	D-218 "E" RING	8
75	H-070 "V" BELT	1
76	D-066 PULLEY	1
77	B-221 SPACER 1/2"	8

**MODEL 906  
 FLAIL BLADE KIT**

INCLUDES THE FOLLOWING PARTS

61	F-205 CUTTER BLADE	28
64	V-221 SPACER 1 1/8"	22
68	F-167 BLADE PIN	4
74	D-218 E RING	8
77	B-221 SPACER 1/2"	8

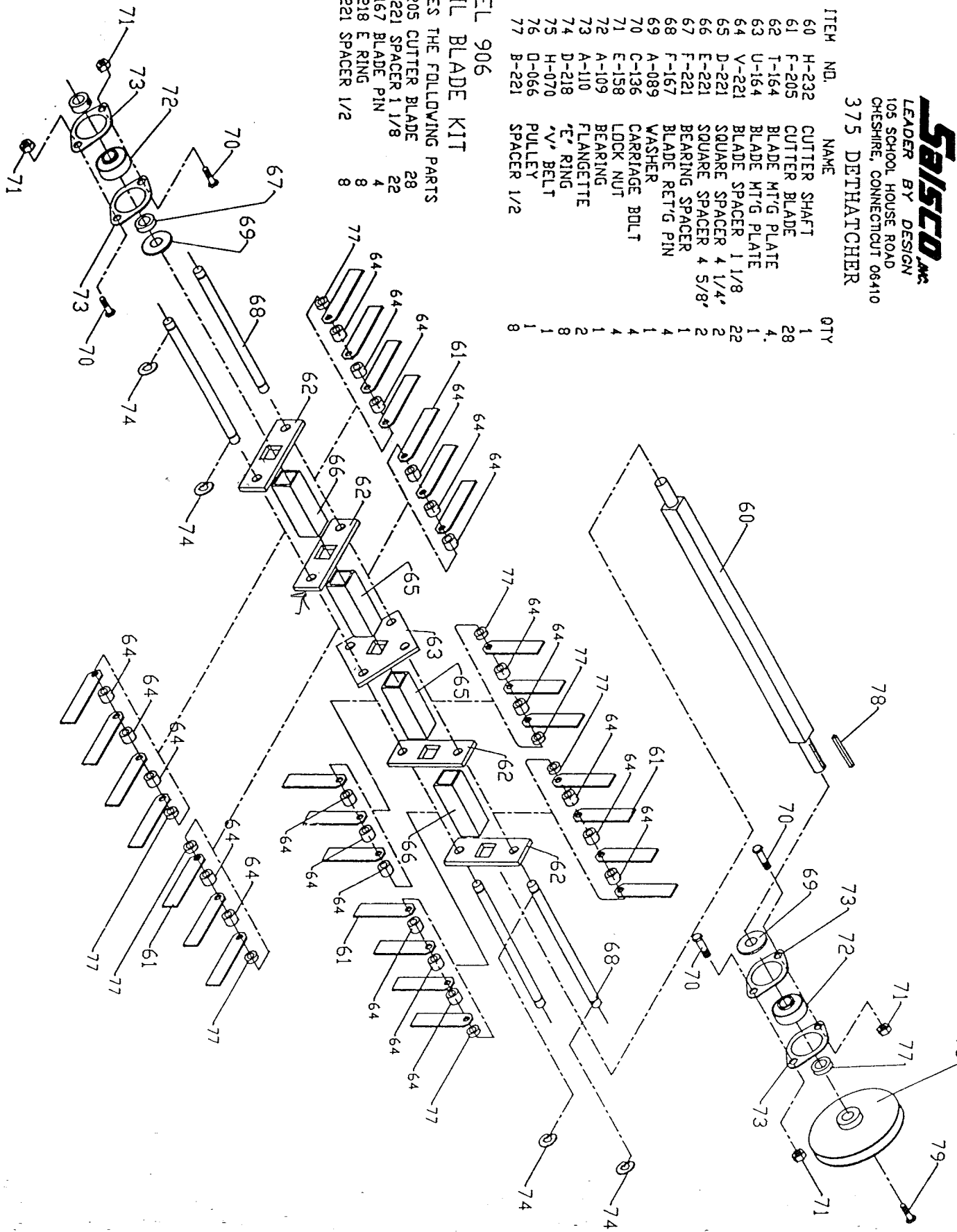



BEFORE STARTING THIS MACHINE  
SEE OPERATING INSTRUCTIONS PAGE 6  
OF 375 MANUAL

KILL SWITCH SHOULD BE MOUNTED TO HANDLE BARS  
WITH BRACKET PROVIDED AND WIRED PROPERLY TO  
MOTOR

KILL SWITCH CORD SHOULD BE ATTACHED SECURELY  
TO OPERATOR

BE SURE THE WHEEL RAISE HANDLE ITEM 3 IS IN THE  
DOWN POSITION SO THAT THE CUTTERS ARE OFF THE GROUND  
MAKE SURE THE CLUTCH LEVER ITEM 12 IS DIS-ENGAGED  
THIS IS A GROUND ENGAGING PIECE OF EQUIPMENT  
THAT CAN TAKE OFF WITHOUT THE OPERATOR IF  
PROPER SAFETY DEVICES ARE NOT USED

**Saisco, Inc.**  
LEADER BY DESIGN  
105 SCHOOL HOUSE ROAD  
CHESHIRE, CONNECTICUT 06410

MODEL 907 .125 THICK BLADE  
MODEL 910 .062 THICK BLADE  
MODEL 911 .031 THICK BLADE  
CUTTER BLADE KIT  
FOR 375 DETHATCHER

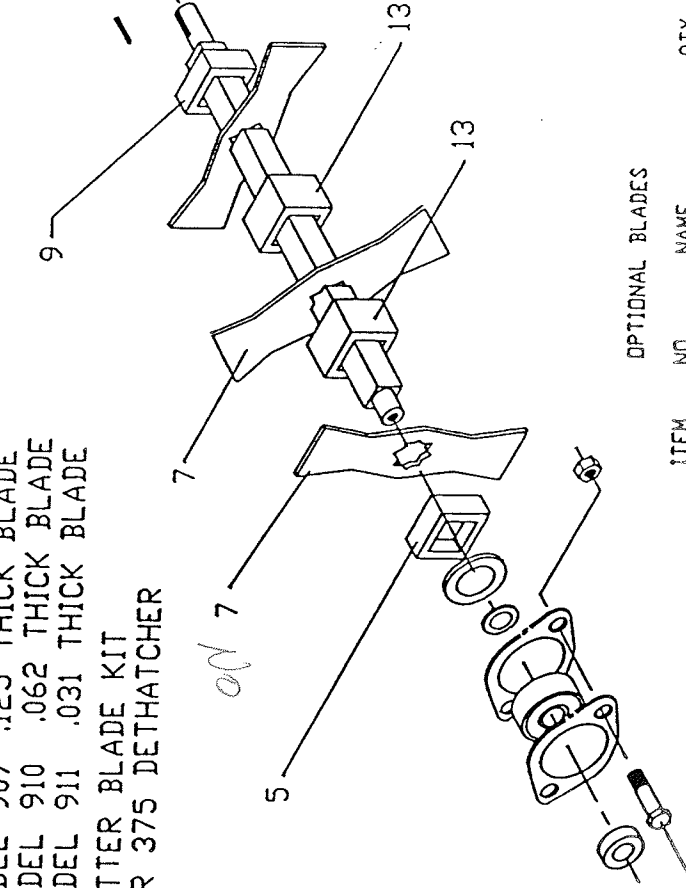
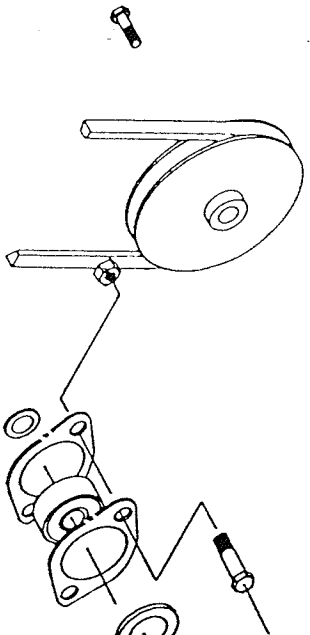
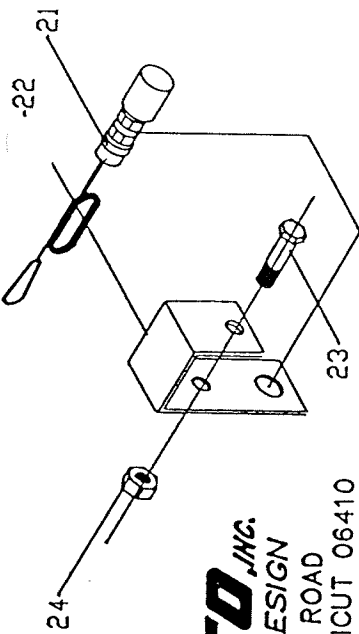

907,910,911 COMMON PARTS  
INCLUDES ALL ITEMS LISTED

ITEM	NO.	NAME	QTY
5	M-221	SPACER 3/8	1
7	*	SEE OPTIONS	
9	L-221	SPACER 1/2	1
13	*	SEE OPTIONS	
21	R-193	KILL SWITCH	1
22	X-228	MOUNTING BK'T	1
23	D-132	HEX SCREW	1
24	E-158	LOCK NUT	1
PARTS NOT SHOWN			
	U-193	WIRE TIE	4
	Q-193	BUTT SPLICE	1
	T-193	1/8 EYE CONNECTOR	1
	D-193	5/16 EYE CONNECTOR	1
	L-212	RED WIRE	48'

ITEM	NO.	NAME	QTY
907 KIT*	J-205	.125 BLADE	7
	K-221	SPACER 2 7/8	6
910 KIT*	K-205	.062 BLADE	7
	B-237	SPACES 2 15/16	6
911 KIT*	N-205	.031 BLADE	7
	C-237	SPACER 3 in	6

PARTS SHOWN ON THIS DRAWING WITHOUT ITEM NO'S  
ARE FOR ASSEMBLY REF. ONLY  
(NOT SUPPLIED WITH KIT)

**Saisco, Inc.**

LEADER BY DESIGN

105 SCHOOL HOUSE ROAD

CHESHIRE, CONNECTICUT 06410

375 DETHATCHER

MODEL 908 WIRE RAKE KIT

FOR THE 375 DETHATCHER

INCLUDES

P-013 TORSION SPRING

68 PIECES

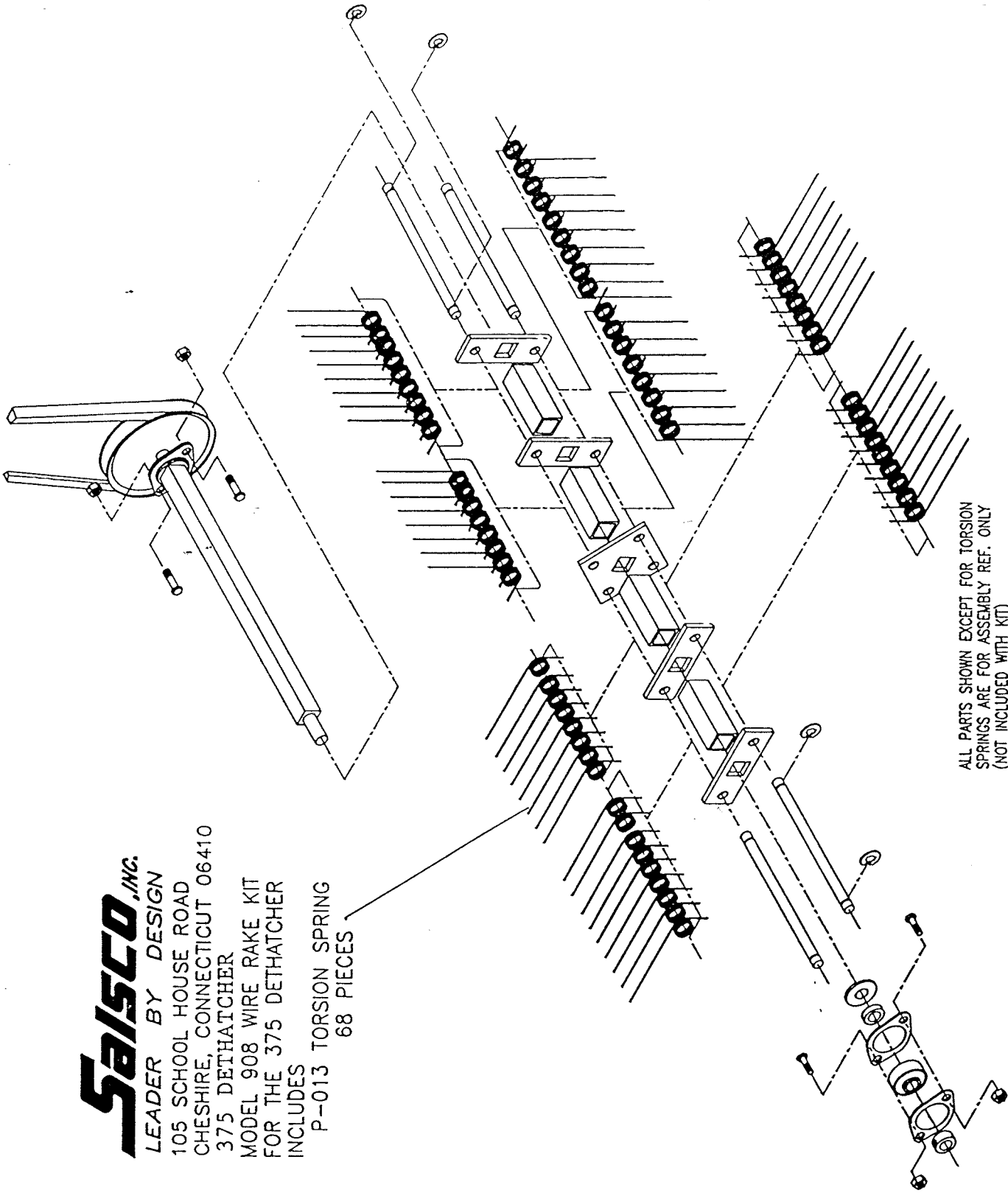

ALL PARTS SHOWN EXCEPT FOR TORSION  
SPRINGS ARE FOR ASSEMBLY REF. ONLY  
(NOT INCLUDED WITH KIT)

# REAR MOUNTING ACCESSORIES

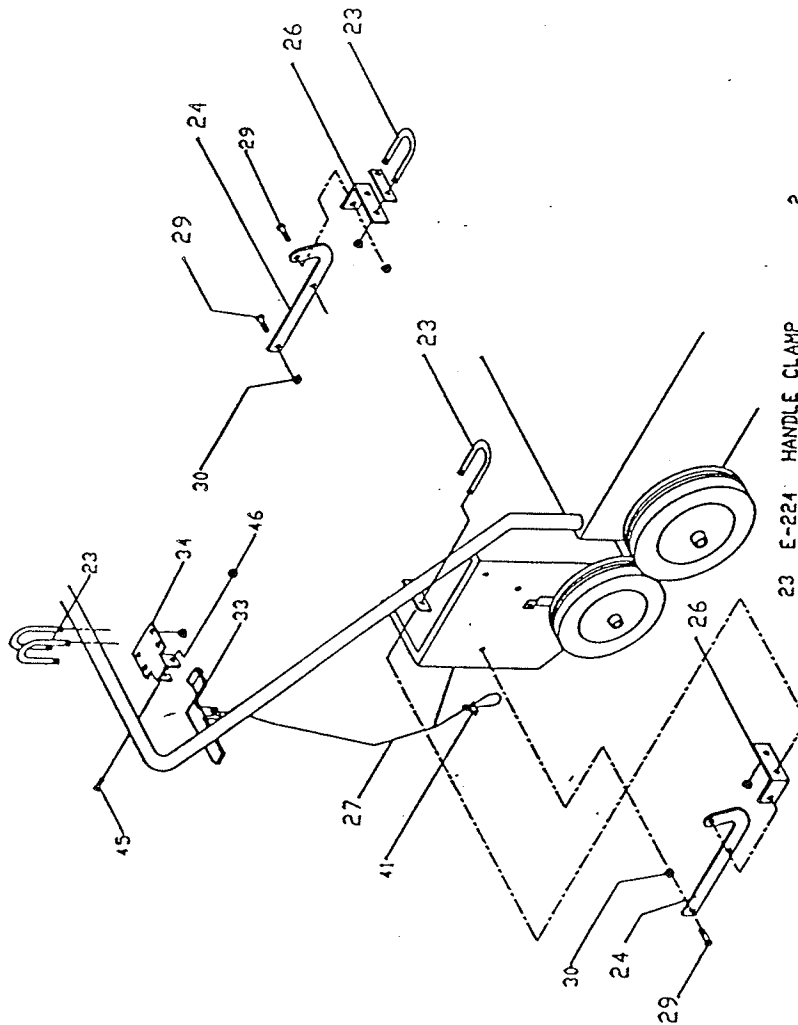

- |    |       |                     |   |
|----|-------|---------------------|---|
| 23 | E-224 | HANDLE CLAMP        | 2 |
| 24 | E-506 | MOUNTING BAR        | 2 |
| 26 | D-228 | CLAMP BRACKET       | 2 |
| 27 | B-105 | CABLE               | 1 |
| 29 | G-138 | HEX BOLT            | 6 |
| 30 | A-159 | LOCK NUT            | 6 |
| 33 | I-103 | SEED HANDLE         | 1 |
| 34 | E-228 | HANDLE MT'G BRACKET | 1 |
| 41 | G-224 | CABLE CLAMP         | 1 |
| 45 | B-143 | HEX SCREW           | 1 |
| 46 | B-158 | LOCK NUT            | 1 |

# MODEL 909 SEED HOPPER ACCESSORIES

FOR MOUNTING TO  
SALSCO MODEL 375 DETHATCHER  
OR CAN BE ADAPTED TO FIT  
MOST POWER RAKE DETHATCHERS  
AND MOST WALK BEHIND AERATORS

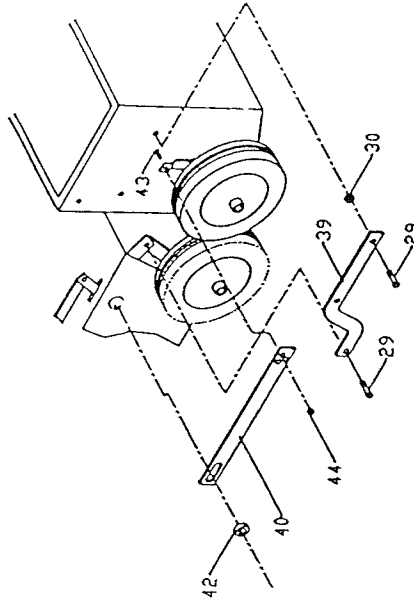

- |    |       |                    |   |
|----|-------|--------------------|---|
| 29 | G-138 | HEX BOLT           | 6 |
| 30 | A-159 | LOCK NUT           | 6 |
| 39 | G-506 | FRONT MT'G BRACKET | 2 |
| 40 | P-099 | SHUT OFF PLATE     | 1 |
| 42 | G-081 | COLLAR             | 1 |
| 43 | A-140 | HEX SCREW          | 1 |
| 44 | E-158 | LOCK NUT           | 1 |

# FRONT MOUNTING ACCESSORIES

## **SALSCO** INC.

LEADER BY DESIGN

105 SCHOOL HOUSE ROAD  
CHESHIRE, CONNECTICUT 06410



WARRANTY

Your Salsco Commercial or Turf Equipment product is a commercial type product and is normally manufactured and sold for commercial or industrial use. Salsco will, for the original purchaser, for one (1) year from the date of purchase (90 days if used for rental purposes; RENTAL IN THIS CASE MEANS MACHINE DOING PROPERTIES NOT OWNED BY ORIGINAL PURCHASER) repair or replace, free of charge, any part or parts found to be defective in material or workmanship or both. Any transportation charges to be borne by the purchaser.

If, during the Warranty Period, the product does not function properly due to defect, simply contact your Salsco Dealer and provide the unit or part for inspection or contact directly:

SALSCO, INC.  
Service Department  
105 School House Road  
Cheshire, CT 06410

203/271-1682  
FAX: 203/271-2596

This warranty does not include incidental or consequential damages and is exclusive of any implied warranties.

This warranty does not include normal maintenance parts, including, but not limited to spark plugs, filters, lubricants, springs, tines, tine overlays, nylon bars, and blades.

This warranty does not include parts or components which are covered under the original manufacturers warranty, including, but not limited to engine and differential.

