

# MODEL 365 BACK LAPPING MACHINE

## ASSEMBLY & SERVICE MANUAL



### **WARNING**

You must thoroughly read and understand this manual before operating the equipment, paying particular attention to the Warning & Safety instructions.

# SAFETY INSTRUCTIONS

**Safety Awareness Symbols** are inserted into this manual to alert you to possible **Safety Hazards**. Whenever you see these symbols, follow their instructions.



The **Warning Symbol** identifies special instructions or procedures which, if not correctly followed, could result in personal injury.

The **Caution Symbol** identifies special instructions or procedures which, if not strictly observed, could result in damage to or destruction of equipment.

1. **KEEP GUARDS IN PLACE** and in working order.
2. **REMOVE WRENCHES AND OTHER TOOLS.**
3. **KEEP WORK AREA CLEAN.**
4. **DON'T USE IN DANGEROUS ENVIRONMENT.** Don't use back lapper in damp or wet locations. Machine is for indoor use only. Keep work area well lit.
5. **KEEP ALL VISITORS AWAY.** All visitors should keep a safe distance from work area.
6. **MAKE WORK AREA CHILD-PROOF** with padlocks or master switches.
7. **DON'T FORCE THE BACK LAPPER.** It will do the job better and safer if used as specified in this manual.
8. **USE THE RIGHT TOOL.** Don't force the back lapper or an attachment to do a job for which it was not designed.
9. **WEAR PROPER APPAREL.** Wear no loose clothing, gloves, neckties, or jewelry which may get caught in moving parts. Non-slip footwear is recommended. Wear protective hair covering to contain long hair.
10. **ALWAYS USE SAFETY GLASSES.**
11. **SECURE YOUR WORK.** Mount the cutting unit in place before back lapping as prescribed in the operators manual.
12. **DO NOT OVERREACH.** Keep proper footing and balance at all times.
13. **MAINTAIN BACK LAPPER WITH CARE.** Follow instructions in Service Manual for lubrication and preventive maintenance.
14. **DISCONNECT POWER BEFORE SERVICING.**
15. **REDUCE THE RISK OF UNINTENTIONAL STARTING.** Make sure the switch is OFF before plugging in the back lapper.
16. **USE RECOMMENDED ACCESSORIES.** Consult the manual for recommended accessories. Using improper accessories may cause risk of personal injury.
17. **CHECK DAMAGED PARTS.** A guard or other part that is damaged or will not perform its intended function, should be properly repaired or replaced.
18. **NEVER LEAVE BACK LAPPER RUNNING UNATTENDED. TURN POWER OFF.** Do not leave back lapper until it comes to a complete stop.
19. **KNOW YOUR EQUIPMENT.** Read this manual carefully. Learn its application and limitations as well as specified potential hazards.
20. **KEEP ALL SAFETY DECALS CLEAN AND LEGIBLE.** If safety decals become damaged or illegible for any reason, replace immediately. Refer to replacement parts illustrations in Service Manual for the proper location and part numbers of safety decals.
21. **DO NOT OPERATE THE BACK LAPPER WHEN UNDER THE** influence of drugs, alcohol, or medication.

# SAFETY INSTRUCTIONS



This machine is intended for back lapping reel mowing units ONLY. Any use other than this may cause personal injury and void the warranty.

To assure the quality and safety of your machine and to maintain the warranty, you **MUST** use original equipment manufacturers replacement parts and have any repair work done by a qualified professional.

**ALL** operators of this equipment must be thoroughly trained **BEFORE** operating the equipment.

This machine is for indoor use ONLY. Do NOT power wash machine.



## UNPACK THE CARTON

Use care when unpacking. The back lapper is delivered assembled, ready to use. Miscellaneous parts, are wrapped separately. Verify that they are in the shipping carton so that they are not discarded by mistake.

Inspect all items for shipping damage as they are removed from the shipping containers. If you find any damage, notify the carrier's claims agent and do not proceed with unpacking until the damage has been inspected by the agent. Refer also to the "Shipping and Receiving Instructions" packed with the unit.

# ELECTRICAL INFORMATION

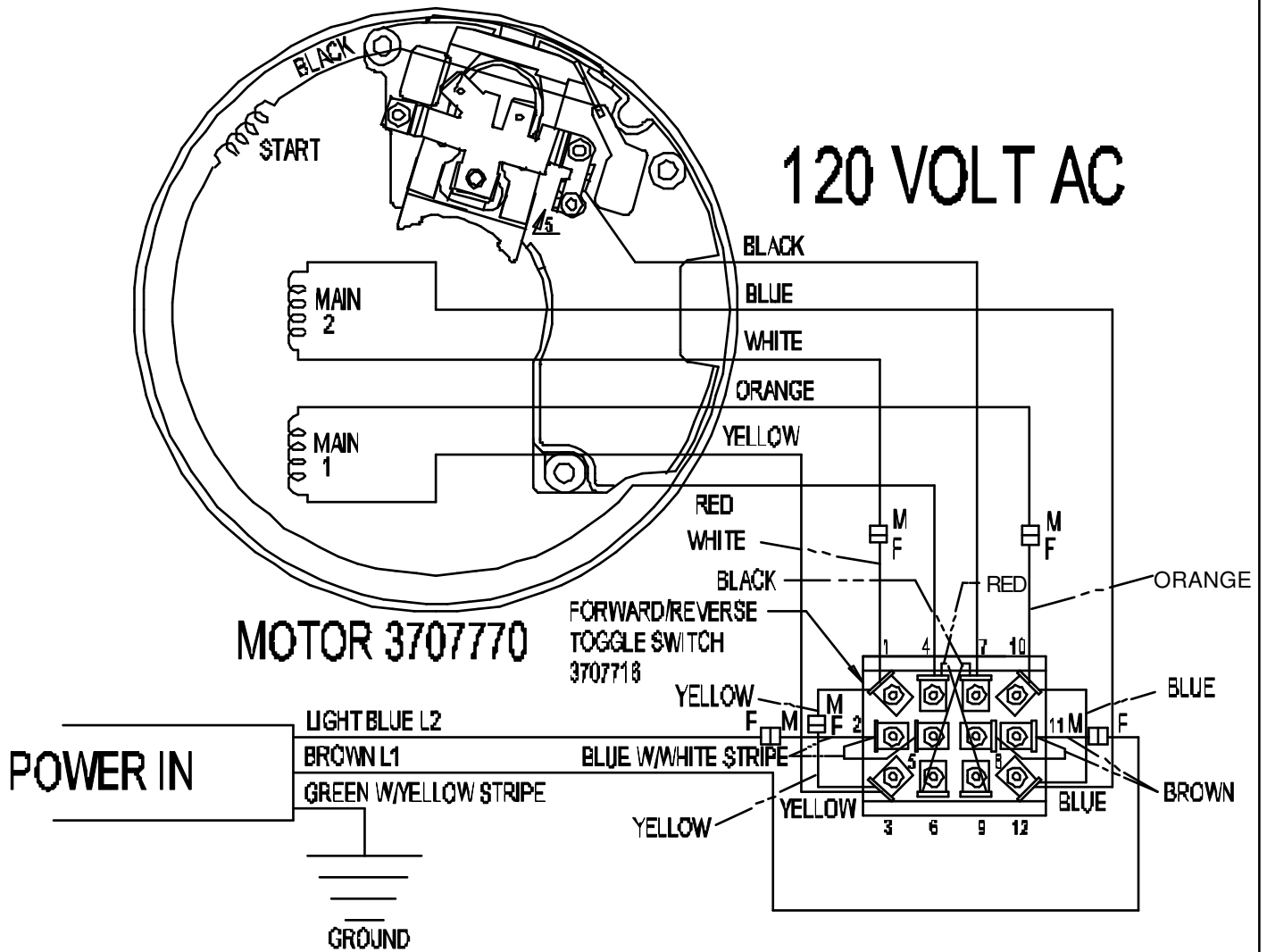

## 120 VOLT AC - AS BUILT

Your machine has been built to operate on 120 volt AC power in the United States and other countries.

**NOTE:** The back lapper has the three-position toggle switch for CW rotation, off, and CCW rotation. Note that the "FWD" and "REV" marks on the switch guard indicate the operating direction of the back lapper's motor; they do not indicate the lapping direction of the mower unit.

# ELECTRICAL INFORMATION

**NOTE:** This motor will correctly operate on 60 Hz or 50 Hz.

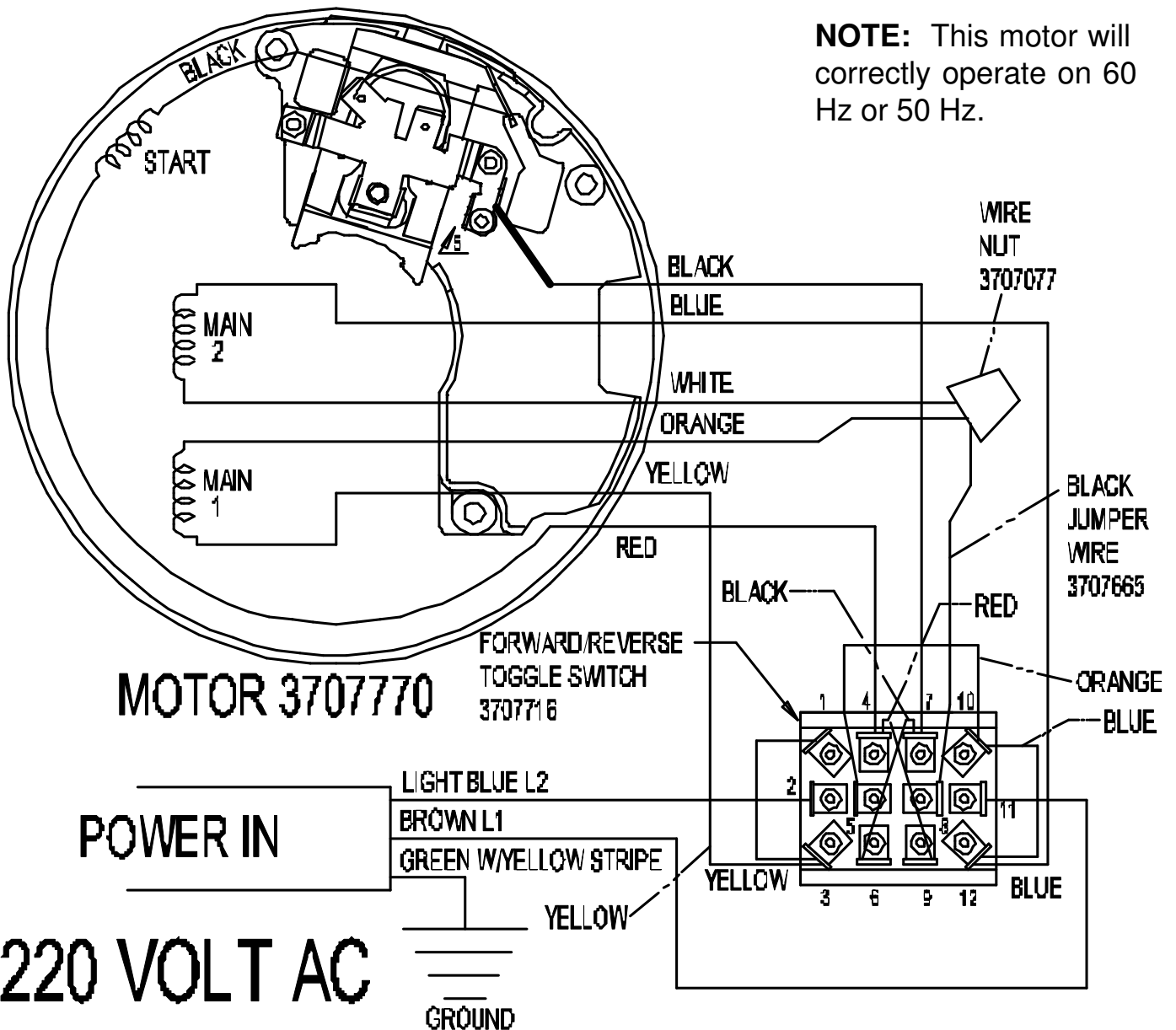

## 220 VOLT AC CONVERSION

To convert this unit to 220 Volt 1 Phase, cut the plug off from cord and replace it with the appropriate plug for your locality. For plug and circuit breaker sizing, see motor nameplate rating. **NOTE:** Circuit should have breaker or fuse rated at 5 amp minimum for 220V application. Use only a qualified electrician. Rewire the unit as below:

### 220 VOLT:

To convert the unit from **120** volt to **220** volt:

1. Remove the Jumper Assembly from terminals 2 to 5 and L2 and discard. Plug L2 onto terminal 2.
2. Remove the Jumper Assembly from terminals 11 to 8 and L1 and discard. Plug L1 onto terminal 11.
3. Remove the Jumper Assembly from terminals 1 to white motor wire and yellow wire and discard. Plug the loose yellow wire that comes from the terminal three onto terminal 1.
4. Disconnect the male/female connection between the orange wires. Connect the female orange wire to terminal 5.
5. Cut the male terminal off the orange motor wire and the white motor wire and strip the insulation back .50" [13 mm]. Wire nut the orange motor wire, white motor wire and black jumper wire 3707665 together.
6. connect the black jumper wire 3707665 female terminal onto terminal 8.

# GROUNDING AND MAINTENANCE INSTRUCTIONS

## IMPORTANT GROUNDING INSTRUCTIONS

In case of a malfunction or breakdown, grounding reduces the risk of electrical shock by providing a path of least resistance for electrical current.

This back lapper has an electrical cord with an equipment grounding conductor and a grounding plug. The plug must be plugged into a matching outlet that is properly installed and grounded according to all local or other appropriate electrical codes and ordinances.

Before plugging in the back lapper, make sure it will be connected to a supply circuit protected by a properly-sized circuit breaker or fuse. 15 amp minimum for 115V applications.



**DO NOT MODIFY THE PLUG PROVIDED; IF IT WILL NOT FIT THE OUTLET, HAVE THE PROPER OUTLET AND CIRCUIT INSTALLED BY A QUALIFIED ELECTRICIAN.**

Always provide a proper electrical ground for your machine. An improper connection can cause a dangerous electrical shock. If you are unsure of the proper electrical grounding procedure, contact a qualified electrician.

### 115 VOLT MODEL ONLY.

Plug the power cord into standard grounded receptacle as shown:



## PERIODIC MAINTENANCE

- |                  |  |
|------------------|--|
| <b>Monthly</b>   | - Inspect the unit for loose, worn or damaged components. Repair or replace any found. |
| <b>Quarterly</b> | - Inspect belts for proper tension and cracks. Adjust or replace as required.          |

# MACHINE SPECIFICATIONS

The Model 365 Back Lapping machine quickly sharpens the reels and bedknives of your mowers, giving them a fine cutting edge. It connects easily to most reel mowers and to gang mowers while still connected to the frame and tractor.

## STANDARD FEATURES

- Drive coupler
- Socket driver assembly
- Two 6" [15.2 cm] x 6" [15.2 cm] x 15" [38.1 cm] height-adjustable support stands.

## OPTIONAL EQUIPMENT

- Trimmer adapter
- Greenmaster adapter
- Lapping compound
- Adapter bushings and Pawl

## PHYSICAL SPECIFICATIONS

Length	15" [38.1 cm]
Width	16.5" [41.9 cm]
Height	19" [48.3 cm]
Grinder motor	.50 Horsepower, 115/220-volt, 60/50-cycle, single-phase, reversing motor operating at 1725/1425 rpm
Lapping speed	140/116 rpm
Weight	Less than 54 lbs [24.5 kg]
Sound Level	Less than 75 Dba when lapping

PARTS LIST

MODEL 365 BACK LAPPER

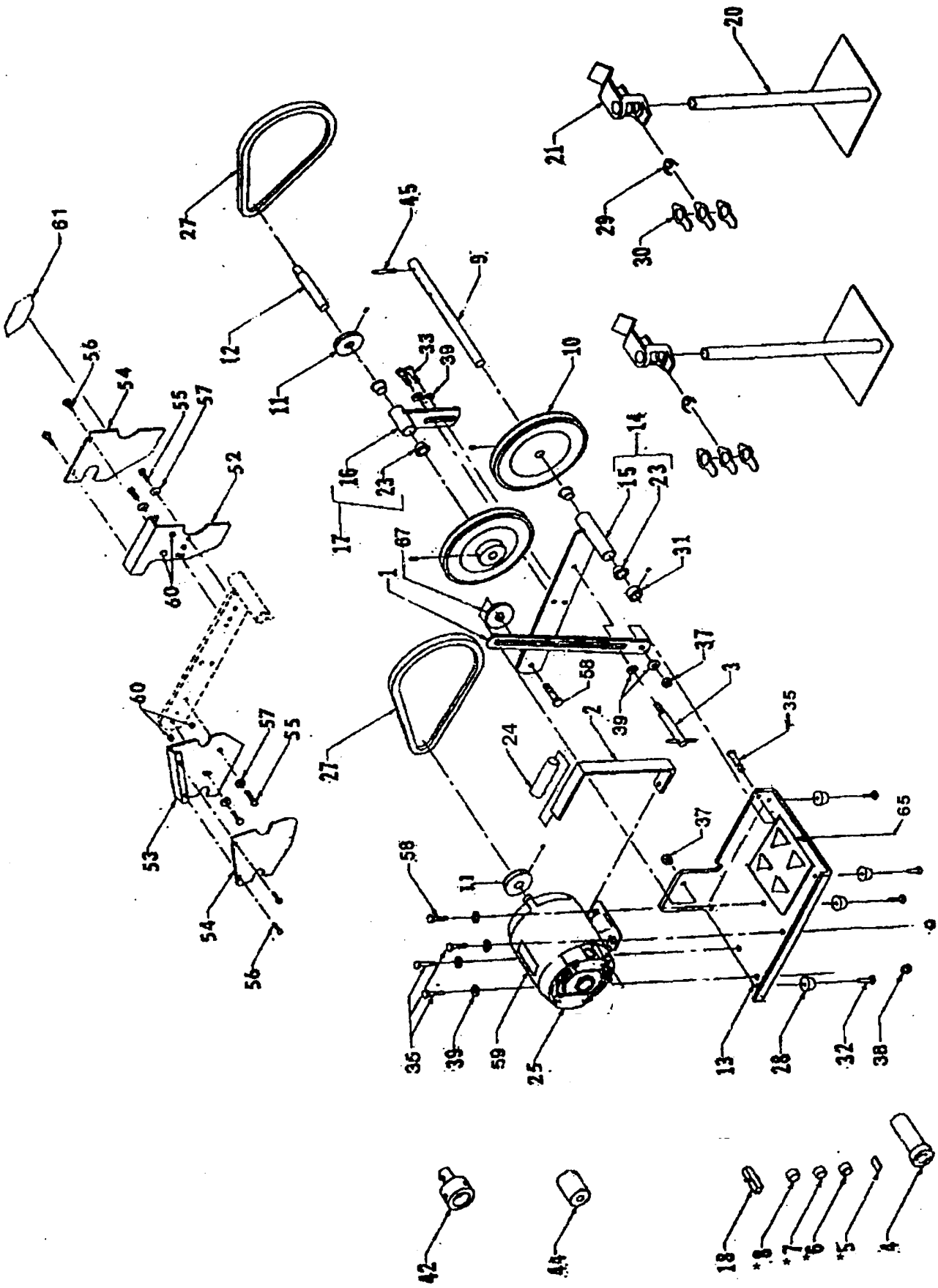



# PARTS LIST MODEL 365 BACK LAPPER

- ORIGINAL INSTRUCTIONS-

DIA. NO.	PART NUMBER	DESCRIPTION
1.....	3649038 .....	Adjusting Arm
2.....	3659009 .....	Handle
3.....	6009535 .....	T-Handle
4.....	3659002 .....	Drive Coupler
<b>5.....</b>	<b>*3659003.....</b>	<b>Pawl</b>
6.....	*3659006.....	1/2" Bushing
7.....	*3659007.....	9/16" Bushing
8.....	*3659008.....	5/8" Bushing
9.....	3659054 .....	Drive Shaft
<b>10.....</b>	<b>3659038 .....</b>	<b>Sheave with Set Screw - 7"</b>
11.....	3659039 .....	Sheave with Set Screw
12.....	3659047 .....	Reduction Shaft
13.....	3659010 .....	Base
14.....	3659542 .....	Support Arm and Bearing Assembly
<b>15.....</b>	<b>3659543 .....</b>	<b>Support Arm Assembly</b>
16.....	3659545 .....	Shaft Housing Assembly
17.....	3659546 .....	Shaft Housing & Bearing Assembly
18.....	3659550 .....	Socket Drive Assembly
<b>20.....</b>	<b>3659553 .....</b>	<b>Support Stand</b>
21.....	3659503 .....	Pony Bracket Weld
23.....	3709088 .....	Bronze Flange Bearing
24.....	3709174 .....	Handle Grip
25.....	3707780 .....	Motor Assy
<b>27.....</b>	<b>3709650 .....</b>	<b>"V" Belt</b>
28.....	3709767 .....	Rubber Support
29.....	3706254 .....	Spring Pony Bracket
30.....	3659011.....	FoleyPonyLever
31.....	3709875 .....	Set Collar with Set Screw
<b>32.....</b>	<b>3708465 .....</b>	<b>188 Dia. Blind Rivet</b>
33.....	B310801 .....	Hex Head Cap Screw 5/16"-18 x 1/2" Long
35.....	B311201 .....	Hex Head Cap Screw 5/16"-18 x 3/4" Long
37.....	J317000.....	5/16-18 Nylok Hex Locknut
38.....	R000551 .....	5/16-18 Kep Locknut
<b>39.....</b>	<b>K310001 .....</b>	<b>5/16 Flat Washer</b>
42.....	*3659904.....	Trimmer Adapter
44.....	*3659906.....	Greenmaster Adapter
45.....	H251609.....	Drive Lock Pin 1/4 x 1 Long
50.....	3707039 .....	Cord Set
<b>51.....</b>	<b>3707716 .....</b>	<b>Switch</b>
52.....	3659080 .....	Front Sheave Guard
53.....	3659081 .....	Back Sheave Guard
54.....	3659082 .....	Door
55.....	B250601 .....	Hex Head Cap Screw 1/4-20 x 3/8" Long
<b>56.....</b>	<b>D190660.....</b>	<b>Hex Head Sheet Metal Screw #10 x 3/8"</b>
57.....	K250001 .....	1/4 Plain Washer
58.....	B311601 .....	Hex Head Cap Screw 5/16-18 x 1" Long
59.....	3708448 .....	Warning Decal
60.....	3659083 .....	Bumper
<b>61.....</b>	<b>3709986 .....</b>	<b>Small Foley United Decal</b>
62.....	3707665 .....	Wire Jumper - Black (Not Shown)
65.....	3708703 .....	Warning Decal
67.....	3589106 .....	Flat Washer .39" ID x 1.38" OD

## \*Optional Equipment

